



AQUADOM Mirror Installation Guide

IMPORTANT SAFETY INSTRUCTIONS

When using an electrical furnishing, basic precautions should always be followed, including the following:



DANGER

READ AND FOLLOW ALL INSTRUCTIONS BEFORE USING THIS MIRROR.



WARNING

Risk of electric shock. Connect this furnishing to a properly grounded circuit only. See Grounding instructions.



WARNING

To reduce the risk of burns, fire, electric shock or injury to persons. Use this furnishing only for its intended use as described in these instructions. Do not use attachments not recommended by the manufacturer. Never drop or insert any object into any opening. Do not use outdoors.

GROUNDING INSTRUCTIONS:

This product must be connected to a grounded metal, permanent wiring system, or an equipment-grounding conductor must be run with the circuit conductors and connected to the equipment-grounding terminal or lead on the product.



WARNING

An Electrical option cabinet must be wired to a 20 Amp GFI (Ground Fault Interrupter) protected circuit when used in bathrooms and all other locations required by the National Electric Code.

PLEASE SAVE THESE INSTRUCTIONS FOR FUTURE REFERENCE

AQUADOM Mirror Installation Guide

TOOLS REQUIRED FOR ASSEMBLY

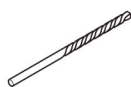
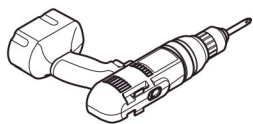

1/8" Drill Bit

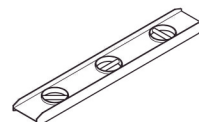
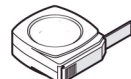
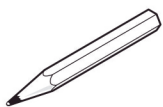

PARTS INCLUDED

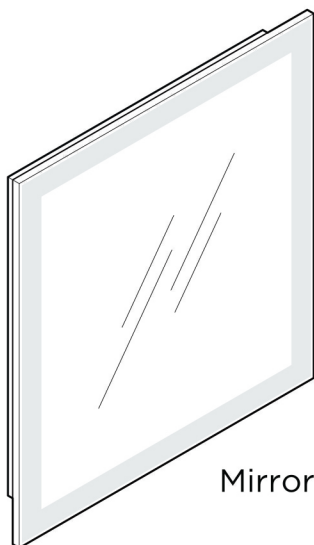

Mirror



Wire Nuts



Screws

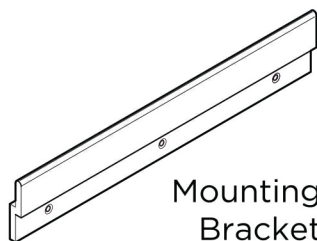

Mounting
Bracket



NOTE: Determine overall mirror dimensions before proceeding to installation.

*All dimensions & specifications are approximate and subject to change without notice.

ELECTRIC CONNECTIONS

ALL WIRING SHOULD BE DONE BY A QUALIFIED LICENCED ELECTRICIAN



WARNING: Shut off power before wiring the mirror.



WARNING: An Electrical option mirror must be wired to a 20 Amp GFI (Ground Fault Interrupter) protected circuit when used in bathrooms and all other locations required by the National Electric Code.



WARNING: This mirror must be connected to a grounded, metal permanent wiring system or an equipment-grounding conductor must be run with the circuit conductors and connected to the equipment grounding terminal or lead on the mirror.



CAUTION: Requires 120 VAC 20 Amp GFI protected circuit.

The electric wire comes through the access hole in the back of the mirror.

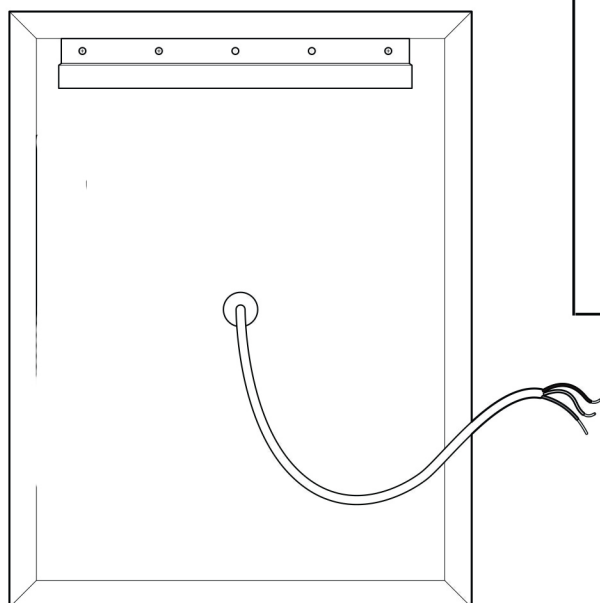

Electric wiring: Be sure to provide enough wire to make the proper and safe connection to the Field/Power.

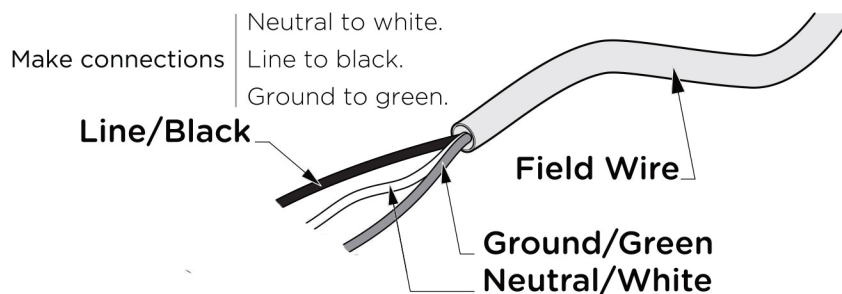

MIRROR FEATURES

Ip44 rated Frame/backplate
5mm copper free silver mirror
High output LED lighting:
CRI 90+, 1950LM, 4000-4500K CCT, Ip65
Dimmable touch switch for surface LED
Tri-Color LED light; Blue-Cold 6500kelvin
Yellow-Warm 2700kelvin
White-Mix 4600kelvin
Defogger with touch switch
Digital clock

INSTALLATION INSTRUCTIONS

- 1** Measure the distance between the bottom of the mirror and point **a**.

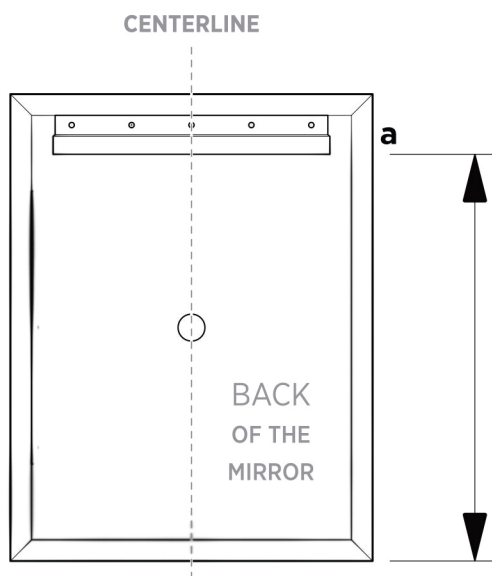

WARNING:
Mounting bracket must be attached to furring strip/channel or wall stud.

- 2** Draw a horizontal line from the point **a** using a level.

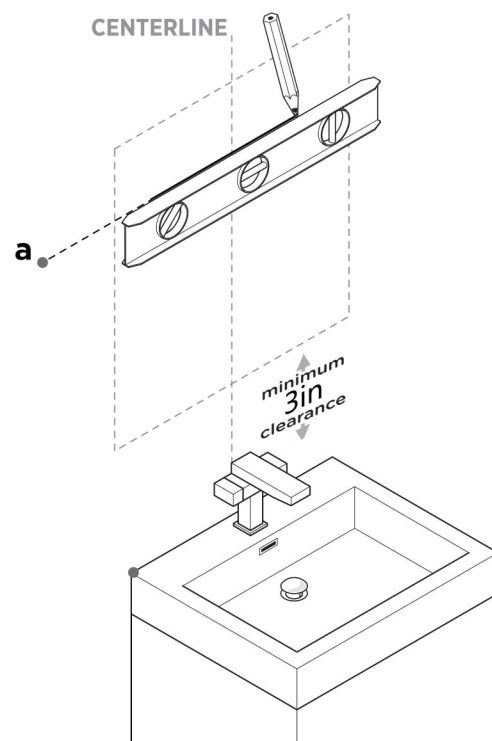

- 3** Attach the mounting bracket to the wall.

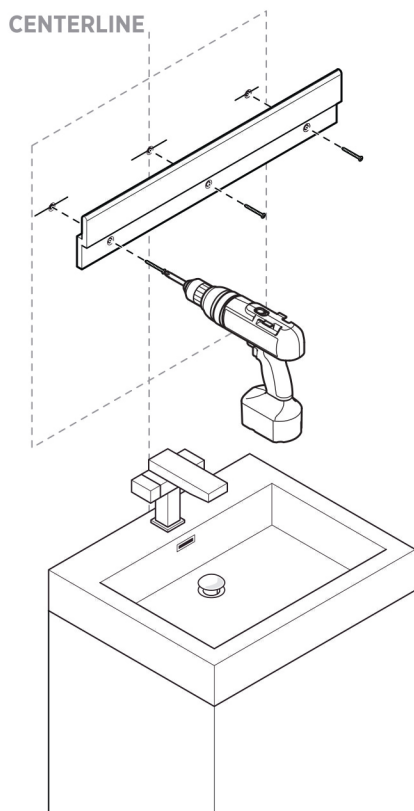

- 4** Connect the Hard Wire to power line.

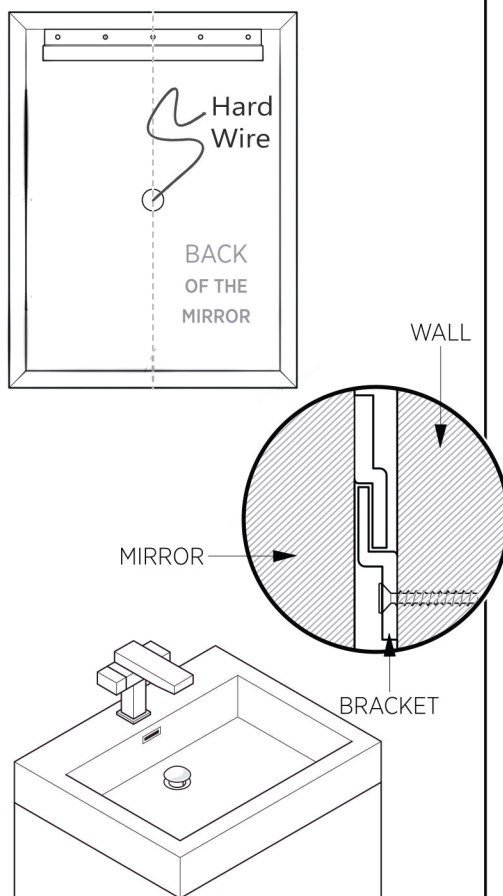

- 5** Hang the mirror on the bracket.

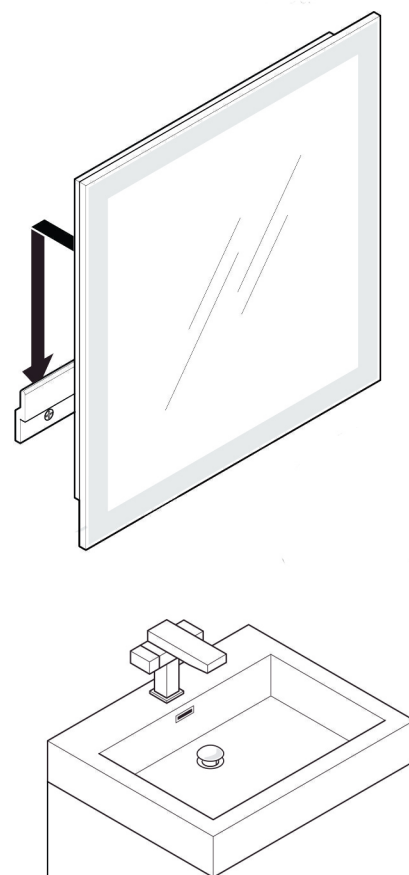

Defogger and Dimmer Switch

Touch the Defogger button in order to turn the heating mechanism on.

Touch the Dimmer/On button in order to turn the light strips on.

Touch the button again to switch between Warm, Cold, and Neutral light.

Touch and Hold the button in order to dim the currently selected light.

How to Customize the Digital Clock

Facing the mirror place your fingers under the frame of the mirror, find the clock button.

Press and hold the button to engage the clock's program mode.

In program mode, the clock will go through 4 number fields with a 3 second break inbetween.

To set the time, press the button again while the number is flashing.