

DESCRIPTION:

Westbrass decorative ASB DUAL OUTLET is a simple and convenient remote on/off air switch. The unit plugs into any standard household wall receptacle. Any 120V, 1HP motor can be plugged directly into either of the MT 951 receptacles. Pressing a remote AIR BUTTON will alternately activate or deactivate two pieces of equipment.

BUTTON CONTROL DISTANCE STANDARD:

#4	#10	#15
n/a	15ft	15ft

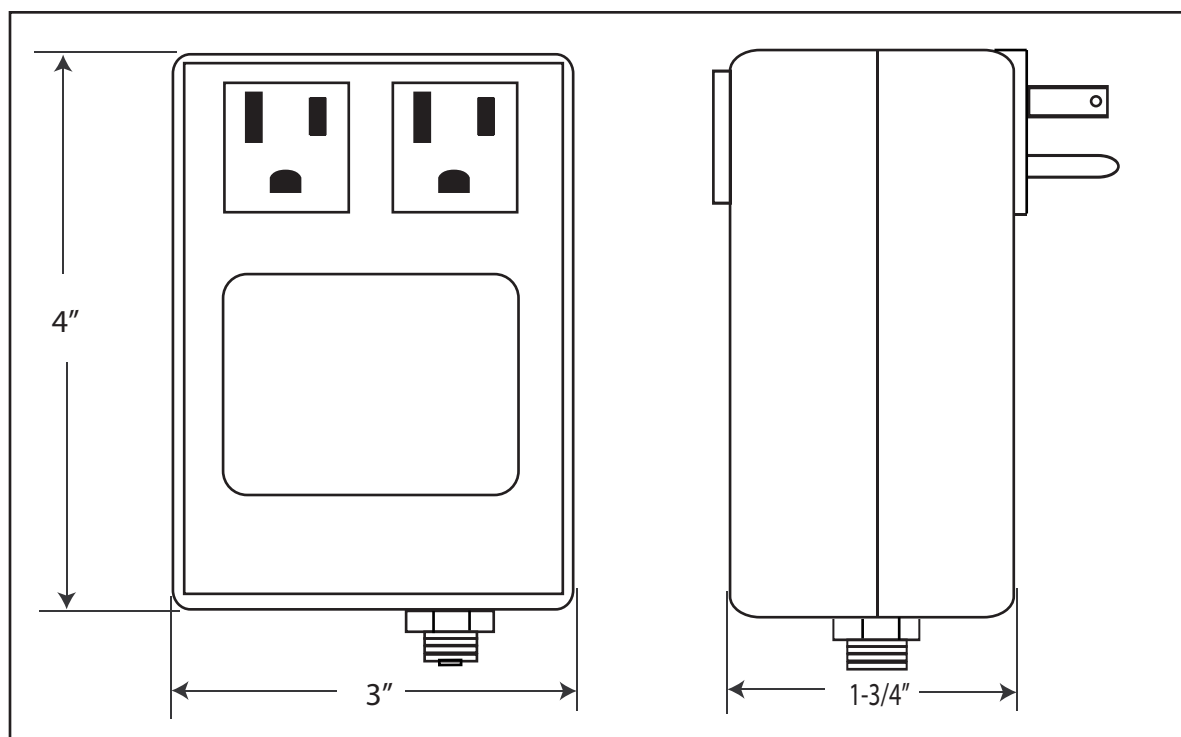

TYPICAL INSTALLATION:

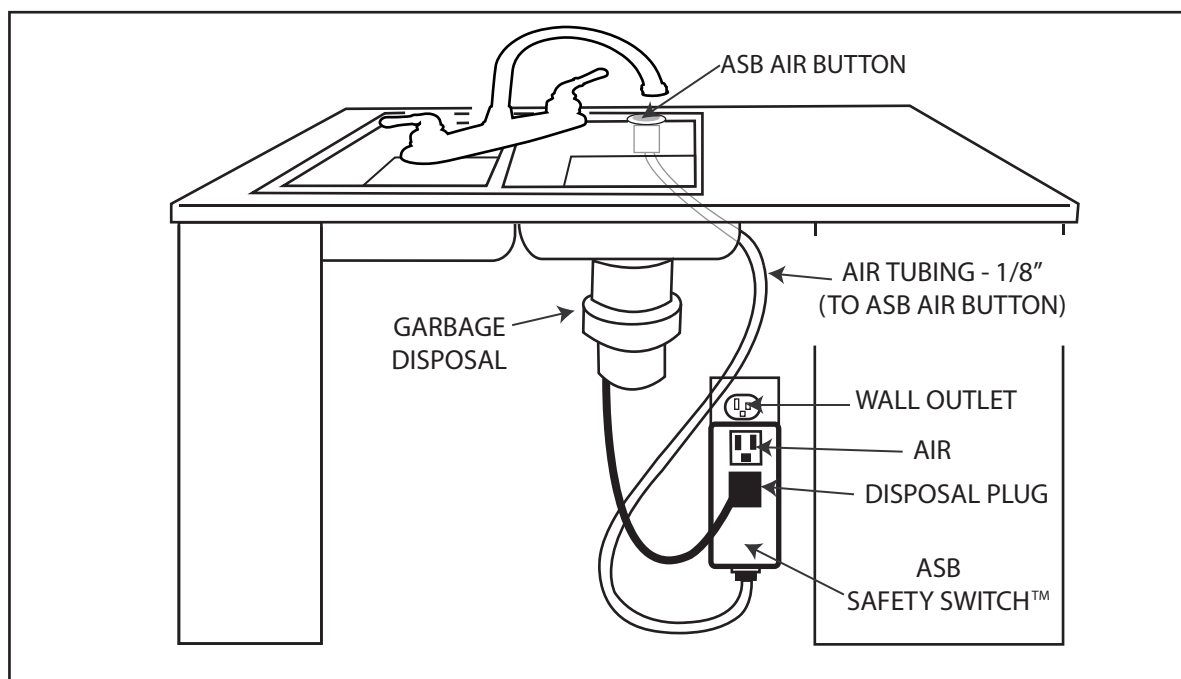

READ AND SAVE THESE INSTRUCTIONS

WARRANTY

SENCOR ELECTRICAL CO.,LTD warrants its products to be free from defects in workmanship and material under normal use and conditions for a period of one year from the date of original manufacture. Should repair be required by reason of any defect or malfunction during the warranty period, SENCOR ELECTRICAL CO.,LTD will repair, or at their discretion, replace this product without charge, subject to verification of the defect or malfunction, upon delivery of the product to the attention of:

The Westbrass Company
2429 E. Olympic Blvd.
Los Angeles, CA 90021

If repair is required after the expiration date of the warranty period, SENCOR ELECTRICAL CO.,LTD will repair this product and bill for any necessary replacement part, shipping and handling.

This warranty is void if:

- 1) the unit is not installed per instructions;
- 2) is hooked up to improper voltage;
- 3) is subjected to chemical corrosion;
- 4) is mechanically or electrically altered in any way;
- 5) is subjected to water or immersion;
- 6) contacts show evidence of short circulating, or the unit has been visibly damaged by accident or misuse or which been damaged by wind, rain, lightening, freezing or other cause; or upon which the serial number or manufacture date has been altered, effaced or removed. There is a charge for replacement parts if the defective unit is returned for any of the reasons listed above.

SENCOR ELECTRICAL CO.,LTD shall not be liable for any inconvenience, loss of time, or incidental expenses incurred. SENCOR ELECTRICAL CO.,LTD shall not be liable for any labor charges associated with the removal or re-installation of any so-claimed defective products.

This is the only warranty expressed or implied by SENCOR ELECTRICAL CO.,LTD Warranties implied under state law, including any implied warranty or merchantability or fitness for a particular purpose, shall be limited to one year from the date of manufacture.

SENCOR ELECTRICAL CO.,LTD disclaims and liability for any incidental or consequential damages.

Ship as follows:

1. Pack the unit in a well padded, heavy corrugated box.
2. Include name, return address, and daytime phone number along with a short description of problem with control.
3. Mail the unit, prepaid, to the above address.

Some states do not allow the exclusion or limitation of incidental or consequential damages, therefore the above limitation may not apply to you.