

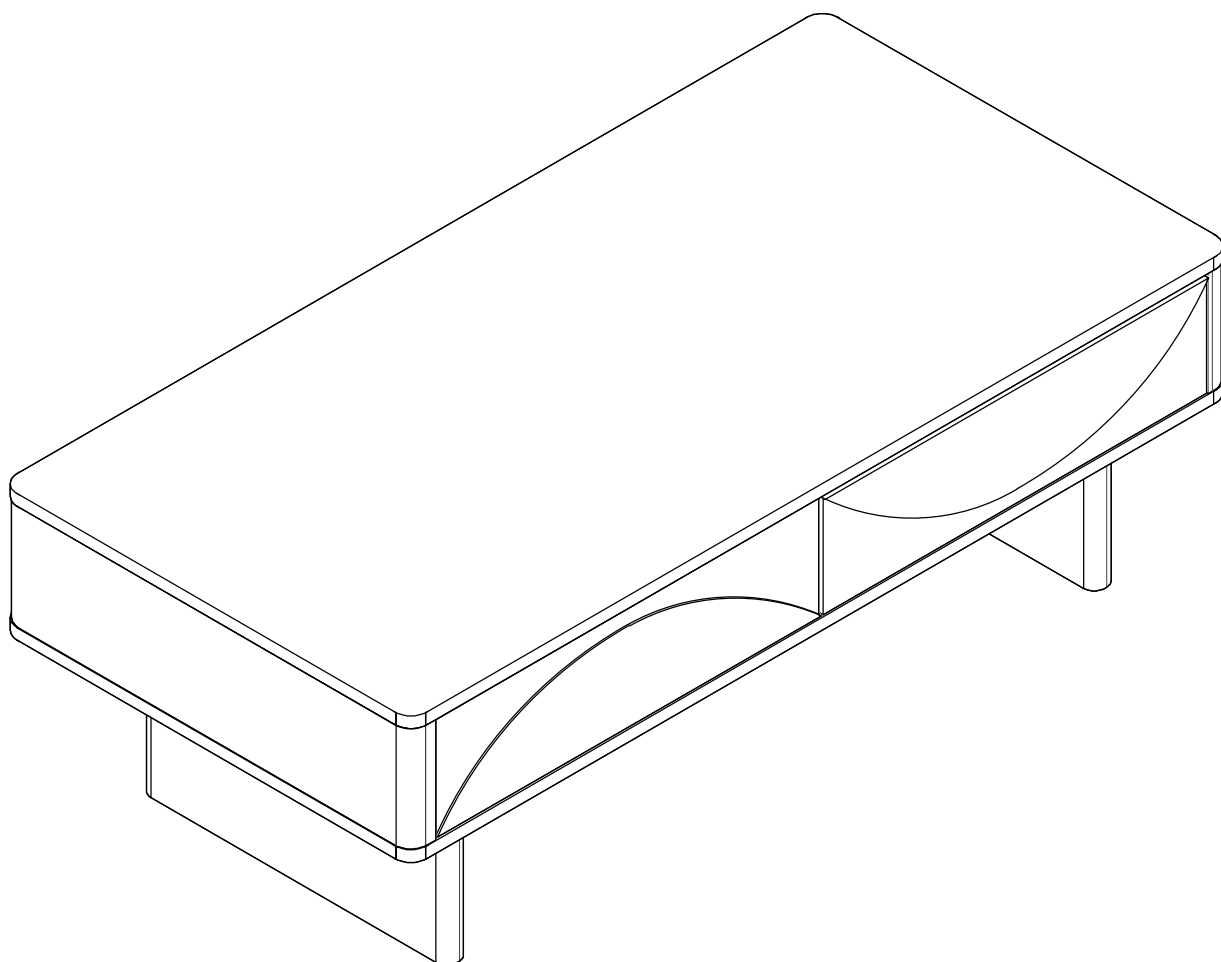

CT020





STOP!

Before beginning the assembly process,
ensure all boxes and parts have been delivered.

FOR BEST RESULTS:

- Do not throw away packaging materials until assembly is complete.
- Assemble item on a soft surface, such as cardboard or carpet, to protect finish.
- Proper assembly requires two people.

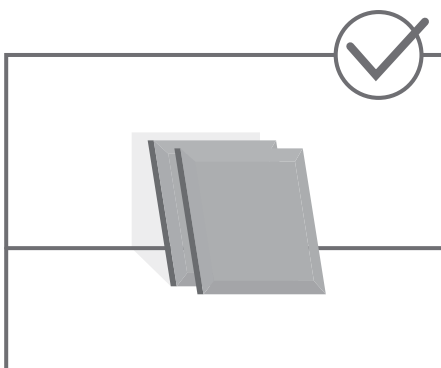
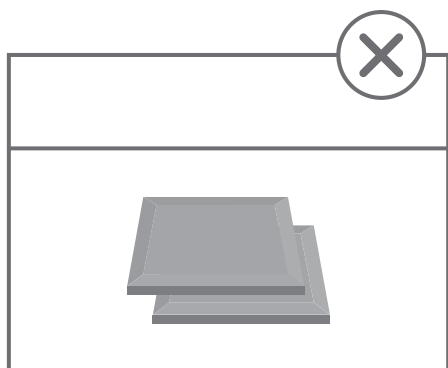
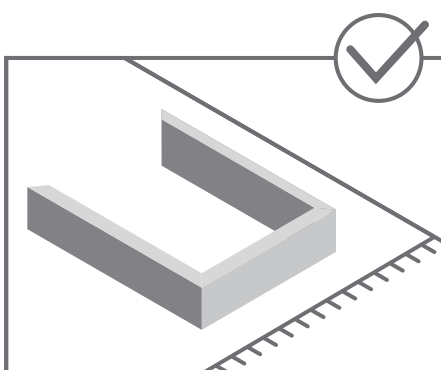
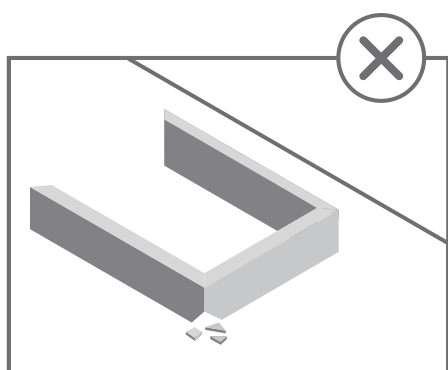

TOOLS REQUIRED

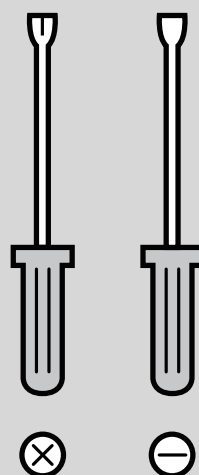

View our assembly video online:
WWW.MANHATTANCOMFORT.COM



Stuck? Question? We are here to help.
tel: 908-888-0818
e-mail: help@manhattancomfort.com

Support Site



Included in this package:

BOX 01/02

1:TOP(1)
2:BOTTOM(1)
3:LEFT END(1)
4:RIGHT END(1)
5:SMALL MIDDLE UPRIGHT(1)
7:CONNECTING OF LEGS(1)
8:BIG MIDDLE UPRIGHT(1)
11:DRAWER BACK(2)
12:DRAWER LEFT(2)
13:DRAWER RIGHT(2)

BOX 02/02

6:LEFT&RIGHT LEG(2)
9:LEFT DRAWER FRONT(1)
10:RIGHT DRAWER FRONT(1)
14:DRAWER BOTTOM(2)
HARDWARE ARE IN BOX 02/02

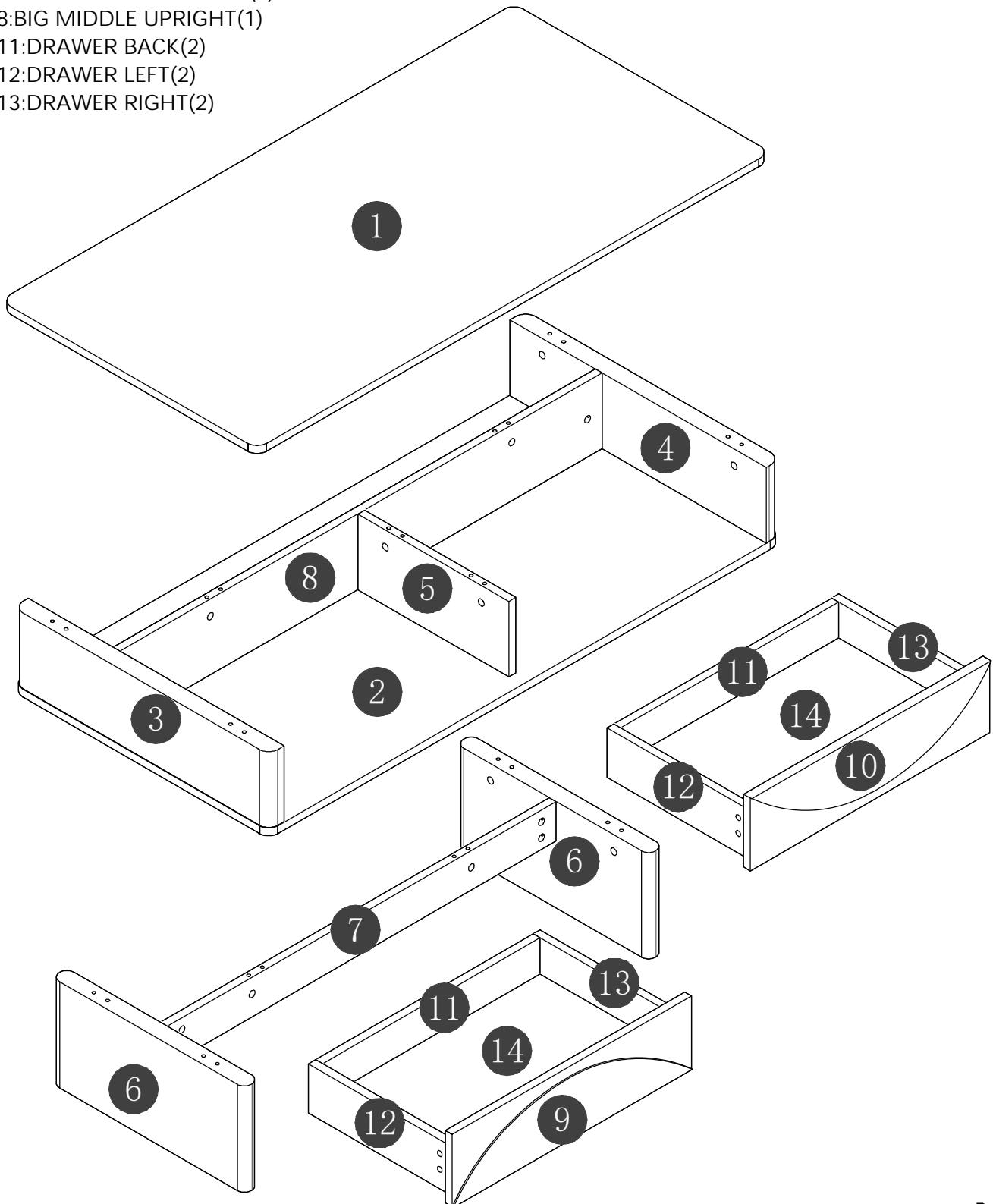

Hardware Identification

A:BOLT-36pcs
M6*40mm

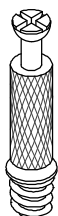

B:WOODDOWEL-22pcs
ø8*30mm

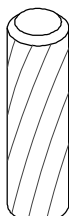

C:GROMMET-36pcs
ø15*12mm

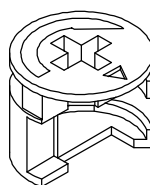

D:PVC STICKER-36pcs
ø21mm



N:DRAWER SLIDE-2 pair

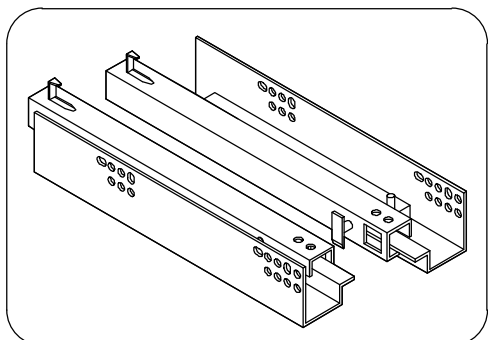

H:SPANNER-1pcs
M4



Q:BOLT-8pcs
ø7*50mm

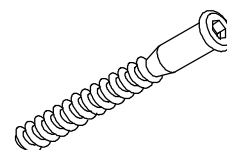

V1:SCREWS-8pcs
M3.5*12mm



Step 1

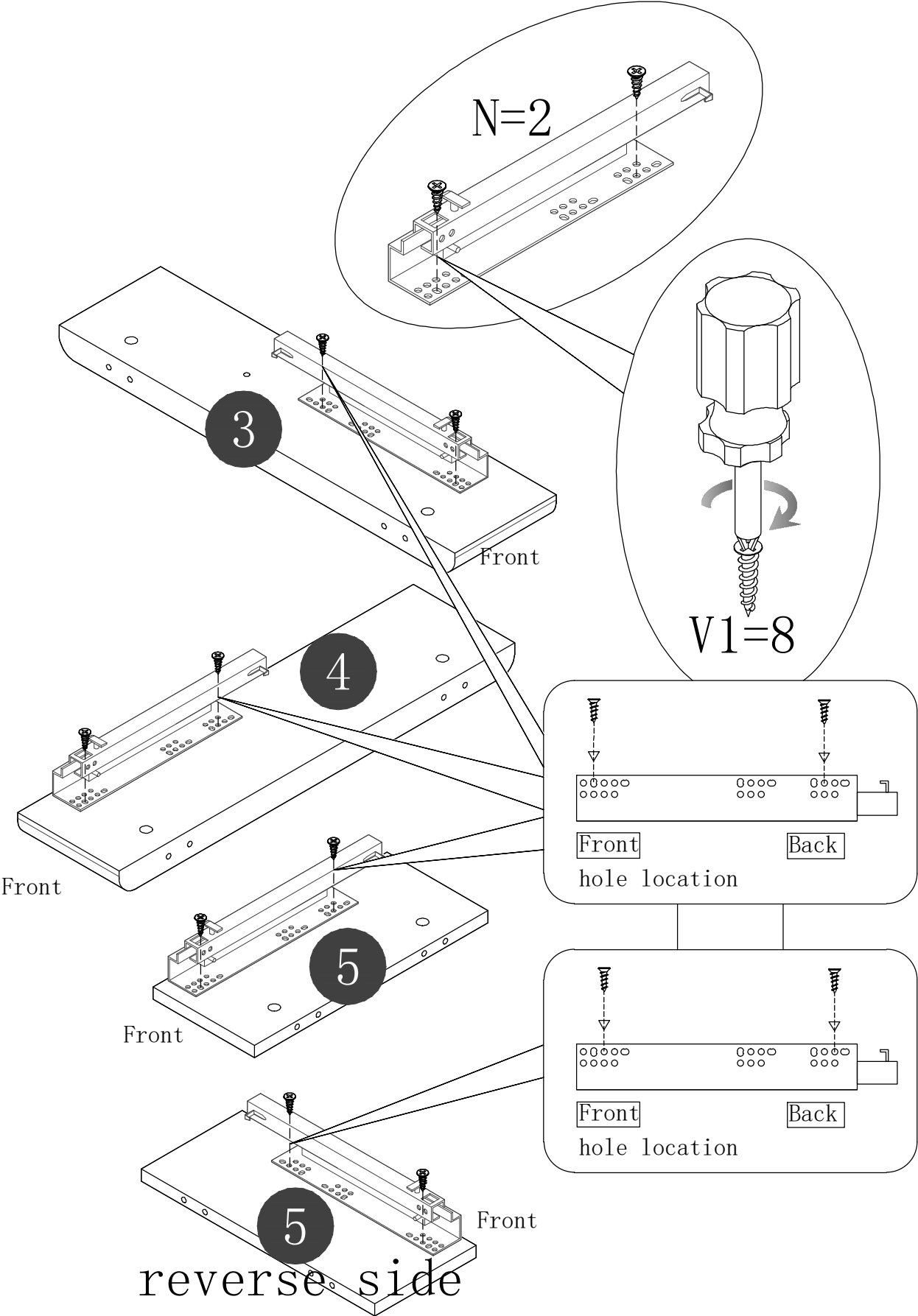

Step 2

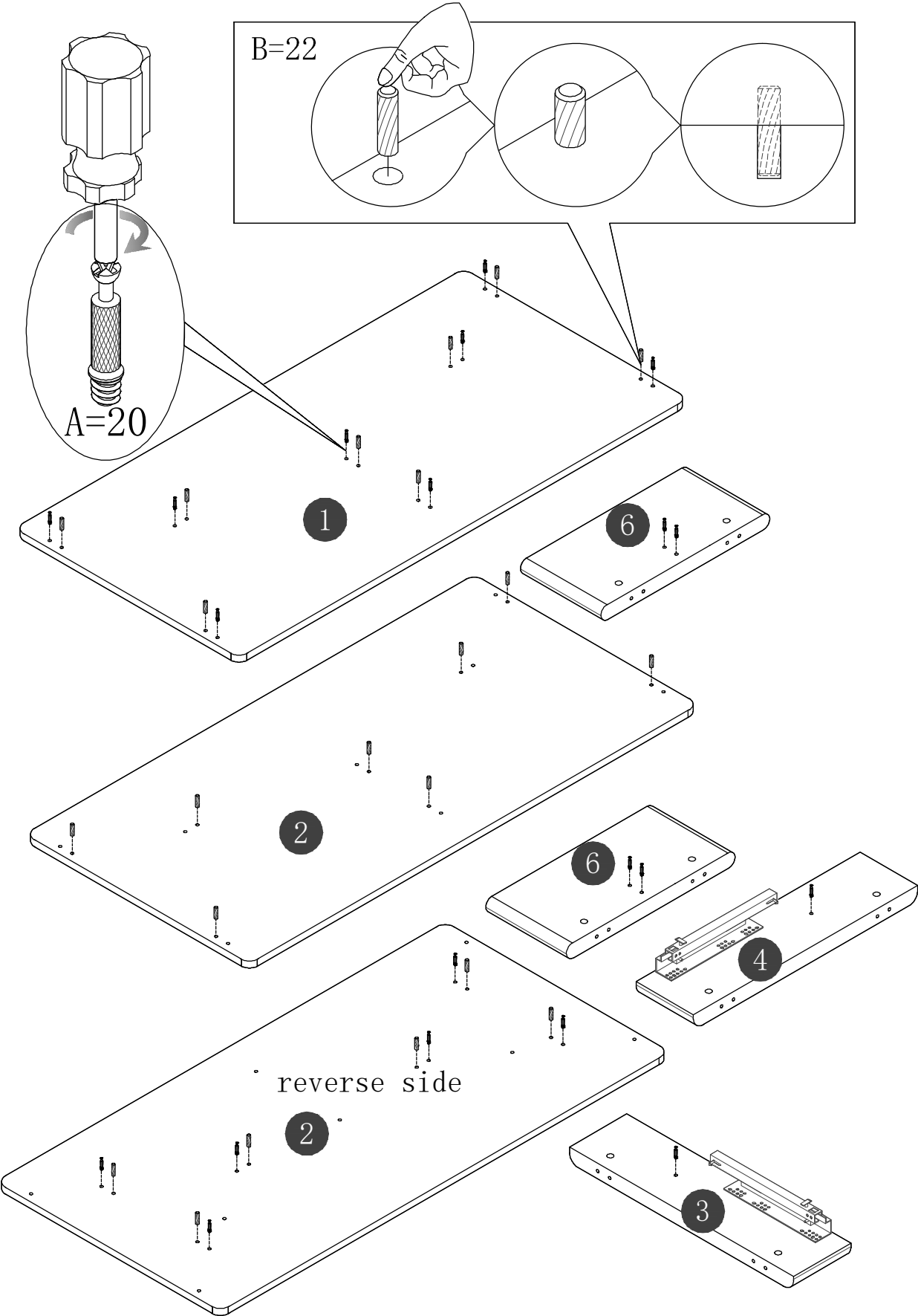

Step 3

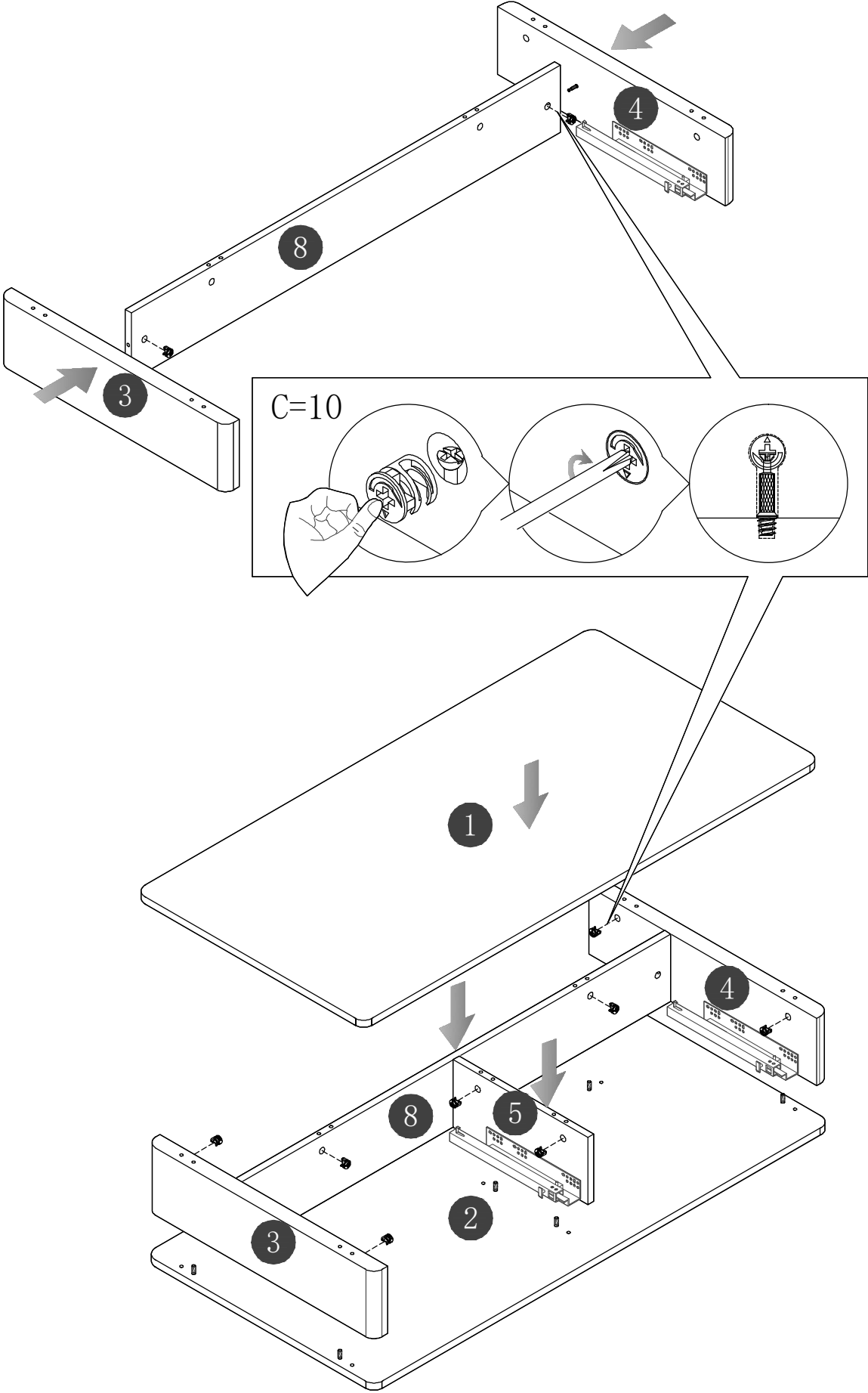

Step 4

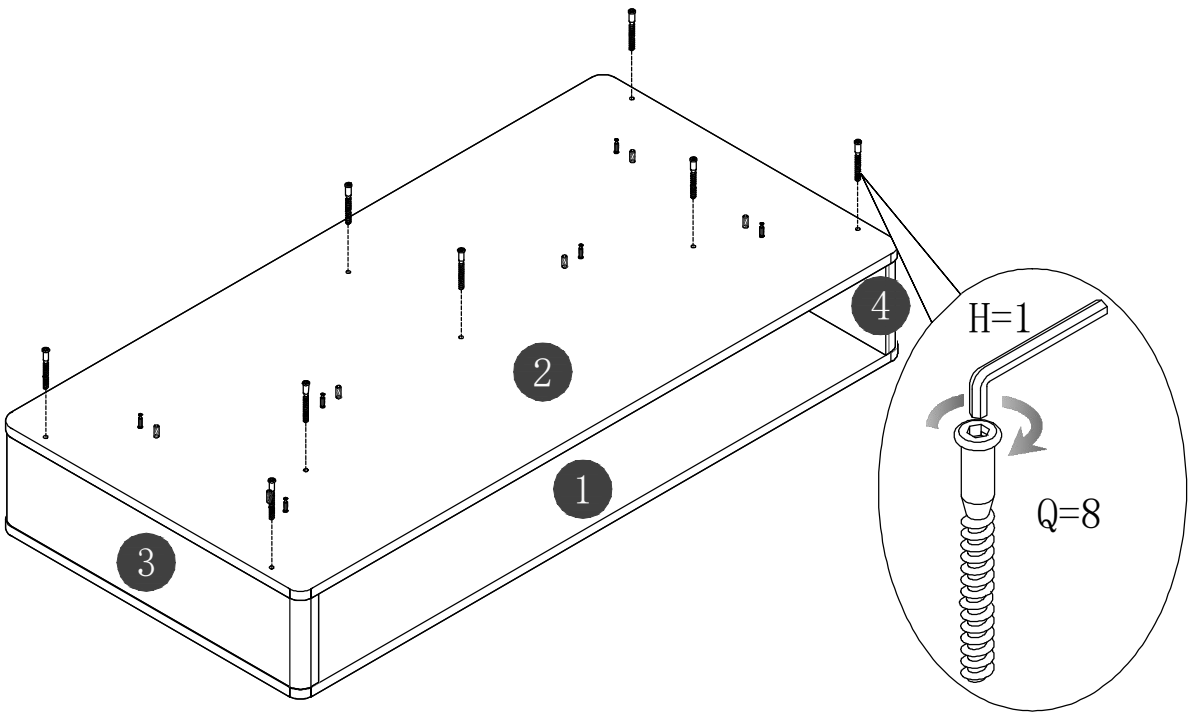

Step 5

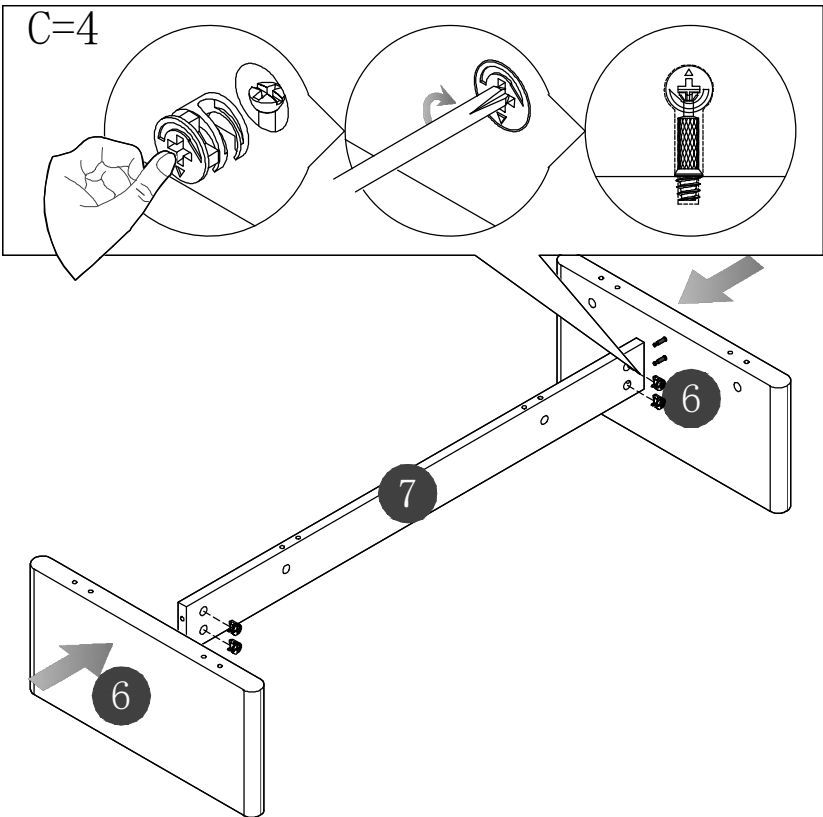

Step 6

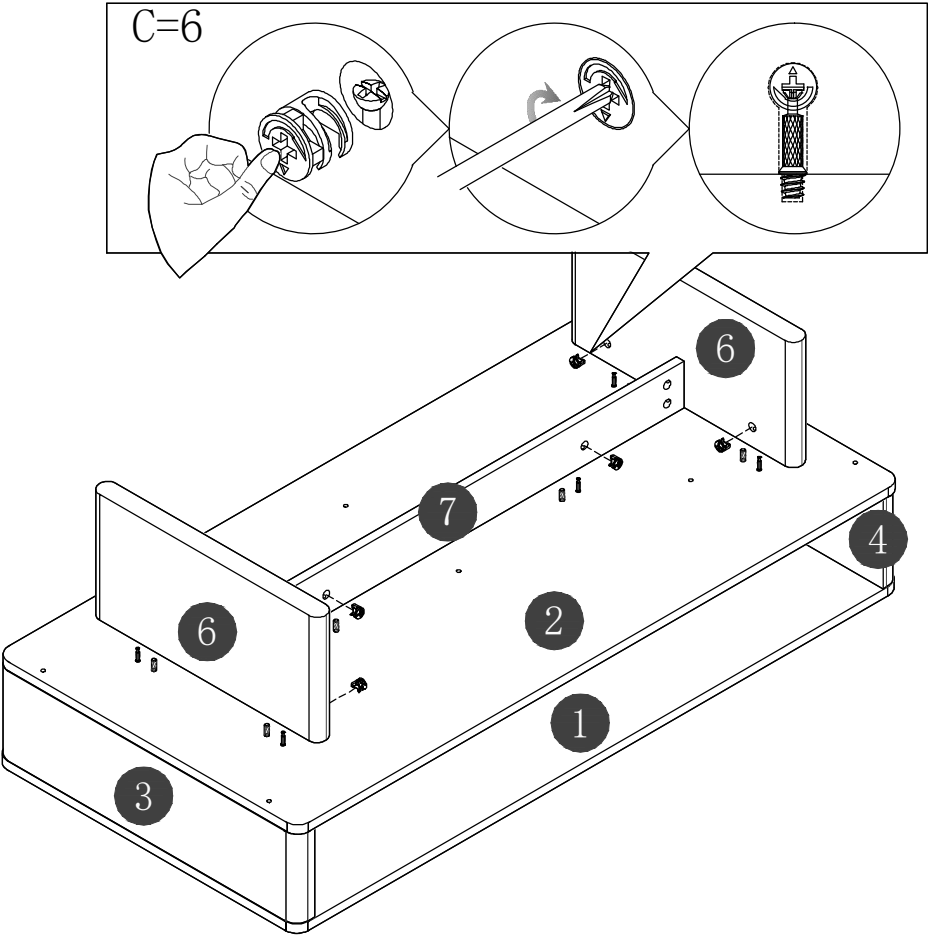

Step 7

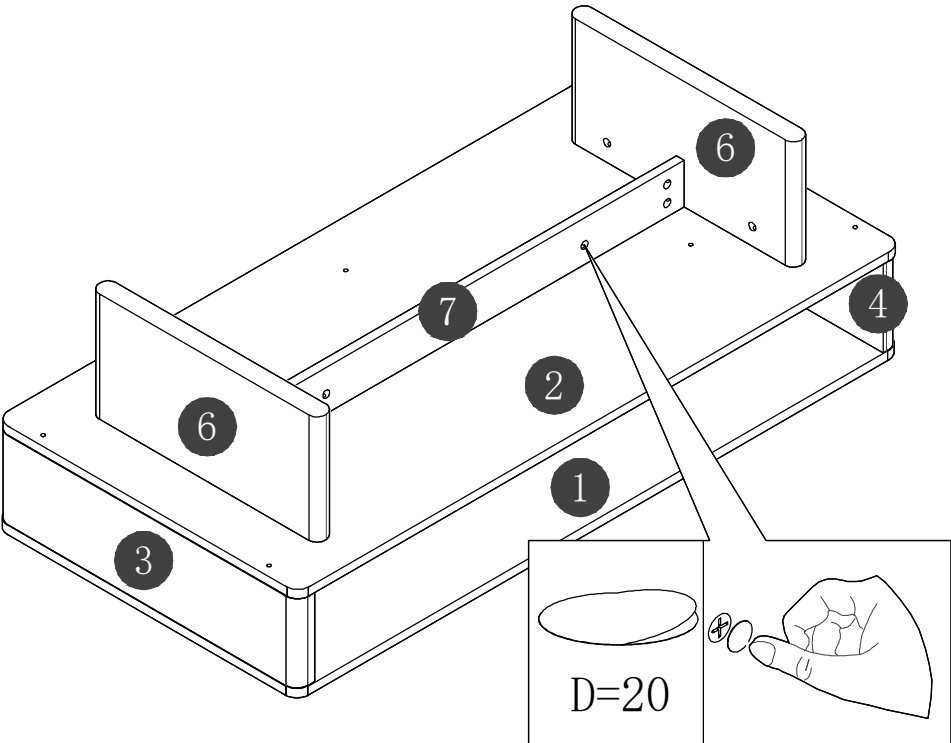

Step 8

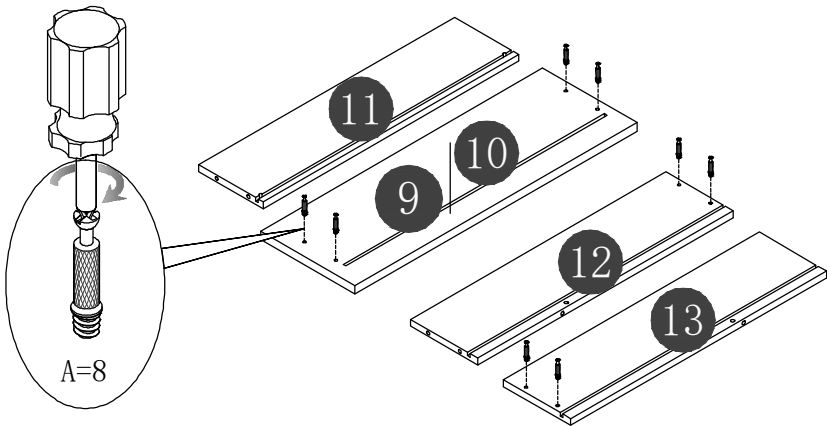

X2

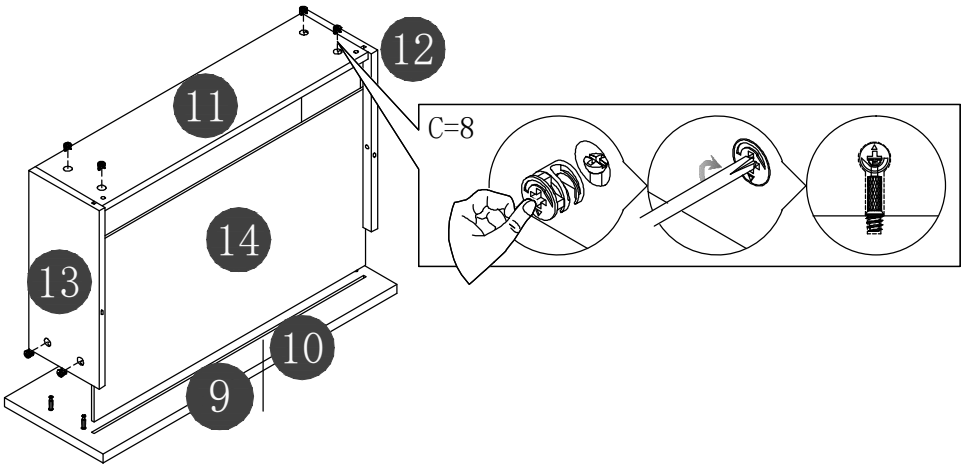

X2

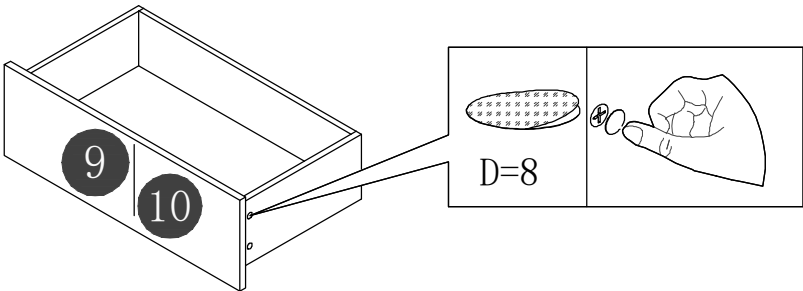

X2

Step 9

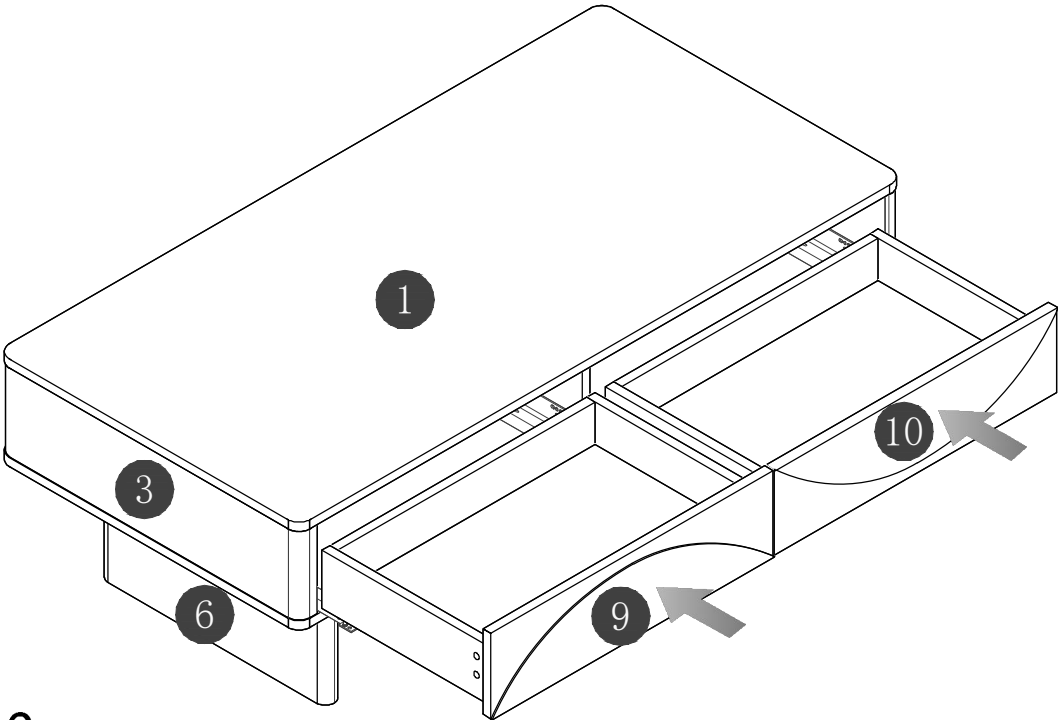

Step 10

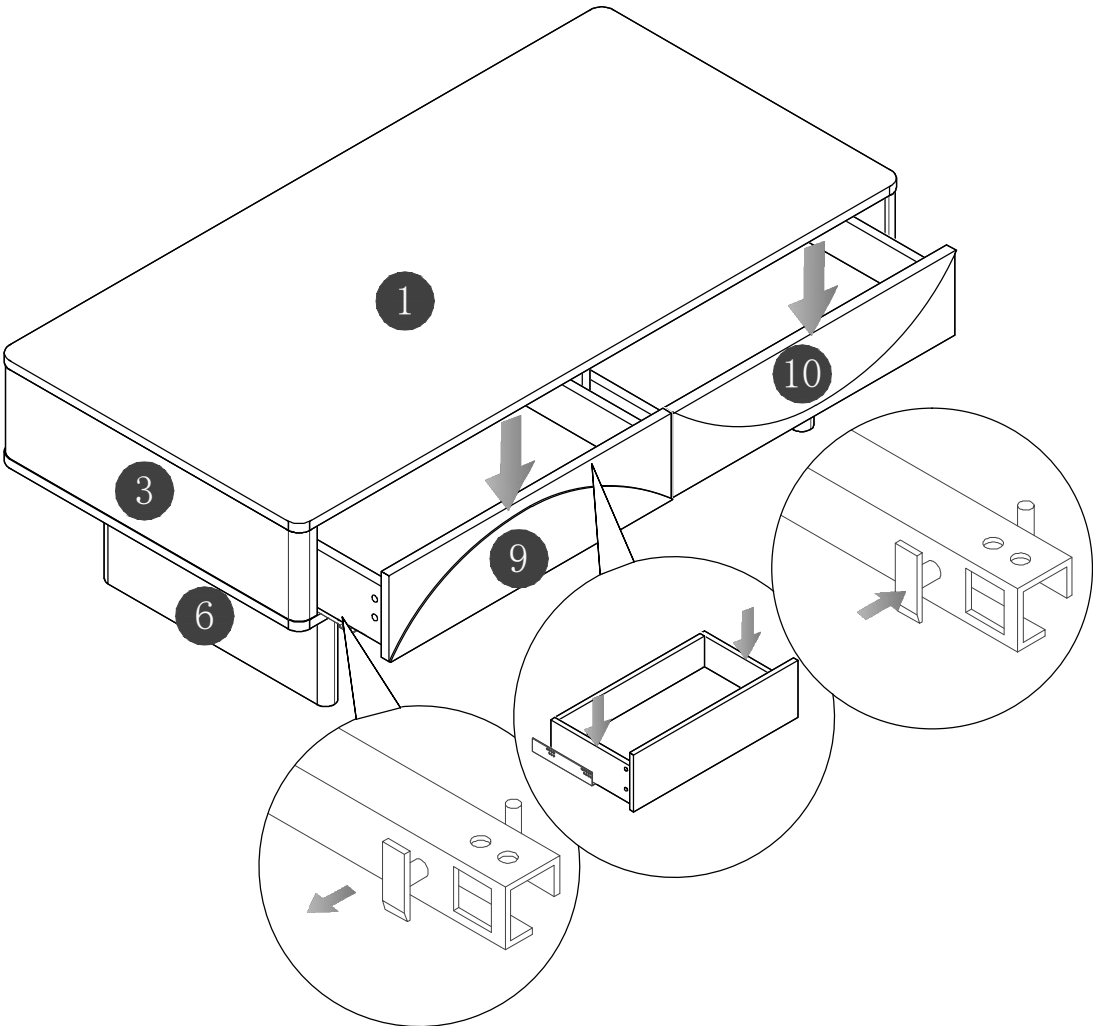

Step 11

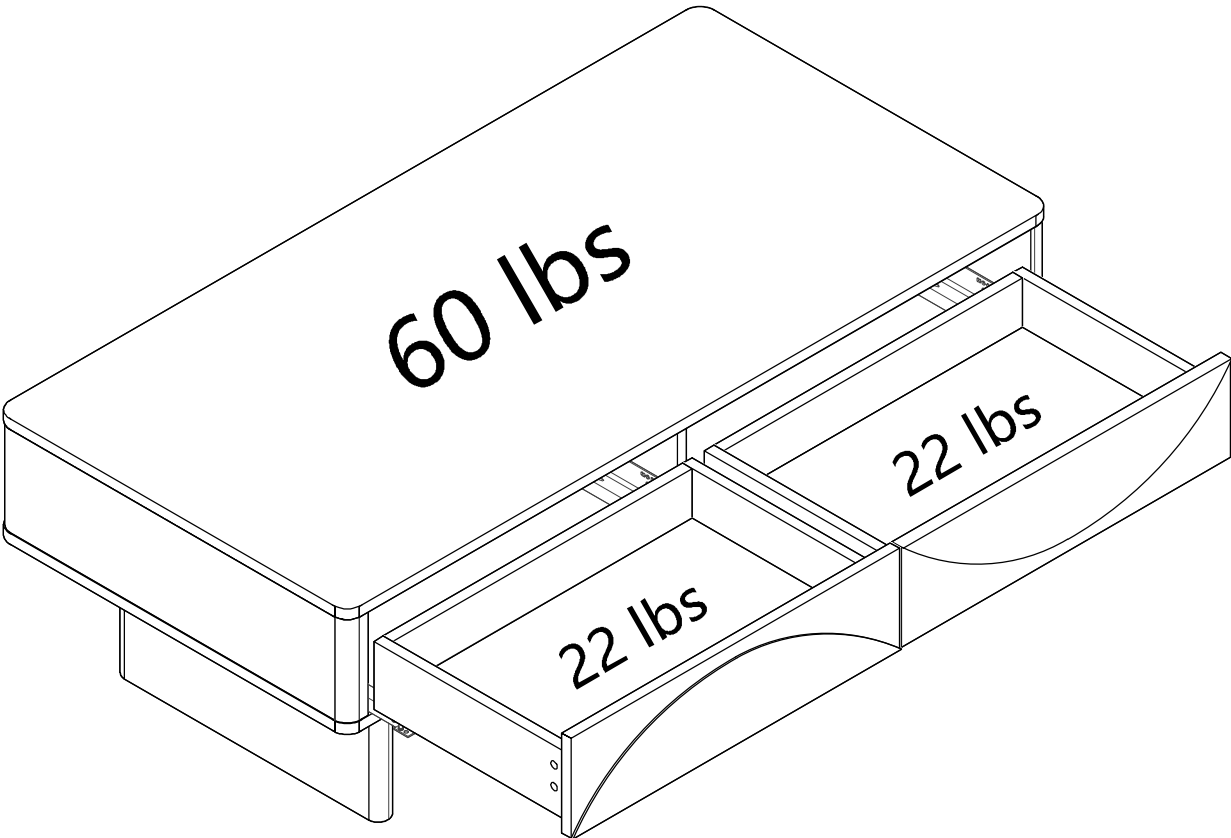



WARRANTY POLICY

All Manhattan Comfort furniture products are warranted, to the original purchaser at the time of purchase and for a period of 30 days thereafter.

Our warranty is limited to new products purchased in factory sealed cartons. This warranty is valid in the United States of America and Canada.

In order to provide you with timely assistance, please thoroughly inspect your furniture for missing or defective parts immediately after opening the carton.

Manhattan Comfort offers a 30-day parts replacement warranty on all items.

Our furniture products are not intended for outdoor use.

THE WARRANTY DOES NOT COVER:

- Defects/damages by improper assembly or disassembly.
- Defects/damages caused by inappropriate use of the furniture.



319 Ridge Rd. Dayton, NJ 08810

908-888-0818