

Solar Light

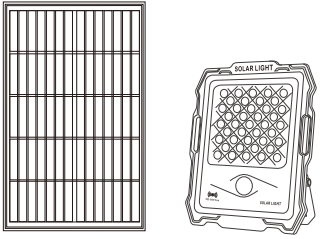

Product Overview

Solar light is an electric lamp which converts light energy into electricity by solar panels. The advantage of the product is no wiring, easy to installation and without electricity. In the day, solar panel absorbs the sun's light and convert to electricity and store in batteries. At night, the light will turn on automatically.

Operating Manual (Camera Edition)

Operating Instruction 1

Packing List

1. Lamp Cap	2. Solar Panel	3. Remote control
4. Installing Support	5. Screws	6. Operating Manual

Light-control detection.

Installing 2

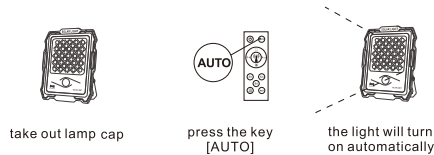

Then, tightening the waterproof wire and placing the solar panel towards the sunlight, the light will turn off automatically and the charging indicator will flash regularly. It means the light control function is working well.

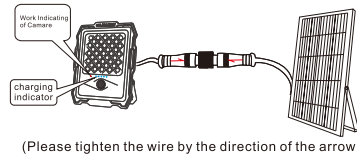

Key Instructions of Remote Control 3

AUTO mode.

Tightening the waterproof wire and pressing the key "AUTO", the light will automatically turn on for 4 hours in the dark. After 4 hours of light-operated mode, it will switch to radar mode. (The remote control has memory function, you can set only once)

Remote-control. The specific functions are shown below.

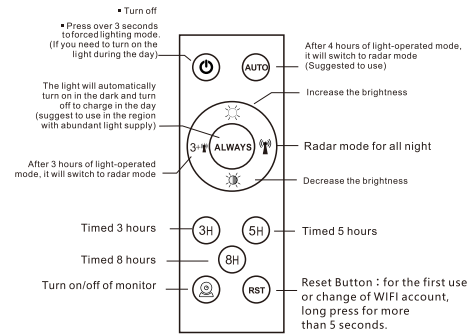

Important Notification

1. Please do not accept 220V ac to avoid damaging the solar lamp.
2. Please ensure the installation is stable to avoid hurting others.
3. Please do not disassemble the lamp to avoid affecting the warranty.
4. Please clean the dust on the solar panel surface every 3 months to avoid affecting the power generation efficiency.

Monitor Configure Network 4

ONE: Connect WIFI
Connect WIFI with your mobile phone, and make sure the network signal is good.
(Tips: Please make sure the lamp, cellphone and WIFI router are within 3 meters during configuring network.)



Scan and download APP

TWO: Download APP
Scan QR code at right to get APP, or search "TuyaSmart" in App Store.
(Tips: available for Android and IOS)

THREE: Register APP
Please use the cellphone number or email address to register an account in "Tuya" APP.



FOUR: Turn on the monitor switch

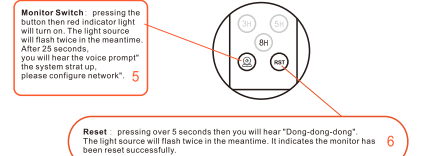

Monitor Configure Network 5

FIVE: Add Device

Open the APP and follow the steps below

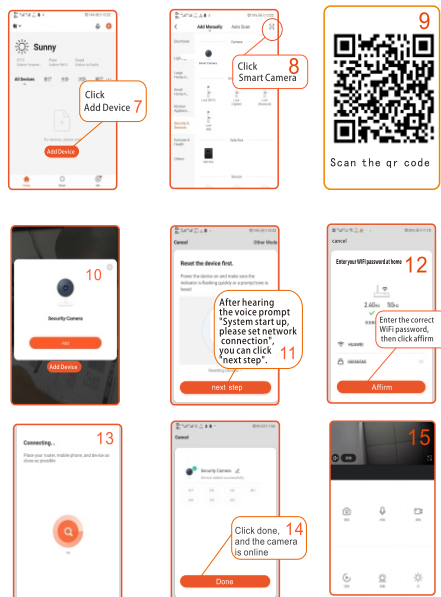

Installing 6

Fix the product on the wall with expansion screws. The installation height is suggested to be 3-5 meters.



Make sure the solar panels are installed at the correct angle and it will not be blocked by obstacles.

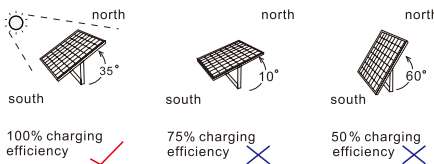

Tips:

1. Installation direction of the solar panel is 5-10 degrees south to west, an angle of 35 degrees with the horizontal place.
2. Please install the solar panel in the sun direction to avoid affecting the power generation efficiency.
3. Please ensure the installation is stable.

Functional Specifications 7

Main Function of APP

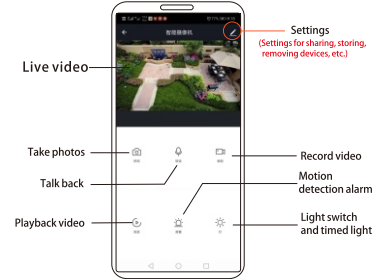

Extensive Functions

Change username. When changes the username, you should remove device in settings. After successfully removed, you can use other username to log in.



Share device. When shares device to others, the shared user should register an account in "Tuya" APP. The master user can add the account of the shared user in settings.

Important Notification 8

Storage settings. Recording mode includes "event recording" and "non-stop". You can select different mode according to your needs. It is suggested to select "event recording" mode because it can save electricity.

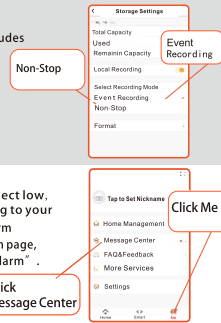

Motion detection alarm. You can select low, medium or high sensitivity according to your needs. Checking motion detection alarm information, please click "Me" in main page, then click "message center" and "Alarm".

Important Notification

1. If changing new WIFI to configure network, please click Reset camera by remote control.
2. At night, the monitor needs to fill-in light during working, it is recommended not to turn off the light.
3. During configuring network, please make sure WIFI signal is good and the WIFI password is entered correctly. When the WIFI signal is weak, the device may be disconnected. At this time, Please remotely restart the camera switch or move the device to an area with good WIFI signal for installation.
4. In order to ensure charging efficiency, the optimal installation direction of the solar panel is 5-10 degrees south to west, with an angle of 30 degrees with the horizontal place. Please install in an unsheltered place.
5. Generating capacity of solar light depends on sunlight in the day. If it is cloudy and rainy, it is recommended to use the remote control to reduce the brightness of the lights to extend the endurance.