

## Features

- Brass construction.
- Brass valve bodies.
- Quarter-turn washerless ceramic disc valves.
- Less drain.
- Standard aerator.
- Variety of handle style options.
- 5-1/4" (133 mm) gooseneck spout.
- For 8" (203 mm) or 16" (406 mm) centers.
- 2.2 gal/min (8.3 l/min) maximum flow rate [max at 60 psi (4.14 bar)].

## Required Products/Accessories

- K-16012-2 Standard Handles for Widespread Base Faucet  
or  
K-16012-3 Cross Handles for Widespread Base Faucet  
or  
K-16012-4 Lever Handles for Widespread Base Faucet  
or  
K-16012-5 Wristblade Handles for Widespread Base Faucet

## Optional Products/Accessories

1160595 .35 gpm Aerator, Medium



## Codes/Standards

ASME A112.18.1/CSA B125.1  
NSF/ANSI 61  
NSF/ANSI 372  
All applicable US Federal and State material regulations  
DOE - Energy Policy Act 1992

## KOHLER® Faucet Lifetime Limited Warranty

See website for detailed warranty information.

## Available Colors/Finishes

*Color tiles intended for reference only.*

### Color Code Description

	CP	Polished Chrome
--	----	-----------------

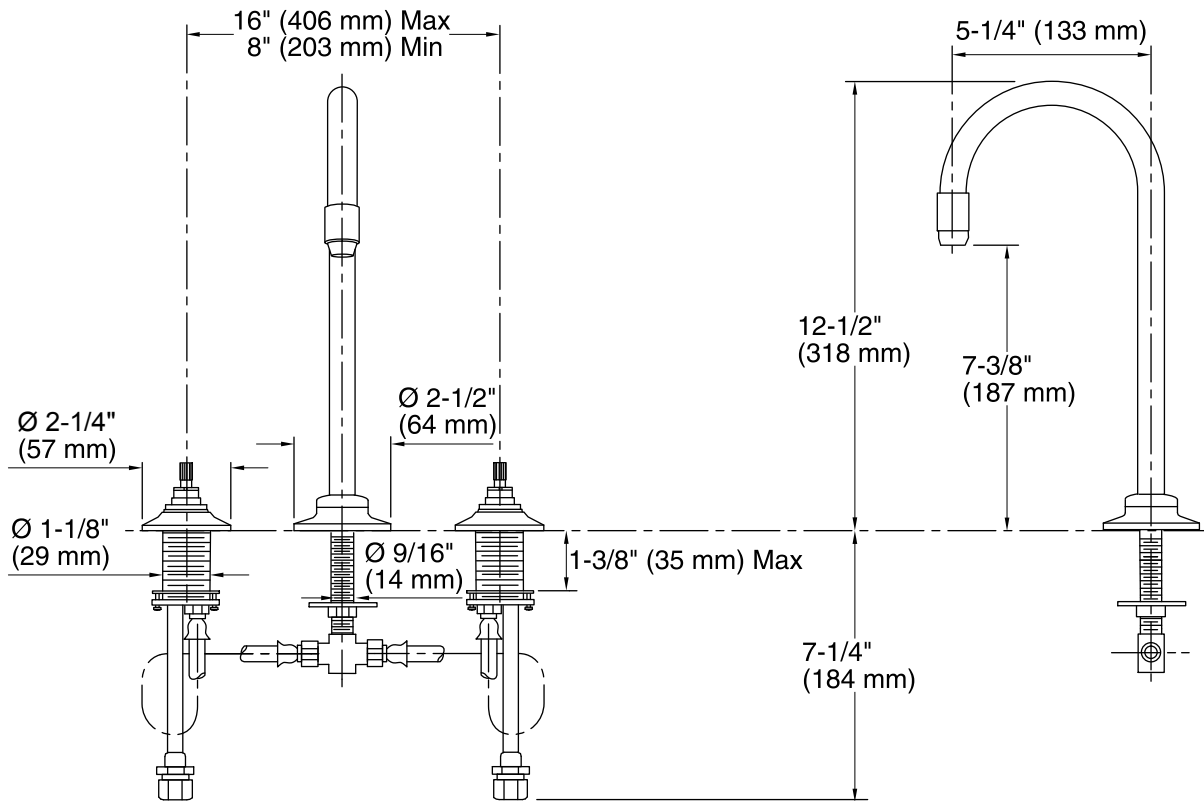

## Technical Information

All product dimensions are nominal.

### Faucet:

Flow rate: 2.2 gal/min (8.3 l/min)

Pressure: 60 psi (4.1 bar)

### Spout:

Spout reach: 5-1/4" (133 mm)

## Notes

Install this product according to the installation guide.