



ASSEMBLY INSTRUCTION

ITEM#:4558-16

DESCRIPTION:4-LAYER SHELF

NO.	PARTS LIST		QTY	HARDWARE LIST			
				NO.	HARDWARE PACK IN	QTY	
A		TOP SHELF	1	1		BOLT M6x30mm	2
				2		BOLT M6x50mm	2
				3		BOLT M6x22mm	6
B		MIDDLE SHELF	2	4		BOLT M6x360mm	2
				5		BOLT M6x380mm	2
				6		FLAT WASHER Ø16xØ7x1.0	4
C		BOTTOM SHELF	1	7		DOWEL Ø6x30	12
				8		ALLEN KEY M4	1
				9		BOLT M6x405mm	2
D		SIDE BOARD	3	10		SCREW M4x37mm	1
				11		METAL PLATE	2
E		METAL CROSS LEG	3	12		ANCHOR	1
				13		GIRDING	1

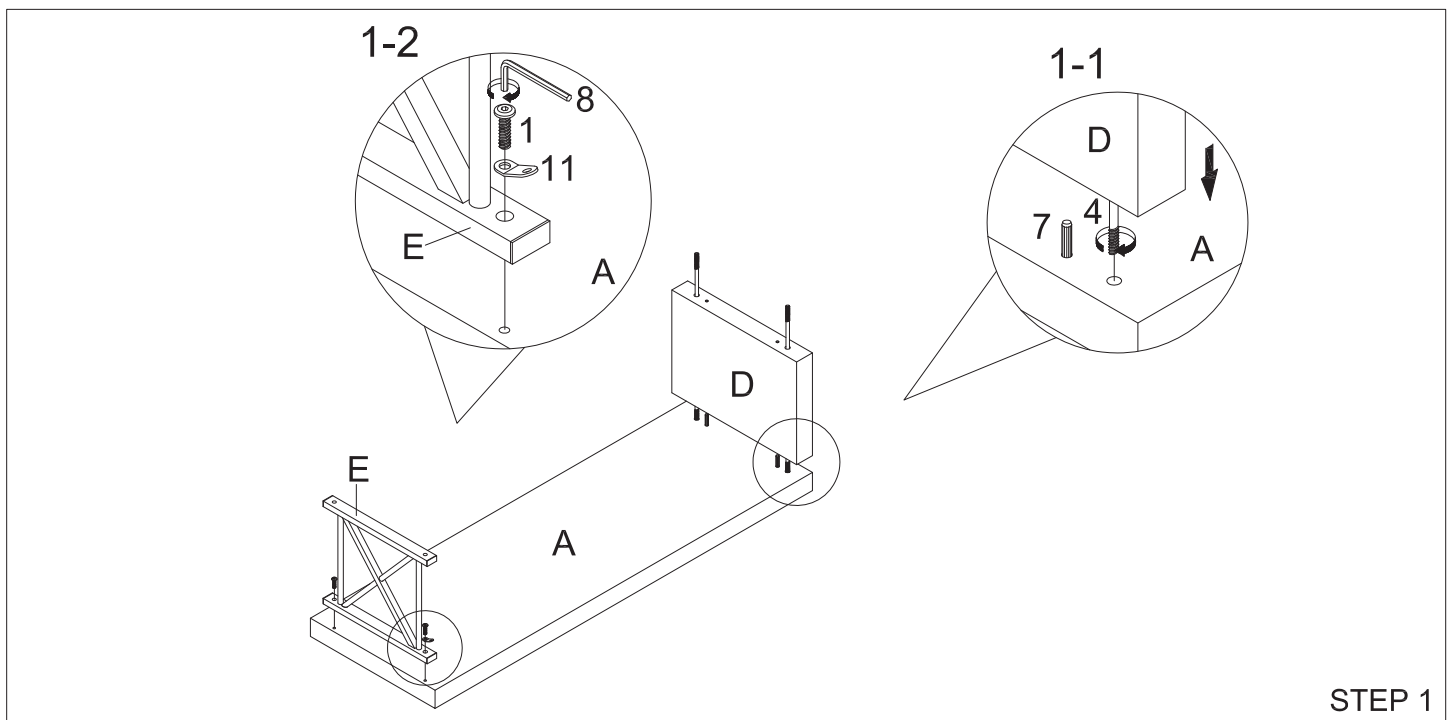

STEP 1

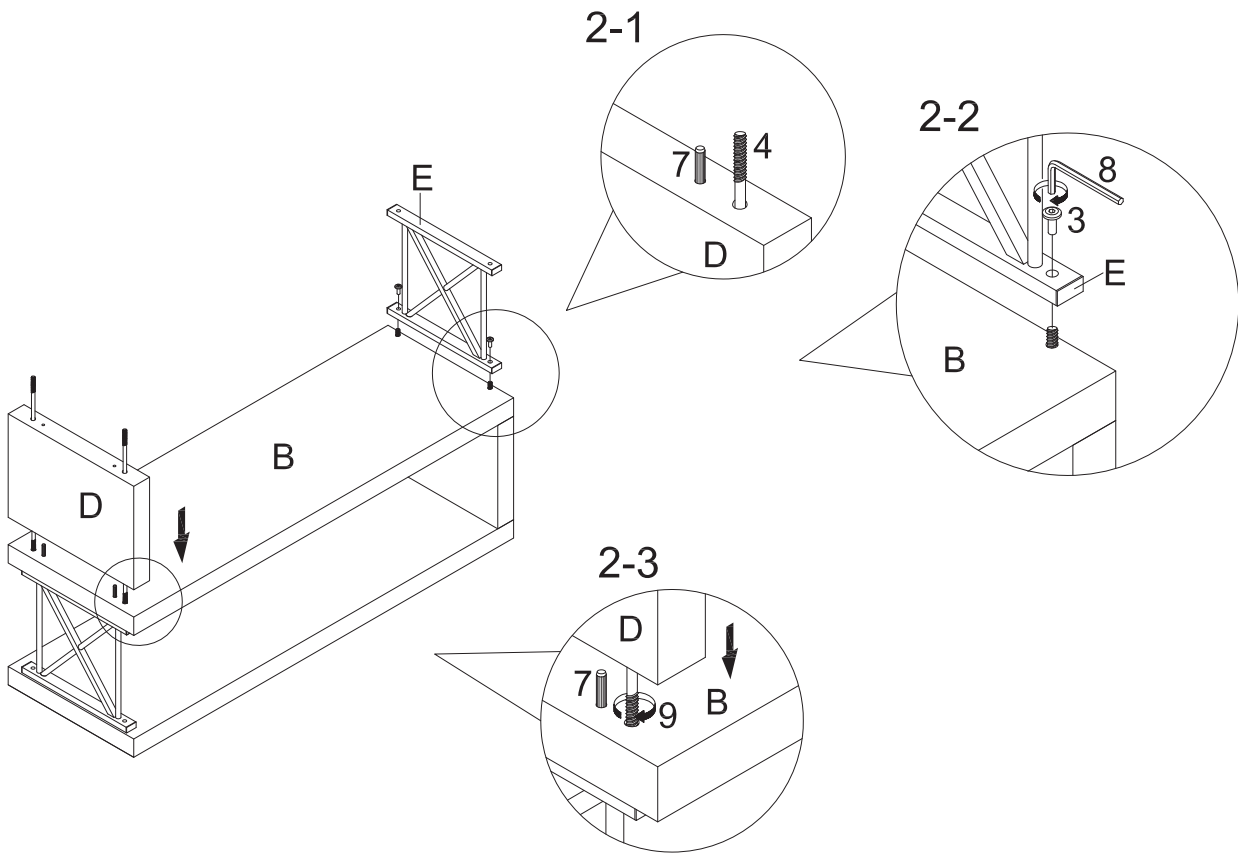

STEP 2

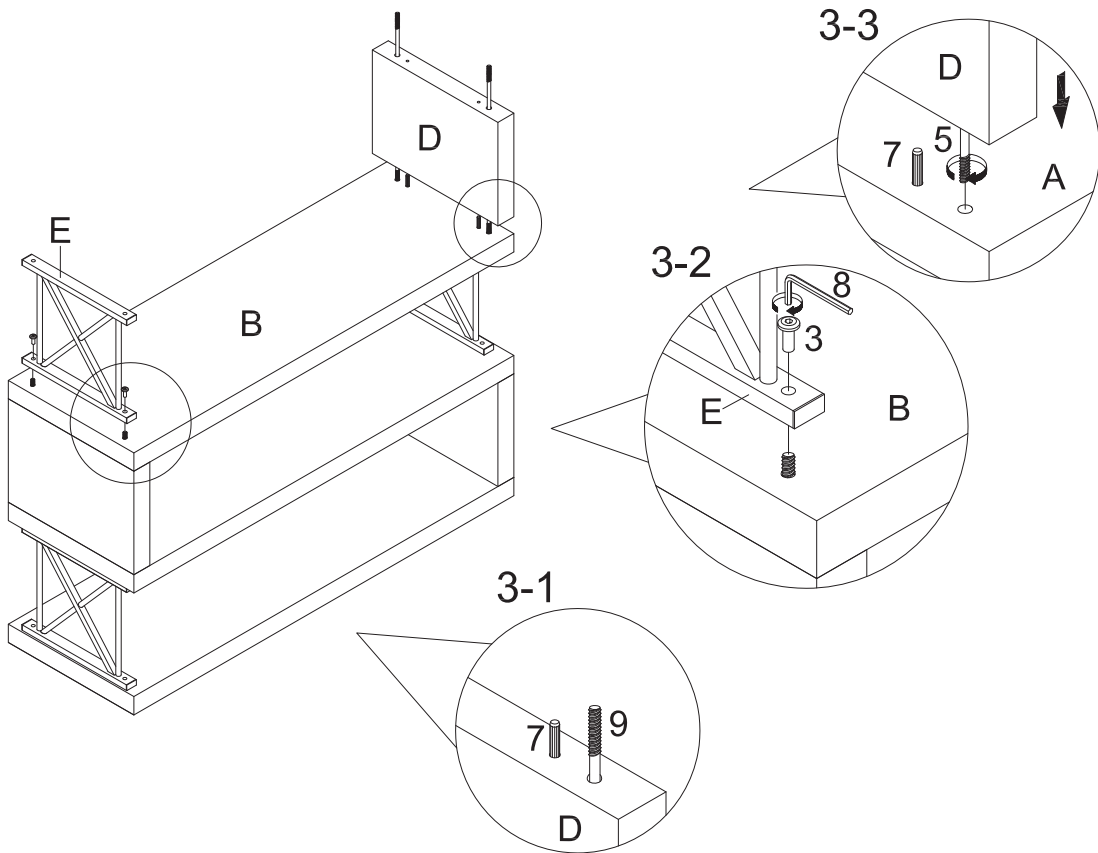

STEP 3



For items use on wooden floor, hard surfaces or carpets, it is recommended to install protective pads under all legs and supports to avoid/prevent from damages/scratches and discoloration

Do not tighten bolts until completely assembled

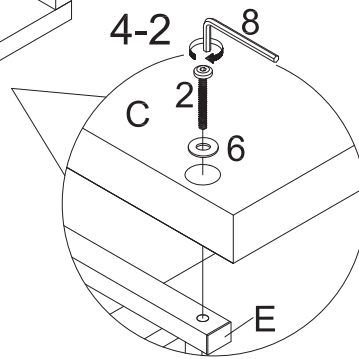
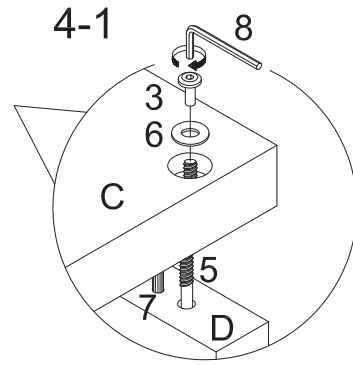
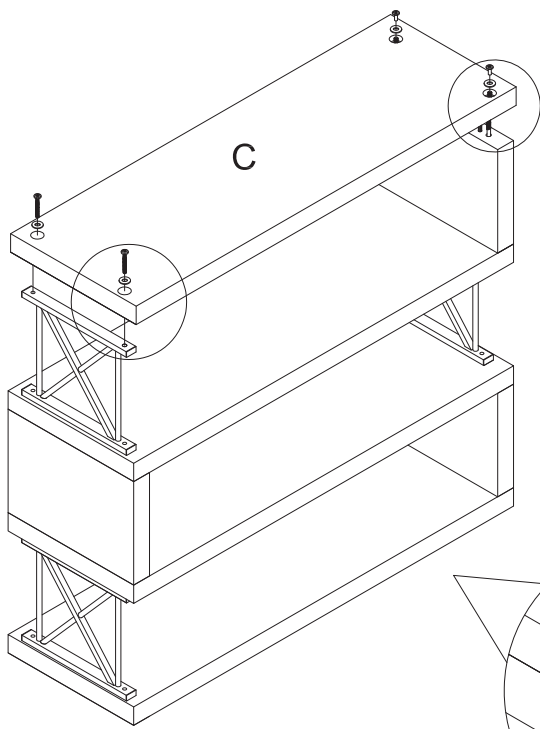

STEP 4

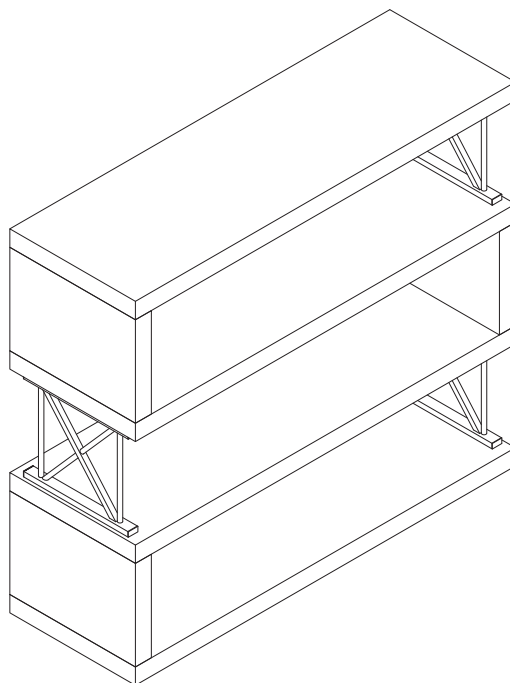

STEP 5



For items use on wooden floor, hard surfaces or carpets, it is recommended to install protective pads under all legs and supports to avoid/prevent from damages/scratches and discoloration

Do not tighten bolts until completely assembled

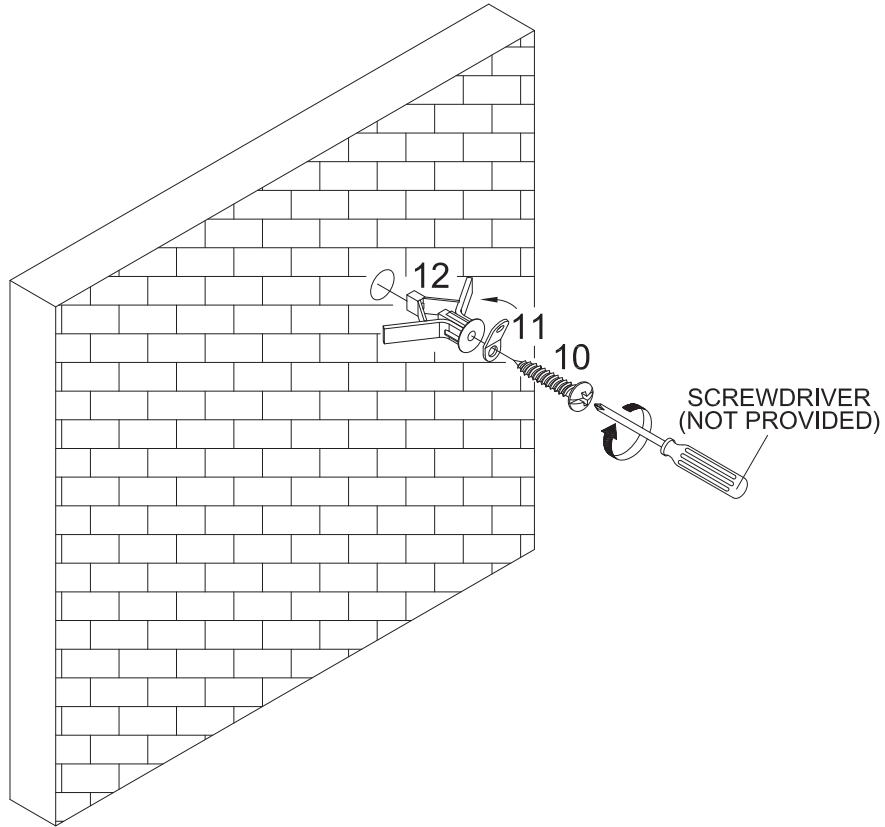

STEP 6

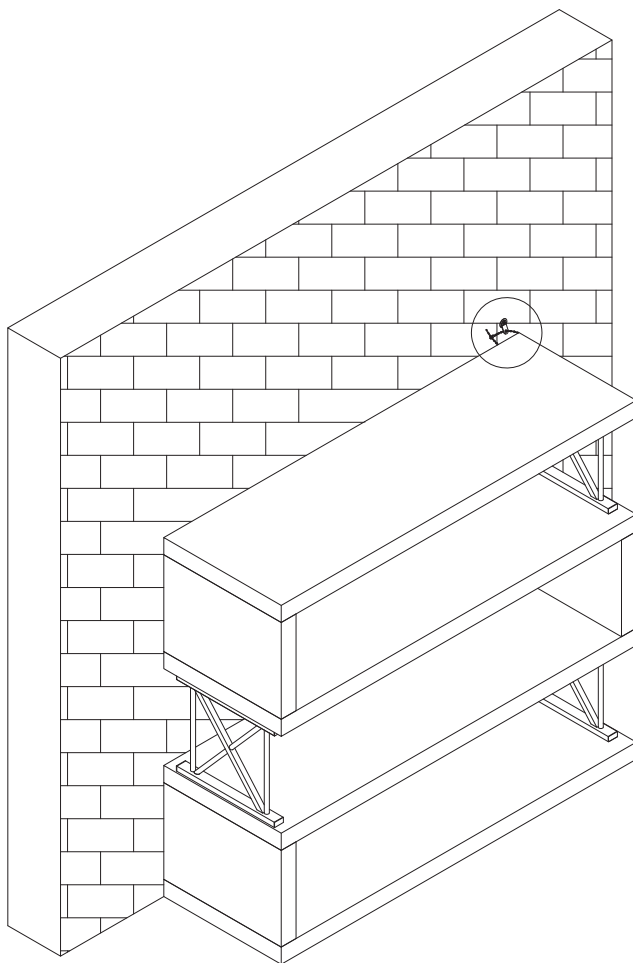

To Prevent Tip over
Product Must Be
Attached To Wall

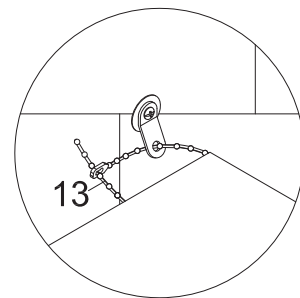

STEP 7
COMPLETED



For items use on wooden floor, hard surfaces or carpets, it is recommended to install protective pads under all legs and supports to avoid/prevent from damages/scratches and discoloration

Do not tighten bolts until completely assembled