



**Liberty Furniture**  
INDUSTRIES, INC

# LIBERTY FURNITURE

## ASSEMBLY INSTRUCTION

ITEM # 705-BR23H/BR23FS/BR23RSP  
705-BR24H/BR24FS/BR24RSP

DESCRIPTION Platform Bed

Thank you for purchasing this quality product. Be sure to check all packing materials carefully for small parts which may have come loose inside the carton during shipment. Identify and count all parts and compare with the parts List Below.

### PARTS LIST

NO.	SKETCH	DESCRIPTION	Q'TY
A		Headboard	1pc
B		Post (L/R)	Queen King 2pcs
C		Footboard	1pc
D		Side Rails	2pcs
E		Slat roll (13 pcs)	Queen King 1set
F		Slat support	Queen King 5pcs
G		Cross bar	1pc

### HARDWARE LIST

NO.	SKETCH	HARDWARE	Q'TY
a		5/16"x18x2-3/4"	8pcs
b			8pcs
c		5/16"	8pcs
d		5/16"x18x2-1/4"	4pcs
e		5/16"x18x1-1/2"	2pcs
f		5/16"x12 mm	6pcs
g		5/16"x19 mm	6pcs
h		4 mm	1pc
i		12 mm	1pc
j		#8x1"	10pcs

#### Assembly steps:

Step 1. Assemble the Posts (B) (L/R) to the Headboard (A) using Bolt (d), spring washer (f), flat washer (g) and wrench (h).

Step 2. Assemble the Cross bar (G) to the Headboard (A) using Bolt (e), spring washer (f), flat washer (g) and Allen wrench (h).

Step 3. Attach the Side rails (D) to the Headboard (A) using set-screw (a), washer (b), nut (c) and wrench (i).

Step 4. Attach the Slat support (F) to the Slat roll(E)

Step 5. Screw slat roll (E) in place.

Step 6. Remove handles from back to front of drawers.

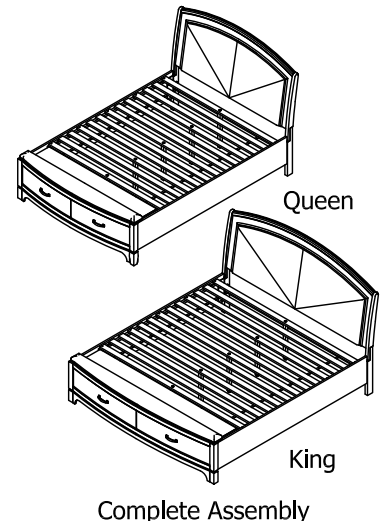
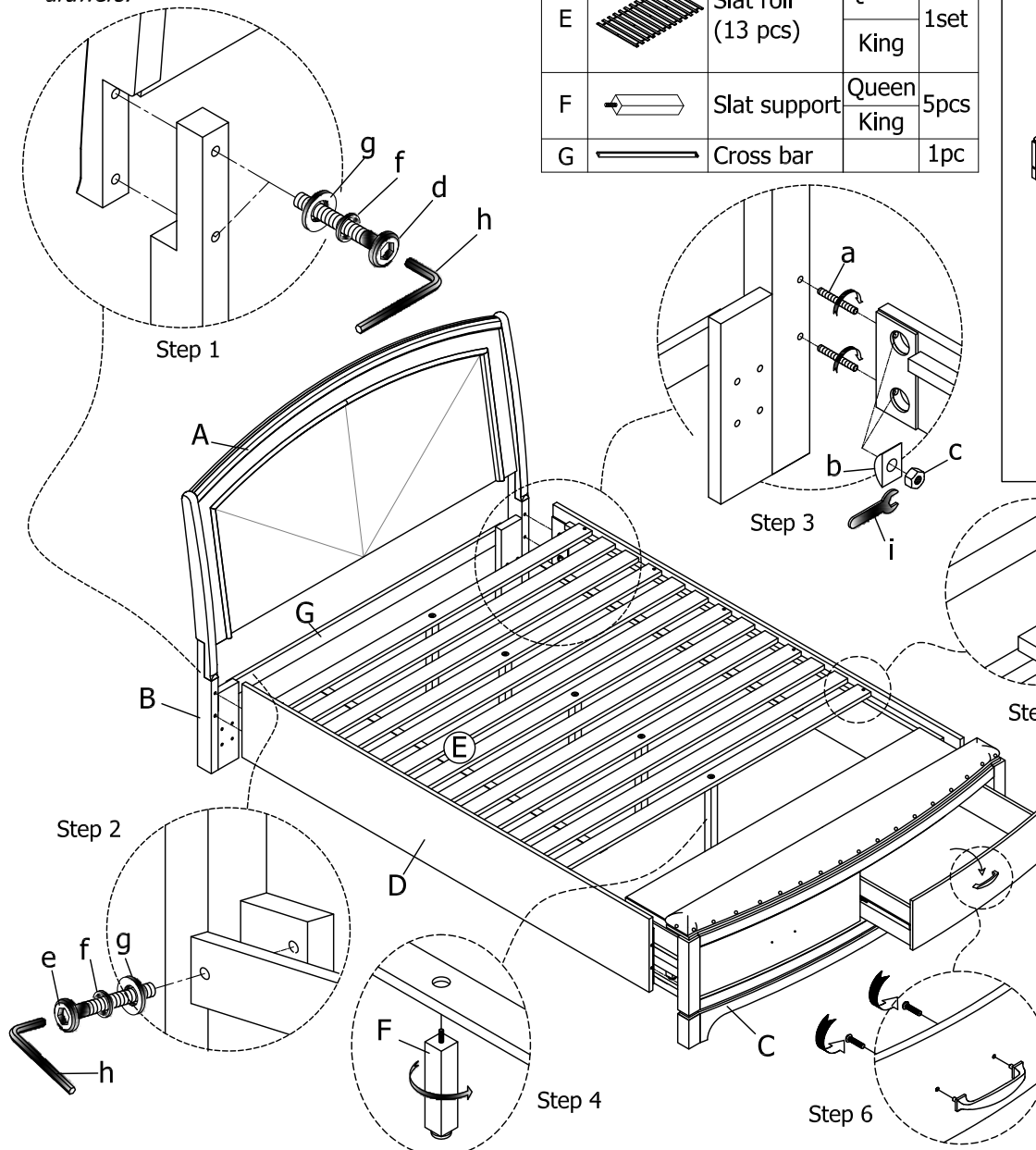

### HOW TO OPEN DRAWER

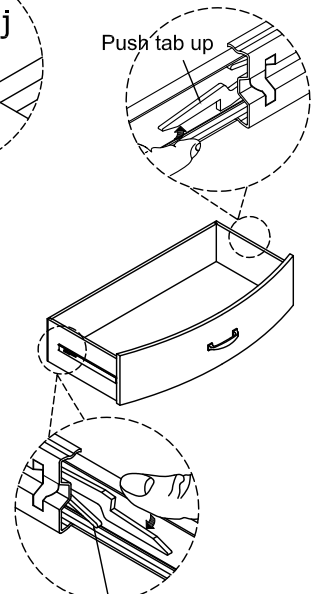

Push tab down  
MADE IN VIETNAM