

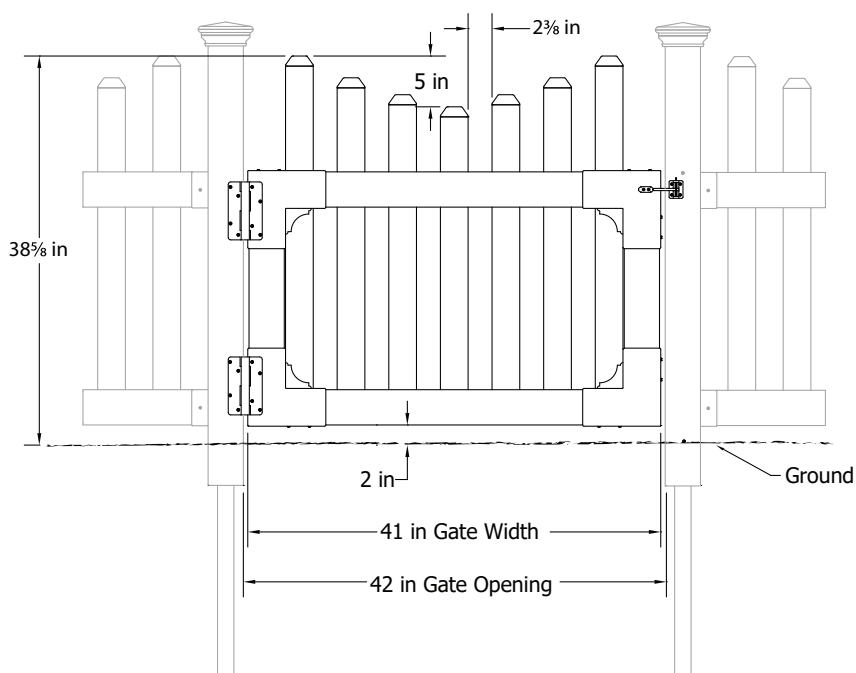

ASSEMBLY INSTRUCTIONS

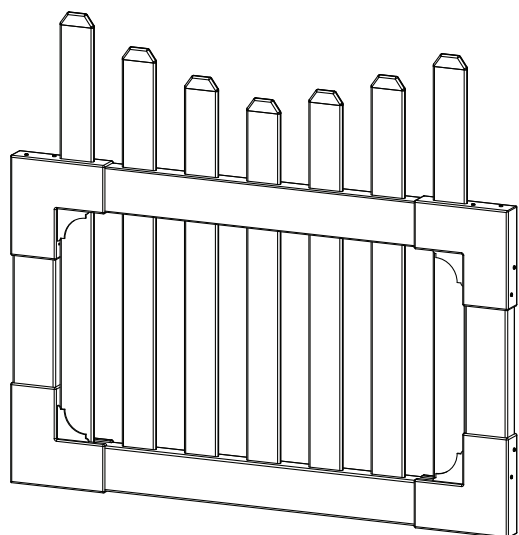

ALL AMERICAN VINYL PICKET GATE

45 MIN approximate assembly time



6935 Reames Rd. Ste. K. Charlotte, NC 28216



support@zippity-outdoor.com



704-892-5222 / 877-234-6196



zippity-outdoor.com

GENERAL INFORMATION



IMPORTANT

- Please read through before starting assembly.
- Important: Check the inside of the larger pieces in your box for other materials packed inside.
- When assembling components, place on a non-abrasive surface (i.e. shipping box) to avoid scratching.
- We recommend an area approx 5'x 8' for unobstructed assembling.
- You should not need to use excessive force when assembling components.

MISSING OR DAMAGED PARTS?

CALL US FIRST SO WE CAN HELP YOU RIGHT AWAY!

Although great care has been taken to ensure proper packaging and handling of this product, occasionally problems occur. If you discover any missing, damaged or defective parts, please contact our customer service department.



EMAIL: support@zippity-outdoor.com



PHONE: 704-892-5222/877-234-6196

Customer service agents are available to take calls weekdays from 8am-5pm EST.

To help you quickly and accurately, please have reference item number ZP19043 and the specific part name which can be found on the next page. It is helpful if you can provide the batch lot which is a stamped number on the end of the box.

NEED ASSEMBLY HELP?

If you are having problems with the assembly or installation of this product, we are happy to assist you with the process, so please give us a call at 704-892-5222/877-234-6196.

NEED TO RETURN?

If for some reason you need to return this product, please allow us to help resolve your issues first. If you still decide to return the product, you will need to initiate the return from the company you originally purchased from.

STEP 1: LAY OUT MATERIALS

▼ ALL AMERICAN VINYL PICKET GATE COMPONENTS

A

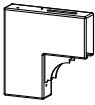

Top Gate Brackets (2)

B

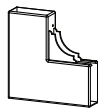

Bottom Gate Brackets (2)

C

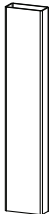

Vertical Stiles (2) -
1 1/2" x 3 1/2" x 18 1/8"

D

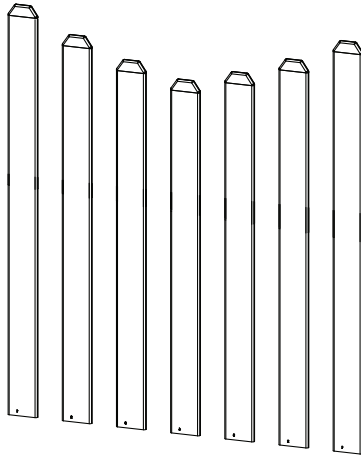

Picket 1 (2) - 3/8" x 2 3/4" x 36 1/2"
Picket 2 (2) - 3/8" x 2 3/4" x 34 3/8"
Picket 3 (2) - 3/8" x 2 3/4" x 32 3/4"
Picket 4 (1) - 3/8" x 2 3/4" x 31 1/2"

E

Top Rail (1) - 1 1/2" x 3 1/2" x 40 3/4"

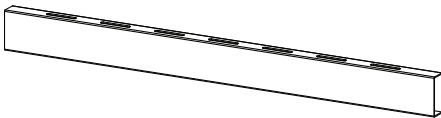

F

Bottom Rail (1) - 1 1/2" x 3 1/2" x 40 3/4"



G



1 1/4" Self-Augering Stainless Steel White-Headed Screw (24)
(to assemble gate frame)

H



1 1/4" Self-Augering Stainless Steel Black-Headed Screws (32)
(to secure hinges to gate and post)

I



5/8" Self-Augering Stainless Steel Black-Headed Screws (6)
(to secure latch to gate and post)

J

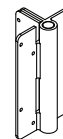

Hinges (2)

K



Latch Finger (1)

L



Latch Catch (1)

TOOLS YOU WILL NEED



Cordless Drill



Level

STEP 2: ASSEMBLE THE GATE FRAME BOTTOM AND SIDES

STEP 2.1

One at a time, insert bottom rail (Part F) fully into bottom gate brackets (Part B)

Note: Orientate the rail with routed holes facing up.

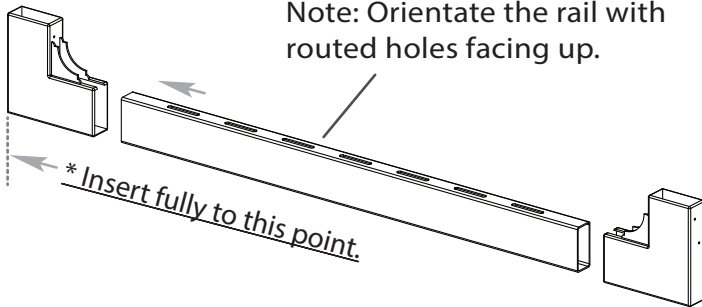

STEP 2.2

To ensure rail has been fully inserted, look down top of gate brackets as illustrated

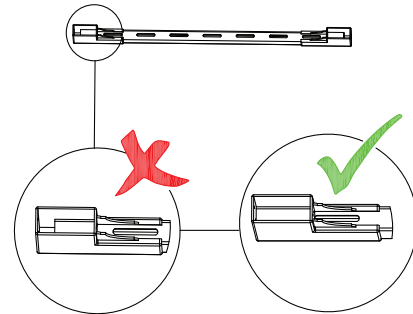

STEP 2.3

Insert vertical stiles (Part C). They will bottom out against bottom rail.

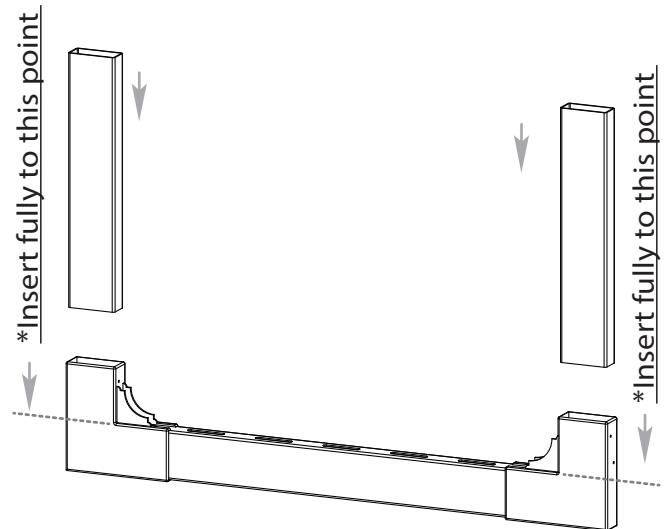

STEP 3: ASSEMBLE THE GATE FRAME TOP & ATTACH TO SIDES

STEP 3.1

One at a time, insert top rail (Part E) into both top gate brackets (Part A). The last routed hole on each end of the rail should align itself with the routed hole in the bracket.

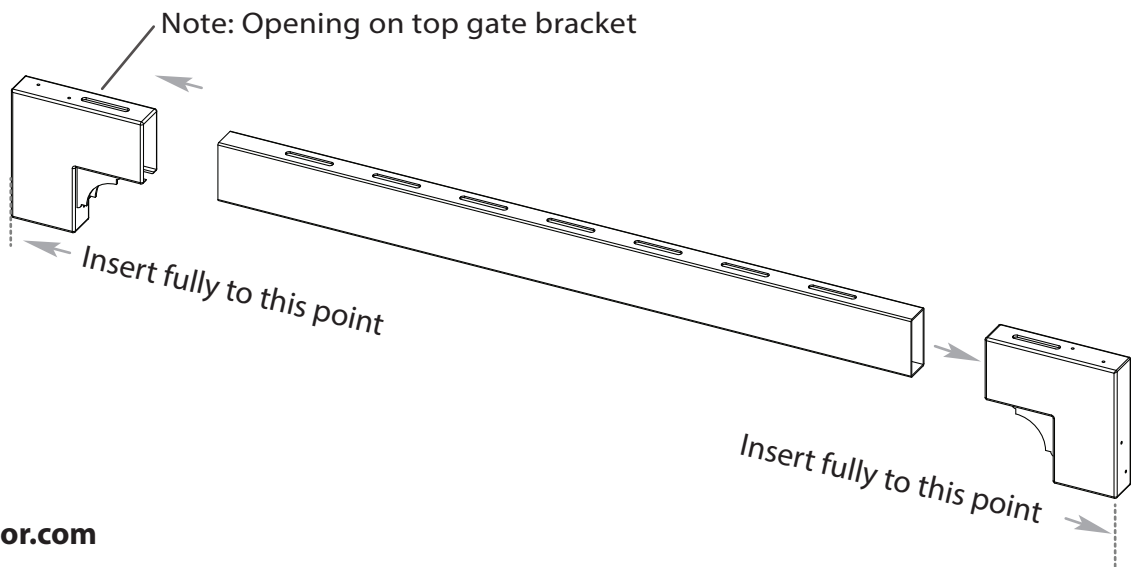

STEP 3.2

Slide top gate brackets with top rail attached down over the vertical stiles.

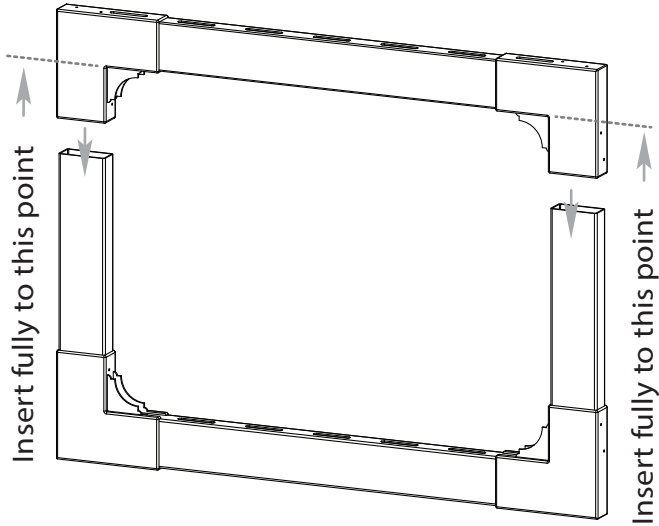

STEP 3.3

Completely assembled gate frame shown.

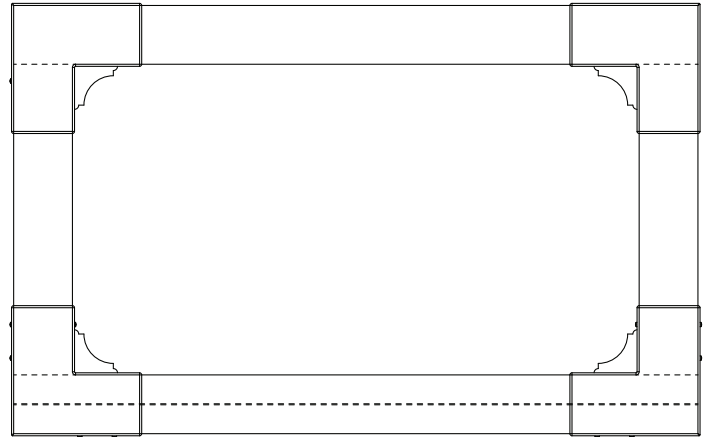

STEP 4: ASSEMBLE GATE FRAME

STEP 4.1

SCREW GATE FRAME/BRACKETS

Fasten brackets to frame with (24) 1 1/4" white-headed screws (Part G).

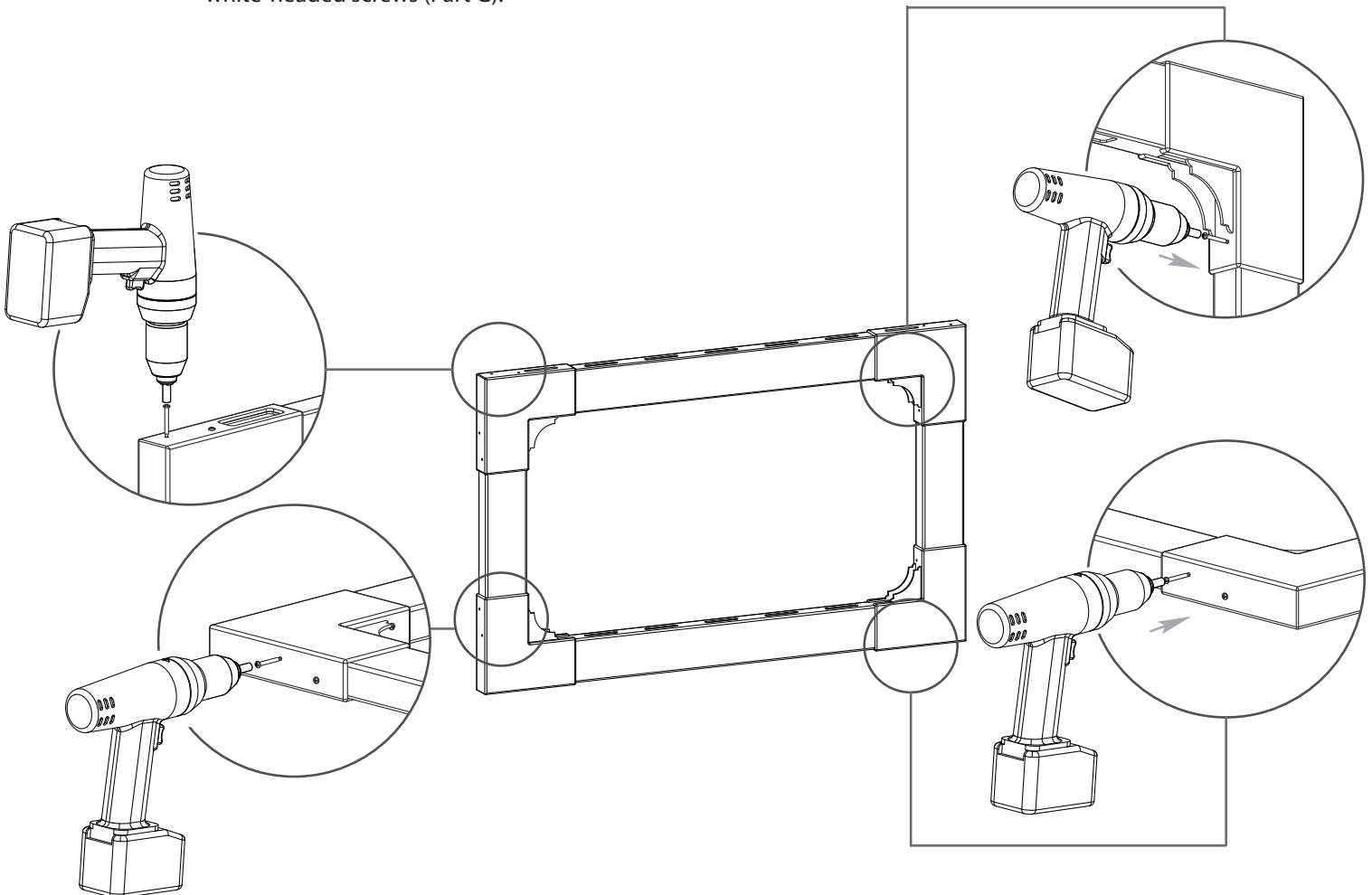

STEP 5: INSERT PICKETS INTO GATE FRAME

STEP 5.1

Insert pickets (Part D) through top rail down into bottom rail.

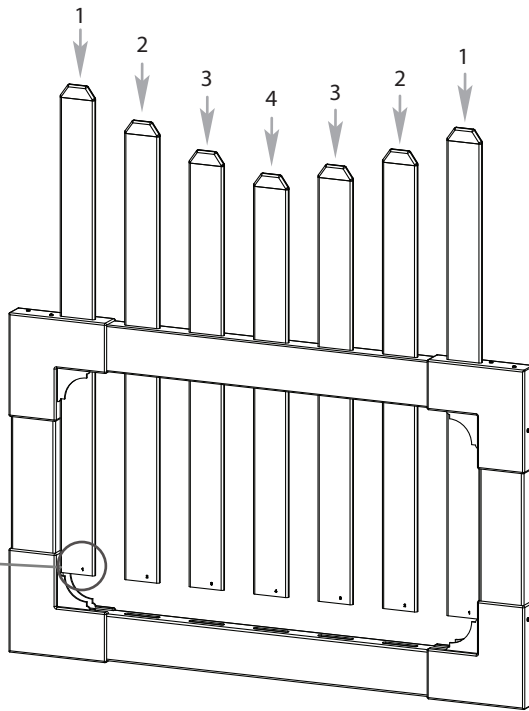
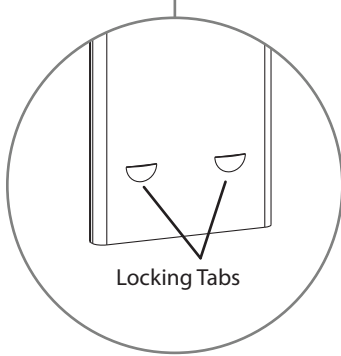
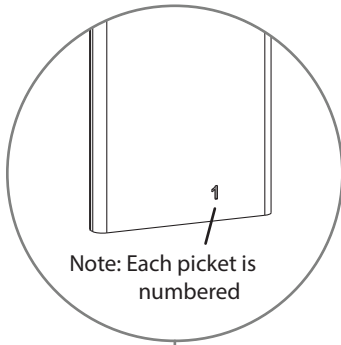

STEP 5.2

Completed gate with frame shown.

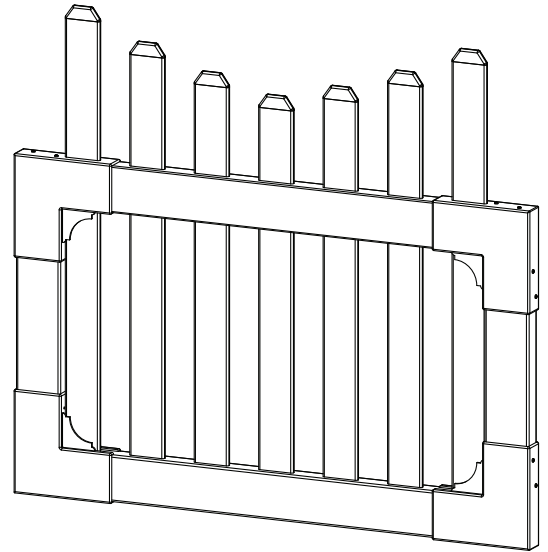

STEP 6: FASTEN GATE HINGES

STEP 6.1

Fasten gate hinges (Part J) onto the gate brackets with (8) 1¼" black-headed screws (Part H).

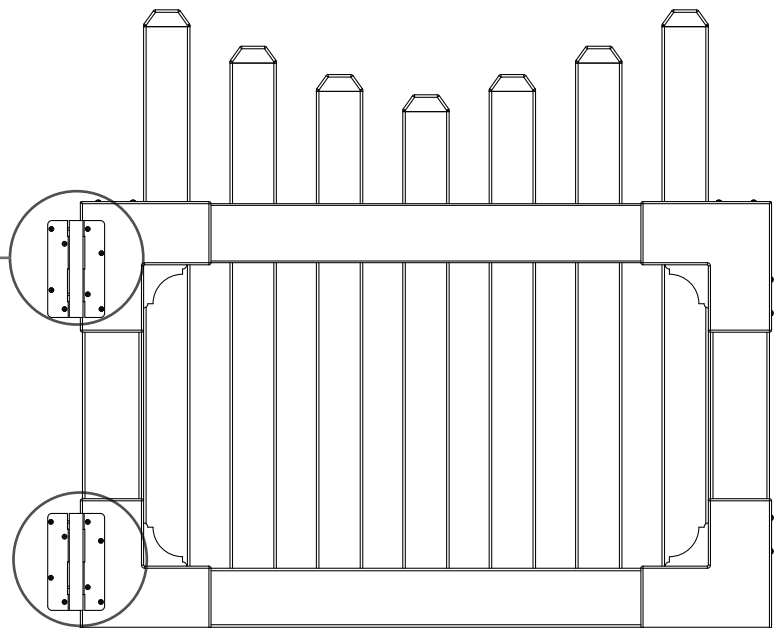
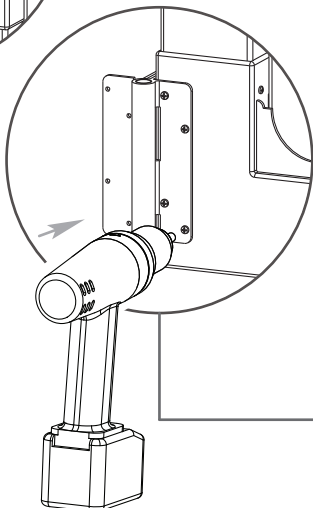
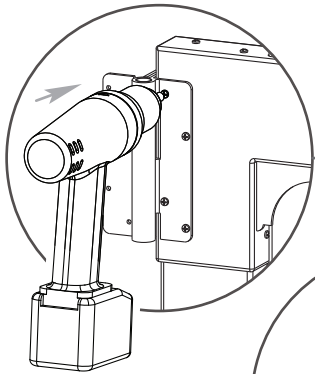

STEP 7: POSITION GATE AND ATTACH HINGES

STEP 7.1

Use temporary spacers or blocks to rest the gate on during alignment and installation.

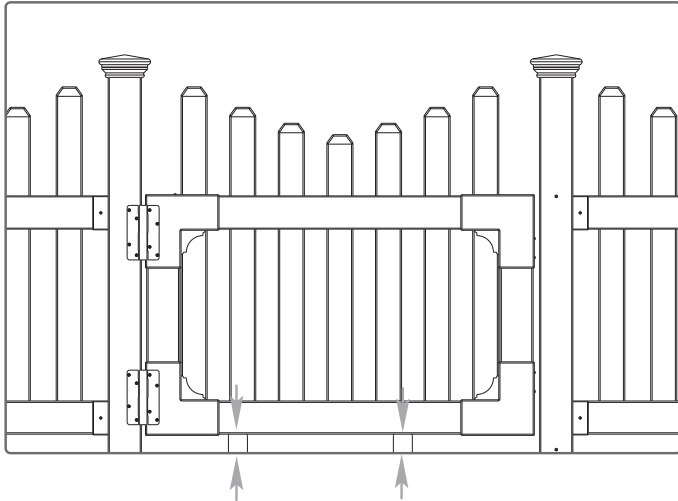

STEP 7.2

Fasten hinges to the post with (8) 1 1/4" black-headed screws.

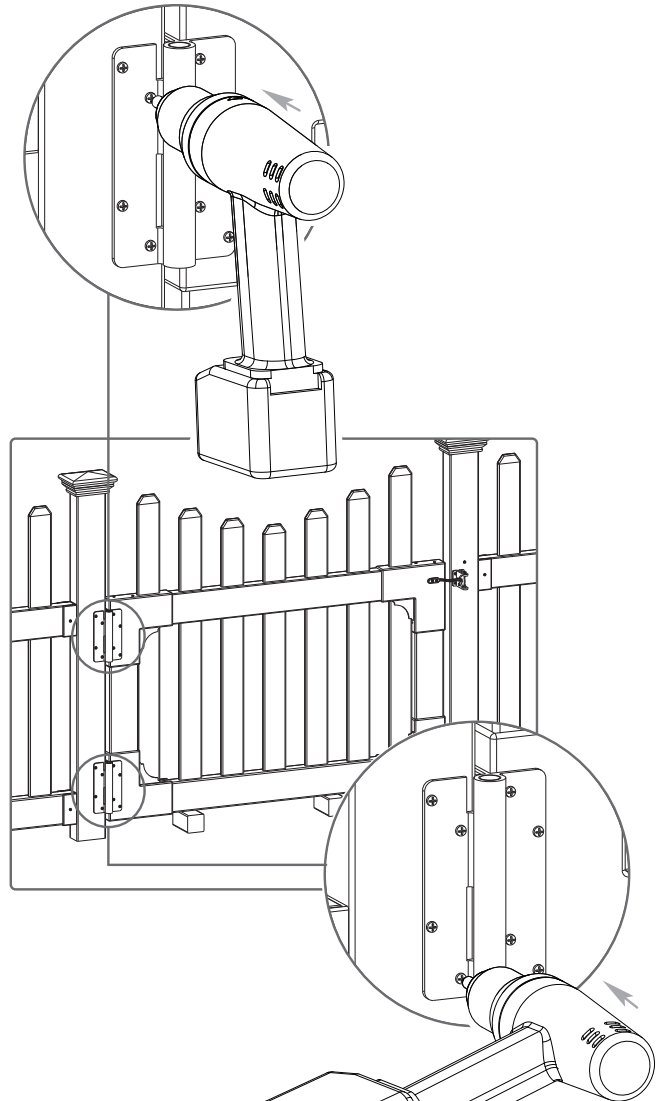

STEP 7.3

Open the gate and fasten the hinges to the post from the inside with (16) 1 1/4" black-headed screws.

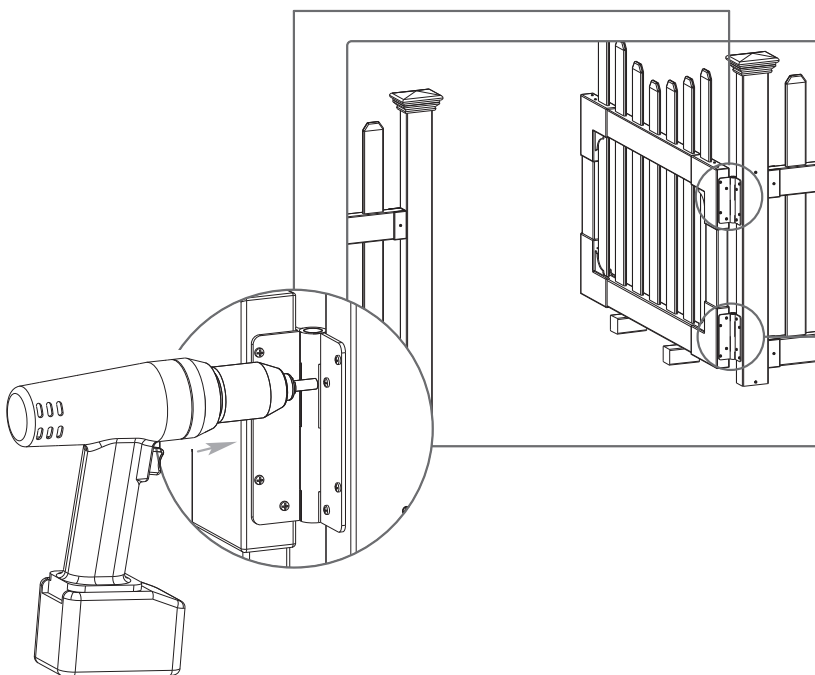

STEP 8: ALIGN & INSTALL LATCH

STEP 8.1

Align and fasten the gate latch to fit and function with the gate finger (Parts K and L) using the (6) $\frac{5}{8}$ " black-headed screws (Part I).

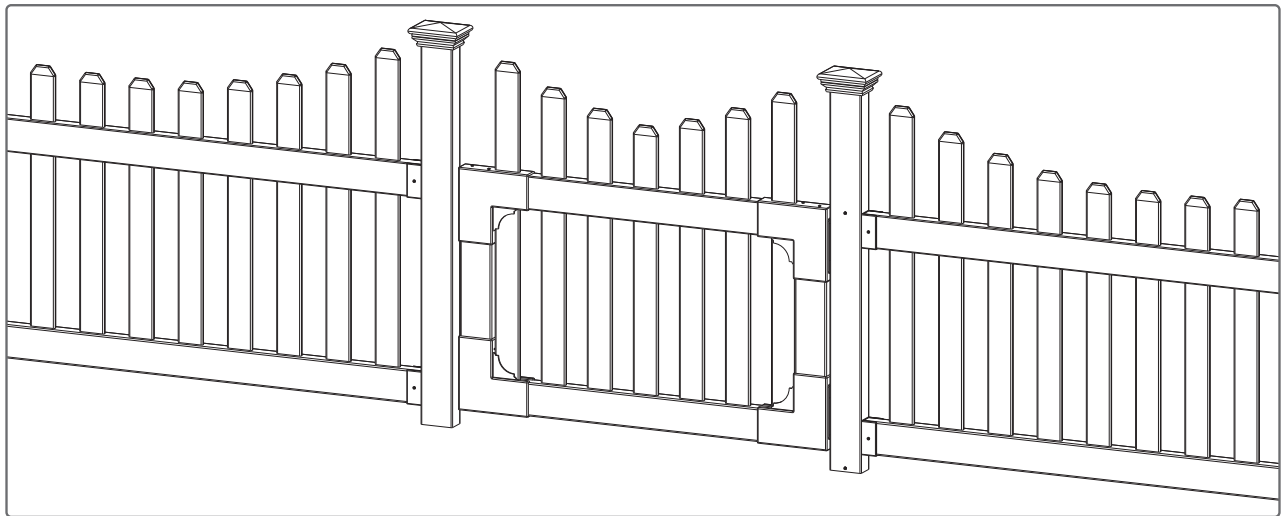
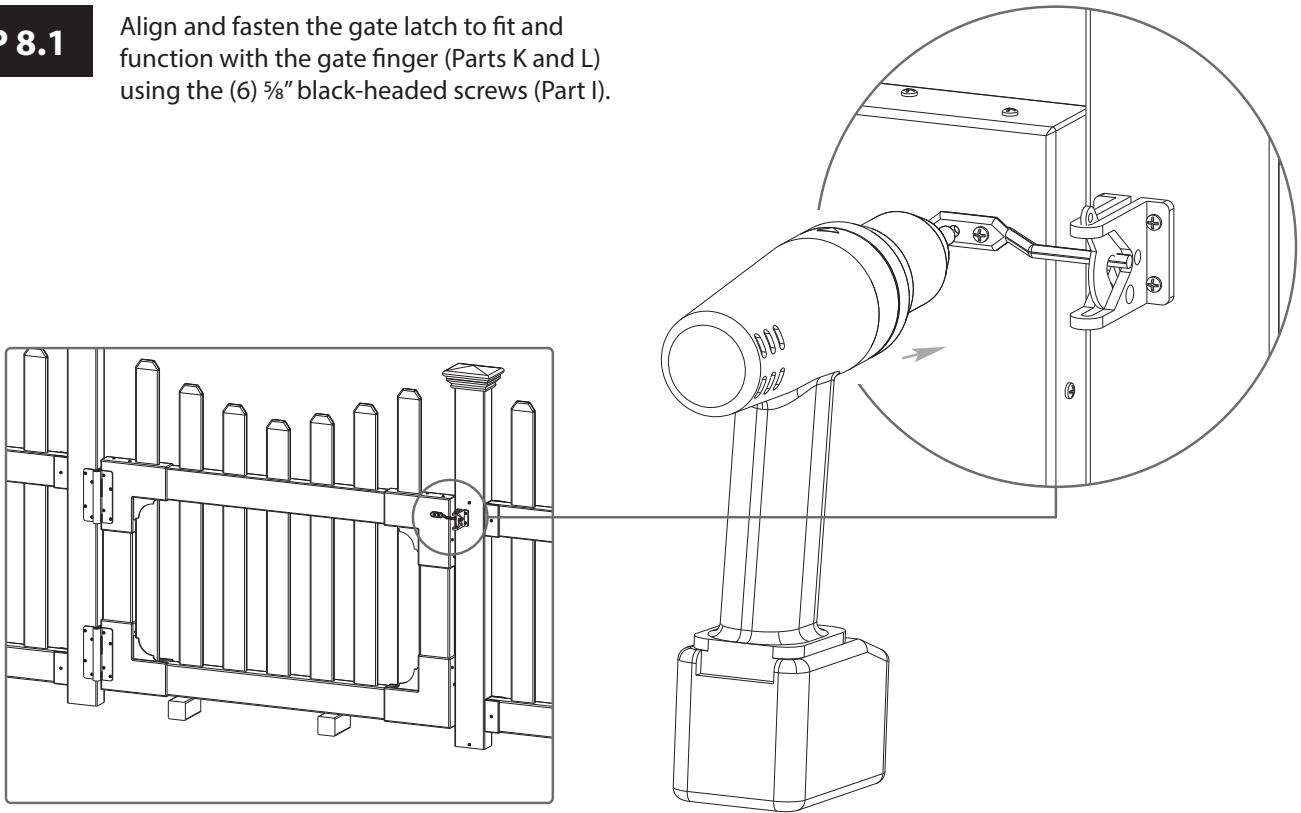

6935 Reames Rd. Ste. K. Charlotte, NC 28216



support@zippity-outdoor.com



704-892-5222 / 877-234-6196



zippity-outdoor.com