

# B8 In Ground Base Installation

## Contents:

Cap, Top Powder Coated Steel Tube, Bottom Galvanized Steel Tube, 3 Knobs, 2 Reducer Sticks

## Needed:

Installation Tools & Concrete (Varies by Surface)

## Concrete Surface

(We are not liable for injury/damage during installation or improper installation.)

### 1. Prepare & Drill/Dig

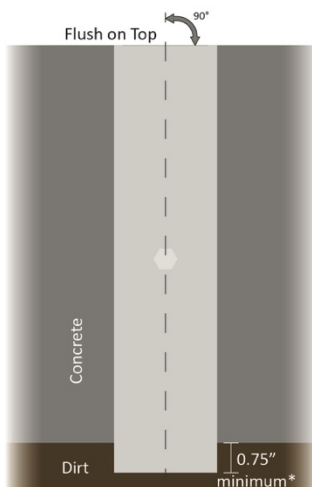

As you prepare and begin creating your hole, be sure to have the exact bottom - in ground tube's measurements in mind. The tube is 14.5" tall and is a 3.493" outer diameter, not including the bolt going through it.

Be sure to plan with the tube oriented correctly, as shown to the left.

\*For maximum drainage allowance try to make sure there is a 0.75" minimum of dirt below the concrete.

We do not provide tools or the concrete.

### 2. Installing the Bottom - In Ground Tube

Carefully set the bottom - in ground tube to desired position as figured out during step 1.

Be sure to keep the tube straight, and the top of the tube flush with the top of the concrete.

Pour concrete around tube. If needed tap the tube lightly until you ensure the tube will be flush with the top of the concrete.

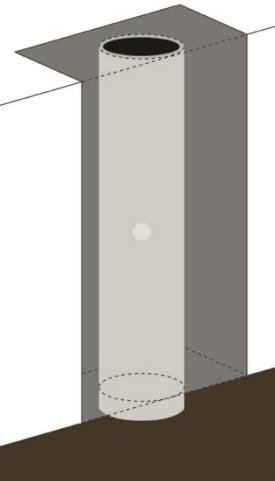

### 3. Drying

Give the cement 48 hours to dry before continuing. (Timeframe may vary due to type of concrete used, but make sure to add extra time.)

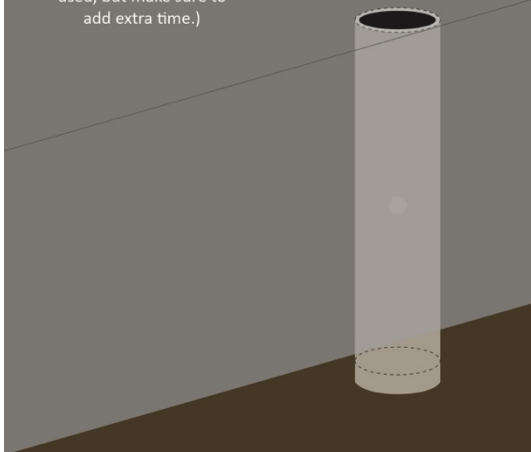

### 4. Ready Base for Umbrella

Lock the top - umbrella tube into place by lowering it into the bottom - in ground tube, following the movements 1-2-3 to the right.

Try to line up the zig-zag line on the top tube with the rod of the bottom tube to get them locked in easiest.

Then, screw in all three knobs loosely.

Peel backing from reducer sticks. Stick them firmly. Do NOT block the knobs with the sticks.

1.8" = 2 Sticks  
2.25" = 1 Stick



Locked

2 Sticks Example



greencorner.com  
407-851-7018  
info@greencorner.com

# B8 In Ground Base Installation

## Other Surfaces

(We are not liable for injury/damage during installation or improper installation.)

### 1. Prepare & Drill/Dig

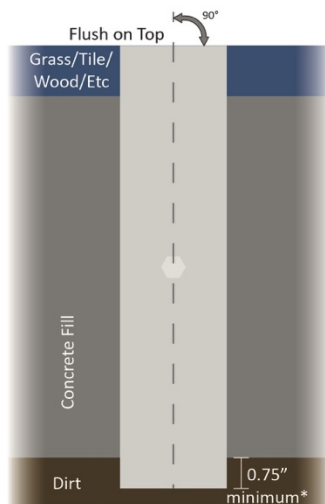

As you prepare and begin creating your hole, be sure to have the exact bottom - in ground tube's measurements in mind. The tube is 14.5" tall and is a 3.493" outer diameter, not including the bolt going through it.

Be sure to plan with the tube oriented correctly, as shown to the left.

Measure out the height of the top layer you will be adding after the concrete.

\*For maximum drainage allowance try to make sure there is a 0.75" minimum of dirt below the concrete.

We do not provide tools or the concrete.

### 2. Installing the Bottom - In Ground Tube

Carefully set the bottom - in ground tube to desired position as figured out during step 1. (Including top allowance.)

Be sure to keep the tube straight, and the top of the tube flush with the top of the concrete.

Pour concrete around tube. If needed tap the tube lightly until you ensure the tube will be flush with the top of the concrete.

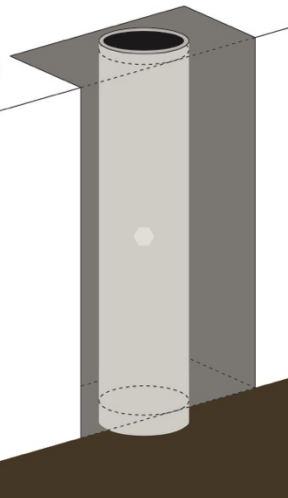

### 3. Drying & Then Install Top Layer

Give the cement 48 hours to dry before continuing. (Timeframe may vary due to type of concrete used, but make sure to add extra time.)

Once dry, install your chosen top layer making the layer flush with the tube.

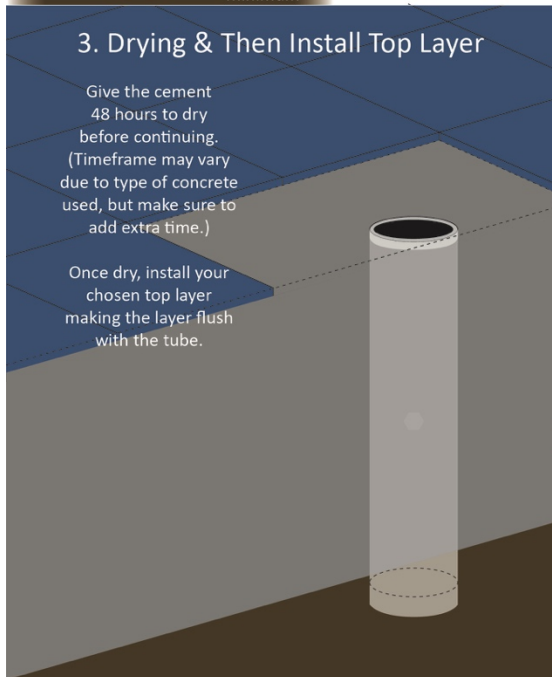

### 4. Ready Base for Umbrella

Lock the top - umbrella tube into place by lowering it into the bottom - in ground tube, following the movements 1-2-3 to the right.

Try to line up the zig-zag line on the top tube with the rod of the bottom tube to get them locked in easiest.

Then, screw in all three knobs loosely.

Peel backing from reducer sticks. Stick them firmly. Do NOT block the knobs with the sticks.

1.8" = 2 Sticks  
2.25" = 1 Stick

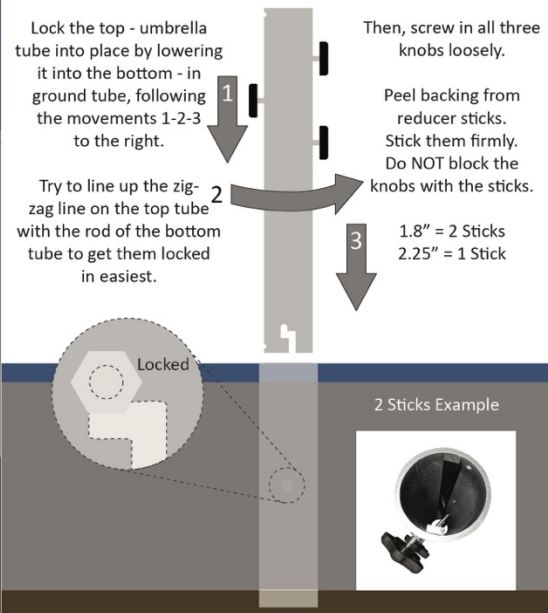

greencorner.com  
407-851-7018  
info@greencorner.com