

WamBam Nantucket Vinyl Picket  
Gate w/Stainless Steel Hardware  
(48" H x 48" W)  
(Adjustable Width)



REALLY

^ Important stuff to know about  
installing your WamBam gate.



This gate is designed to be integrated with our  
WamBam Nantucket Vinyl Picket Fence - 4' High.  
(This gate can also be used in any opening that is 50" wide or less  
by trimming down both the top and bottom rail).

V-2.0

**1-877-778-5733**  
[www.wambamfence.com](http://www.wambamfence.com)

# WamBam Nantucket Vinyl Picket Gate w/Stainless Steel Hardware



## 1 - Read Over Fence Instructions First

Your gate and fence will work better together as an integrated solution if you first take the time to read and understand your fence instructions.

## 2 - Pre-Assemble the Gate Frame (without pickets)

Please do not screw your gate frame together until you have first temporarily assembled the gate. In other words, do a dry run first.

This will ensure three things:

- a) *That you have everything necessary to complete the gate.*
- b) *That you will have assembled the gate in the correct order.*
- c) *All the pieces fit and function properly.*

It's easier to trouble shoot when things are not screwed together. After you assemble your gate correctly, please disassemble as necessary and use screws to permanently assemble the gate.

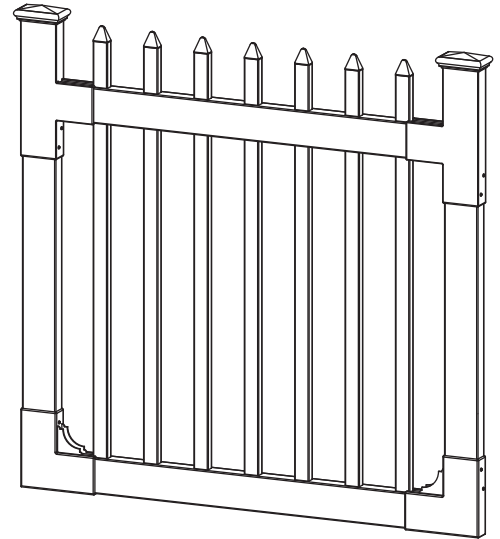

## 3 - Ideally, Install Your Gate Posts Before Your Fence Posts

Your fence panels will be more forgiving for a custom fit than your gate. Ideally, position and install your gate posts before you do anything else, or very early on in the process of setting up your fence run.

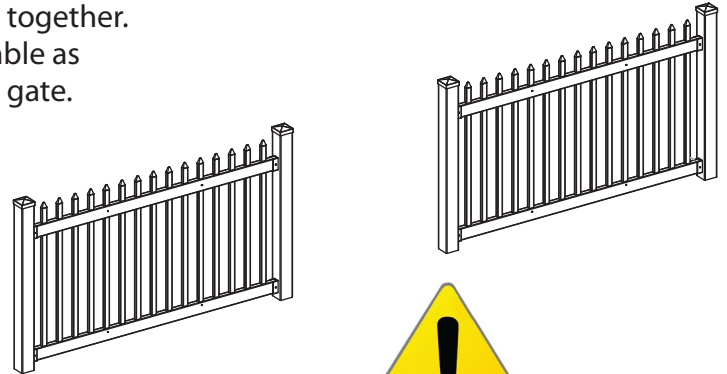

## 4 - Ideally, Do Not Hang Your Gate System Off a Single Non-Supported Post

Your gate will perform better and last longer if your hinge post is connected to a panel of fence which is connected to another post. The weight strain will be transferred unto two posts versus just one. Installing fence panels on both sides of your gate is the ideal in all situations. If this is not possible because of space restrictions, please contact us for alternative solutions to overcome.

**Install Your Gate Posts  
Before Installing Your  
Fence Posts.**

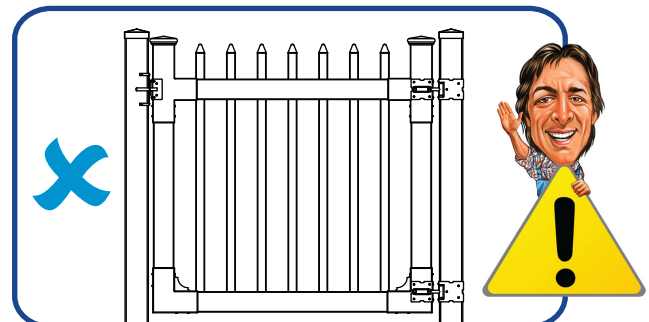
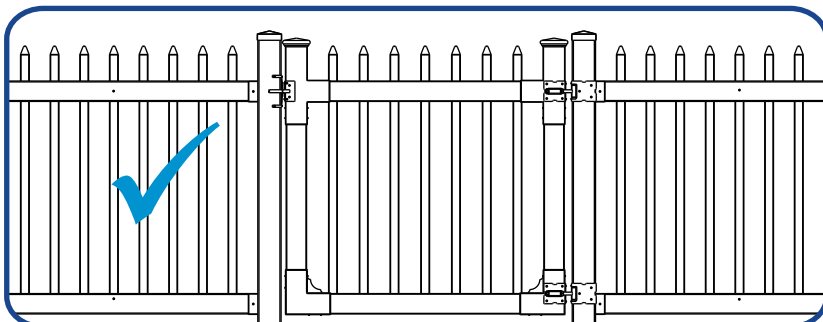

For more information, contact us at 1 877-778-5733.

*Do Not Hang Gate on Lone Soldier Post.*

# WamBam Nantucket Vinyl Picket Gate w/Stainless Steel Hardware



## PRODUCT OVERVIEW

### Gate Assembly

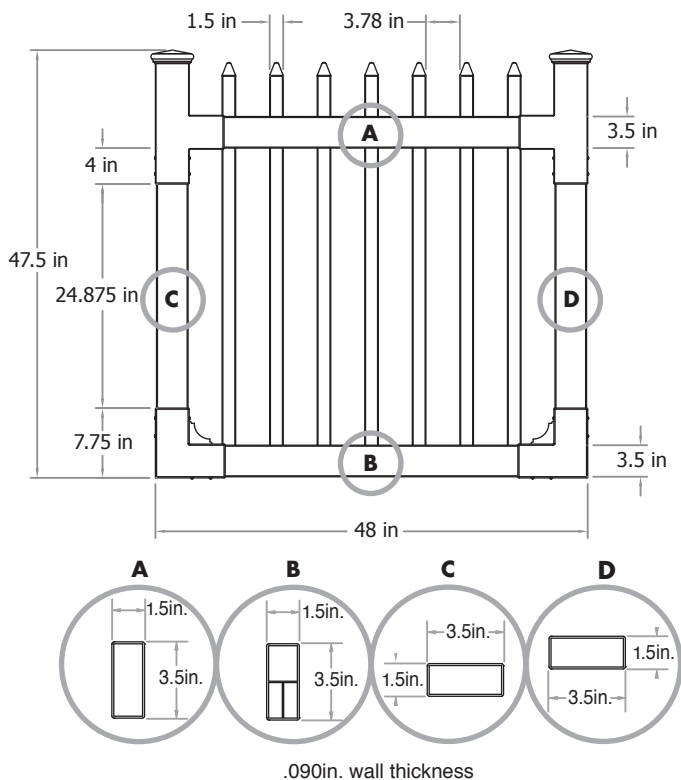

### Gate Installation

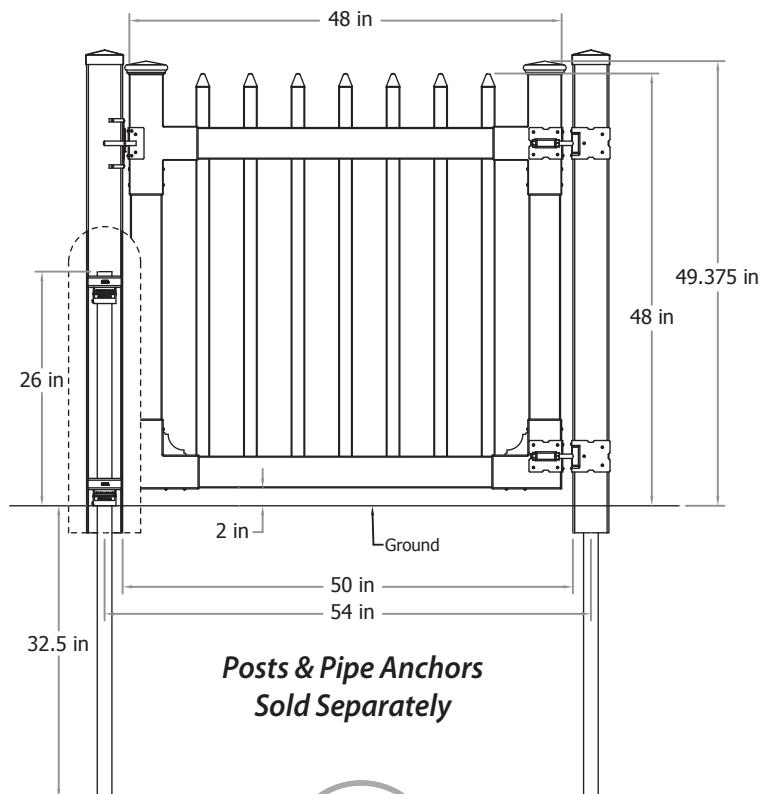

*Posts & Pipe Anchors  
Sold Separately*

## BOX CONTENTS

### Each Gate Box Includes:

- Gate Caps (2)
- T-Brackets (2)
- Gate Latch (1)
- Top Rail (1)
- Gate Hinges (2)
- Vertical Stiles (2)
- Pickets (7)
- Gate Bottom Brackets (2)
- Bottom Rail (1)
- Stainless Steel Screws (20)

### Sold Separately:

- 4ft. Post & Pipe Anchor (1-Pack)

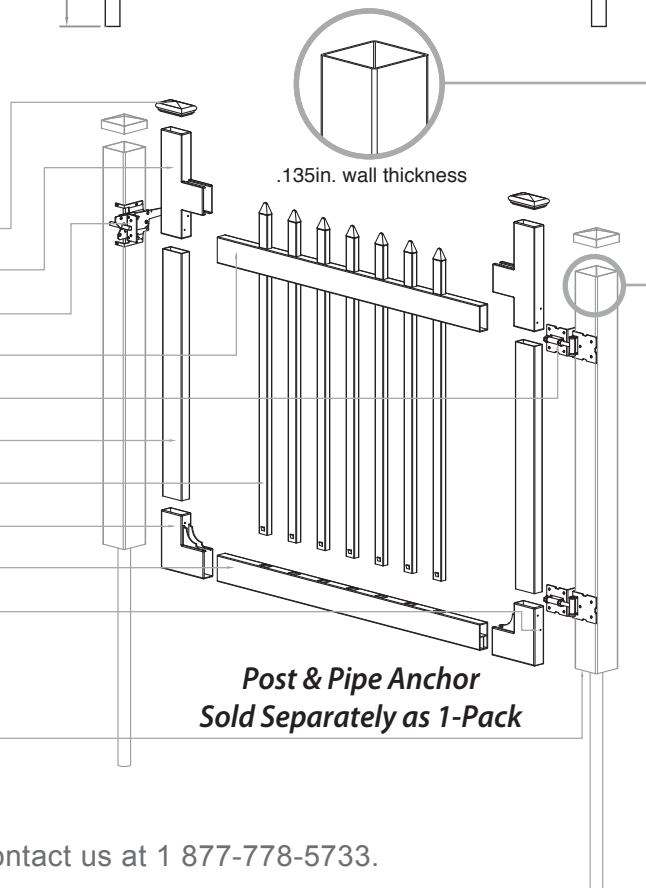

*Post & Pipe Anchor  
Sold Separately as 1-Pack*

### DETAILED ASSEMBLY INSTRUCTIONS

#### STEP 1 Assemble the Gate Frame Bottom & Sides

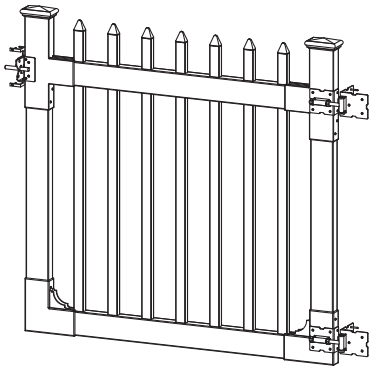

Completely assembled gate shown

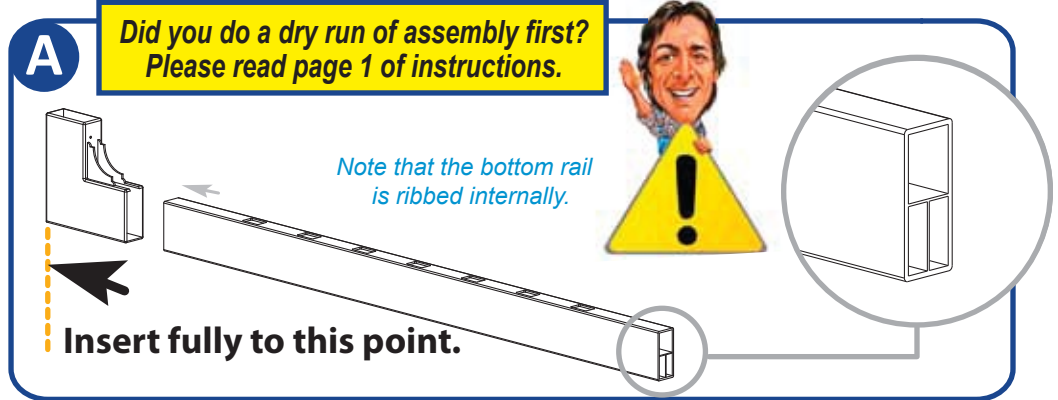

A - Insert the bottom rail **ALL THE WAY** until it **BOTTOMS OUT** inside gate bracket

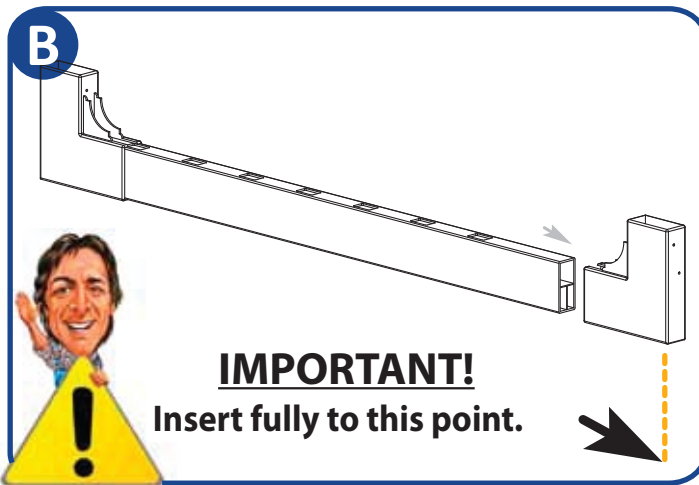

B - Insert the bottom rail **ALL THE WAY** until it **BOTTOMS OUT** INSIDE GATE BRACKET

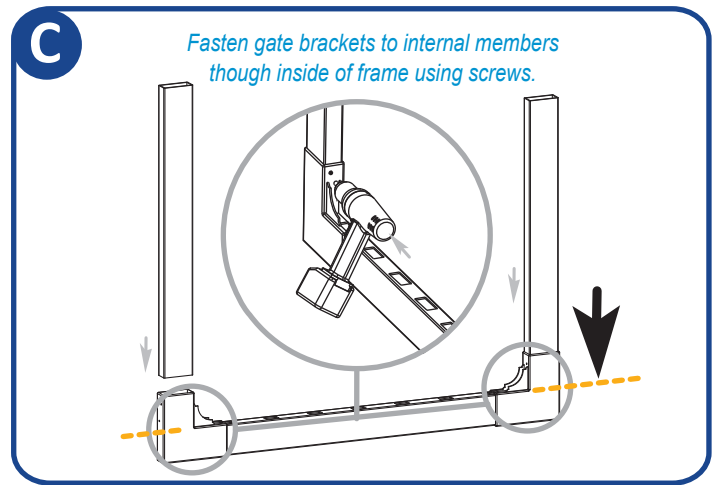

C - Insert vertical gate stiles. They will **BOTTOM OUT** against bottom horizontal rail

#### STEP 2 Assemble the Gate Frame Top & Attach to Sides

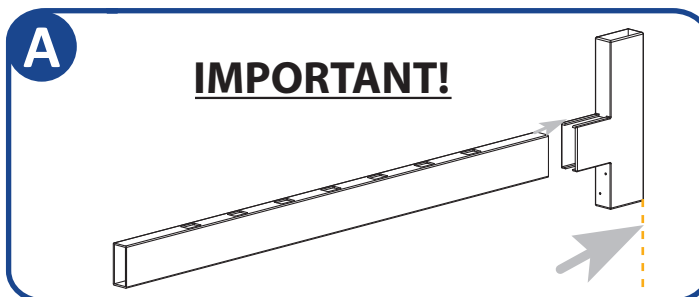

A - Insert top rail **ALL THE WAY** until it **BOTTOMS OUT** inside bracket

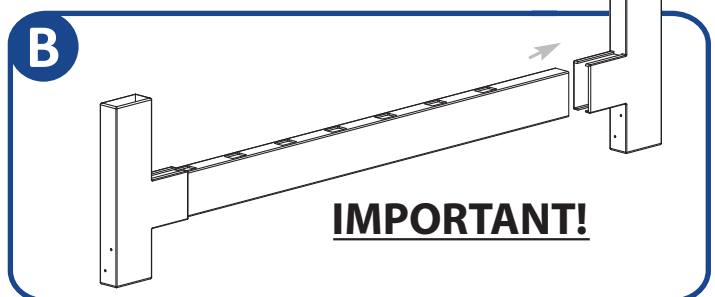

B - Insert rail **ALL THE WAY** until it **BOTTOMS OUT** inside bracket

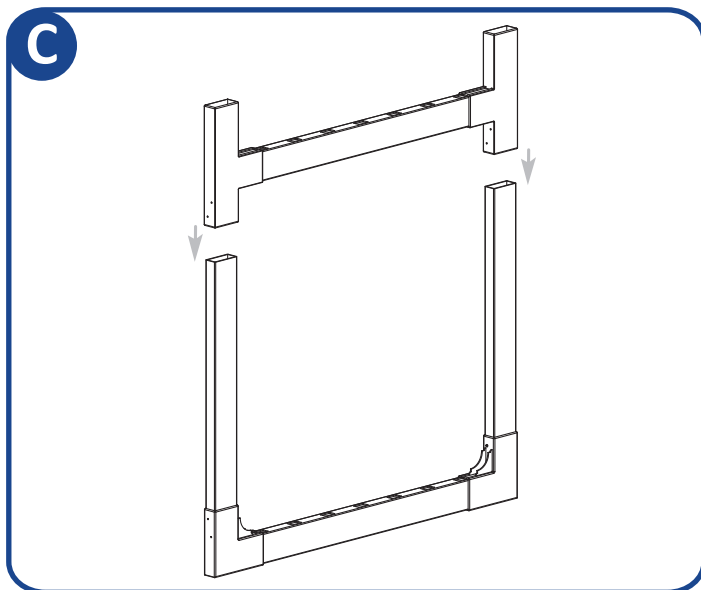

**C - Slide T-brackets with top rail attached down over the vertical gate stiles**

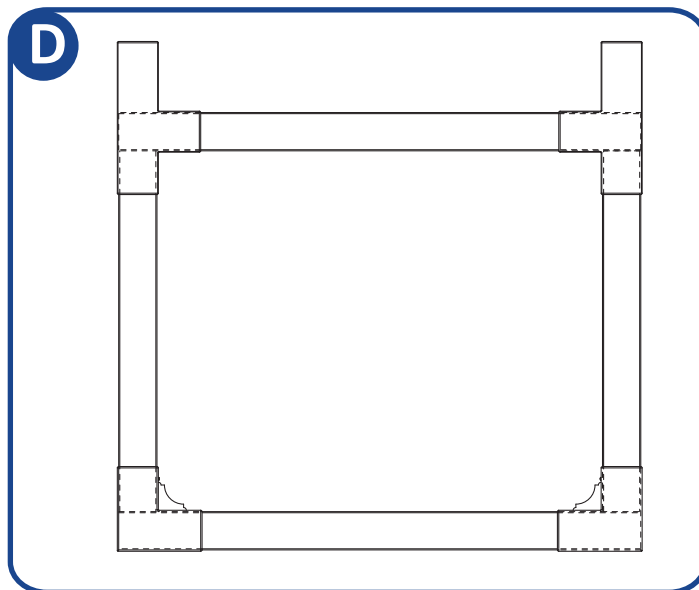

**D - Completely assembled gate frame shown**

### STEP 3 Screw Gate Frame/Brackets

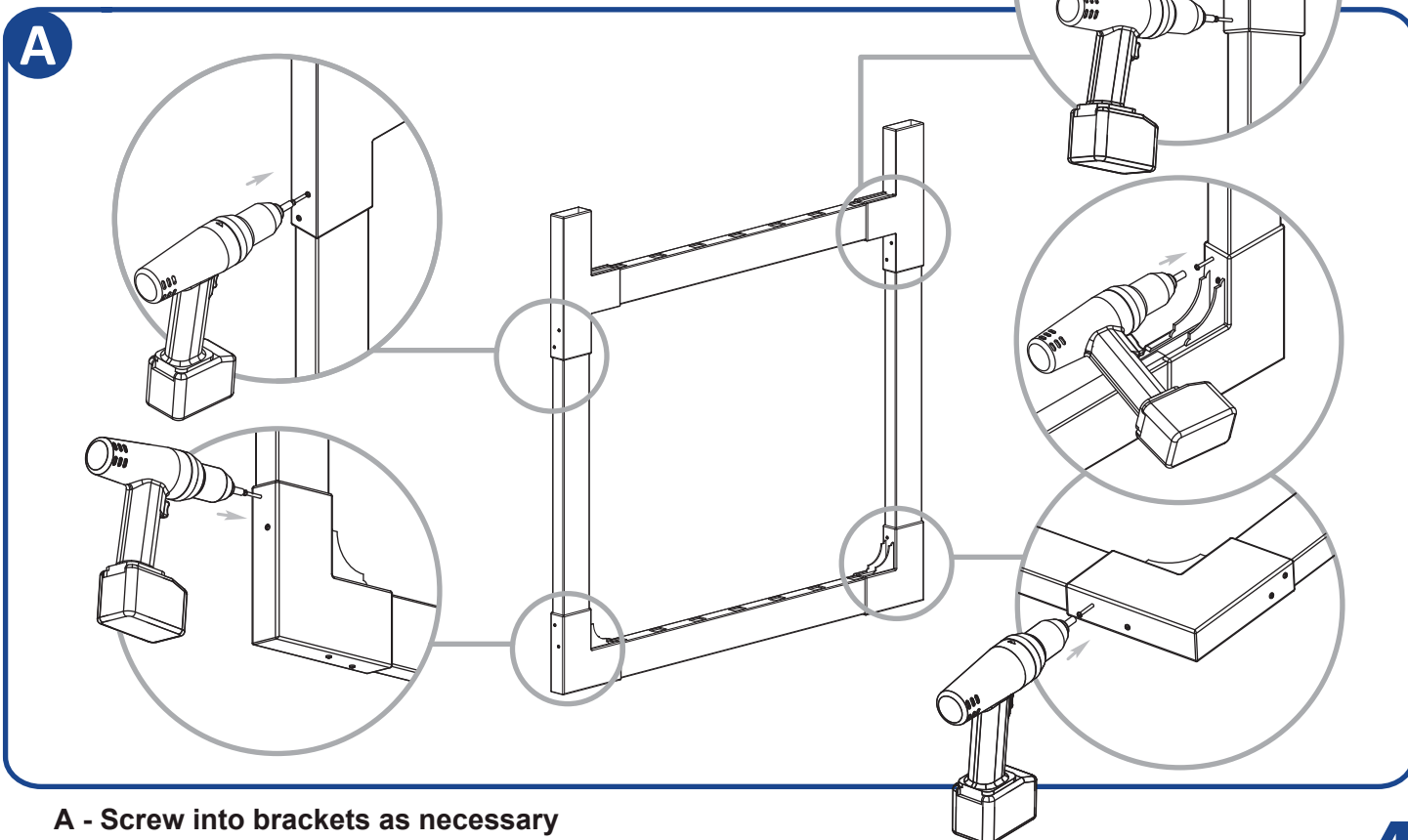

**A - Screw into brackets as necessary**

For more information, contact us at 1 877-778-5733.

### STEP 4 Insert Pickets Into Gate Frame & Attach Caps

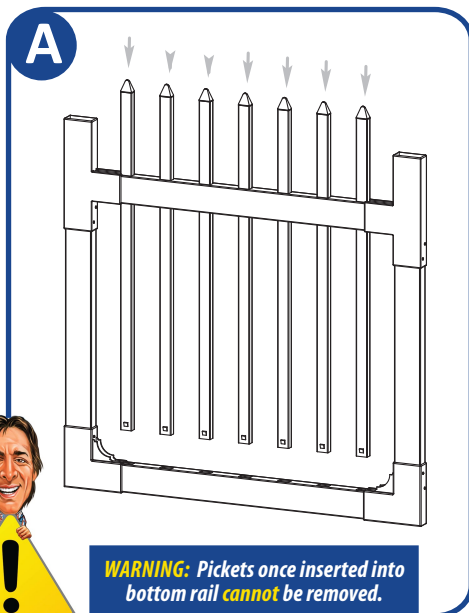

A - Insert pickets through top rail down into bottom rail

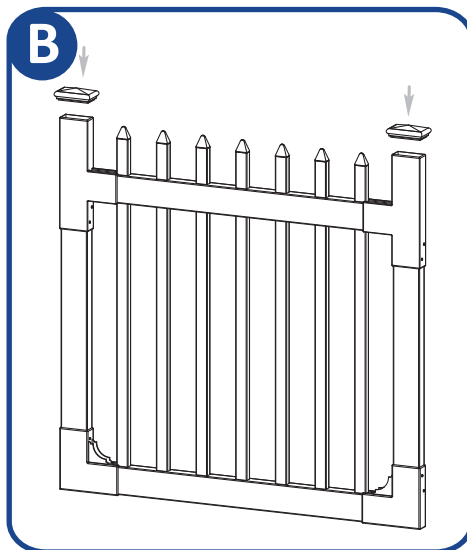

B - Install bracket caps. Use pvc glue (purchase separately) if you would like to permanently secure caps to T-brackets

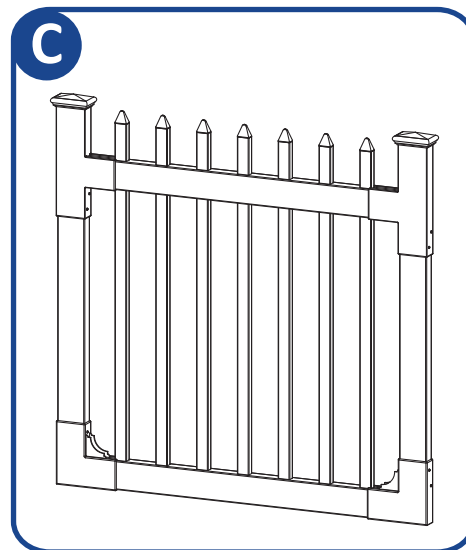

C - Completed gate with frame shown.

### STEP 5 Fasten Gate Hinges & Gate Latch

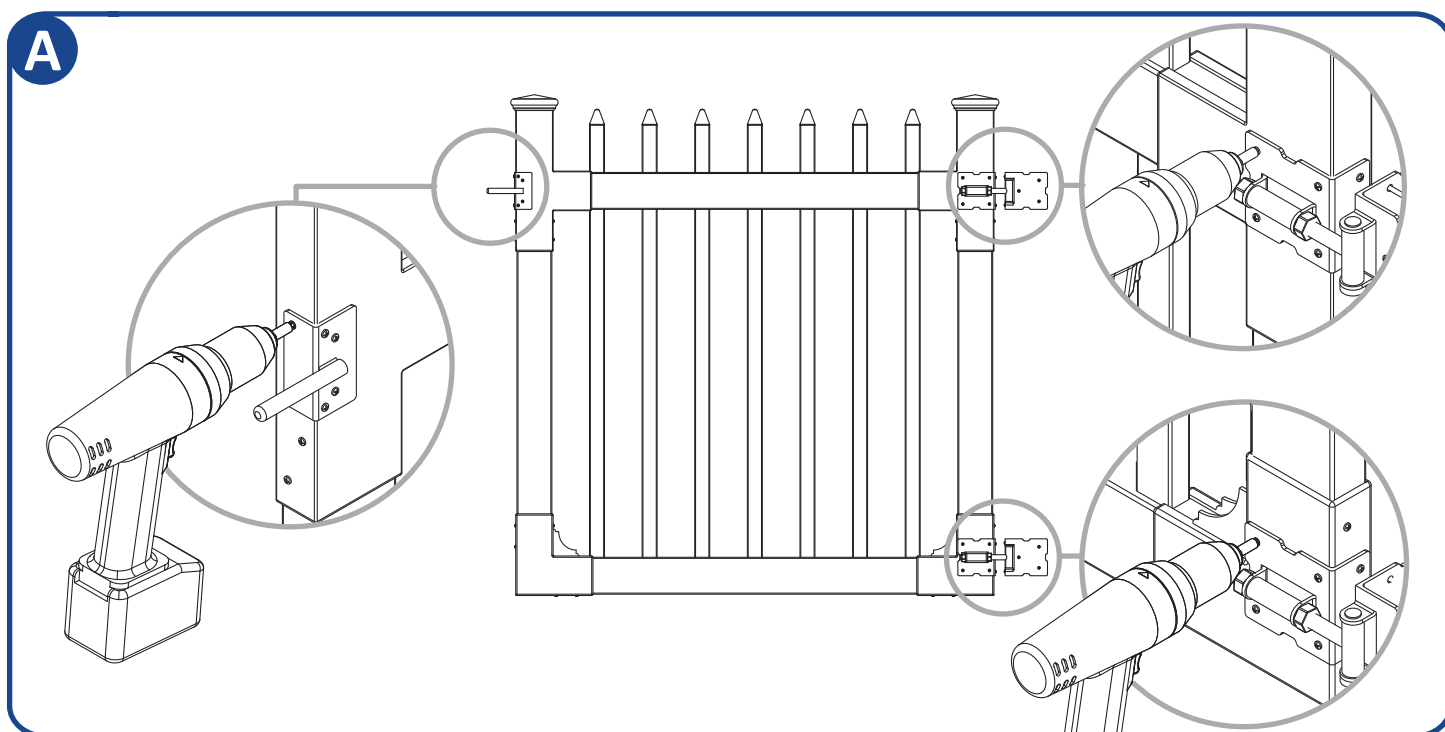

A - Fasten gate hinges and gate latch onto the gate brackets with screws.



**STEP 6** Position, Adjust & Align Gate/Secure Hinges to Posts

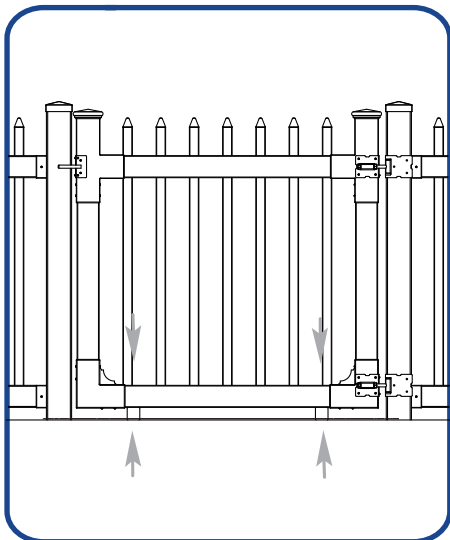

**A** - Use temporary spacers OR blocks to rest the gate on during alignment and installation

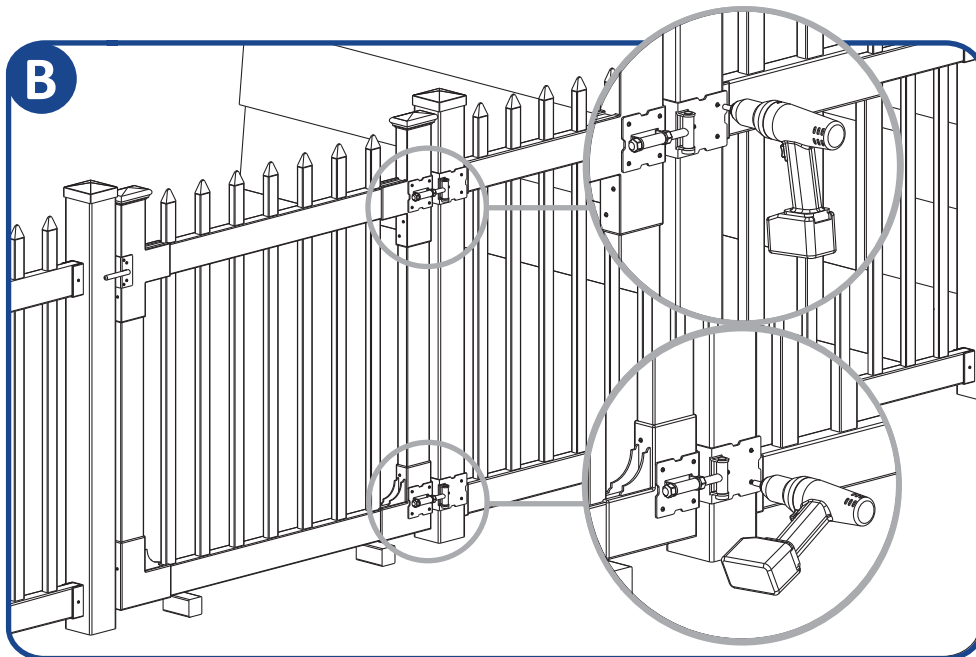

**B** - Fasten hinges to post with screws

**STEP 7** Level Gate & Adjust Hinges

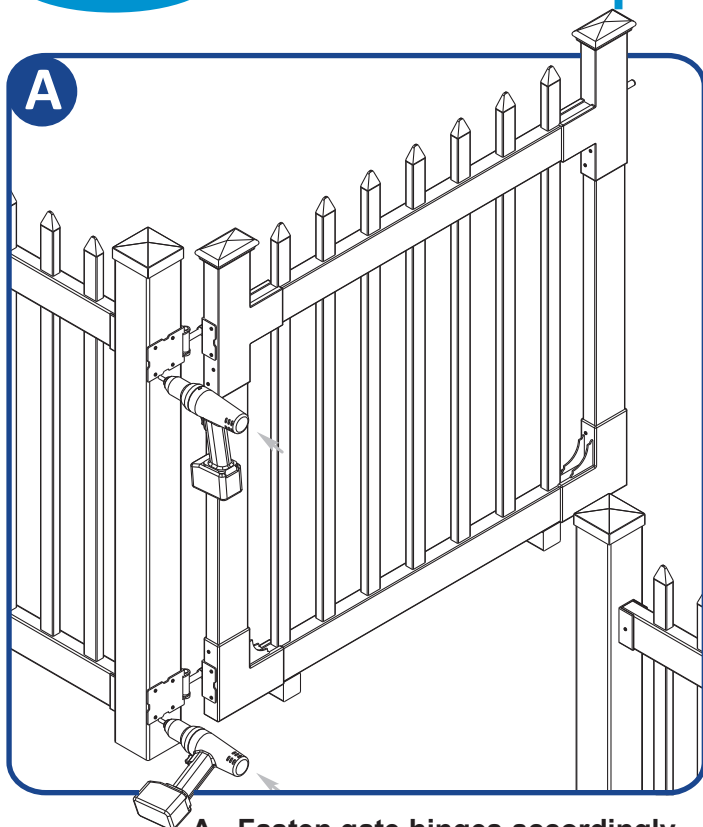

**A** - Fasten gate hinges accordingly

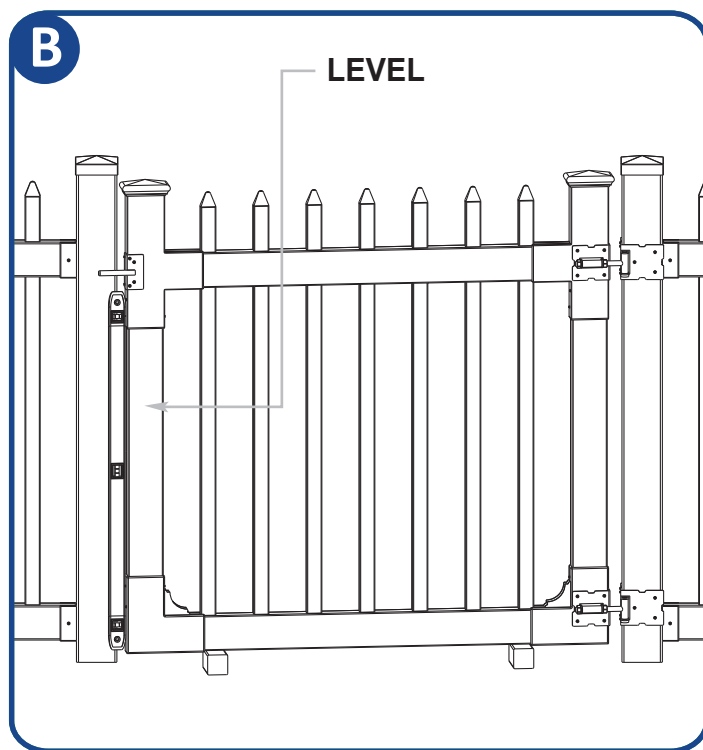

**B** - Check for level, fit and function to latching post

# WamBam Nantucket Vinyl Picket Gate w/Stainless Steel Hardware

# WamBam FENCE

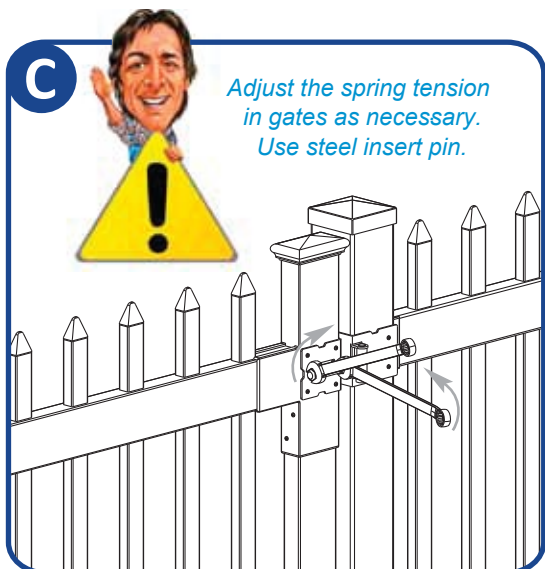

**C** - Hinges can be adjusted moderately to bring gate into level alignment with post

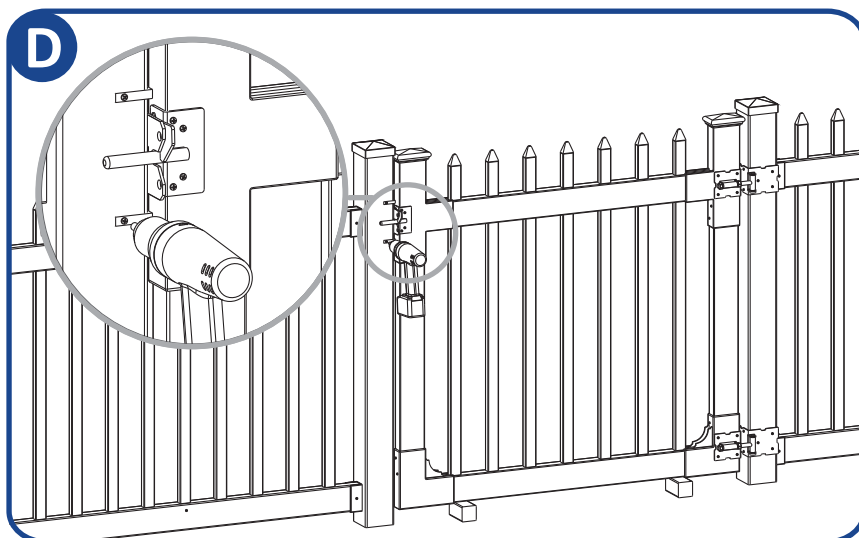

**D** Latch is designed for left and right hand applications. Temporarily remove the spring, bolt and reverse paddle portion as necessary.

## STEP 8 Align & Install Latch

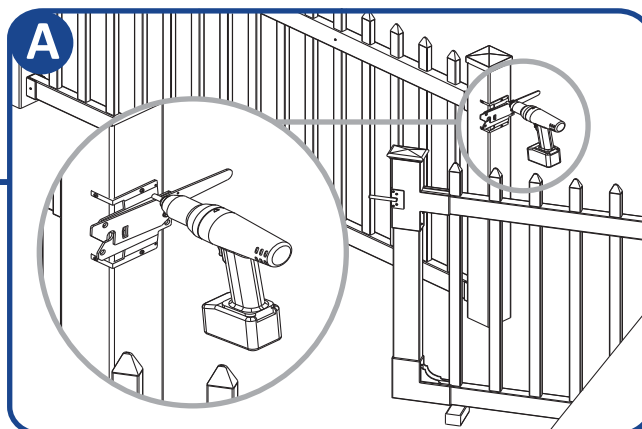

**A** - Align and fasten the gate latch catch to fit and function with the gate finger.

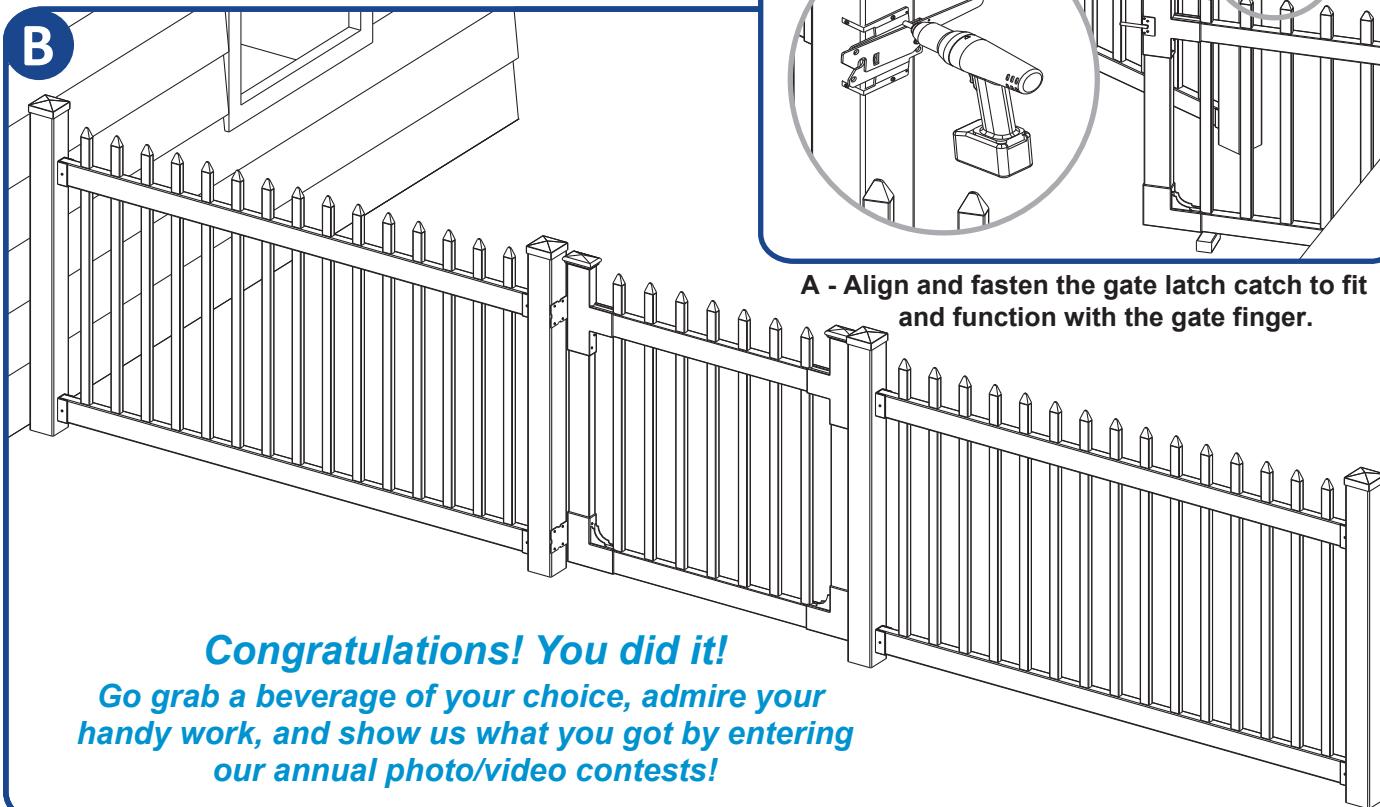

**Congratulations! You did it!**

Go grab a beverage of your choice, admire your handy work, and show us what you got by entering our annual photo/video contests!