

72" x 40" x 24" (1829 x 1016 x 610 mm)  
 Gallon to Overflow = 112 (Liters = 424)  
 Factory installed integral drain.  
 Freestanding Bathtub  
 Non-Textured Tub Floor

## Material:

Acrylic

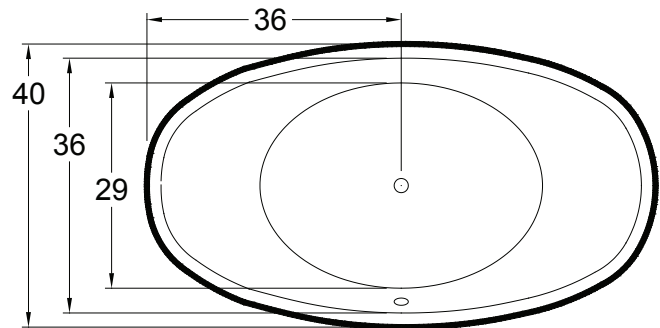

## Colors/Finishes:

- Biscuit
- White

## Codes/Standards/Approvals:

- Underwriters Laboratories (UL)
- Underwriters Laboratories - Canada (cUL)
- Canadian Standards Association - (CSA)
- ANSI Z124.1, ANSI Z112.19.7, ANSI A112.19.8

## General Information:

- Install according to Owner's Manual and local codes
- Hot water supply should be 65-75% of tub capacity or greater.
- Always consult your local plumber for recommendations as installations will vary.
- All specifications are subject to change without notice.

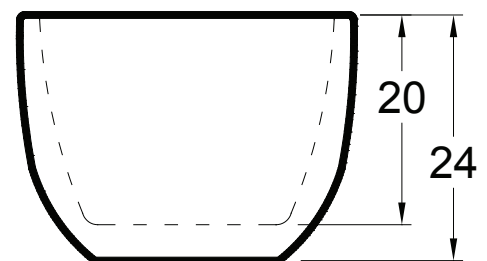
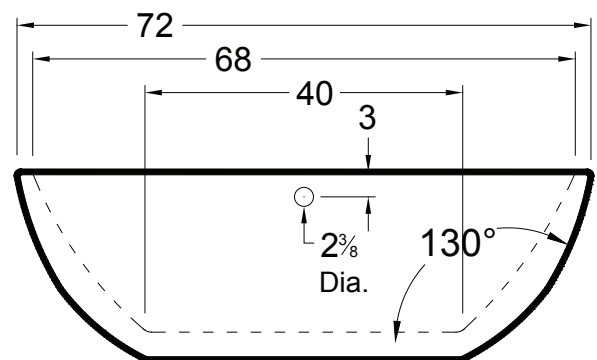

ALL BATHTUB DIMENSIONS ARE +/- 1/2"