



WHERE STYLE FLOWS

Porcelain Drop-In Sink Guide

Porcelain Drop-in Sink,
NP-DI012185521

Over Flow Sink
Drain w/ Overflow Required

Glazed & Double-fired
For Durability

Drain Opening
1.75" Standard

Installation
Drop-In

THANK YOU

We would like to take this opportunity to thank you for choosing Novatto. We hope you are truly satisfied with our product(s) and enjoy it for years to come. As a small business, we learn the most from you, the customer. Please visit the link below and leave us a review with a good, high-resolution image and you could win a \$25 Amazon or Visa gift card.

It's easy as...

- Go to novatto.com
- Find your product's page
- Scroll 1/2 way down, on the right click the white button "Write a review"
- Review, submit... Enjoy!

NOVATTO
WHERE STYLE FLOWS

Novatto | P: 844.404.4242
support@novatto.com
Novatto.com



PORCELAIN SINKS 101

In the 18th and 19th century, the "vanity" was more of a table that held not only a handbasin and water jug but also wigs, hairbrushes and other items. By the end of the 19th century though, the handbasin and water jug - the "bathing facilities" in the bedroom - changed rapidly. Newly built homes were being equipped with a separate bathroom. Factories that used to focus on pottery for tableware now started to produce ceramic bathroom pieces from sinks to tubs. Sanitary firms started to produce washbasins that were completely made out of the more hygienic porcelain or fire clay.

During the late 19th century, the washbasin became a piece of furniture with a deep-set bowl and a water tank. The basin was filled with warm water from the tank in the morning, and the basin, now part of the countertop, would be emptied in the evening. Once running water was installed, these pieces of furniture would be connected to the water supply and sewage system.

Over the years, the porcelain basin, set in the countertop, began to change into a square basin with raised edges, preventing water from splashing all over the vanity. Corner basins were added to hallways, next to the lavatory. Now one could wash their hands after being outside but could also wash up after visiting the toilet. These corner basins were designed with a high back to prevent water from splashing on the wall.

Today there are many choices for your bathroom sink, from drop-ins, to vessels, to undermounts. Novatto is pleased to offer you this wide variety.

TOOLS NEEDED FOR ASSEMBLY

(not included)



Questions, problems, missing parts? Before returning to your retailer, call our customer service department at 844.404.4242, 8:00 a.m. - 5 p.m., MT, Monday - Friday. Or email us at: support@novatto.com

DROP-IN ASSEMBLY

Steps to Complete Your Drop-in Sink Project

- Measure **inside edge** of lip and mark the countertop accordingly
- **Cutout of the counter** should be ½ - 1.5-inches inside than the diameter of the sink
- **Before applying silicone**, drop the sink into the counter to ensure a nice fit.
- **Apply silicone** around cut-out on counter top, and place sink in cut-out.
- **Use a level** to ensure the sink is level in every direction.
- **Carefully** remove any excess silicone
- **Install the drain** according to specs when the sink has fully set.
- **When cleaning** do not use abrasive cleaners.

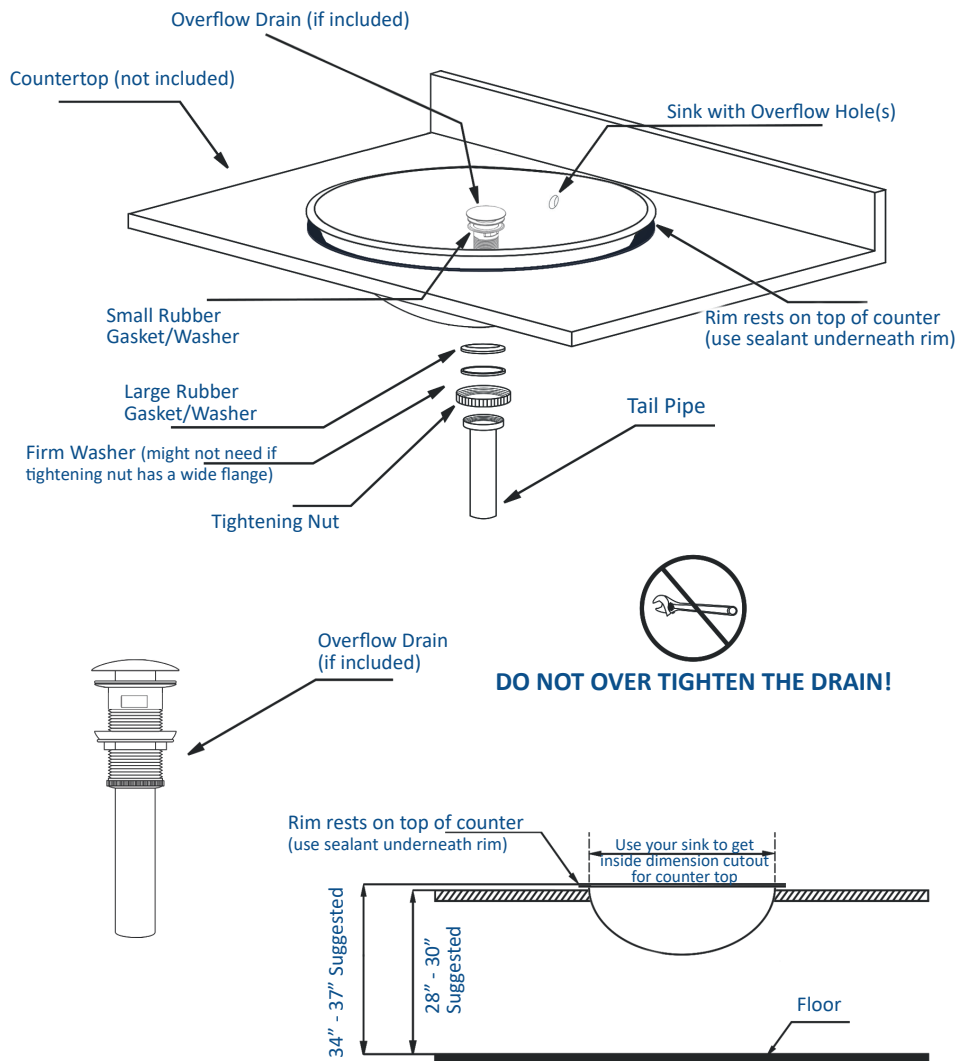

PLEASE NOTE - DROP-IN SINKS:

- Review and abide by all building and plumbing codes.
- Have a licensed professional install your Novatto sink.
- Evaluate current or desired cabinetry. If you are building or remodeling the area from scratch, you will be able to choose cabinets specifically made for drop-in sinks.
- Some counters require different cutting methods; seek the details of your chosen countertop material.
- Novatto recommends consulting an experienced cabinet maker for assistance and providing them with the actual sink to ensure a custom fit. There is no template.
- Be careful when unpacking the sink, we advise setting it on the packing it was received with.
- **Do not use** standard plumbers putty or oil-based sealers. These products will stain the porcelain. Please use 100% silicone gel (non-water based) or a stain-free putty, on the inside of the sink to seal the drain.
- Check to make sure the sink is sealed watertight.
- Use non-abrasive cleaners when cleaning up.
- Allow adequate room for faucet and back-splash when laying out the sink

CARE AND MAINTENANCE

Porcelain sinks have been around forever, and they’re still popular, because porcelain is such an easy-to-clean material. As a sink material, porcelain has a lot more going for it than cast-iron, which is super heavy. Plus, the sink is coated with a thin layer of glass giving it its glossy appearance and durability.

One of the distinctive characteristics of a porcelain sink is that contain millions of minute pores which act as a natural gathering place for minerals deposits, soap scum, mouth wash, toothpaste, or other hygiene products which can cause unsightly stains. The absorption and build up of these deposits over time will tend to dull your sink’s finish, and it will lose its shine after years of exposure. But sealing it with a sealer like *Glacier Ice wipes will create a barrier on the sink’s surface, so these deposits can’t gather or collect. This will eliminate the beginning of stains and makes future clean-up fast and easy.

After cleaning your sink and sealing it for the first time, simply use a mild soap and water for your everyday cleaning. To keep your sink from potential staining, and discoloration it is advisable to rinse out the sink after use and give it a good wipe down if needed. We suggest you leave the water running while brushing teeth, using mouth wash or cleaning/shaving your face. This will ensure the sink maintains its color, gloss, and appearance for a very long time. If staining occurs, use a porcelain cleaner like **Glacier Ice’s Faucet and Sink Restorer Cleaner with Sealer Kit.

A sink made of porcelain is a strong option that holds up well over time, so your sink should last for years if you care for it well.

Warning: Porcelain sinks can be harmed using certain sink cleaners. Abrasive cleaners and chlorine bleach can permanently damage the finish if left on for too long. Products like Soft Scrub can leave an off-white film that is hard to remove. Abrasive tools like scouring pads, pumice scouring sticks or steel wool could cause unsightly scratches to appear on your sink.

**GLACIER ICE SINK AND FAUCET STAIN GUARD AND SEALER protect sinks, faucets, counters, shower doors, and fixtures from hard water deposits and will keep them looking great for a year or more. The wipe-on treatment prevents oxidation on glass, ceramics, stainless steel, porcelain, and stone. It also inhibits the growth of pathogens while preventing mold, mildew, corrosion, oxidation, and dirty mineral buildup caused by hard water.*

**If wipe arrives dry, re-activate by moistening with rubbing alcohol. You do not have to saturate the wipe, just get it moist enough for use.*

***GLACIER ICE FAUCET AND SINK RESTORER CLEANER WITH SEALER KIT is a two-in-one system which not only removes water stains and mineral buildup, but also seals the surface from future contaminants! It will clean and protect sinks, faucets, counters, shower doors and fixtures from hard water deposits and will keep them looking great for an entire year. Harsh chemicals, scrubbing agents, or acid-based cleaners can create a cleaning cycle disaster. The Restorer Cream removes mineral buildup and oxidation from glass, ceramics, stainless steel, porcelain, and stone. The Super Sealer will protect from further corrosion and oxidation by bonding to the surface making it easy to clean, anti-static and more hygienic.*

TROUBLESHOOTING TIPS DROP-IN

| Issue | Reason | Solution |
|---|--|---|
| Finish is changing color or is loosing its shine/luster | Abrasive cleaners, soaps or other factors constantly in contact with finish. | Stop using abrasives. Might have to have sink refinished. |
| Does not completely drain | Drain is too high; too much silicone used around drain’s flange | Make sure drain’s flange isn’t resting on top of sink’s hole; Remove any excess silicon |
| Leakage under sink | Drain has come loose; gasket(s) are not in proper position | Tighten fastener under counter; Face gasket(s) up; Use plumbers’ tape |
| Sink seems to be sagging / separating from countertop | Silicon didn’t set long enough before using; Countertop not leveled | Reseal, set for 24 hrs; Level counter top using shims if necessary |

Porcelain Drop-In Sinks

FAQs

Do I need to seal my porcelain sink? If so, why?

Short answer is yes. All sealers, even those that are factory applied, will break down over time and become less effective. And the glaze on your porcelain is no different. Most sinks, to a degree, lose their luster and therefore it is important to protect your sink against harmful substances in everyday use.

Sealer prevents dirt, oil, minerals, contaminants and stains from penetrating the porcelain. Your sink may have come with *Glacier Ice wipes which will seal the sink's surface and prevent stains. Be sure your sink is completely clean before sealing it. We then recommend re-sealing every year or two to keep your sink in its gleaming state. If your porcelain sink is properly sealed, it will pretty much last for hundreds of years!

**If wipe arrives dry, re-activate it by moistening the wipe with rubbing alcohol. You do not have to saturate the wipe, just get it moist enough for use*

Is there a template for my sink?

No, the installation is pretty easy. Just cutout the appropriate size hole in your counter top, drop the sink in, check fit, level, adhere. Done.

Is there a difference between Ceramic and Porcelain sinks?

Ceramic is a general term for materials made by heating clay in a kiln. Porcelain is a type of ceramic that is heated to a much higher temperature than other ceramics, between 2,200- and 2,600-degrees F. This extreme heat adds strength to porcelain. Otherwise there is no real difference.

Should I hire or consult a professional?

The benefit of hiring a professional is they have likely done the job dozens to hundreds of times. Precision is key to this project, to ensure no leaks nor surprise incidents in which you find your sink in the bottom of your cabinet!

Each sink will vary slightly in size because of the manufacturing process. Therefore, we suggest that you provide your cabinet maker with the actual sink to ensure a custom and safe fit. Otherwise, a poorly reinforced cabinet may lead to accidents, personal injury, or destruction of your sink.

Are clips needed with my porcelain drop-in sink?

No. Novatto's drop-in sinks do not need clips. No mounting hardware is needed. Simply adhere to the counter in the desired location.

Do your porcelain sinks have overflows?

Yes, some of our sinks have overflow holes and therefore need drains with overflows.

Considering porcelain sinks are manufactured differently than say copper or glass, are there any issues I should know about between porcelain and other materials?

About the only problem with porcelain is that it can crack or chip, which typically happens if you drop something heavy into your sink. Although porcelain is non-porous, its glaze is susceptible to staining and daily wear and tear. Over time your sink can dull due to soap scum and water with a high mineral content. Rust stains are another problem, especially if your water contains higher levels of iron. Also, watch out for mishaps with hair dyes, nail polish or any products containing chemicals that can harm or strip the finish off porcelain sinks.

WARRANTY

Novatto products have been made under the highest standards of craftsmanship and quality. Due to manufacturing characteristics of our porcelain products very slight variations in dimensions, and colorization are expected and are not considered defects. Porcelain sinks are durable and easy to clean. If you like the look, then it's hard to find a better choice.

Novatto offers no warranty with respect to the finish on the porcelain products, as it will naturally change over time and use. Novatto offers a warranty for defects in workmanship and/or materials for all of our collections when the product was purchased through an authorized Novatto dealer for up to one (1) year.

Under no circumstance will Novatto Inc. be held responsible for any damage as a result during or after product installation. Novatto accepts no liability for any damages to the floor, walls, plumbing or personal injury during installation. We will not be responsible for any labor or installation charges, or any other expenses associated with a defective product. Novatto Inc's only responsibility is the replacement, or exchange of a defective product.

Get the most out of your Novatto sink by registering!

By registering, you activate Novatto's product's warranty. Plus you will receive helpful tips and product information, learn of special events and much more.

If you believe you have a warranty claim, contact Novatto, either through your local Dealer, Plumbing Contractor, Home Center, or by writing: Novatto, Inc., Attn.: Product Support, 3533 E. Corona Ave., Phoenix, AZ, 85040, USA. Please be sure to provide all pertinent information regarding your claim, including a complete description of the problem, the product, color, model number, the date the product was purchased and from whom the product was purchased. Also include your original invoice. For other information email: productsupport@novatto.com. or write to the above address.

Novatto's porcelain sinks have a classic look and they are very popular. Our sinks are manufactured using molds, automated glazing and firing with calculated temperatures and glaze amounts.

We do some small touch-ups and will use hand-held polishing tools as needed. To be sure Novatto's product fits perfectly in your home, we recommend purchasing the product first and then build accordingly.



More questions? Feel free to contact our technical support team anytime. More info is also available at our website.

Novatto | P: 844.404.4242
support@novatto.com
Novatto.com

Need more help?

Feel free to contact our technical support anytime at 844.404.4242 or email us at: productsupport@novatto.com. More information is also available at: www.Novatto.com.