



PIONEER INDUSTRIES, INC.
3325 S. Garfield Ave.
Commerce, CA 90040
(800) 338-9468
www.pioneerind.com

INSTALLATION

Tools:



Adjustable Wrench



Plumbers Putty



Teflon Tape



Rags

Model Number: 4MO610T

Warnings and Notes:

Check with local plumbing code requirements before installation.
This product should be installed by a local listed plumber.
Do not use plumbers putty on threads.



Installation Steps:

Two Handle Roman Tub Trim Set

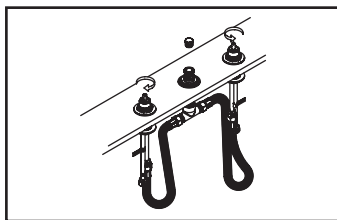

(1) Remove the mud guards from the spout shank and valves. Remove test cap from spout shank.

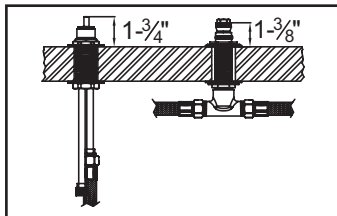

(2) Confirm the valve and spout dimension for 1-3/4" & 1-3/8" where 1-3/4" is the required valve height from the finished deck. And 1-3/8" is the shank height from the finished deck.

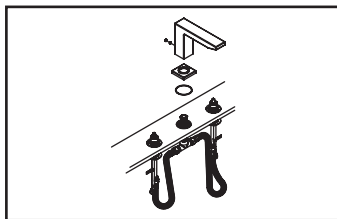

(3) Place the washer underneath of the spout escutcheon. Carefully slide the spout on the spout shank so the o-ring on the spout shank does not get damaged. Tighten the 1/8" Allen screw with the help of the Allen wrench tool provided. Do not overtighten. Place the hole cover to cover the hole.

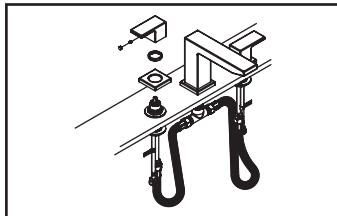

(4) Place valve escutcheon on both side valves. From top of valve escutcheon, thread sleeve on valve to secure valve escutcheon. Ensure handles move in correct direction; tighten Allen screw with help of Allen Wrench tool provided to install both side handles. Turn on both side handles to check for any leaks.

Exploded Drawing :

* Note: Please specify finish/color when ordering.

	ITEM #	DESCRIPTION
A	X-4900024	3/32" Allen Wrench
B	X-1400044*	Metal Lever Handle
C	X-4400108*	Valve Escutcheon
D	X-4400058	1/8" Allen Wrench
E	X-2400019*	Rigid Spout
1	X-4900002	Allen Screw
2	X-4900044*	Hole Cover
3	X-4400102	Flow Streamer
4	X-4400073*	Hole Cover
5	X-4400028	Allen Screw
6	X-4400109*	Spout Escutcheon
7	X-4400071	Flow Streamer Removal Tool

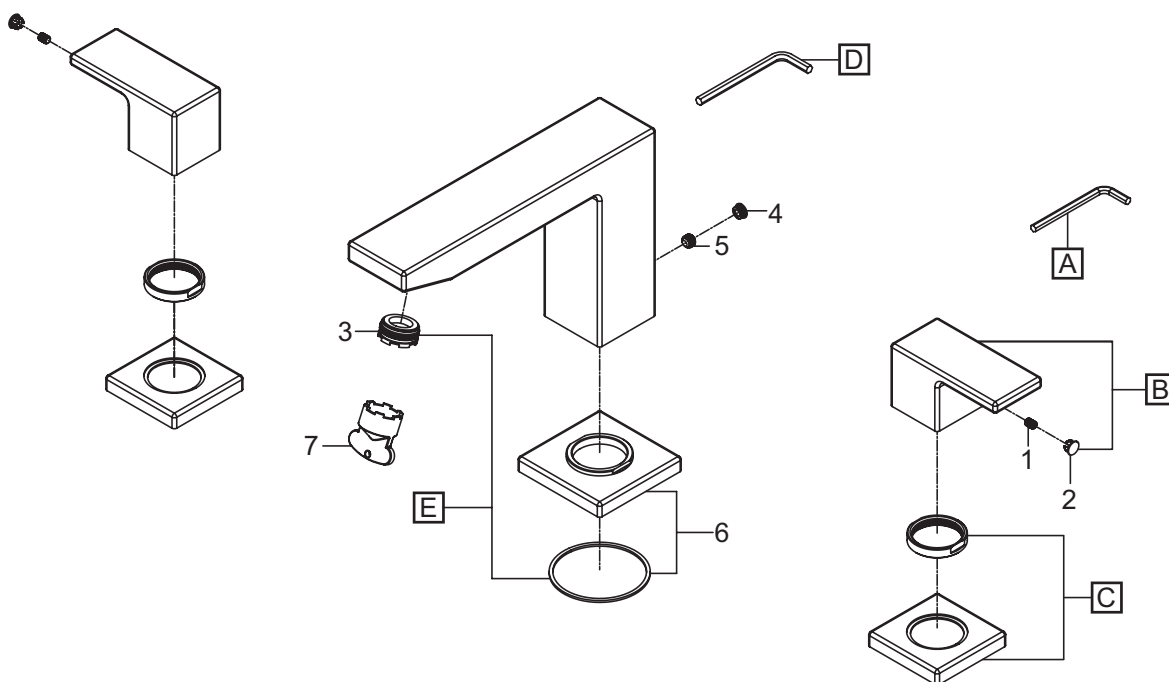

For more care information or trouble shooting inquiries about your Pioneer product, please call:

Pioneer Industries, Inc. (800) 338-9468

8AM - 8PM EST (5AM to 5PM PST)

www.pioneerind.com