

ASSEMBLY INSTRUCTIONS

Required Tool :

1. Allen Bolt
40 x 8mm
12 Pcs.

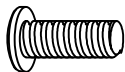

2. Flat Washer
12 Pcs.

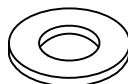

3. Allen Key
5mm
1 Pc

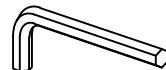

PARTS

Top

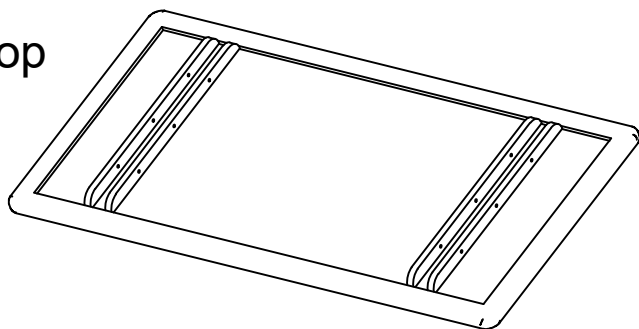

Leg

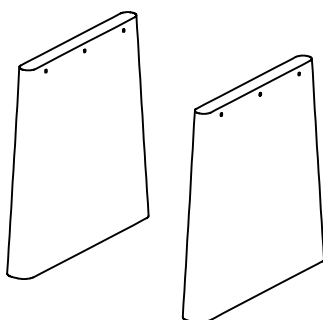

Step 1.

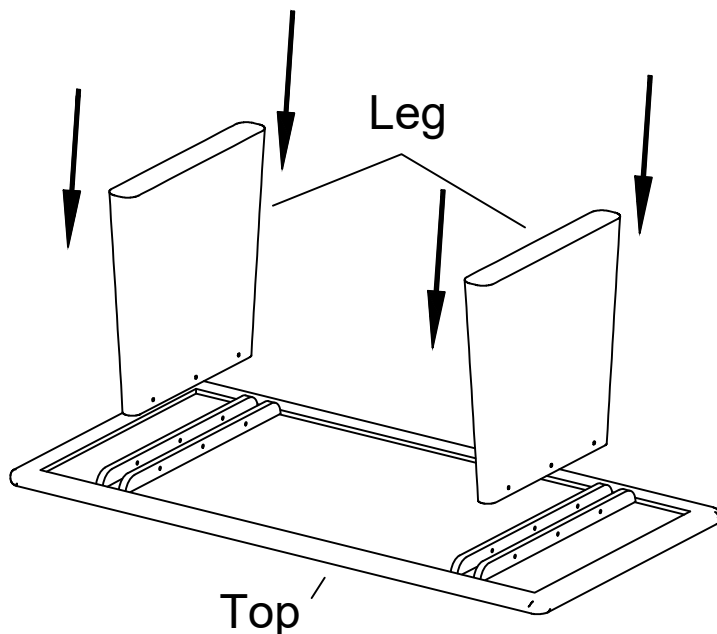

NOTE :- Place top on clean and dry surface to prevent damage to top.

Step 2.

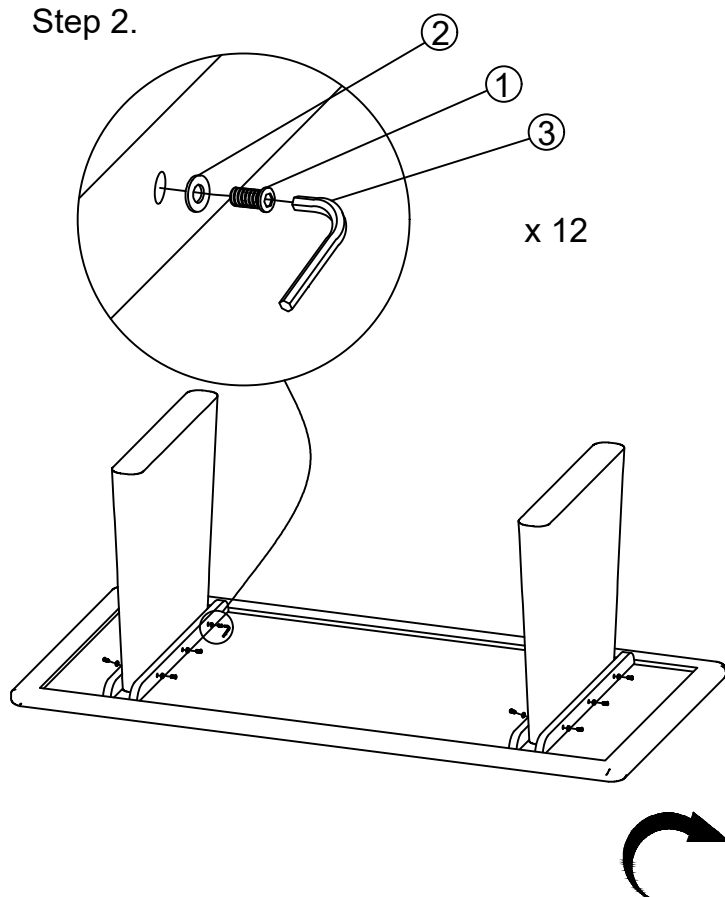

Step 3.

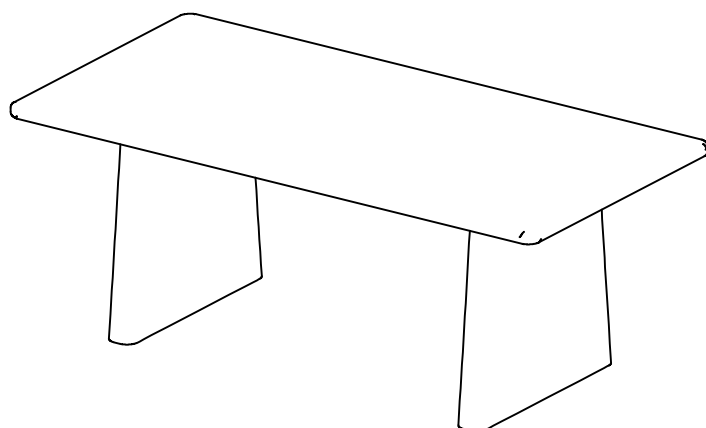

Your dining table is now ready to use.