

FAUX TIN CEILING TILES (Glue Up) - Installation Guide



Required Tools

- ✓ Scissors
- ✓ A measuring tape
- ✓ Oscillating Saw
- ✓ Compass
- ✓ An adhesive ([Instant Grab #310](#))
- ✓ Caulking gun

Ensure accuracy and levelness by using a level during the installation process.

Step 1. Preparing the Surface



Begin by preparing the surface for the ceiling tile installation. This involves figuring out the layout, which typically involves using full tiles in the main area and cut tiles along the perimeter. Take the necessary measurements to calculate the width of the border tiles, ensuring a consistent and uniform border.

Step 2. Determining Border Tile Width

$$BW = (CL - WD) \div 2$$

Add up the combined length of the full tiles. Subtract this distance from the wall dimension and divide the result by 2.

Alternatively, use the masking tape technique to determine the width of the border tiles.

Step 3. Mark the starting edge



Measure the width of the border tile at each end from the wall. Drive a small nail at one mark and stretch a chalk line between the nails.

Snap the line to create a perfectly straight starting edge.

Step 4. Tile Cutting Process

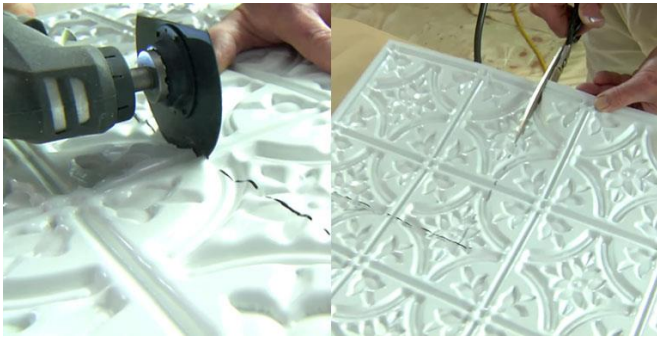

Begin laying perimeter tiles, starting from one corner of the room. Transfer measurements from the back of the tiles using a straight edge to draw a cut line.

Cut the tiles along the cut line using heavy-duty scissors or an oscillating saw.

Step 5. Affixing Tiles with Adhesive



Use a high-tech, high-strength water-based adhesive suitable for ceiling tiles. Place nickel-sized dollops of adhesive in the field and run a small bead around the outside edges.

Press the tiles into position, aligning the factory edge with the chalk line.

Step 6. Installing Field Tiles



After installing perimeter tiles on two walls, begin putting up field tiles. Use the overlapping edge design for alignment.

Place the factory edge of the new tile on top of the tab or lip of the tile already in place. Adjust for proper alignment.

Step 7. Customize Perimeter Tiles



Measure the remaining distance of the wall on both ends of the tile.

Transfer those measurements and cut the perimeter tile to fit the remaining space.

Step 8. Installing Full Tiles

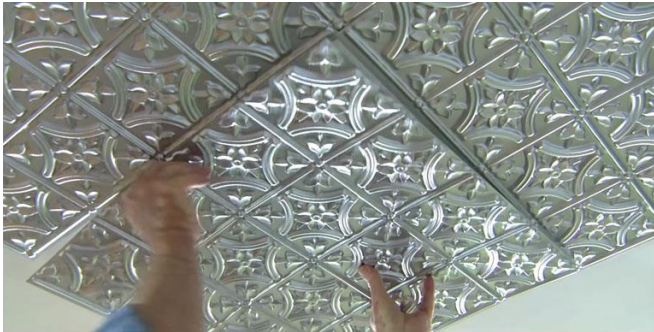

Install full tiles rapidly in the main area using adhesive.

If working with a partner, have one person apply adhesive and the other place the tiles.

Step 9. Fitting Boxes/Vents Area Tiles



Measure from the edge of the nearest full tiles to the center of the electrical box. Mark the intersection of those dimensions, draw a circle, and cut out the opening.

For air conditioning or heating vents, measure from the nearest full tiles to the edges of the opening and cut accordingly.

Step 10. Finalizing the Installation



Step back and inspect the installed ceiling tiles. Make any final adjustments, such as adding touch-up paint or filling any gaps if needed.

Clean the area and remove any debris.

FAUX TIN CEILING TILES (Drop-In) - Installation Guide



Required Tools

- ✓ Stepladder
- ✓ A measuring tape
- ✓ Adhesive (if preferred)

To ensure accuracy and levelness during the installation process of faux tin drop-in ceiling tiles, follow these steps:

Step 1. Check the color of the grid system

- If the lines of the grid system do not have the same color as the tile you intend to install, you need to paint them to achieve the right color balance.

Step 2. Measure the dimensions of the tile

- Remove at least one tile and use a measuring tape to accurately measure its length and width.
- This information is crucial for ensuring proper installation.

Step 3. Determine dimensions for corner tiles

- Measure the dimensions of the tiles located near the corner of the ceiling.
- Cut the faux tin drop-in ceiling tiles to fit these dimensions.

Step 4. Start installing the tiles

- You do not need to find the center of the room for installing faux tin drop-in ceiling tiles.
- Use the existing tile system as a guide.
- Begin by gently pushing the ends of the first tile into the creases of the existing grid system.
- Be careful not to apply too much pressure, but just enough to insert it over the existing tile.

Step 5. Repeat the installation process

- Repeat the same process described in Step 4 for the remaining whole tiles.
- Continue installing the tiles until you reach the corners.

Step 6. Secure the "cut-to-fit" tiles

- The "cut-to-fit" faux tin drop-in ceiling tiles may require an adhesive to hold them tightly in place.
- Since they are not held from all four corners into the existing grid system, an adhesive ensures a secure fit.
- If you were able to cut the tiles in a way that provides a tight fit between the wall, you may skip using adhesive.

Step 7. Finishing touches

- After completing the installation of all the tiles, perform any necessary touch-ups or adjustments to ensure a visually appealing and well-fitted ceiling.

