

Lucania Wall Mounted LED Waterfall Bathroom Sink Faucet

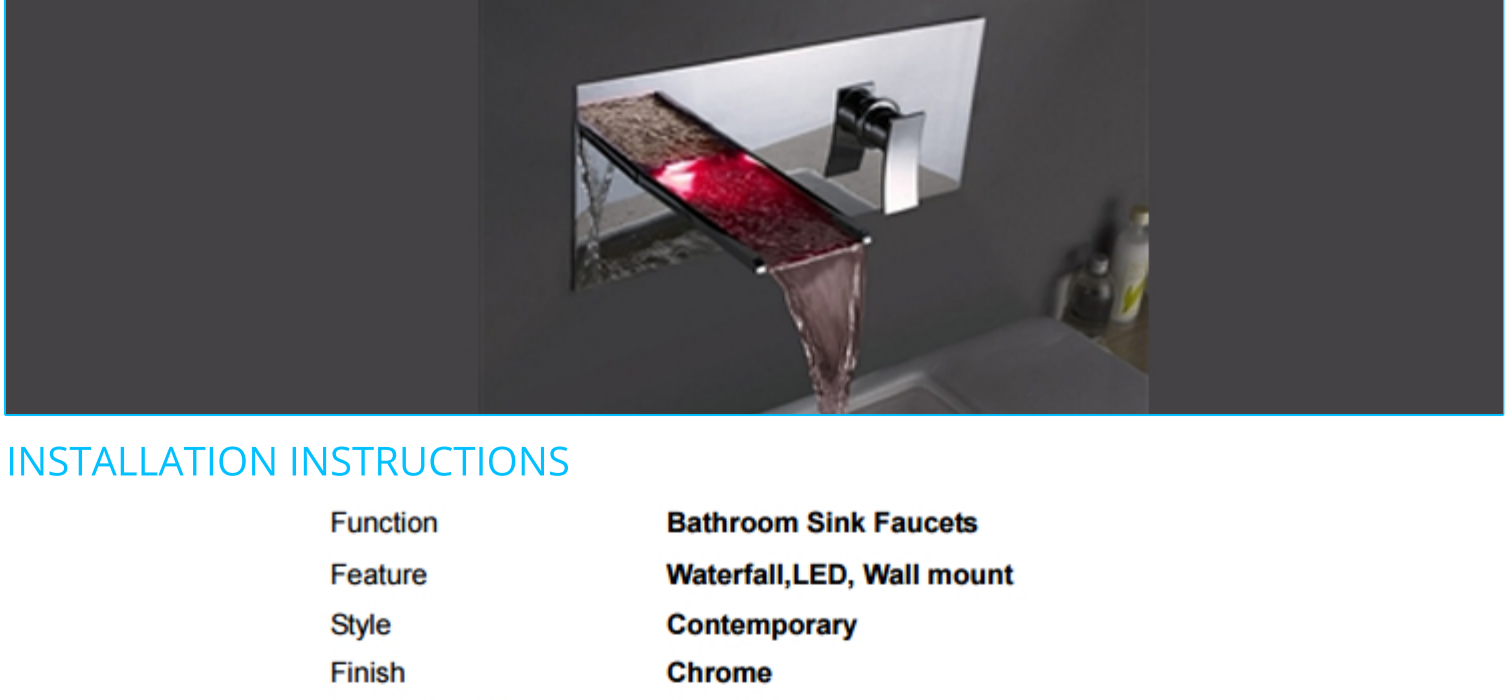

INSTALLATION INSTRUCTIONS

Function	Bathroom Sink Faucets
Feature	Waterfall,LED, Wall mount
Style	Contemporary
Finish	Chrome
Installation Holes	One Hole
Number of Handles	Single Lever
Faucet Total Height	-
Spout Reach	175mm [6-7/8 Inch]
Spout Width	126 mm [4-15/16 Inch]
Spout Height	-
Flow rate	6.8L/M [1.8 GPM]
Valve Type	Ceramic Valve
Faucet Body Material	Brass
Faucet Spout Material	304 # Stainless steel
Net Weight	1.8 KG [3-15/16 lbs]
Gross Weight	2.2 KG [4-7/8lbs]
Working water press	0.2 ~0.8 Mpa
Packing box size	305mm [12"]x 255mm[10"] x 110mm[4-5/16"]
LED power supply	Water flow generator

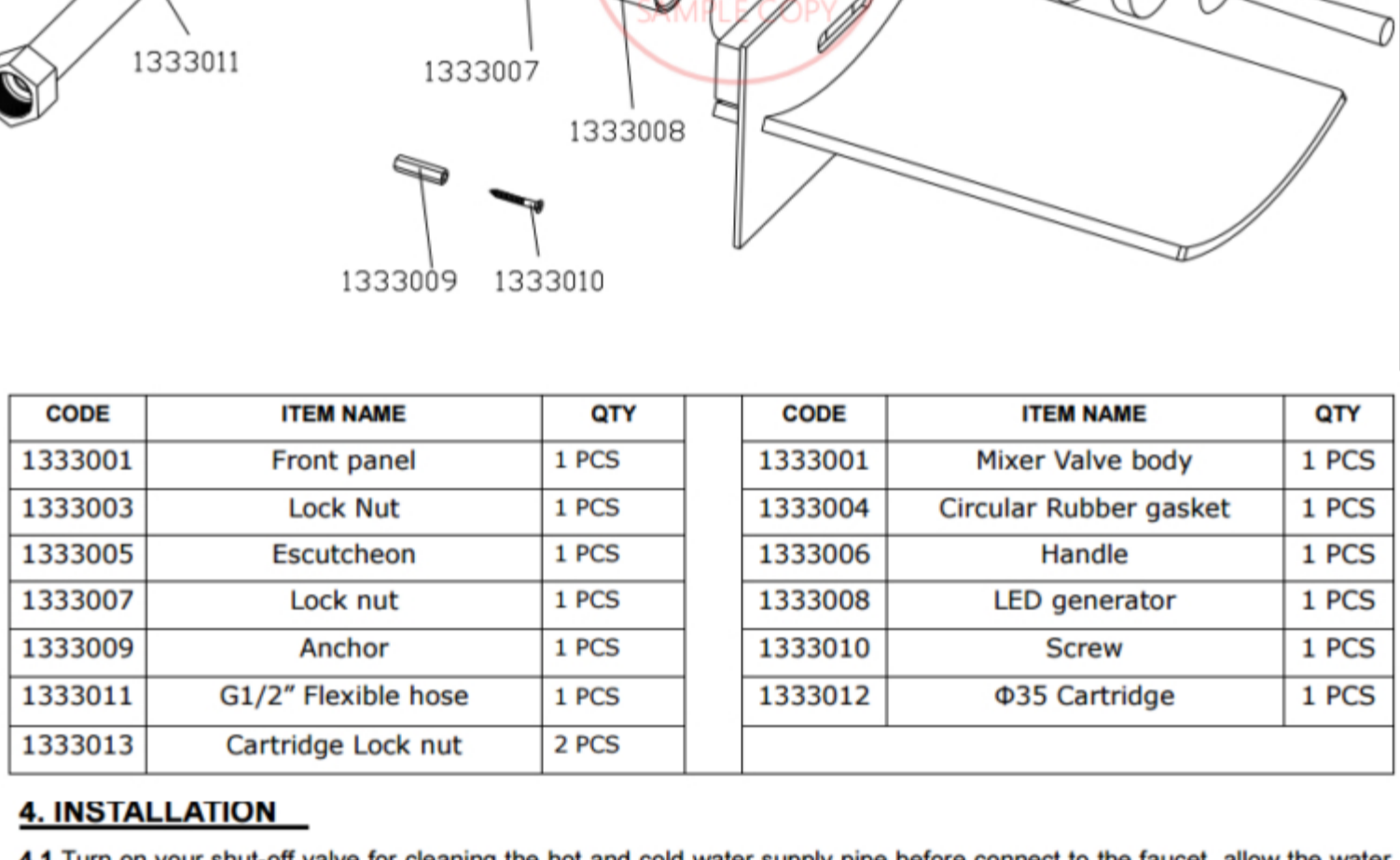
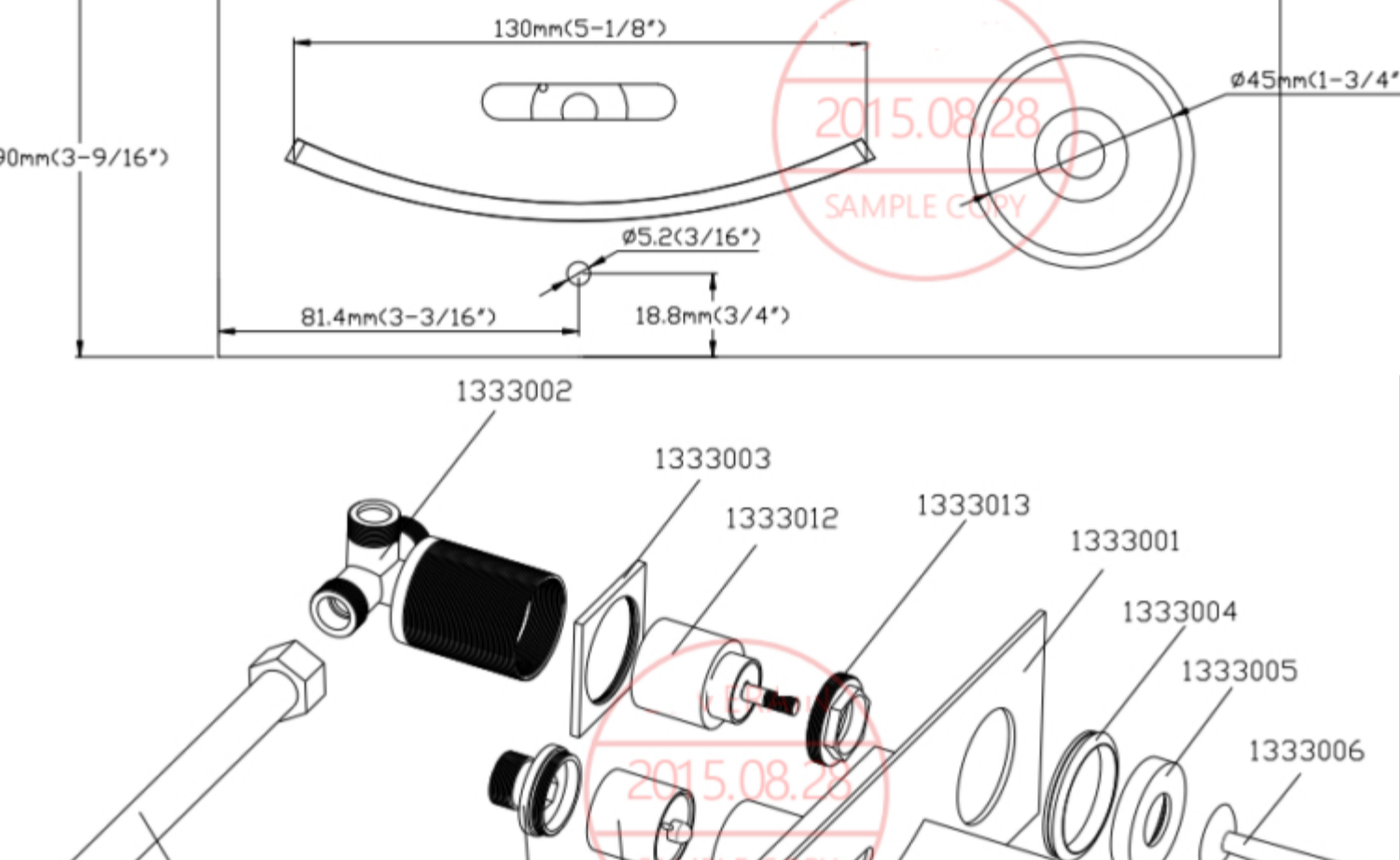
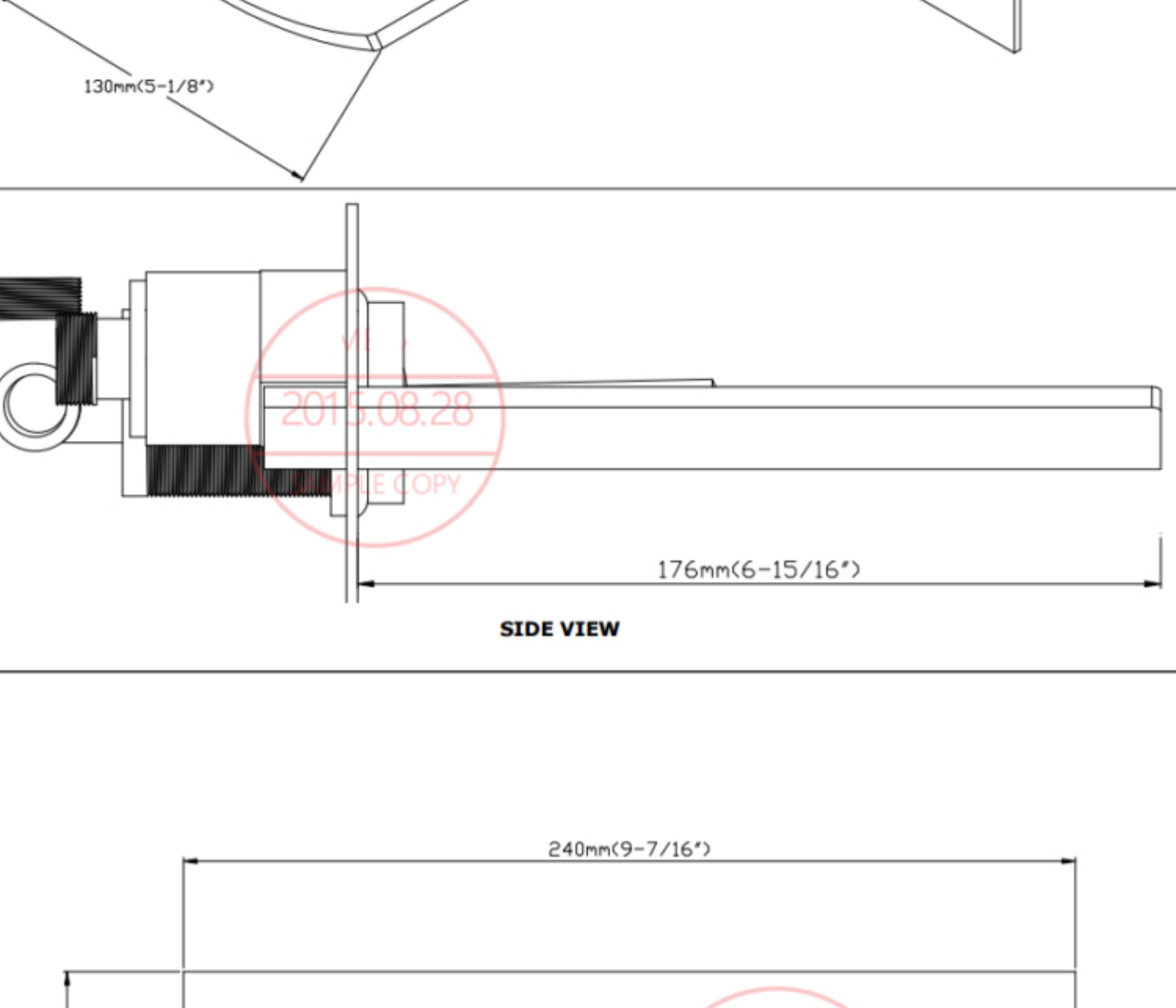

CODE	ITEM NAME	QTY	CODE	ITEM NAME	QTY
1333001	Front panel	1 PCS	1333001	Mixer Valve body	1 PCS
1333003	Lock Nut	1 PCS	1333004	Circular Rubber gasket	1 PCS
1333005	Escutcheon	1 PCS	1333006	Handle	1 PCS
1333007	Lock nut	1 PCS	1333008	LED generator	1 PCS
1333009	Anchor	1 PCS	1333010	Screw	1 PCS
1333011	G1/2" Flexible hose	1 PCS	1333012	Phi 35 Cartridge	1 PCS
1333013	Cartridge Lock nut	2 PCS			

4. INSTALLATION

4.1 Turn on your shut-off valve for cleaning the hot and cold water supply pipe before connect to the faucet, allow the water flush 3-5 minutes to flush out dirt and debris. Shut off the water supply again after finish.

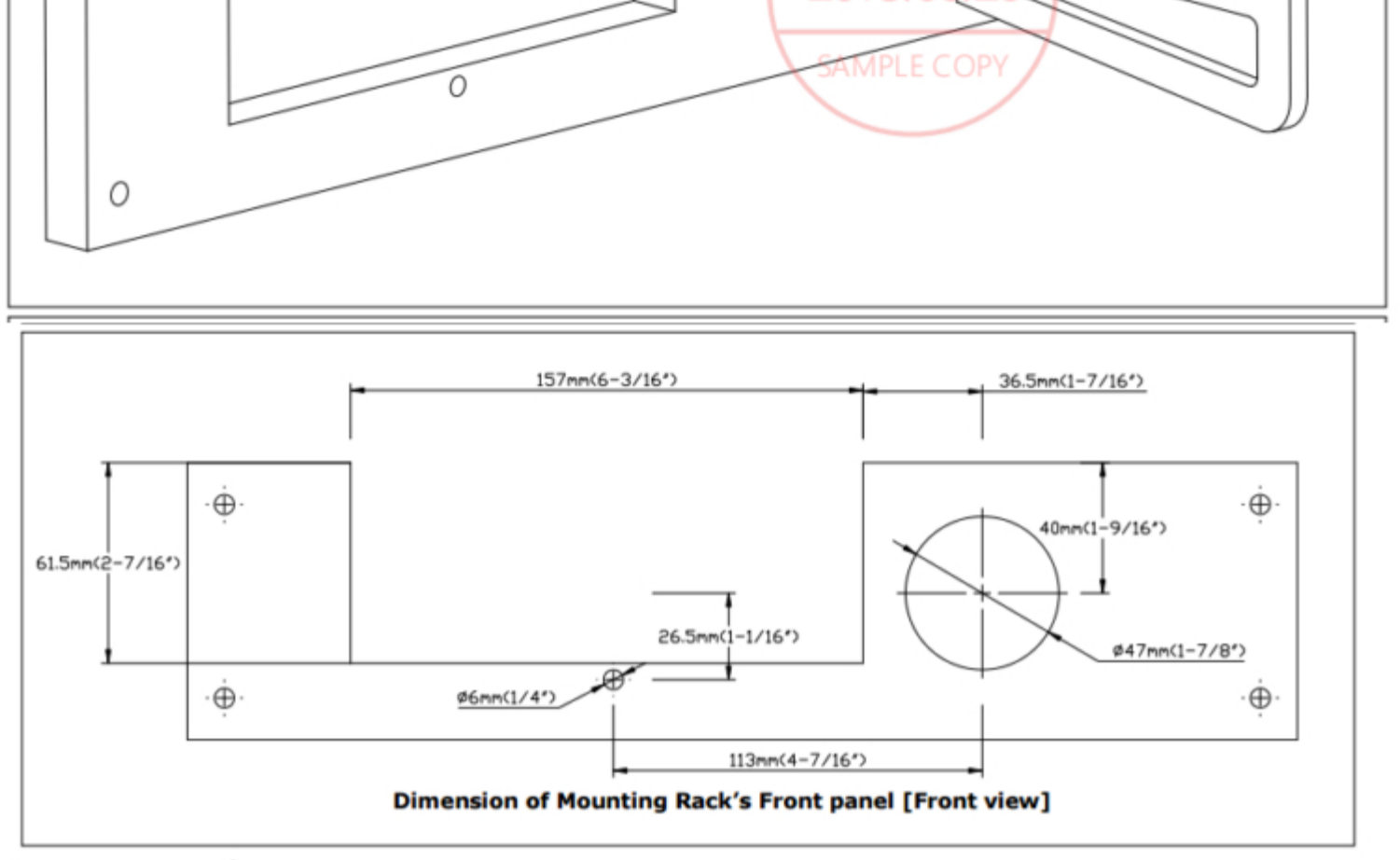

4.2 Make a front panel (normally use woods as materials) for establishing a mounting rack.

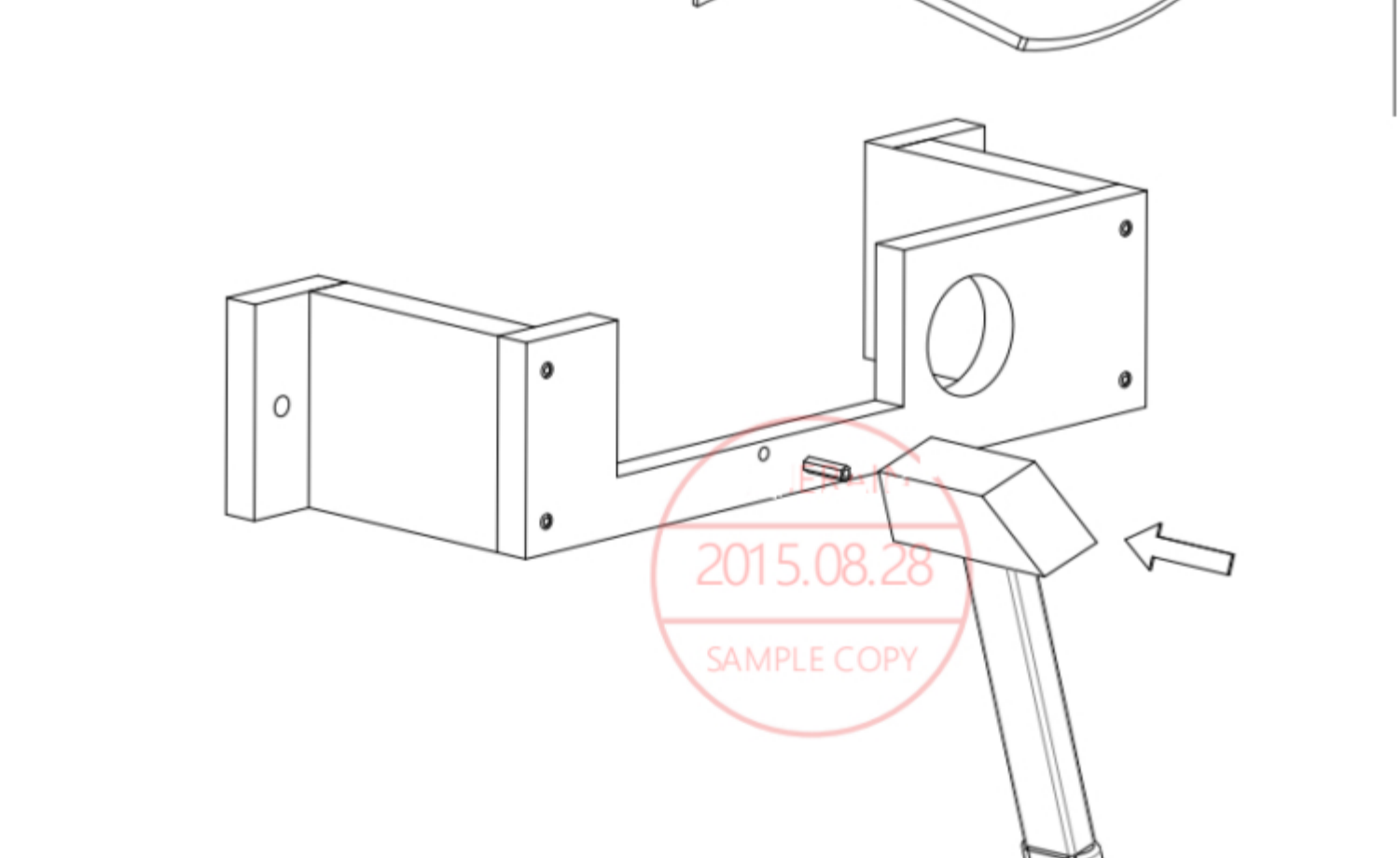
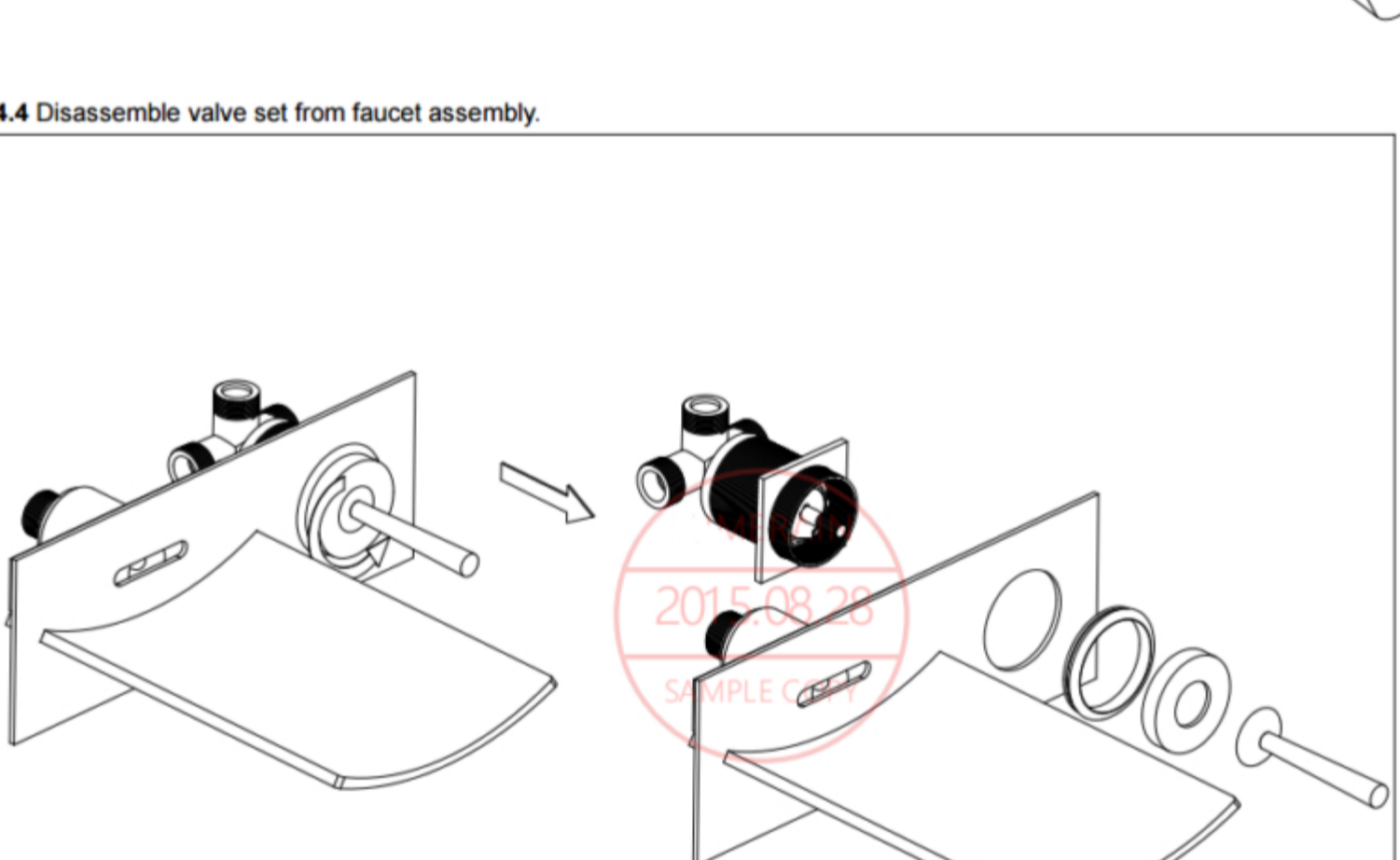
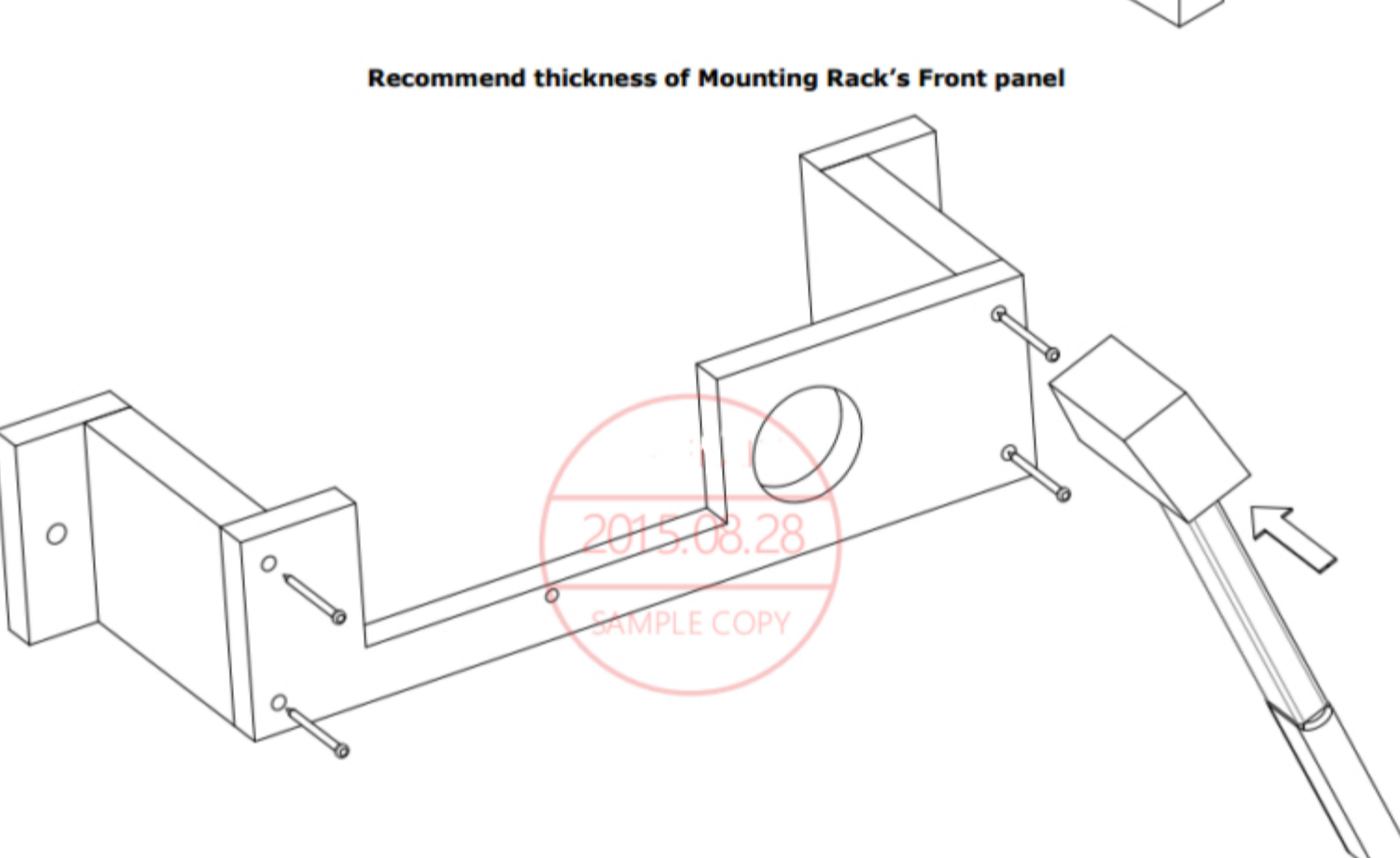
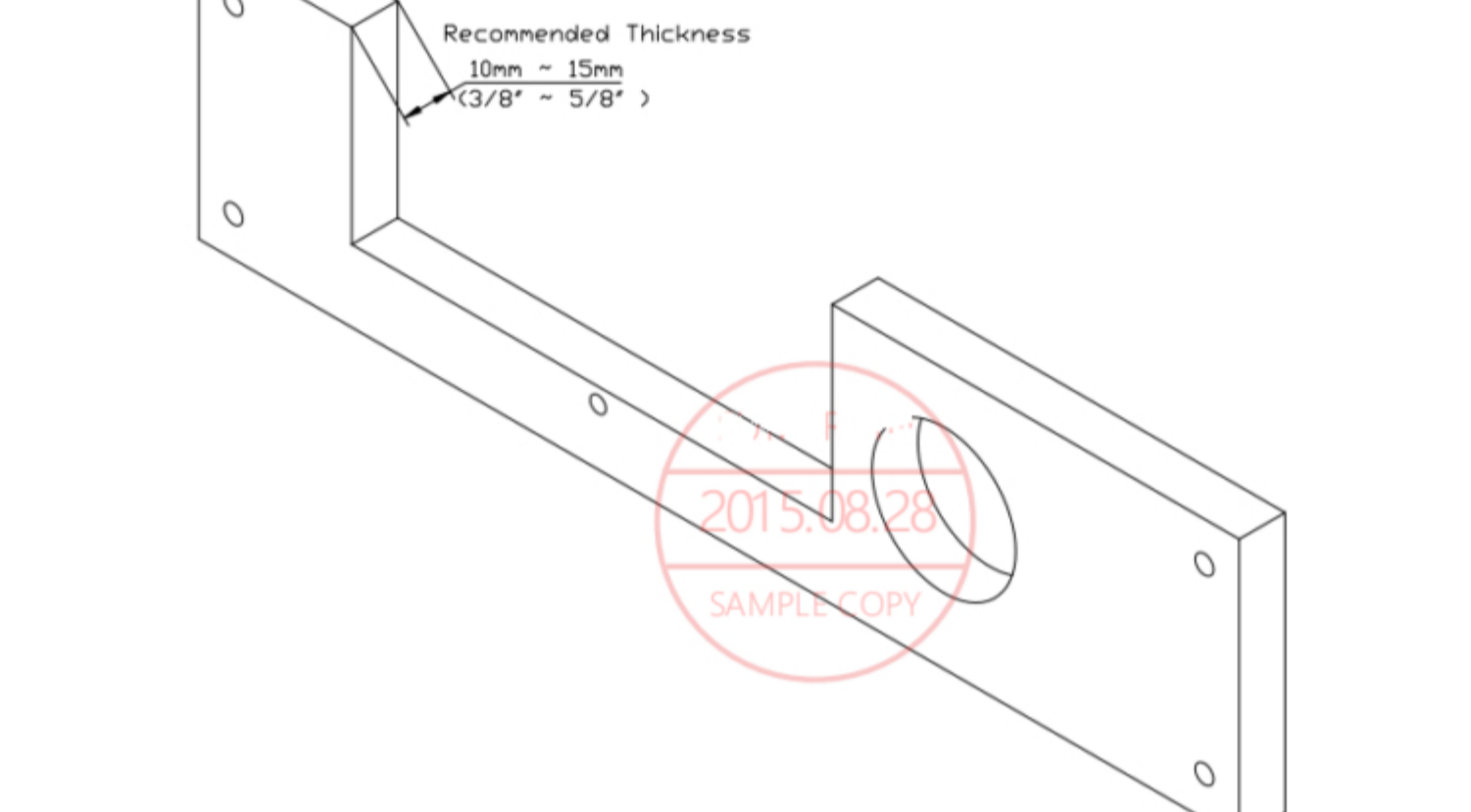

4.4 Disassemble valve set from faucet assembly.

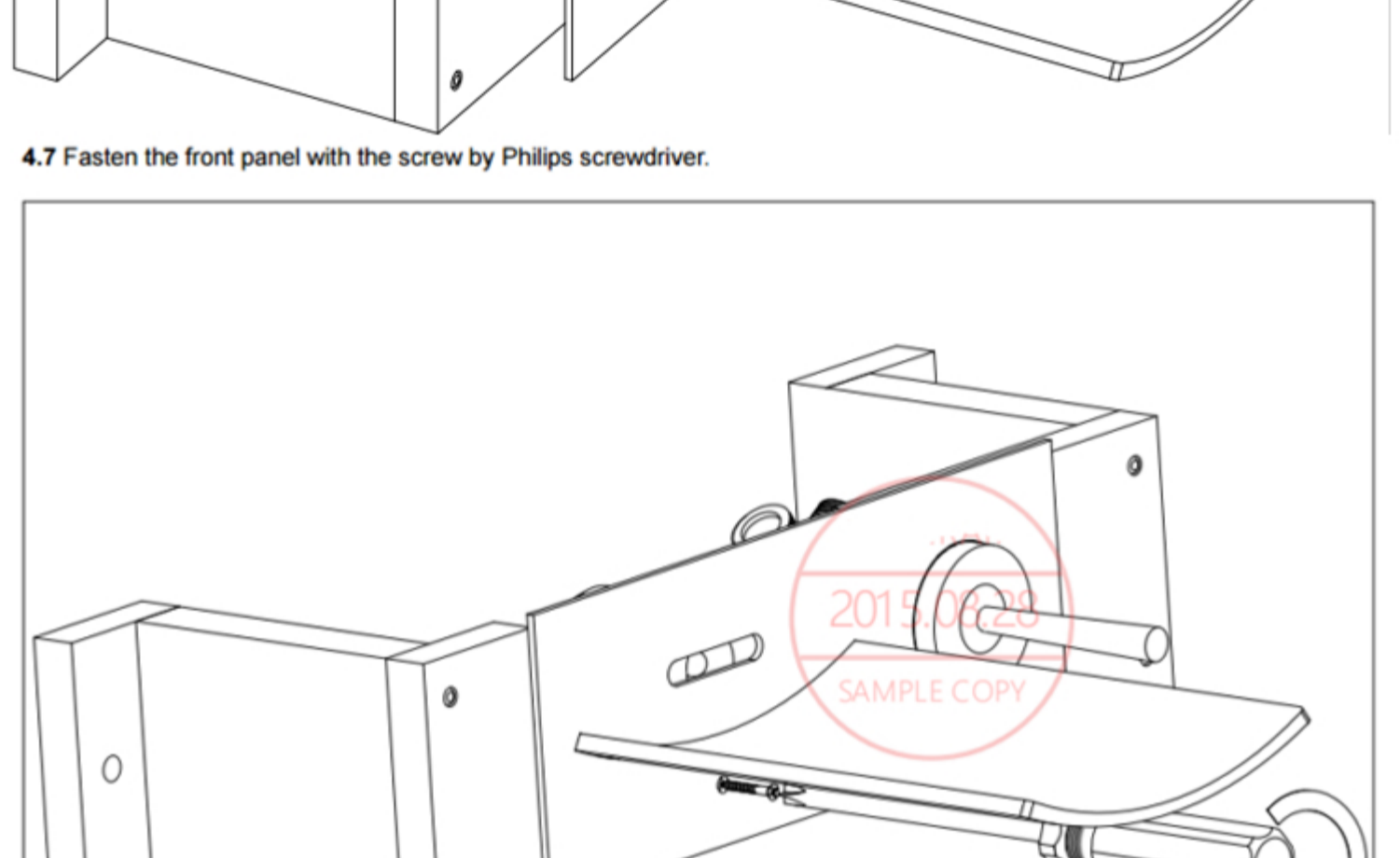
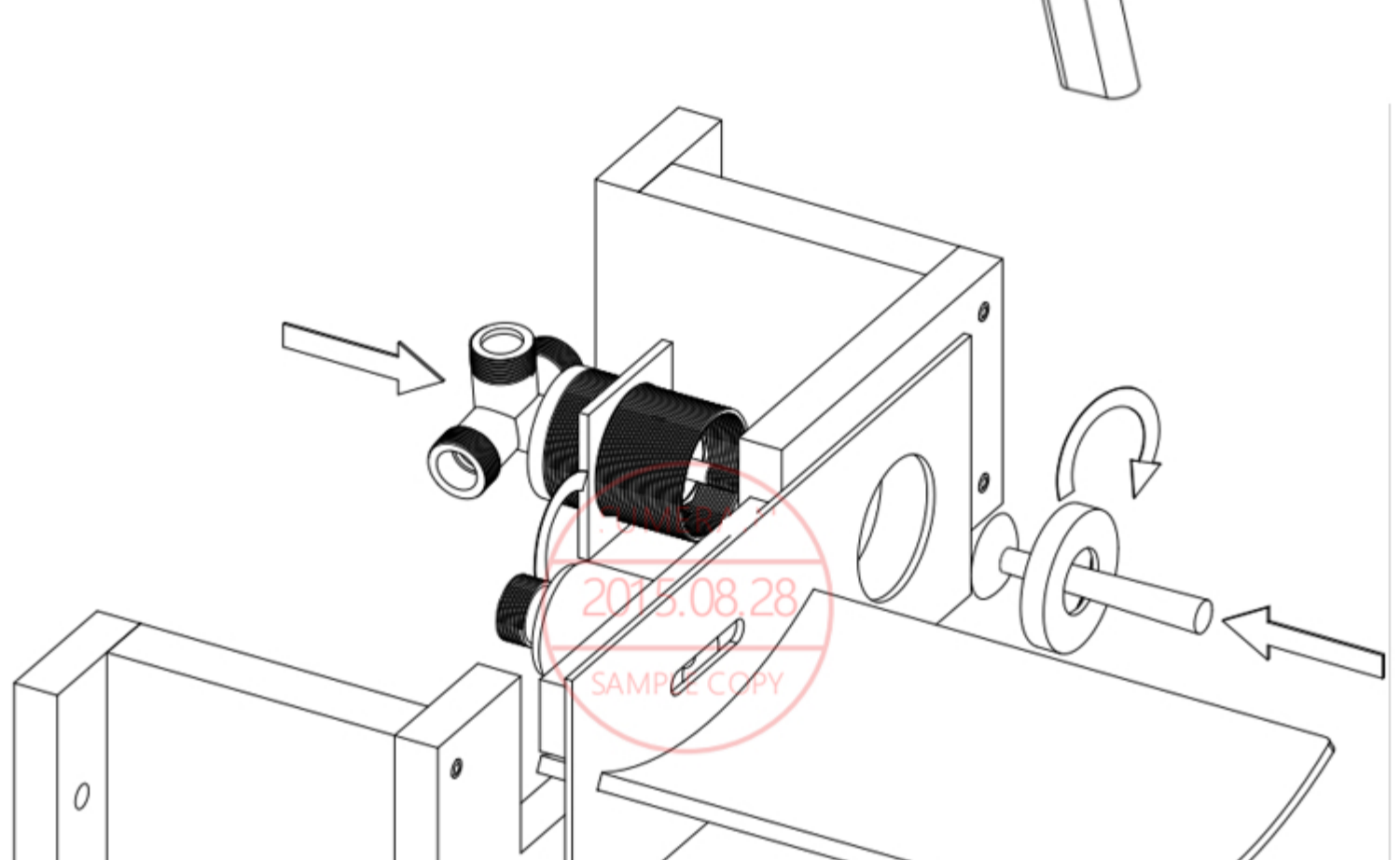

4.7 Fasten the front panel with the screw by Philips screwdriver.

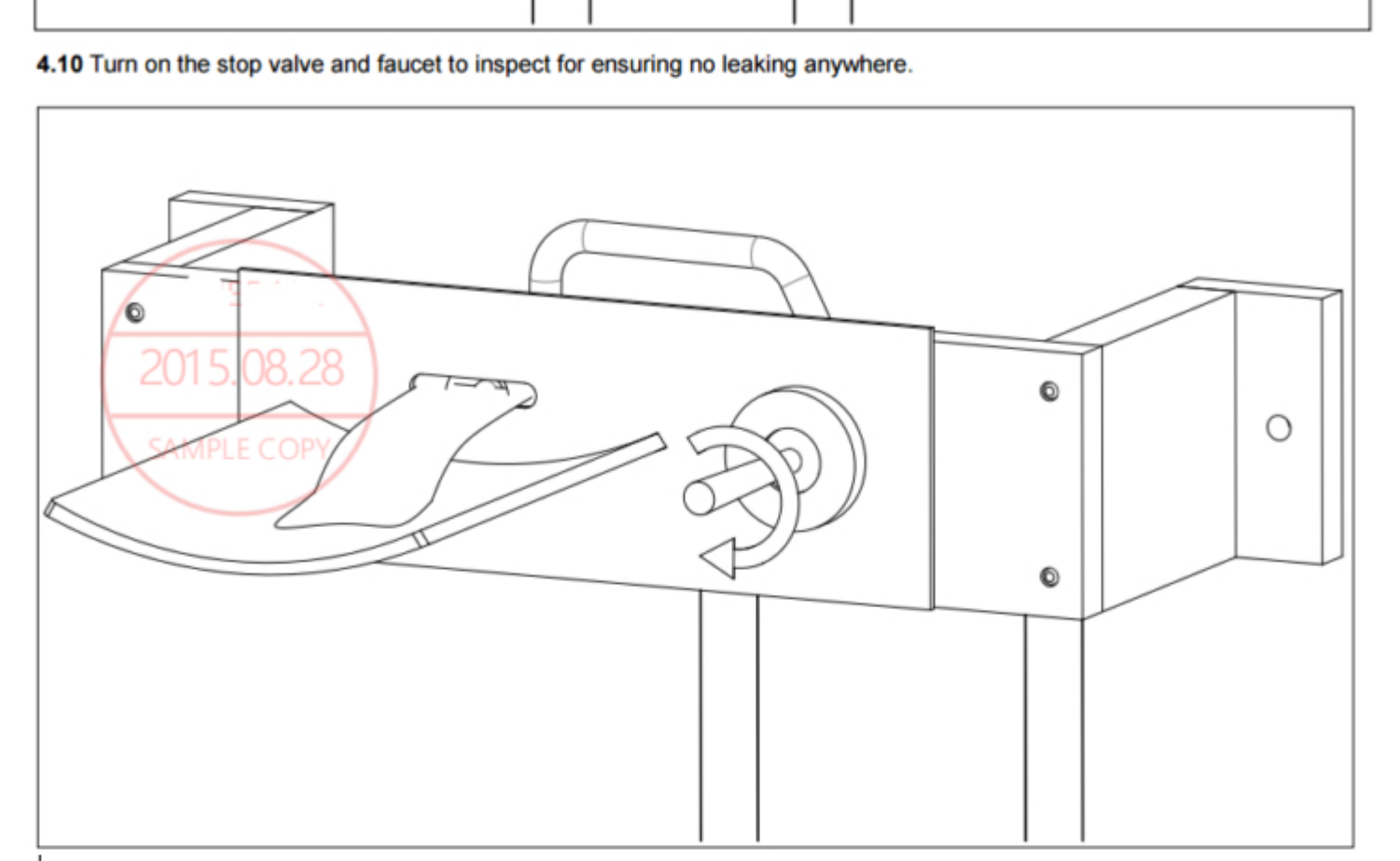
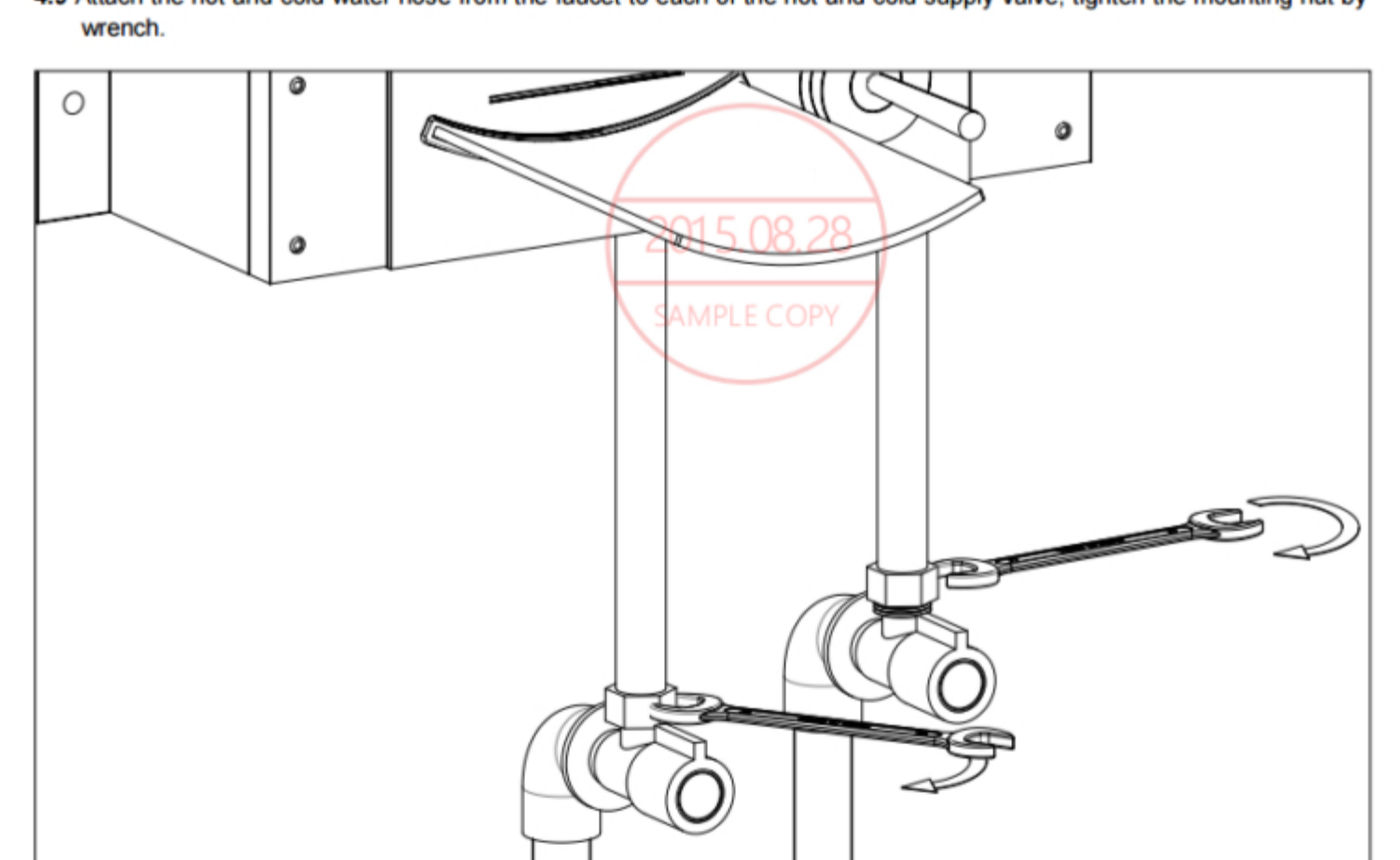
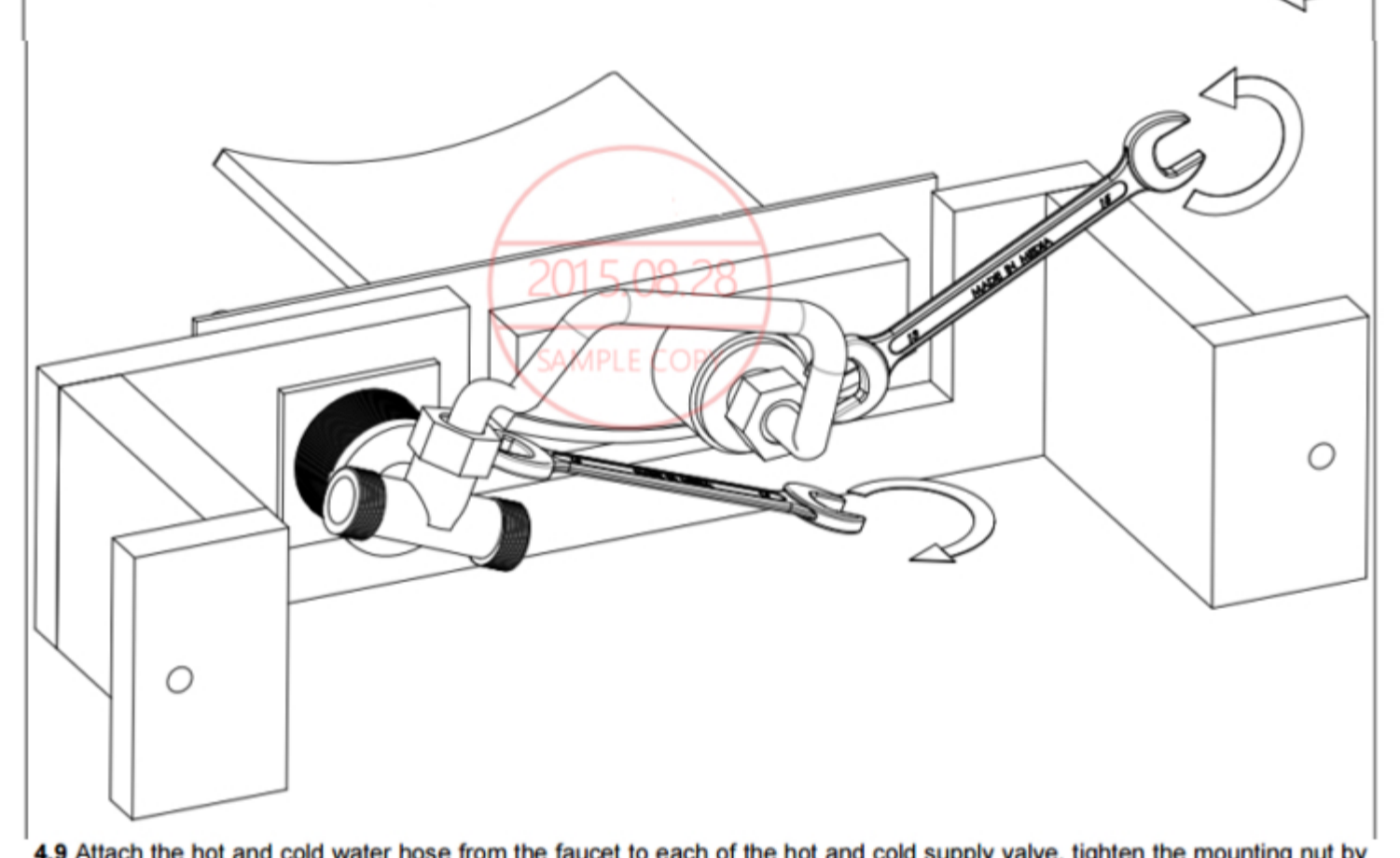

4.9 Attach the hot and cold water hose from the faucet to each of the hot and cold supply valve, tighten the mounting nut by wrench.

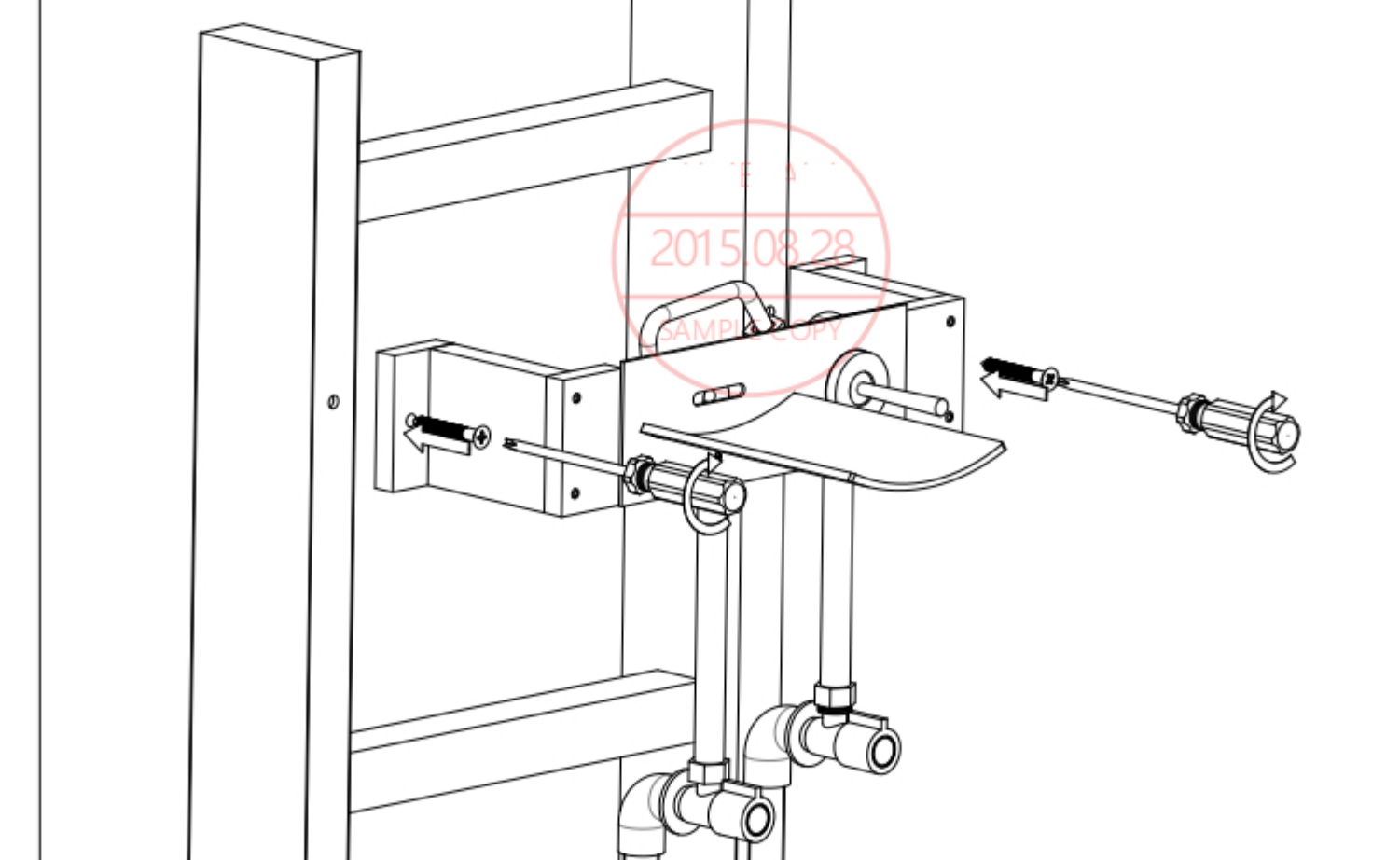

4.10 Turn on the stop valve and faucet to inspect for ensuring no leaking anywhere.

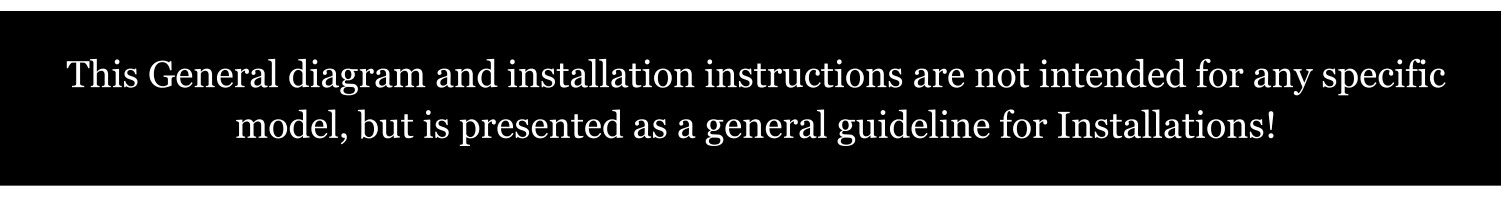

This General diagram and installation instructions are not intended for any specific model, but is presented as a general guideline for Installations!