

NOTES:

1. PART GEOMETRY IS DEFINED BY CAD MODEL PROVIDED BY ENGINEERING.
2. AESTHETIC DIMENSIONS SHALL NOT AFFECT FIT AND FUNCTION OF PART.
3. DIMENSIONS IN BRACKETS [] ARE MILLIMETERS AND FOR REFERENCE ONLY.
4. GRAIN DIRECTION PER ASME Y14.36M-1996 FOR SS SATIN FINISHES (180 GRIT) ONLY.
5. DO NOT POLISH THIS SURFACE.
6. MASK THIS SURFACE PRIOR TO POWDER COAT.

| BOM Table | | | |
|-----------|---------------|---|------|
| ITEM NO. | PART NUMBER | DESCRIPTION | QTY. |
| 1 | 500013 | LH MOUNTING BRACKET | 1 |
| 2 | 500015 | LH FRAME | 1 |
| 3 | 600053 | PHENOLIC SEAT TOP | 1 |
| 4 | 500016 | RH FRAME | 1 |
| 5 | 700024 | 18-8 S.S. SHOULDER SCREW, 1/2" SHOULDER DIA., 1/2" SHOULDER LENGTH, 3/8"-16 THREAD, .590-.605 LENGTH" | 2 |
| 6 | 500014 | RH MOUNTING BRACKET | 1 |
| 7 | S-4500-110316 | 6063 ALUM. LOW-PROFILE BINDING BARRELS AND SCREWS 8-32 THREAD SIZE | 2 |
| 8 | S-4500-110082 | 3/4" OD X 1/2" ID X .125", NYLON WASHER | 2 |
| 9 | S-4500-110007 | STAINLESS STEEL CAP NUT, 3/8"-16 THREAD SIZE | 2 |
| 10 | S-4500-120456 | #14 X 2-1/2" PHIL FLAT HD SCREW | 4 |
| 11 | S-4500-110314 | #14 X 2.5 LONG, 5/32 HEX DRIVE | 2 |
| 12 | S-4500-120447 | Hex L-Key, 5/32" Size | 1 |
| 13 | S-4300-120546 | 1" X 1.90" 45 MIL VHB ACRYLIC FOAM TAPE, BLK | 8 |
| 14 | S-4500-110464 | 7/8" OD X 1/2" ID X 0.073", NYLON WASHER | 2 |

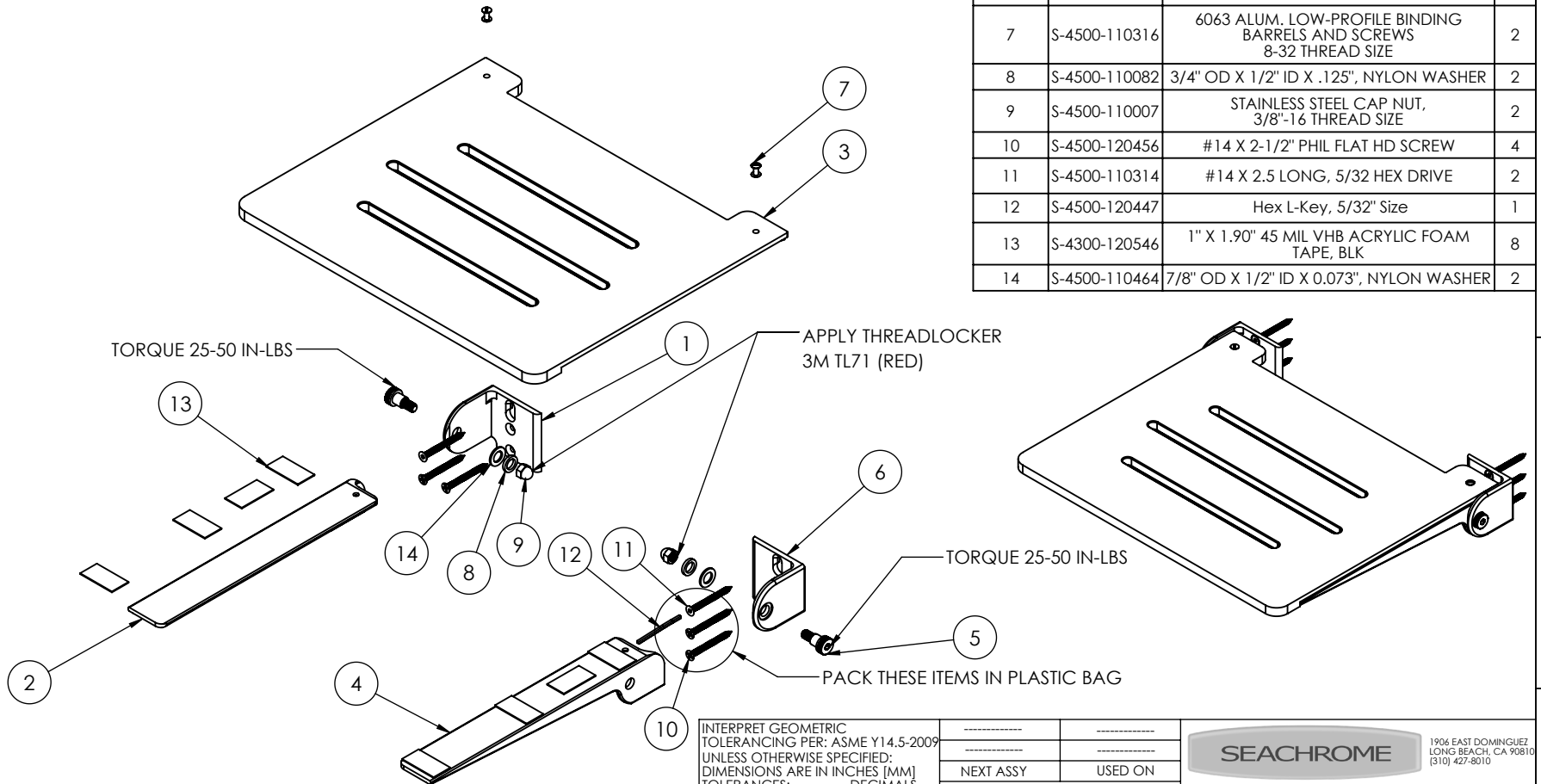

Proprietary & Confidential
 This drawing and the information contained herein is the property of Seachrome Corporation and shall not be reproduced, copied, or disclosed in whole or in part, or used in manufacturing, or for any other purpose without the written permission of Seachrome Corporation.

INTERPRET GEOMETRIC TOLERANCING PER: ASME Y14.5-2009
 UNLESS OTHERWISE SPECIFIED:
 DIMENSIONS ARE IN INCHES [MM]
 TOLERANCES: DECIMALS
 FRACTIONAL ±1/64 .X ±0.1
 ANGLES ±1° .XX ±0.02
 BEND ±1° .XXX ±0.005
 (XX) DENOTES CRITICAL DIMENSION
 ALL THREADS ARE CRITICAL
 REMOVE ALL BURRS & SHARP EDGES
 MATERIAL
 FINISH SEE NOTE

| TESTING | ASSEMBLY | POLISHING | MACHINING | TOOLING FIXTURE # |
|---------|----------|-----------|-----------|-------------------|
| ----- | ----- | ----- | ----- | ----- |

| | | | |
|------------------------------|-----------|---|----------------------------|
| SEACHROME CORPORATION | | 1906 EAST DOMINGUEZ LONG BEACH, CA 90810 (310) 427-8010 | |
| NEXT ASSY | | USED ON | |
| APPLICATION | | | |
| DRAWN | J. AMOZOC | 2/18/20 | |
| CHECKED | J. AMOZOC | 2/18/20 | |
| ENG APPR. | J. AMOZOC | 2/18/20 | |
| MFG APPR. | R. CANO | XX-XX-XX | |
| Q.A. | ----- | XX-XX-XX | |
| DWG. NO. SHAFSL-185155 | | REV B | |
| DO NOT SCALE DRAWING | | SIZE A | SCALE: 1:12 SHEET 1 OF 2 |

| ZONE | REV | ECN NO./DESCRIPTION | DATE | APPROVED |
|------|-----|---------------------------|---------|----------|
| | B | Hex Key | 6/23/20 | J.A. |
| | A | Nut replaced with Cap nut | 3/3/20 | J.A. |
| | - | RELEASED | 2/18/20 | J.A. |

NOTES:

1. DIMENSIONS IN BRACKETS [] ARE MILLIMETERS, FOR REFERENCE ONLY.
2. GRAIN DIRECTION PER ASME Y14.36M-1996 FOR SS SATIN FINISHES ONLY.

CUSTOMER SPECIFICATION DWG

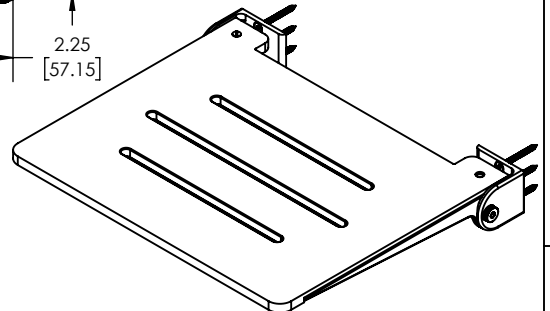
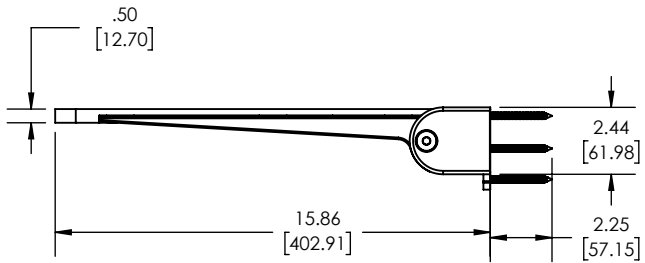
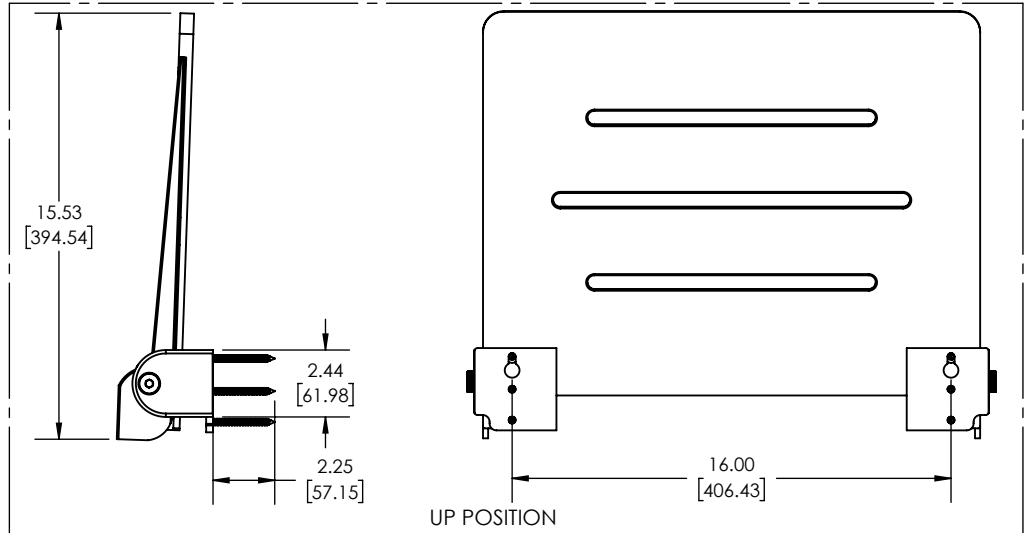
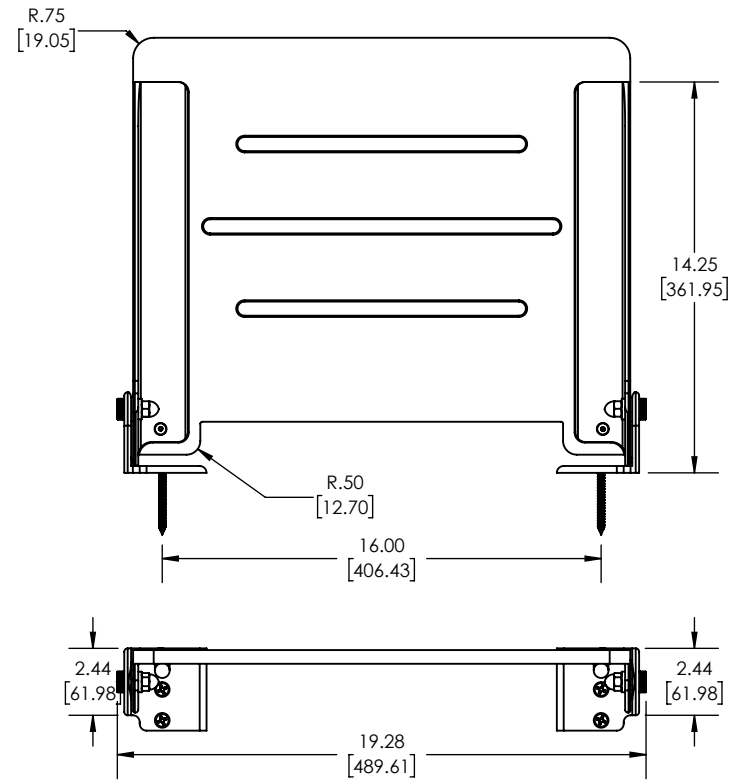

PRODUCT SPECIFICATION

-CLIENT: NA
-MATERIAL: NA

-AVAILABLE FINISHES

-POWDER COAT

1. ALMOND
2. WHITE
3. MATTE BLACK
4. SILVER
5. REFERENCE PRICE BOOK FOR ADDITIONAL OPTIONS

-HARDWARE PACKAGE INCLUDES:

1. #14X2.5" 5/32" HEX DRIVE 18-8 (S-4500-110314 QTY 2)
2. #14X2.5" PHIL. DRIVE 18-8 (S-4500-120456 QTY 4)
3. 5/32" HEX KEY (S-4500-120447 QTY 1)

Proprietary & Confidential
This drawing and the information contained herein is the property of Seachrome Corporation and shall not be reproduced, copied, or disclosed in whole or in part, or used in manufacturing, or for any other purpose without the written permission of Seachrome Corporation.

| | |
|---|-----------|
| INTERPRET GEOMETRIC TOLERANCING PER: ASME Y14.5-2009 | |
| UNLESS OTHERWISE SPECIFIED: DIMENSIONS ARE IN INCHES [MM] | |
| TOLERANCES: | DECIMALS |
| FRACTIONAL ±1/64 | .X ±0.1 |
| ANGLES ± 1° | .XX ±0.02 |
| DRAWN | J. AMOZOC |
| ENG APPR. | |

| | | | |
|---|-------------------------------|---|--------------|
| SEACHROME | | 1906 EAST DOMINGUEZ LONG BEACH, CA 90810 (310) 427-8010 | |
| CORPORATION | | | |
| TITLE: SILHOUETTE SLIMLINE SHOWER SEAT | | | |
| DWG. NO. | SHAFSL-185155 | REV | B |
| SIZE | A DO NOT SCALE DRAWING | SCALE: | 1:12 SHEET 1 |