



INSTALLATION INSTRUCTIONS

Features

- Oil rubbed

- Kerox™ Ceramic Disc Cartridge
 - Solid brass construction
 - Pull-out spray head with multi-function feature
 - Up to 2" deck thickness
 - 1 hole installation(standard 1-3/8" hole)
-  Certified and listed by cUPC to meet Industry Codes



This product complies with the new federal "lead-free" requirement of the 2014 Reduction of Lead in Drinking Water Act.



ensions

- Overall Height: 1
- Spout Height: 9

- Snout Reach: 8' 75"

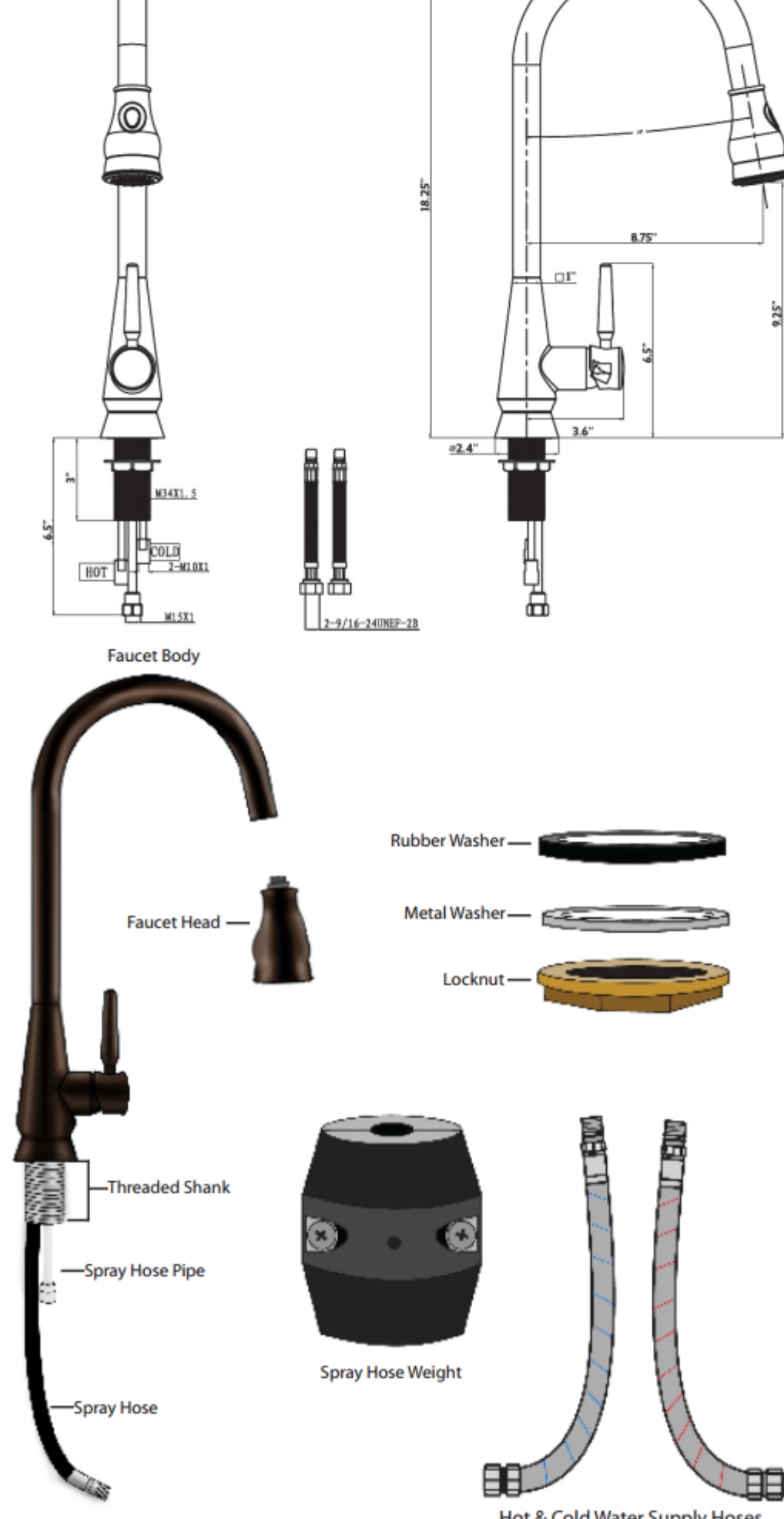
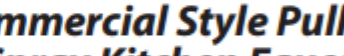

Installation

1. Remove rubber washer, metal washer, and locknut from the threaded shank (**Figure 1**). If you look closely, you will find a black rubber O ring sitting in a groove on the underside of the base of the faucet, just above the threaded shank. Do not remove this O ring (**Figure 1**).

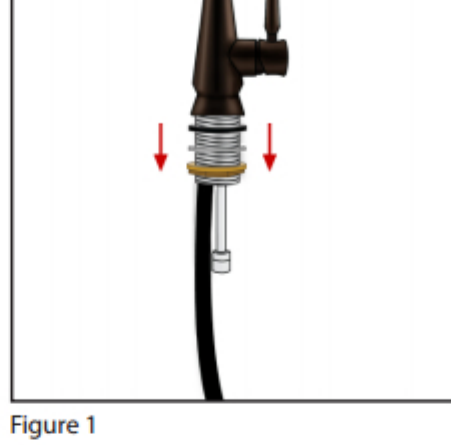

- ply hoses to the faucet by screwing the male end of each hose into the base of the faucet body (**Figure 2**).

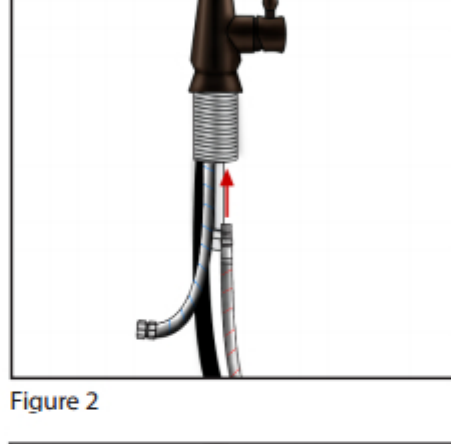

- 3.** Place the faucet body into the faucet hole of the deck/sink (**Figure 3**). A standard 1-3/8" hole is required for this faucet.

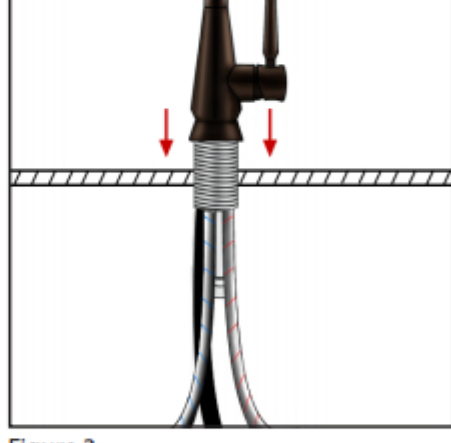

4. From underneath the deck/sink, slide the rubber washer followed by the metal washer all the way up the threaded shank of the faucet (**Figure 4**)

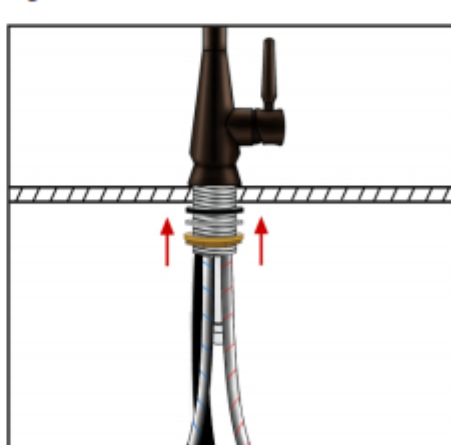

5. Screw the locknut all the way up the threaded shank of the faucet until tight. Then using a Phillips-Head Screwdriver, tighten the screws of the locknut until tight (**Figure 4**).

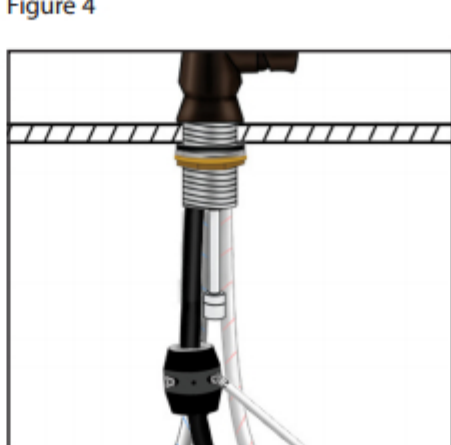

- weight until it is in two pieces. Place one half of the hose weight on the center sections of the spray hose. Then place the remaining half of the

7. Connect the spray hose by screwing it into the spray hose pipe (Figure 6).

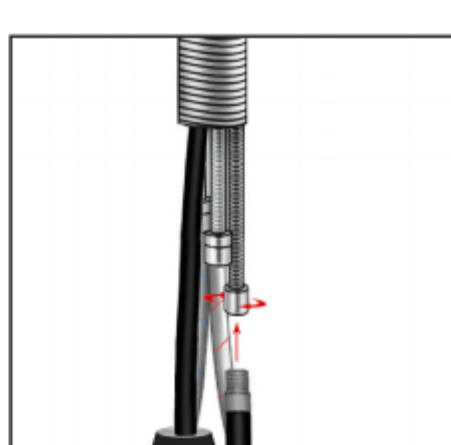

8. Make sure the spray hose weight is vertical on the loosest section of the spray hose and tighten the screws with a Phillips head screwdriver.

- 9.** Tightly screw the faucet head to the spray hose pipe coming out from the top of the faucet body (**Figure 7**).



10. Then screw the remaining female ends of the supply hoses to the corresponding hot and cold water supply using an adjustable wrench or pliers (**Figure 8**)

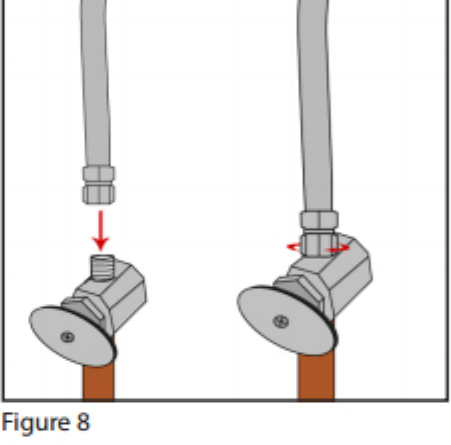

- 11. Turn water supply on (Figure 8).** Test the faucet by turning it on and off. Make sure there is good water flow and no leaks. Inspect the faucet above and below the countertop to make sure there are no leaks. If there is a leak, turn the water supply off and contact Ruvati Support.

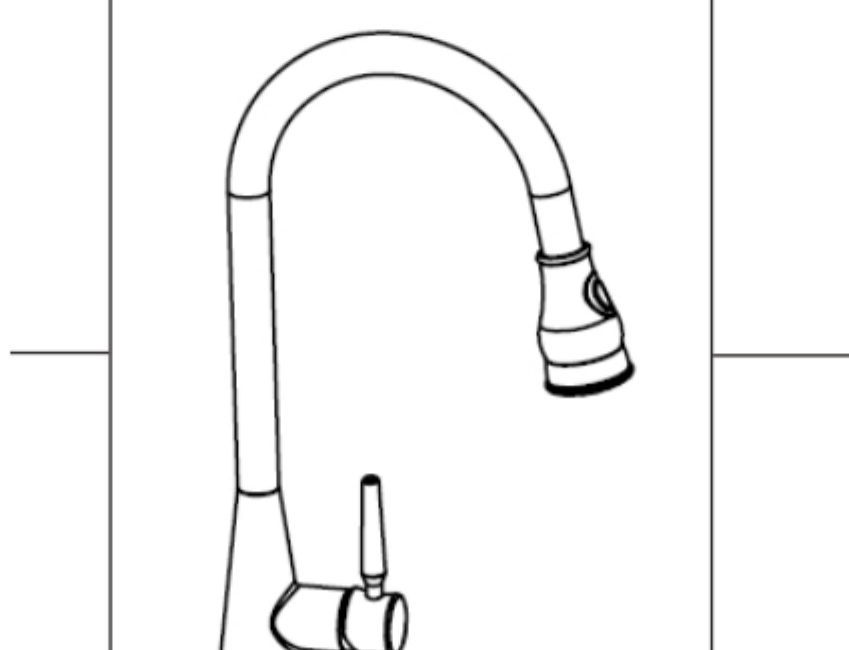
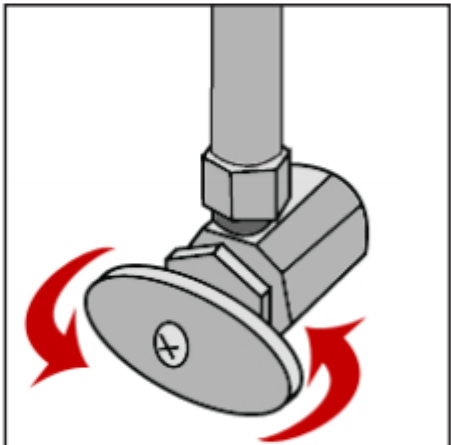

This General diagram and installation instructions are not intended for any specific model, but is presented as a general guideline for Installations!