

## 100.4101 | 3/4" Thermostatic Valve With Volume Control & Trim

### SPECIFICATIONS:

- Turn bottom handle to control temperature
- Turn top handle to control volume
- Includes Thermostatic valve (TVH.4101) w/ service stops
- Thermostatic Valve Flow Rate - 13.0 GPM @ 60 PSI
- Extension Available - TVH.4101E\*\*

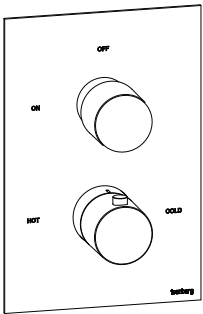

Trim  
[ 100.4000T\*\* ]

+

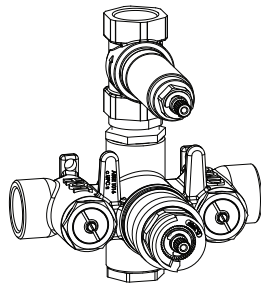

Valve  
[ TVH.4101 ]

Belgian Mirror Finish



Legislation Compliance



ZeroDrip Technology



### Technical Diagram

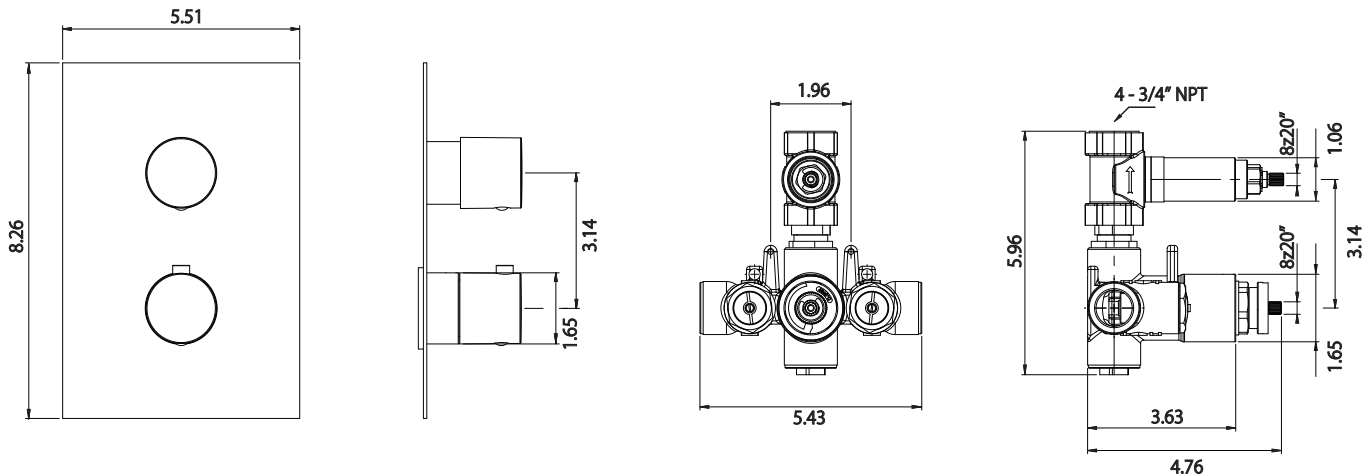

### Water Diversion Diagram

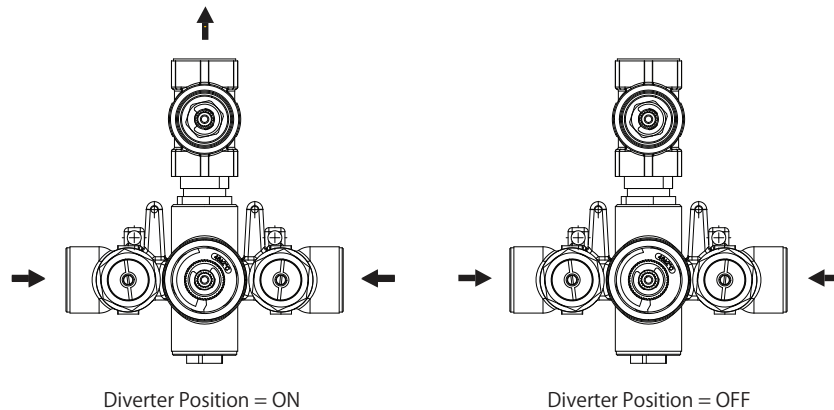

**TVH.4101 | 3/4" Thermostatic Valve With Volume Control** Page 1 of 2



**SPECIFICATIONS:**

- Turn bottom knob to control temperature.
- Turn top knob to control water flow.
- Thermostatic Valve Flow Rate - 13.0 GPM @ 60 PSI

**STANDARDS:**

- ASME A112.18.1 / CSA B125.1

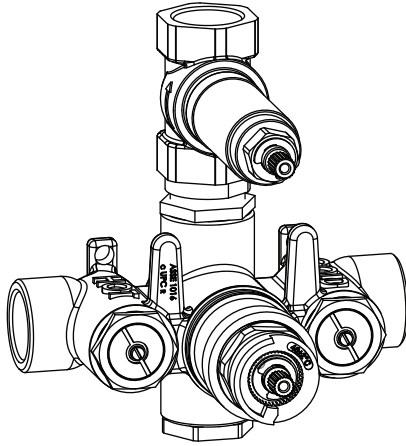

Legislation Compliance



ZeroDrip Technology



**Technical Diagram**

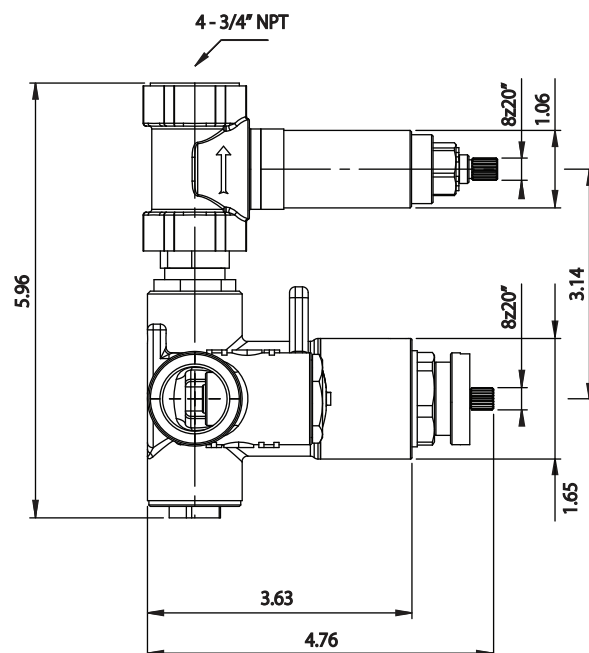
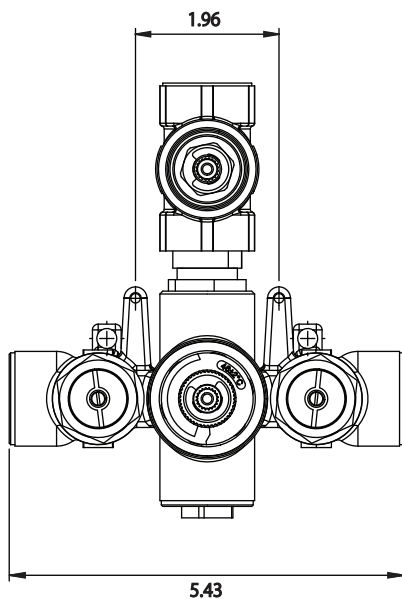

TVH.4101 | 3/4" Thermostatic Valve With Volume Control Page 2 of 2



Water Flow Diagram

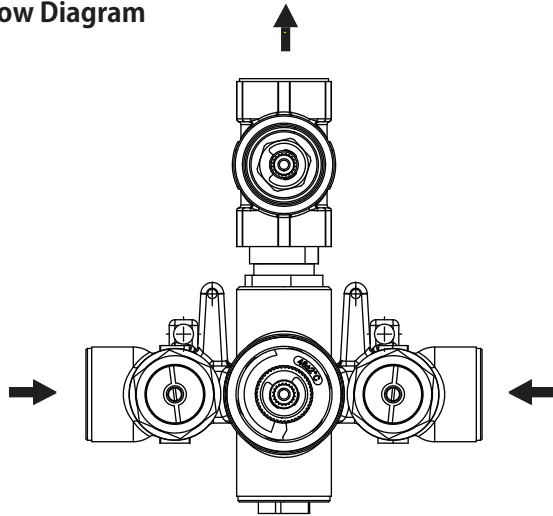

Diverter Position = Left (on)

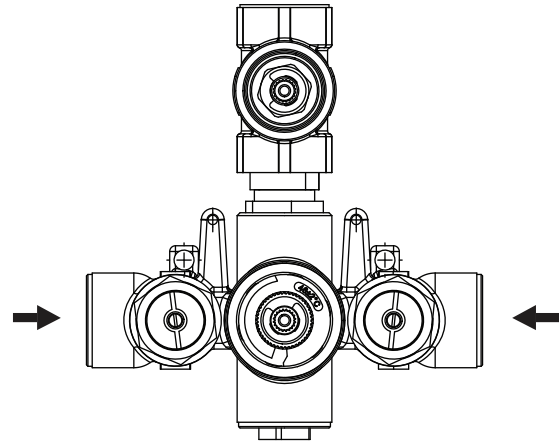

Diverter Position = Top (off)