

Shower room mixing valve, shower room 3/4/5 way water outlet thermostated copper head, shower room thermostatic faucet

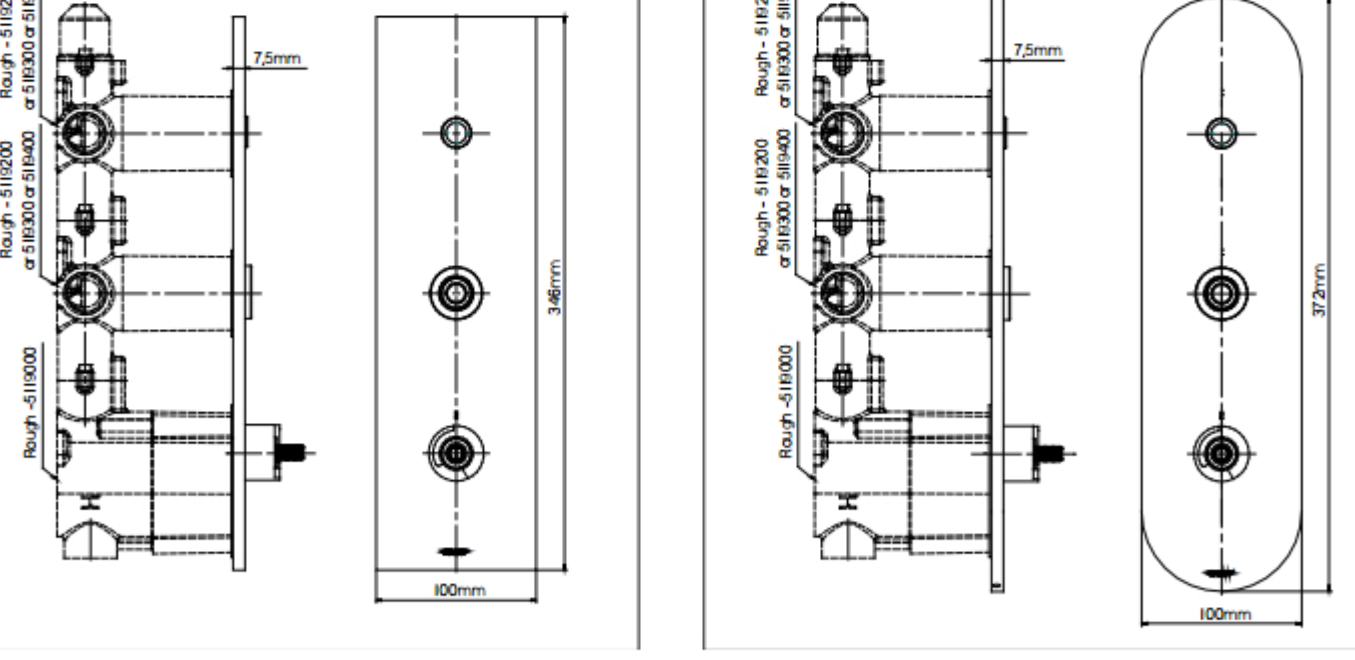

INSTALLATION INSTRUCTIONS

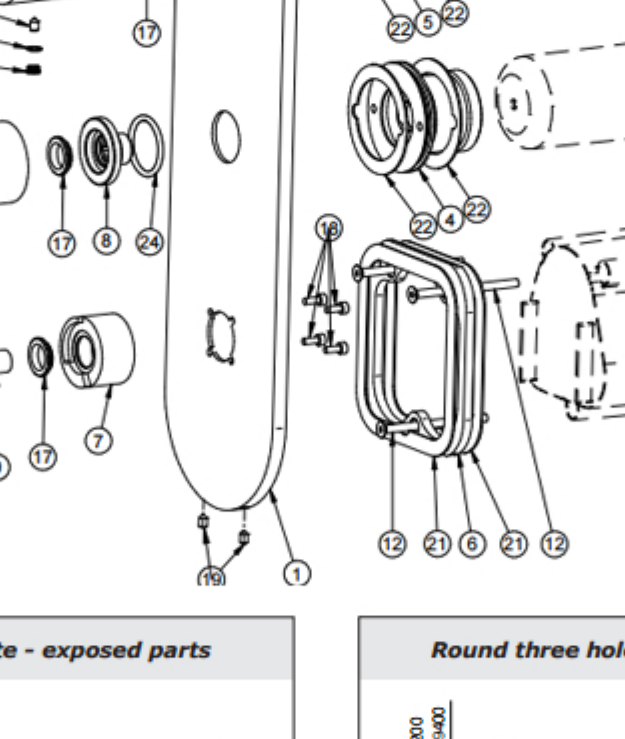
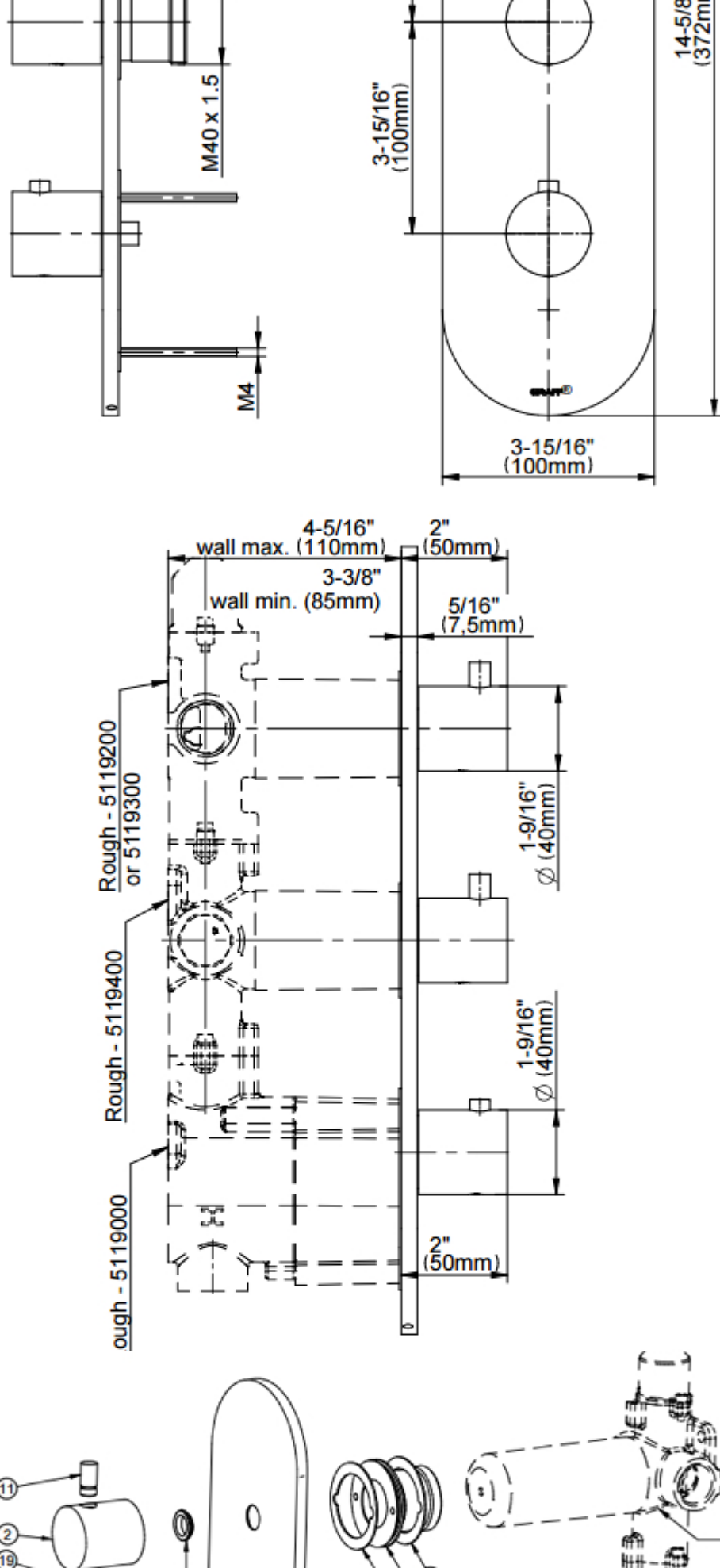
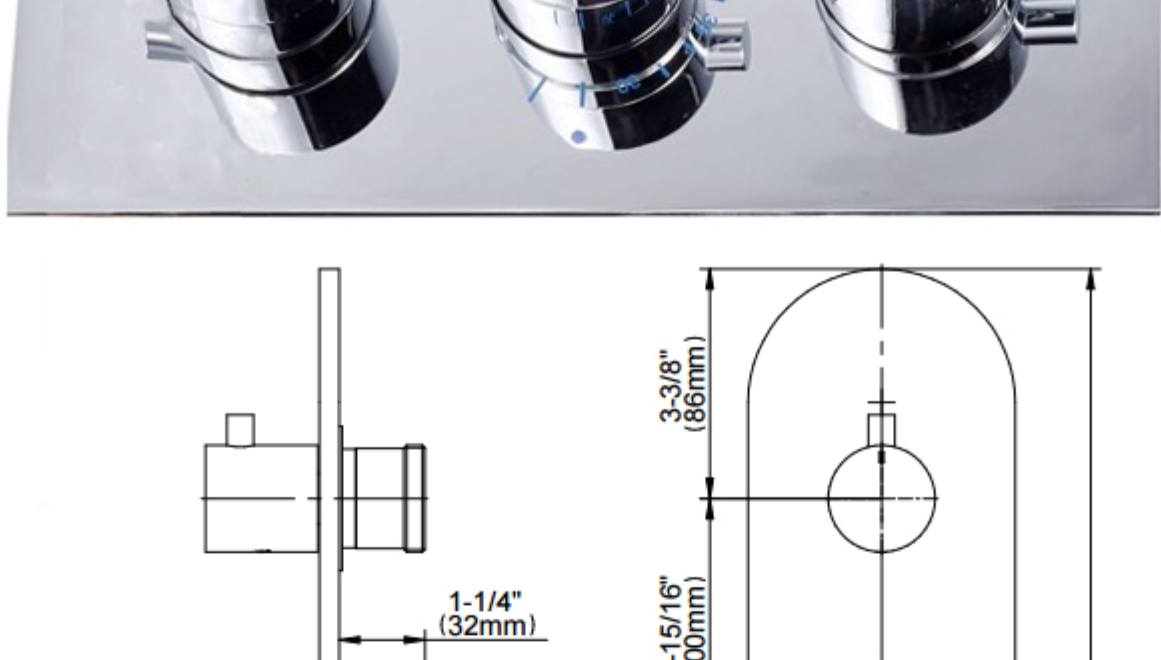

Square three holes trim plate - exposed parts

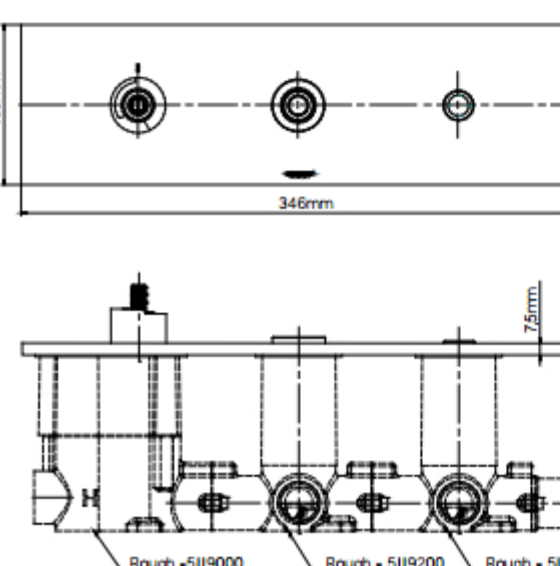

Round three holes trim plate - exposed parts

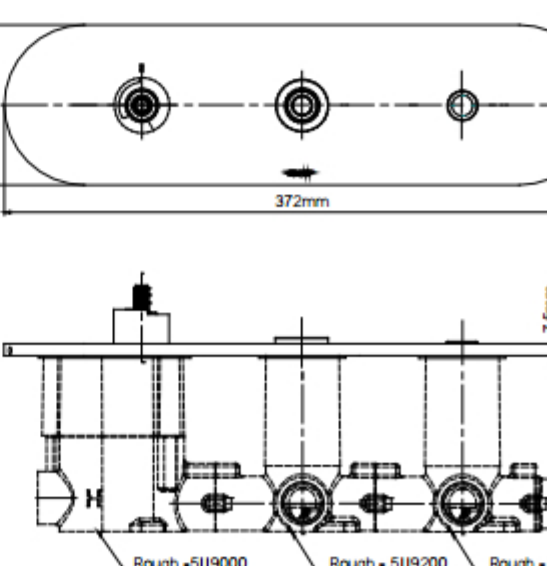

Square three holes trim plate - exposed parts

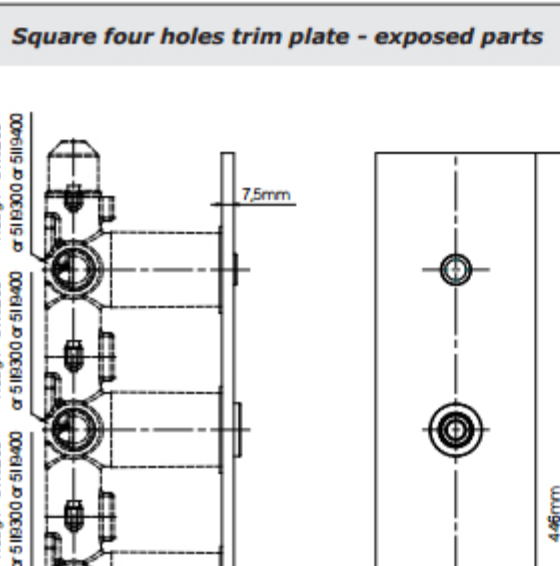

Round three holes trim plate - exposed parts

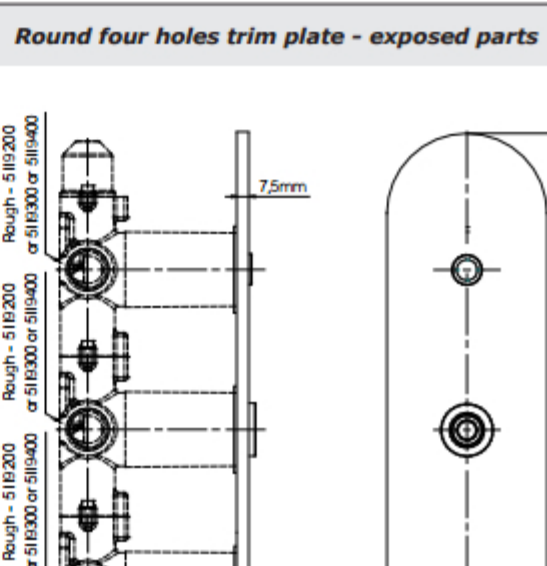

Square four holes trim plate - exposed parts

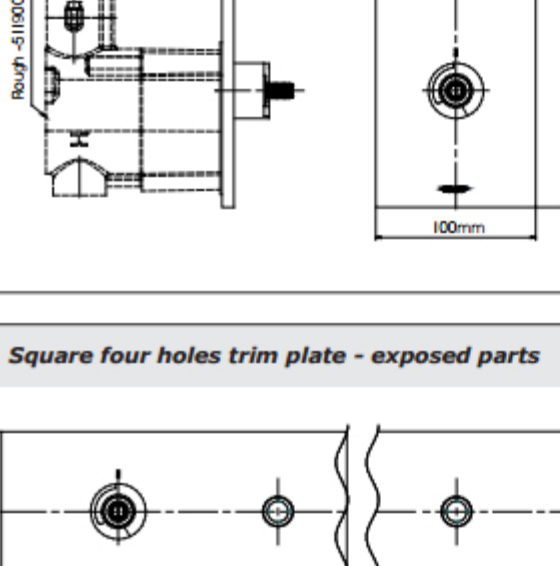

Round four holes trim plate - exposed parts

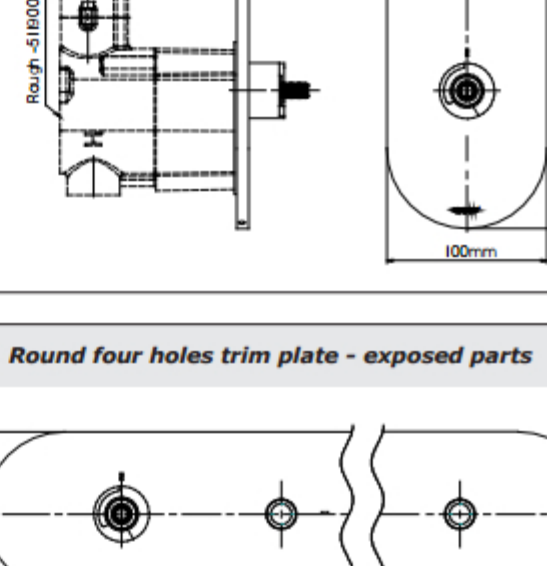

Square four holes trim plate - exposed parts

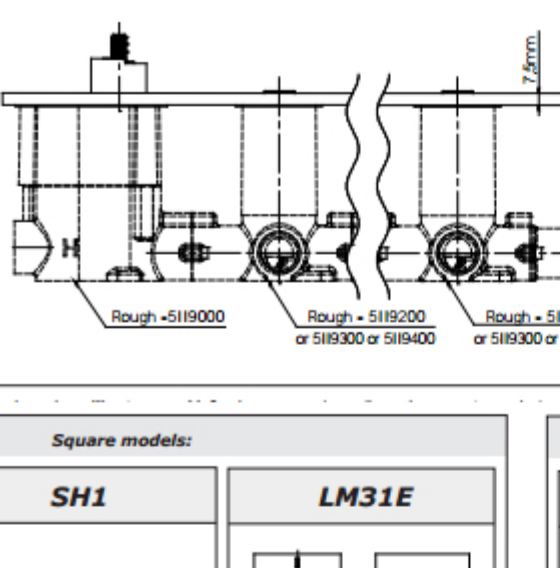

Round four holes trim plate - exposed parts

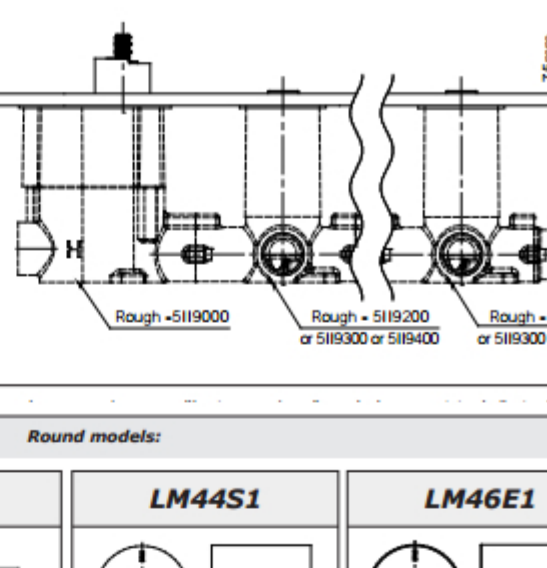

Square models:

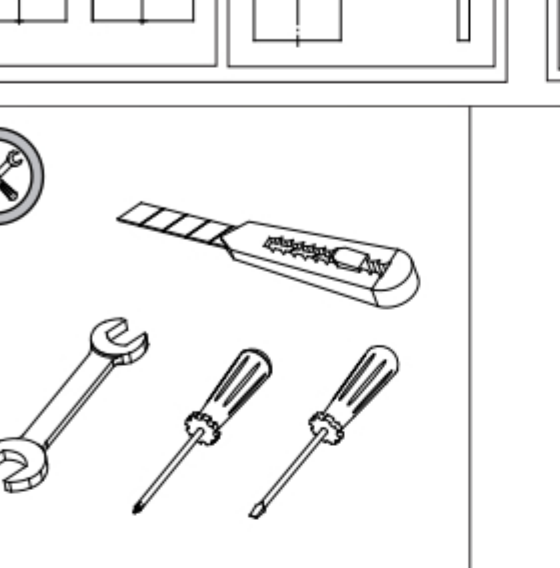

Round models:

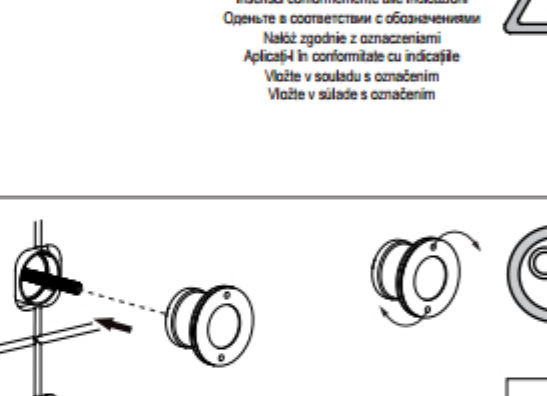
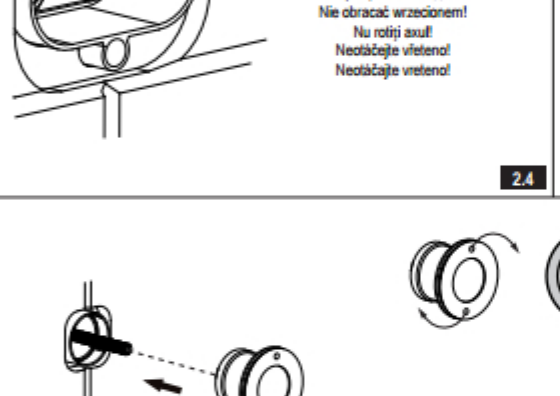
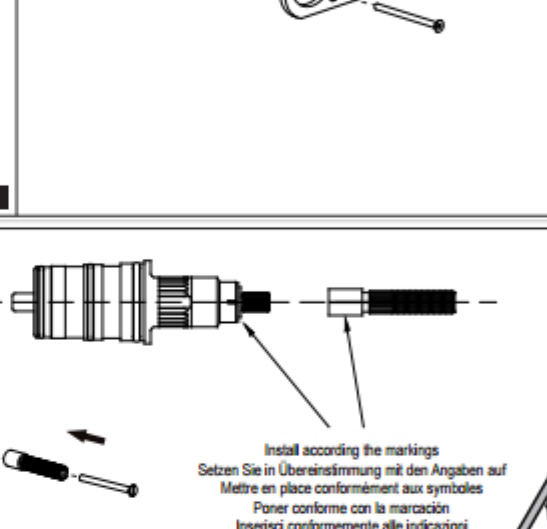
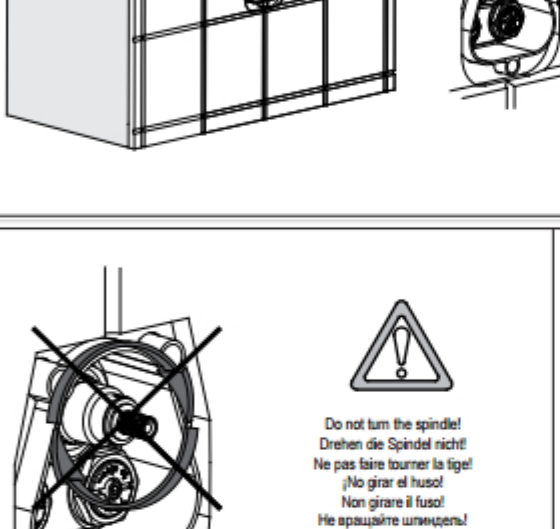
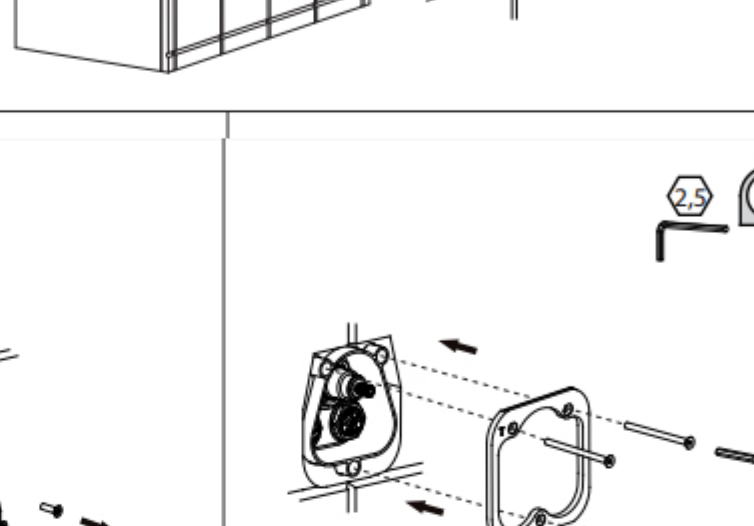
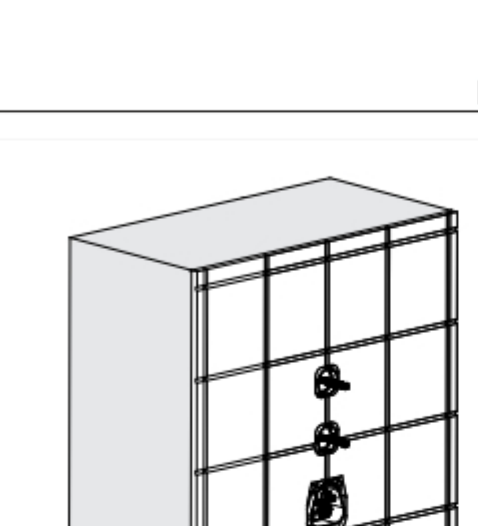
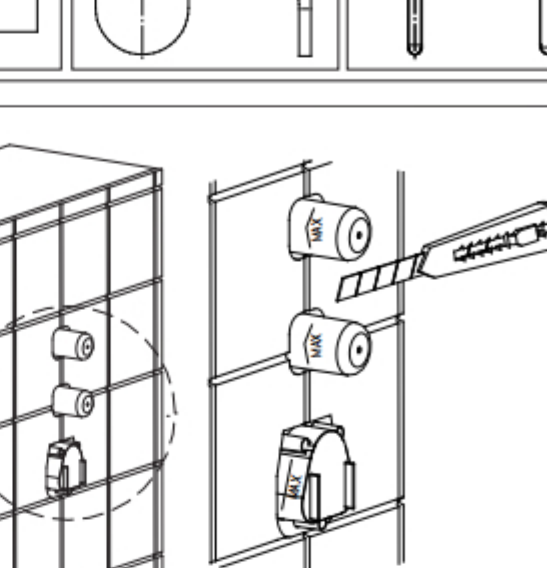

Do not turn the spindle!

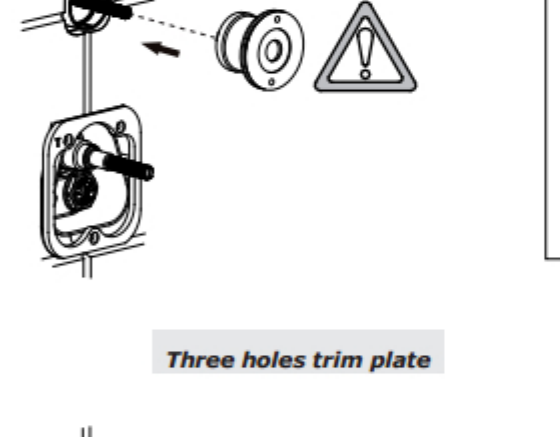

Install according to the markings

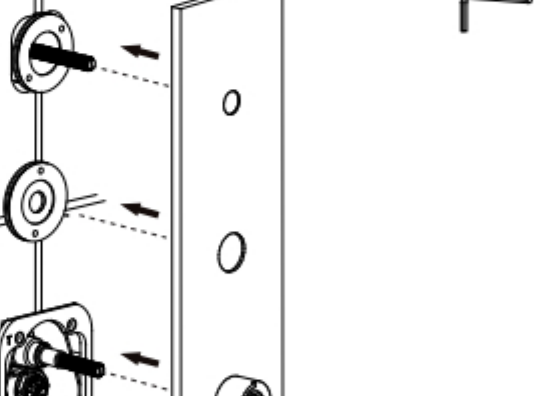
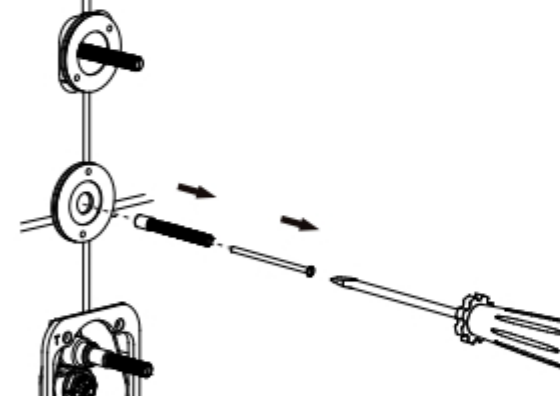
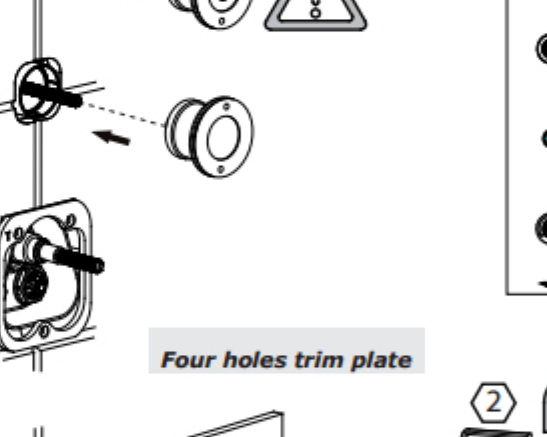

Three holes trim plate

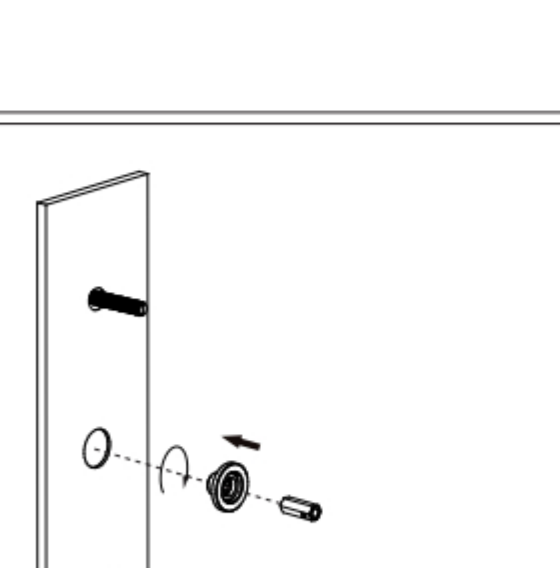

Four holes trim plate

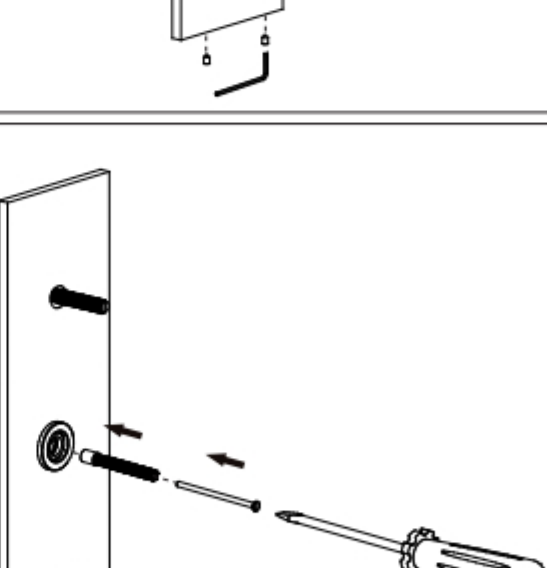

Concealed cut-off valve

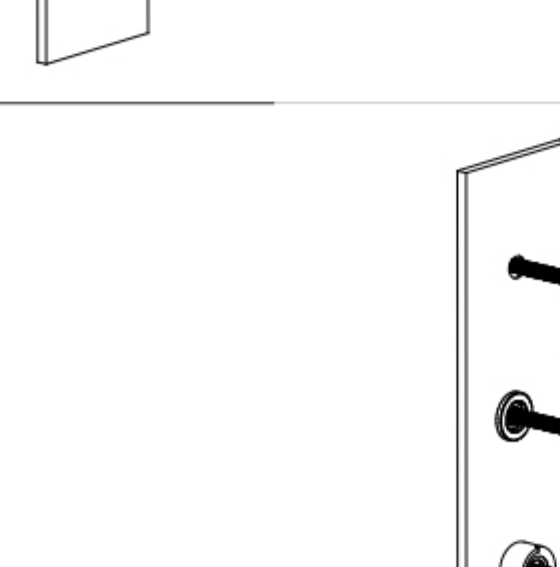

Concealed 3-way diverter

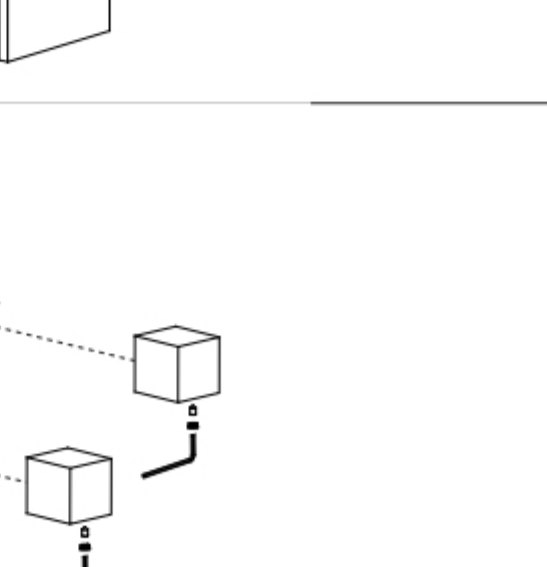

Concealed 4-way diverter

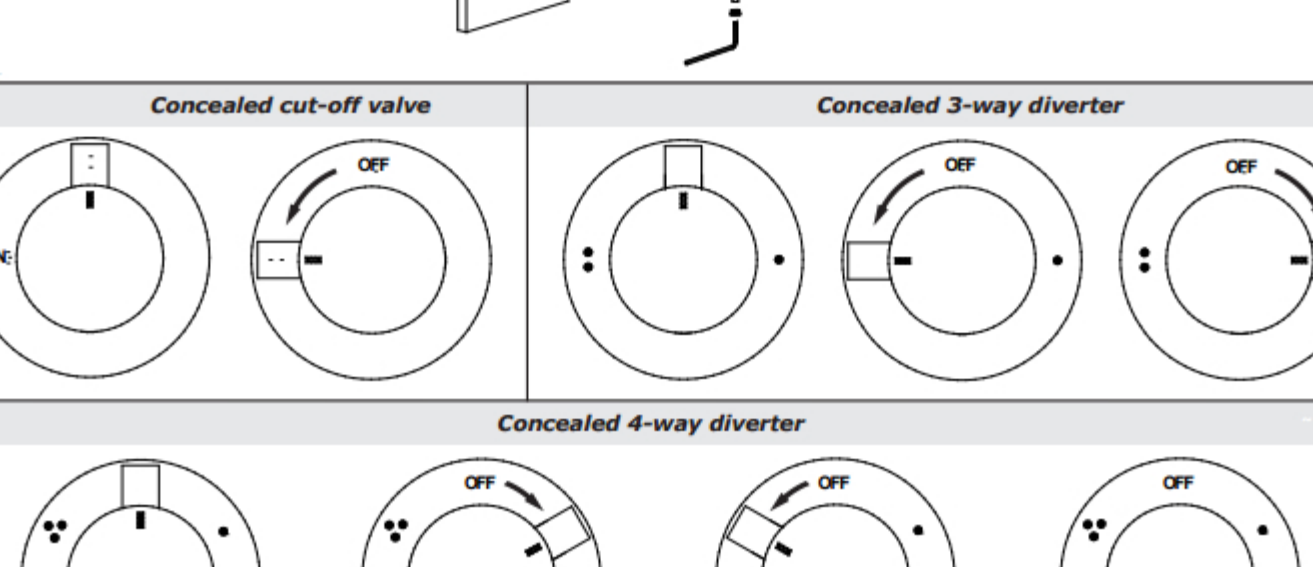

This General diagram and installation instructions are not intended for any specific model, but is presented as a general guideline for Installations!