

Parts Included:

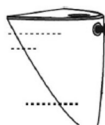

Docking System



Wall Holder



Screw



CSA / UL Safety Requirements

CSA/UL requires that these IMPORTANT SAFETY INSTRUCTION be listed:

- This portable lamp has a polarized plug (one blade is wider than the other) as a safety feature to reduce the risk of electric shock. This plug will fit in a polarized outlet only one way. If the plug does not fit fully in the outlet, reverse the plug. If it still does not fit, contact a qualified electrician. Never use with an extension cord unless plug can be fully inserted. Do not alter the plug.

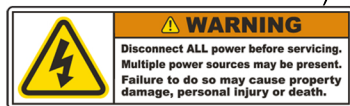

Care Instructions

Arnsberg suggests using only a micro fiber cleaning cloth to clean this fixture. If required, a slightly damp cleaning cloth may be used to spot clean. Do not use common household cleaners on this fixture, as the final finish may be damaged as a result. Enjoy your new Arnsberg fixture.

Mounting Instructions:

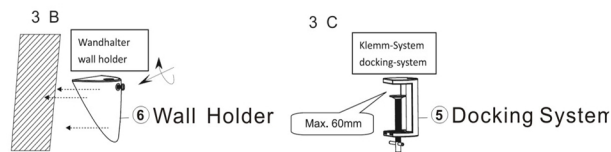
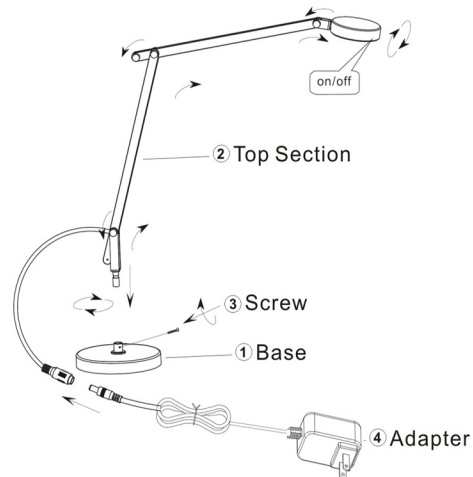

Assembly Instructions:

1. Carefully unpack and lay out the parts as shown in the illustration.
2. When using the lamp in a Desk Lamp Mode; Insert the Top Section (#2) on top of Lamp Base (#1); insert the Screw (#3), twist and tighten it.
3. When using the lamp in a Edge-Fixed Lamp Mode; Combine the Docking System (#5) with the Top Section (#2); insert the Screw (#3), tighten it.
4. When using the lamp as a Wall-Fixed Lamp, combine the Wall Holder (#6) with the Top Section (#2), insert the Screw (#3) into the hole, tighten it.
5. Installation is complete, plug the Adapter (#4) in electricity socket, Turn the switch on to activate the lamp.