

Maykke™

www.maykke.com

Installation, Care Guide and Warranty



Undermount Sink

YSA1092001 and YSA1092002

Step 1 : Apply adhesive caulking around the topside of rim near the edge, Carefully raise sink in place, align, and press firmly

See Figure 1.

Step 2 : Attach 4 undermount-clips to hold lavatory in place

See Figure 2.

Figure 2.

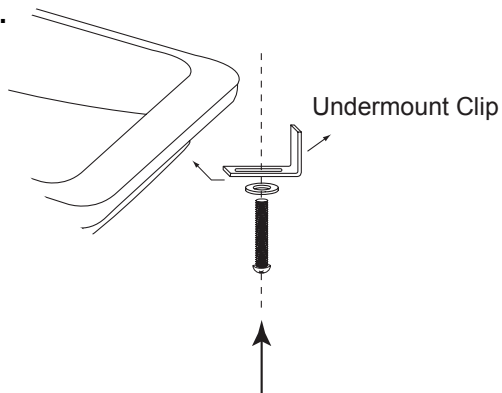

Figure 1.

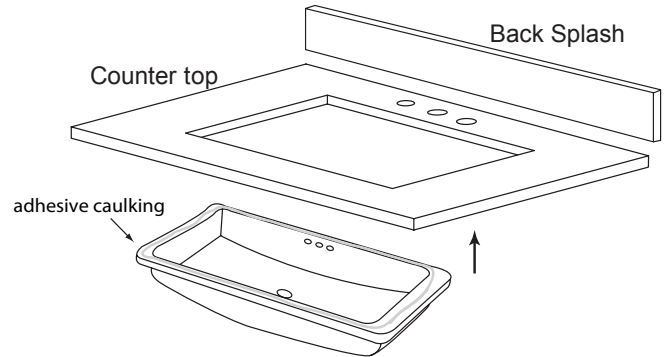
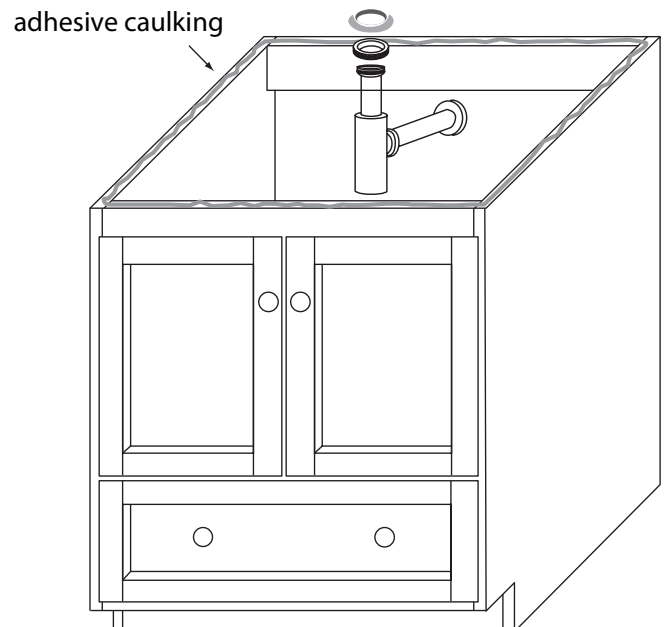

Figure 3.



Step 3 : Secure top & back splash to cabinet by using adhesive caulk

See Figure 3.

CARE GUIDE:

Care: Rinse thoroughly and use a soft cloth to wipe the product dry after each use to prevent hard water stains.

Cleaning: Soft abrasive cleaners may be used when necessary.

One Year Limited Warranty

Your Maykke product is warranted against defects in material and workmanship for ONE (1) YEAR from the date of original purchase, when used in accordance with Maykke's Care Guide. Damage caused during moving or installation is not considered a defect. The warranty cannot be transferred and is for original purchaser only. Maykke will not be responsible for any installation or removal charges. For customer service concerns please email: support@maykke.com or call 1 (877) 659-2858