

Installation Manual

Step 1



Measure and mark for starting point

Step 2

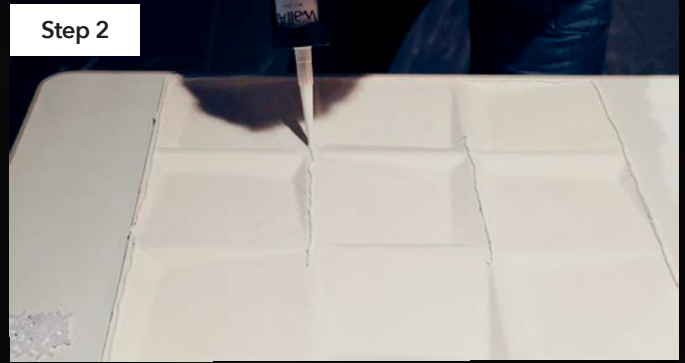

Apply construction adhesive along perimeter and middle of back of panel

Step 3



Install and apply equal pressure using your finger tips

Step 4



Note: Using the provided spacers is optional. No need to use them if butting the panels together.

Install the panels using the spacers or just butt them together

Step 5



Apply coat of latex primer with spray gun, brush or roller

Step 6



Apply your choice of top coat paint color and finish

Enjoy your Beautiful Wall - Outlet Frames are also available if needed

Check us out at: www.WallDecor3D.com