

# ACADIAN / NORMANDY / BRUNSWICK

---

## PARSON CHAIR

MODEL # WS5113-4-DSB

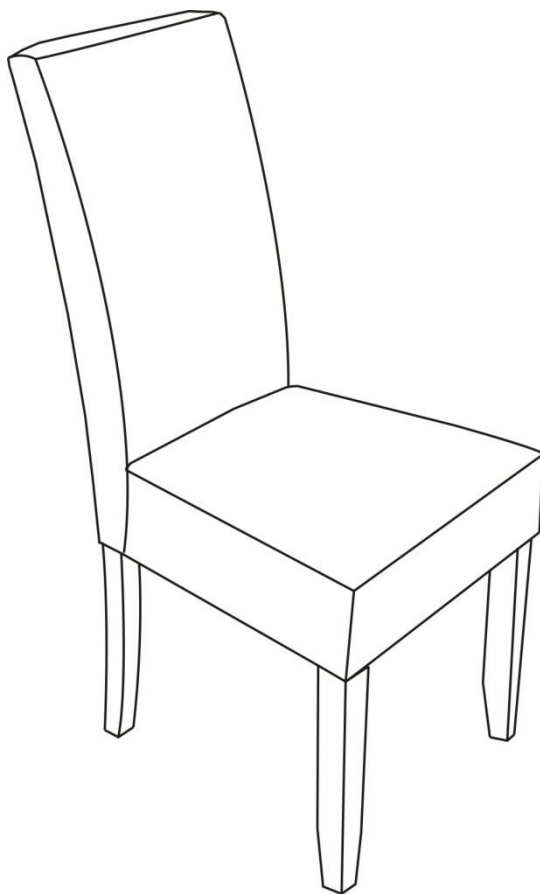

## PRE-ASSEMBLY INFORMATION

### PARTS DESCRIPTION

A



CHAIR BACK  
QTY 1

B

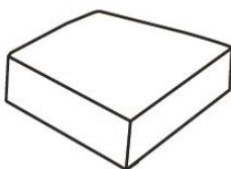

SEAT  
QTY 1

C



FRONT LEG  
QTY 2

**NEED HELP?** For help with assembly or if you are missing a part,  
Please call customer service at 1-866-518-0120 ext. 262 (9 am to 4 pm EST)

## PRE-ASSEMBLY INFORMATION

### HARDWARE DESCRIPTION

1

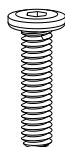

ALLEN KEY SCREW  
M8 x 45 MM  
QTY 1

2

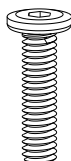

ALLEN KEY SCREW  
M8 x 60 MM  
QTY 4

3

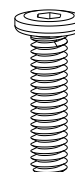

ALLEN KEY SCREW  
M8 x 80 MM  
QTY 4

4



ALLEN KEY  
5 MM  
QTY 1

5

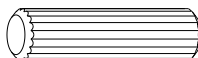

DOWEL  
Ø8 x 30 MM  
QTY 2

6



FLAT WASHER  
Ø22 MM  
QTY 9

7



LOCK WASHER  
Ø13 MM  
QTY 9

**NEED HELP?** For help with assembly or if you are missing a part,  
Please call customer service at 1-866-518-0120 ext. 262 (9 am to 4 pm EST)

# ASSEMBLY

## STEP 1

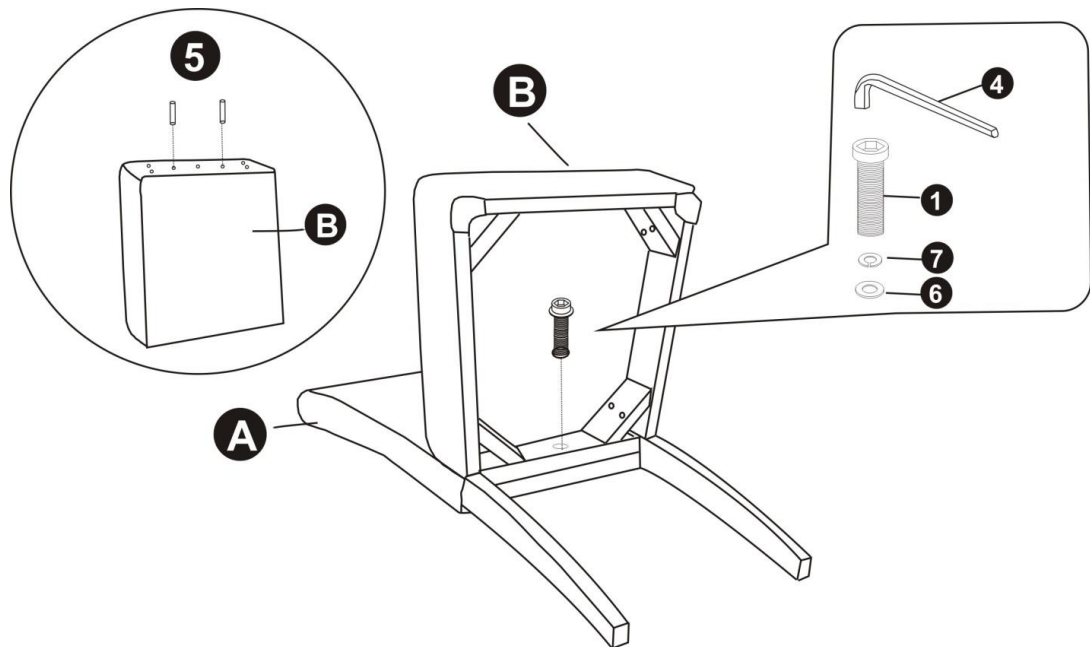

Insert Dowels (5) into pre-drilled holes on Seat (B).

Attach Seat (B) to Chair Back (A) using Allen Key Screw (1) and one Washer each of (6) and (7).

Use Allen Key (4) to tighten. Do not over-tighten.

# ASSEMBLY

## STEP 2

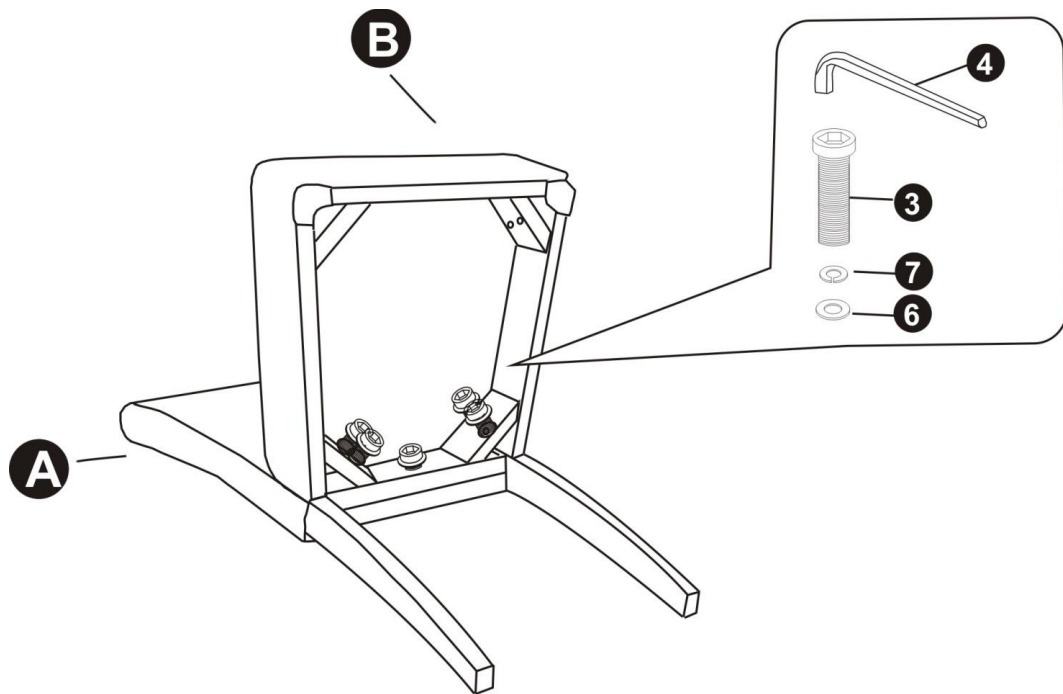

Secure Seat (B) to Chair Back (A) using Allen Keys Screws (3) and four Washers each of (6) and (7).

Use Allen Key (4) to tighten. Do not over-tighten.

## ASSEMBLY

### STEP 3

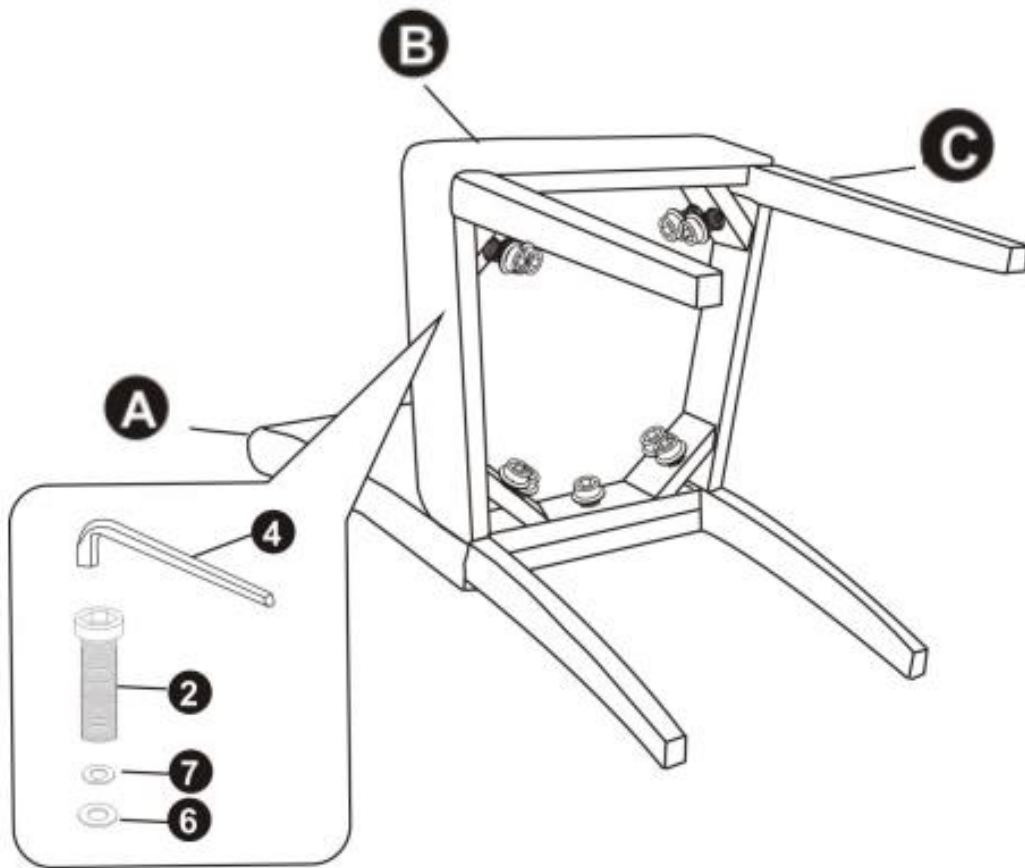

Attach Front Legs (C) to Seat (B) using Allen Keys Screws (2) and four Washers each of (6) and (7).  
Use Allen Key (4) to tighten. Do not over-tighten.

## ASSEMBLY

### STEP 4

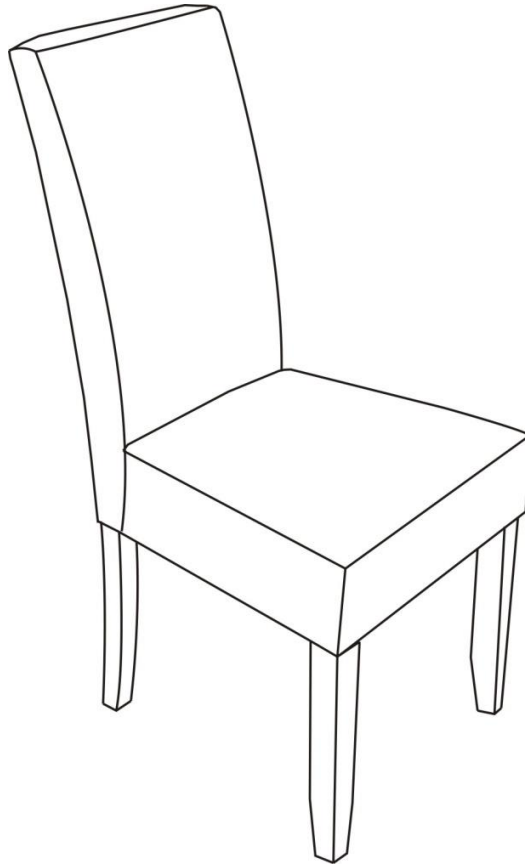

Place Chair on a flat level surface to ensure it is level.  
If it is uneven, adjust either the Seat (B) or Front Legs (C).  
Ensure the Chair is level and then fully tighten all bolts.