

# Touchless Flush Kit INSTALLATION INSTRUCTIONS

---

*Swiss Madison®*  
well made forever

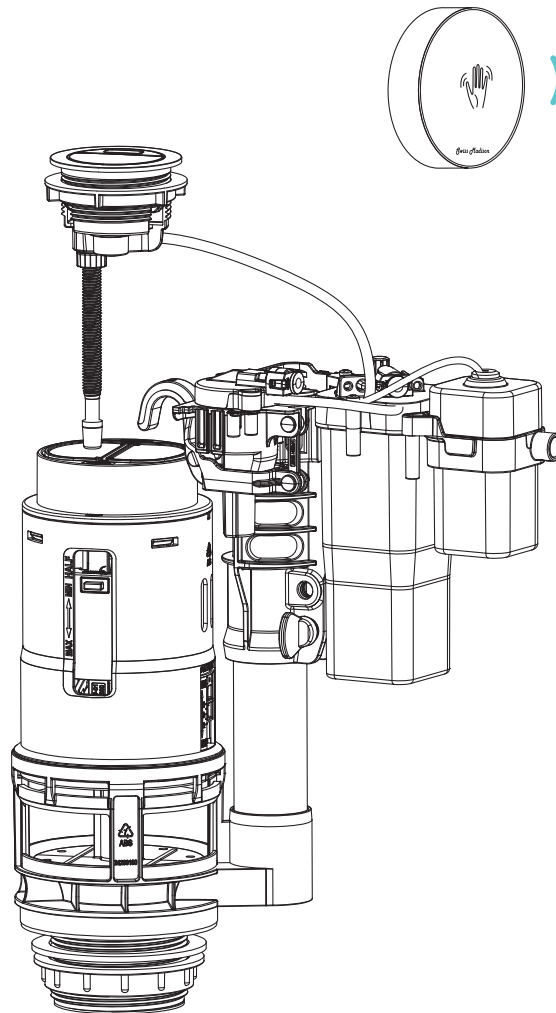

**TOUCHLESS**  
technology

@SwissMadison  
#WellMadeForever



**PRIOR TO INSTALLATION:**

- Inspect product to ensure no damages have occurred while in shipping.
- Observe all plumbing and building codes in accordance with your state and local requirements.
- All dimensions are nominal! Be sure to measure your toilet prior to installation.
- The step-by-step guidelines in the installation instructions are a general reference. Should there be any discrepancies, Swiss Madison cannot be held liable. It is recommended to install all Swiss Madison products by hiring a licensed professional.
- Read installation and maintenance instructions thoroughly before installing. Be sure to use proper tools and always wear proper personal safety accessories for your protection.

If you have any questions or concerns please contact us:

1-434-623-4766

[info@swissmadison.com](mailto:info@swissmadison.com)

**SUGGESTED TOOLS & MATERIALS:**

Safety  
Glasses

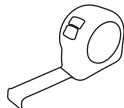

Tape  
Measure

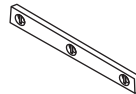

Level

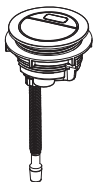

Drill

**INCLUDED PARTS:**

Sensor  
Button



Air Tube



Bushing

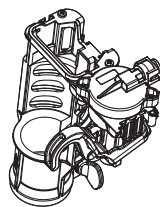

Drive  
Assembly

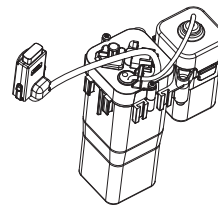

Control Box  
Assembly

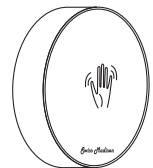

Wall Sensor

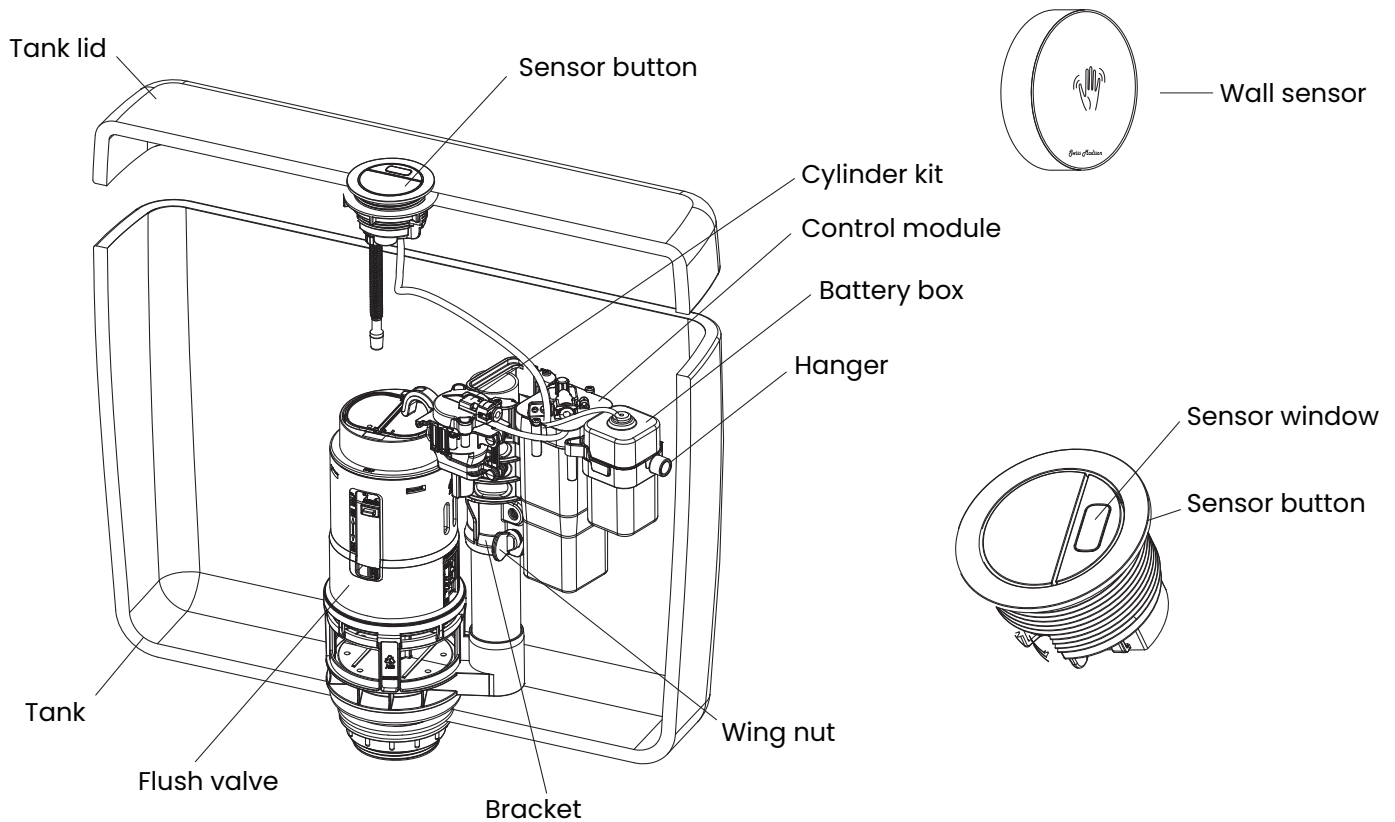

## USAGE INSTRUCTIONS:

- **Sensor Flushing:** If you wave your hand for less than one second within the sensing distance window the system will perform a half flush. If you wave your hand for more than, or equal to, one second within the sensing distance window the system will perform a full flush. The indicator will light up during the sensing period.
- **Wired Infrared Sensor Low Battery Indication:** If the battery is low, when sensing, the indicator light will flash 10 times and perform flushing indicating batteries need to be replaced. The indicator will stop flashing if it is out of battery.
- **Wireless Wall Sensor Low Battery Indication:** If the battery is low, when sensing, the indicator light will flash 5 times and perform flushing indicating batteries need to be replaced. The indicator will stop flashing if it is out of battery.
- **Flush Volume Hand-Wave Adjustment:** Adjust within five minutes of powering on, or by waving hand 5 times within 5 seconds over the sensor to enter flush volume adjustment mode. The default level for both full flush and half flush is level 3. The indicator light will flash every 1.5s to indicate the current level. Adjust level by waving your hand over the sensor one time per level. The level will adjust in the order: 1>2>3>4>5>1. Not waving for 15 seconds will exit flush volume adjustment mode.

## SPECIFICATION PARAMETERS:

- Wired Infrared Sensor Power Supply: 4 "AA" batteries.
- Wireless Wall Sensor Power Supply: 3 "AA" batteries.
- Operating Temperature: 35.6°F - 113°F
- Wired Infrared Sensor Max. Sensing Distance: 7-9"
- Wireless Wall Sensor Max. Sensing Distance: 0.8-1.6"
- Operating Pressure: 0.02Mpa - 0.8Mpa

**TOUCHLESS FLUSH KIT INSTALLATION:****1. Remove Parts from Box**

- Remove the sensor button, air tube, installation bush, drive assembly and control box assembly from the box.

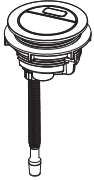

Sensor button



Air tube



Installation bush

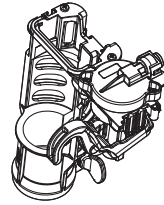

Drive assembly:

- Bracket
- Cylinder kit
- Bolt

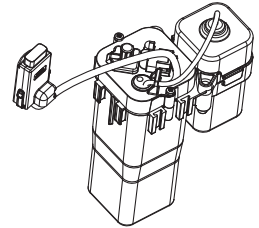

Control box assembly:

- Control box
- Battery box
- Hanger
- Filter window

**2. Relocate Actuator Assembly to Top Position**

- Unscrew the screw at the bottom of the actuator assembly.
- Remove from the overflow tube hanger, then raise above the edge of the overflow tube hanger and reattach using the screw. Be sure not to overtighten the screw to prevent damage to the product.

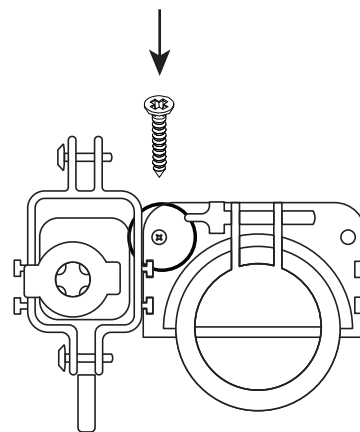
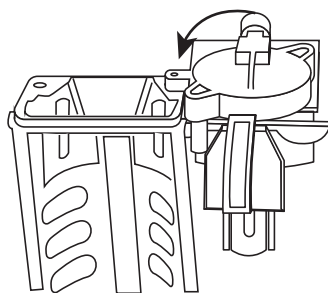
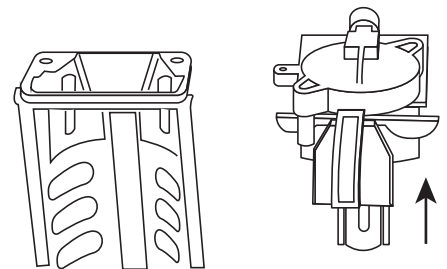
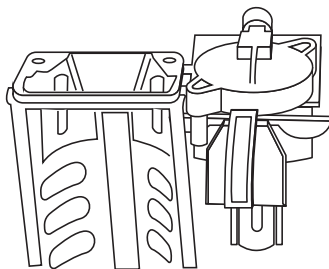
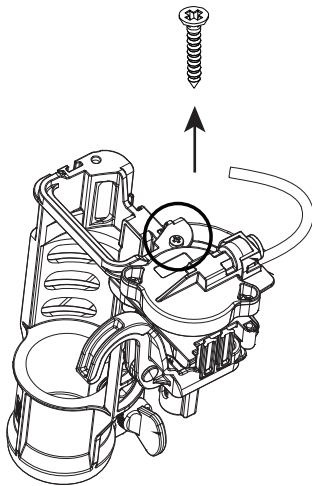

### 3. Remove Parts from Toilet

- Remove the fill line from the overflow tube, remove the flush valve tower then loosen the lock screw at the bottom of the tank.

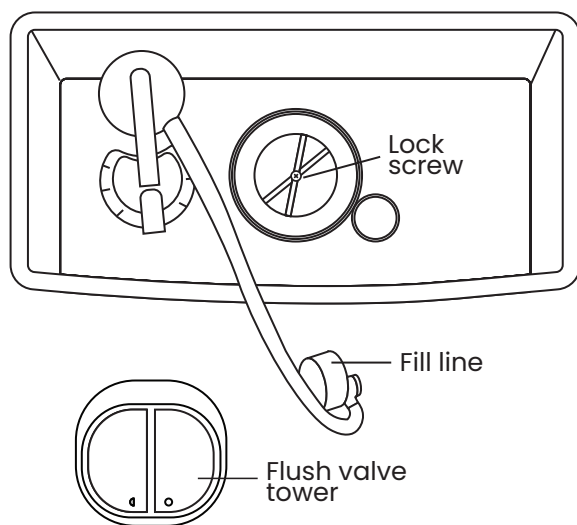

### 4. Re-install Flush Valve Tower

- Rotate the flush valve housing towards the back of the tank, then tighten the lock screw and re-install the flush valve tower.

**NOTE:** It is recommended to dry fit the retro kit to ensure there is enough clearance in the tank.

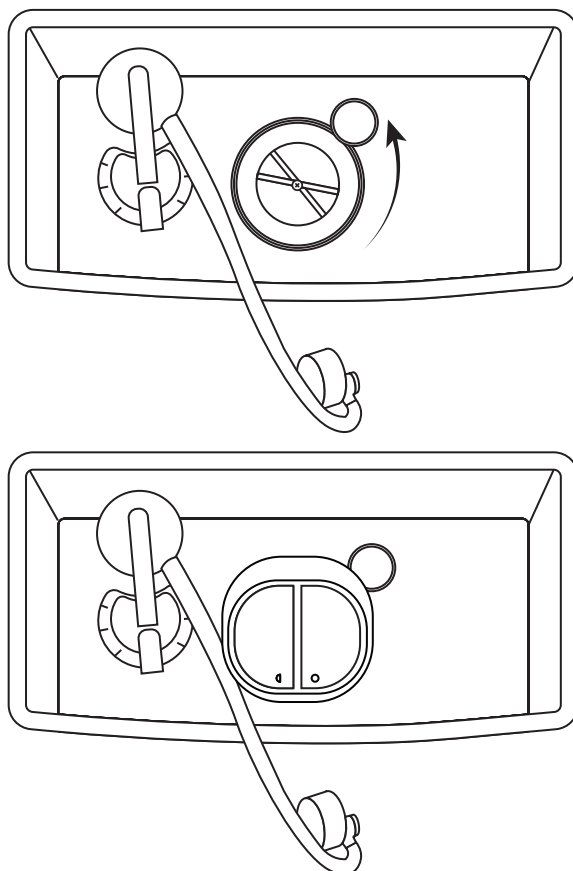

### 5. Remove Battery Box

- Unclip the battery box from the bracket.

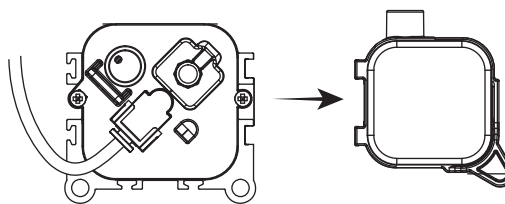
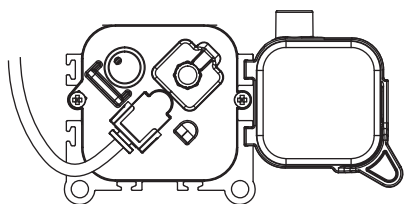

## 6. Install Retro-Fit Kit

- Loosen the wingnut and hang the bracket on the overflow tube.
- Adjust the distance of the push rod to the top of the flush button between 1mm and 3mm then tighten the wingnut.
- Hang the battery box and attach the fill line to the overflow tube.

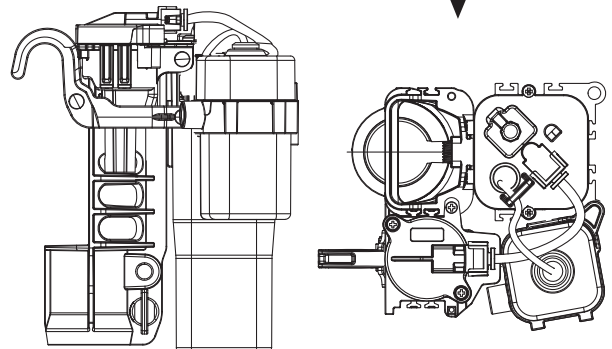
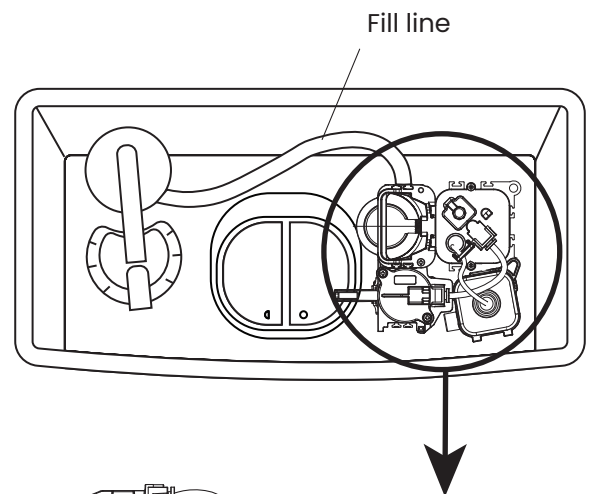
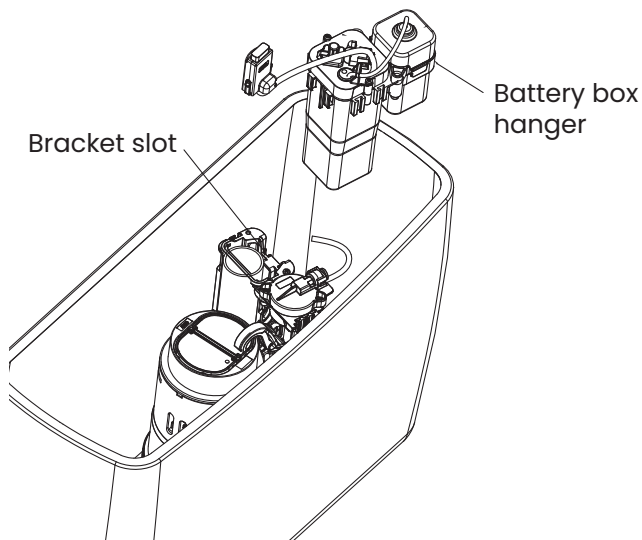
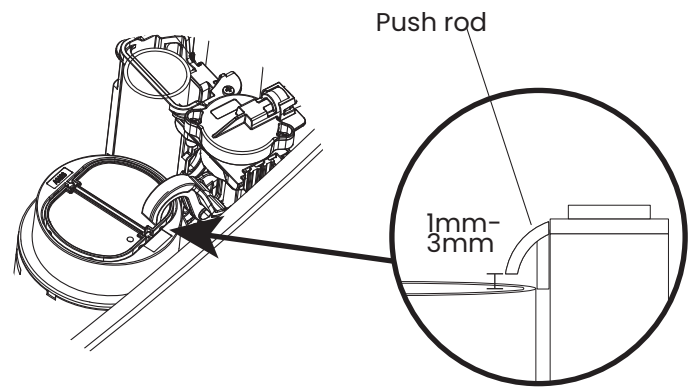
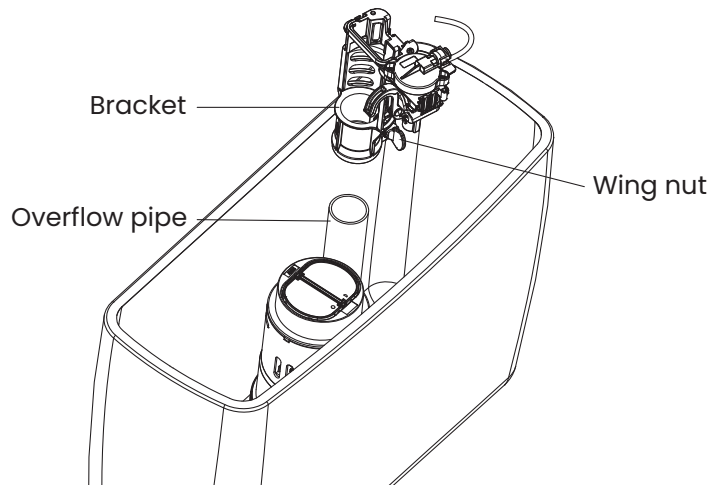

## 7. Cut & Install Sensor Button

- Measure the length of A, then measure the length of B from the highest point of the push rod.
- Cut part B to ensure the push rod is touching the top of the flush valve when the sensor button is installed.
- Install the sensor button on the lid of the tank and tighten the nut.
- Install the filter window into the installation slot of the sensor button.

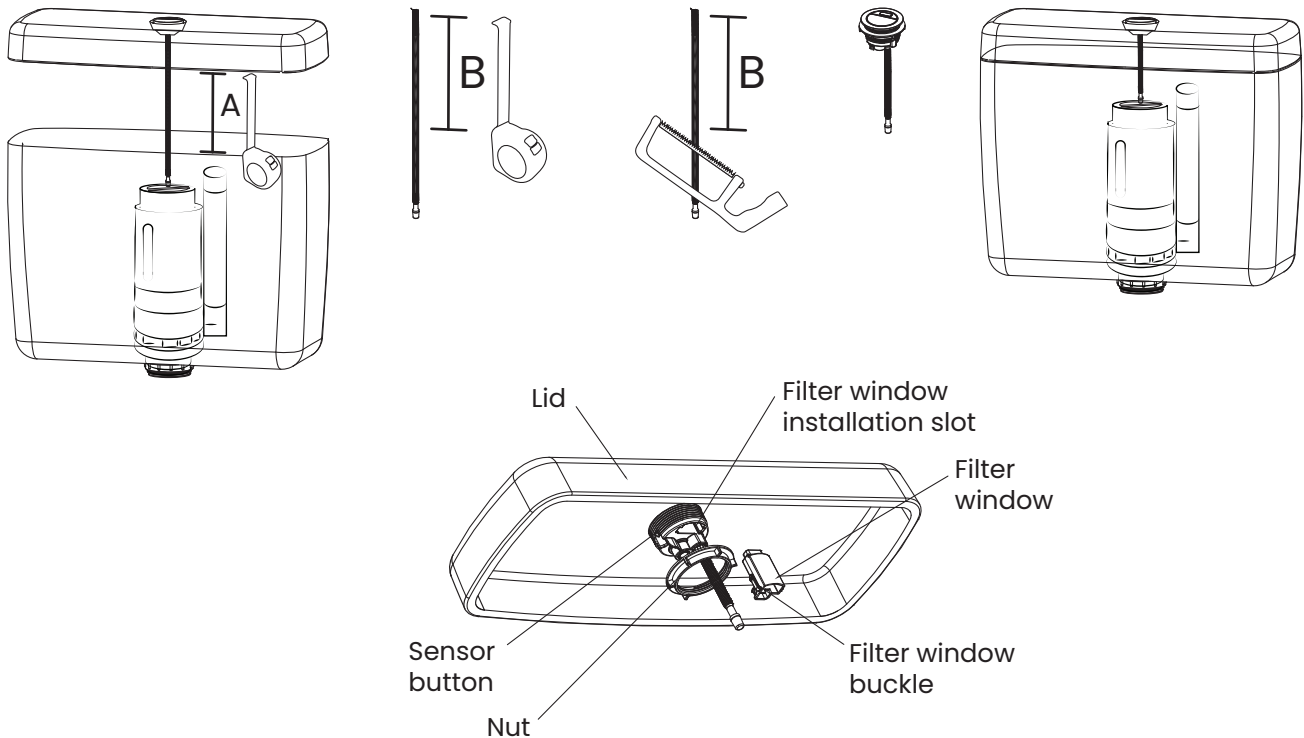

## 8. Install Batteries & Tank Lid

- Install four "AA" batteries into the battery box.
- When re-installing the cover of battery box, use your fingers to squeeze the side of rubber plug to exhaust air out of the box and ensure sealing.
- The batteries should be installed within three minutes before batteries are installed to the wall sensor. The codes will be automatically matched between the modules.
- Put the tank lid on the tank.
- Power on and flush once to ensure functionality.

**NOTE:** Batteries not included

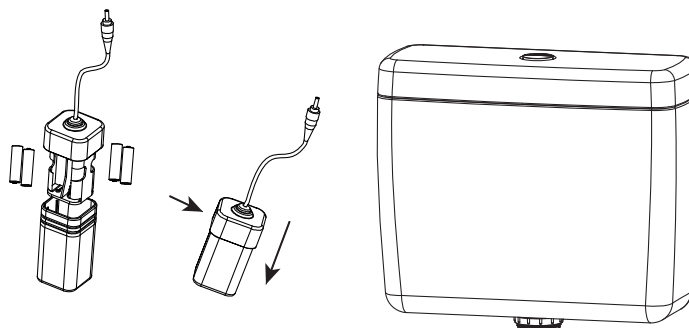

## WALL SENSOR INSTALLATION (optional):

### 1. Install Batteries

- Put three “AAA” batteries into the sensor and tighten the screws.
- The batteries should be installed within three minutes after batteries are installed to the battery box in the toilet. The codes will be automatically matched between the modules.
- When the codes match successfully, the indicator light will fast flash 3 times and the sensor will enter normal working stage. After three minutes, if the sensor is not working, restart code matching by reinstalling the batteries in both sensor modules.

**NOTE:** Batteries not included.

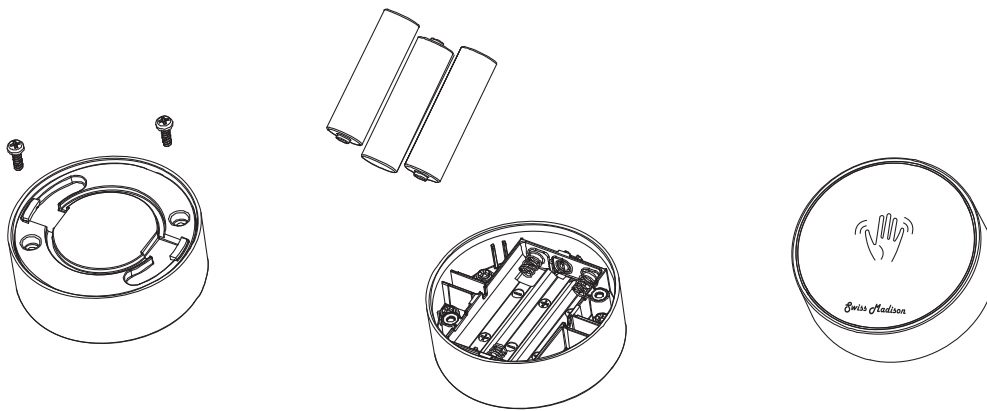

### 2. Install Sensor Mount

- The installation method depends on the wall it is being installed on. Determine appropriate installation method and follow the instructions on the next page.

**Method A: Screw fixing** - suitable for installation on rough walls.

**Method B: Adhesive fixing** - suitable for installation on tiles and other smooth walls.

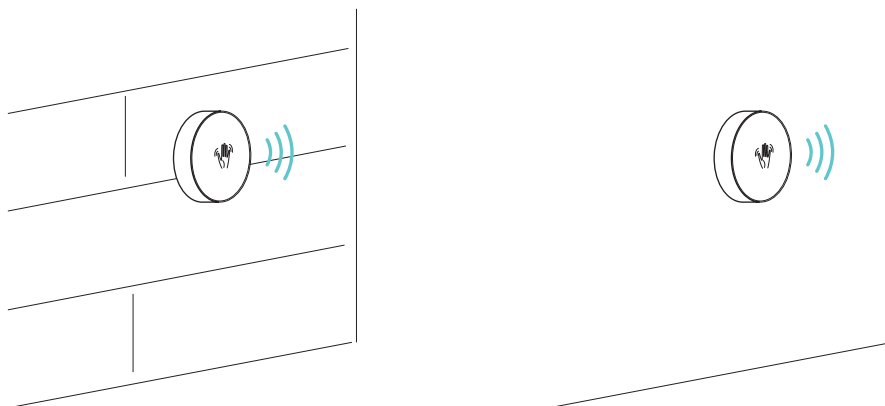



## Method A: Screw Fixing

### 2a. Mark Position

- Put the sensor wall mount on the wall where you want to install it and mark the position on the wall with a pen.

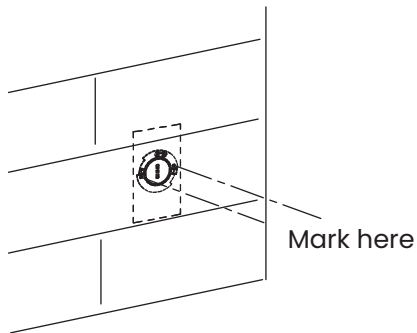

### 2b. Drill Holes

- Drill two horizontal holes, 0.24" in diameter, on the marked position. The distance between the two holes is about 2" and the depth is 1.18".

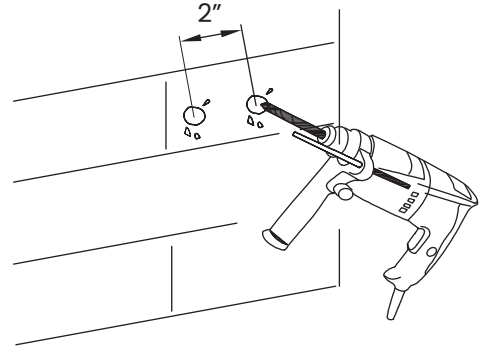

### 2c. Mark Position

- Put the expansion bolts into the holes on the wall.
- Place the sensor holder against the wall and align the holes with the expansion bolts, then tighten screws to lock it in place.

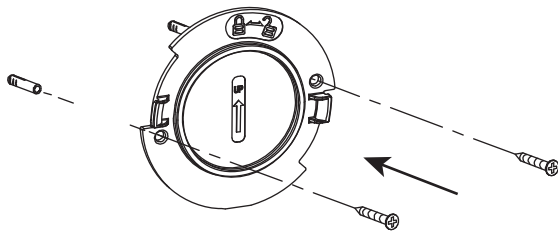

### 2d. Lock in Place

- Align the sensor slot with the sensor holder, and rotate counterclockwise to lock in place.

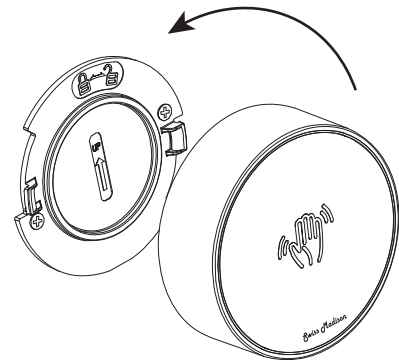

## Method B: Adhesive Fixing

### 2a. Adhere Holder to Wall

- Clean and dry the decided installation area of the sensor to optimize adhesion.
- Peel off the double-sided adhesive sticker on the back of the sensor holder and stick it vertically on the wall.

### 2b. Lock in Place

- Align the sensor slot with the sensor holder, and rotate counterclockwise to lock in place.

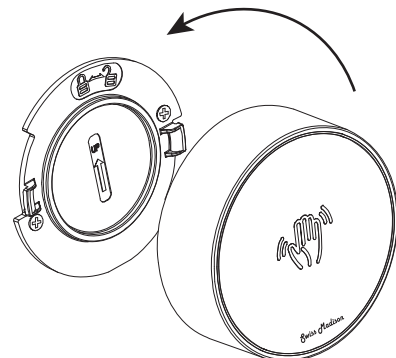

## TROUBLESHOOTING

### 1. Low flush volume.

Reason:

- a. The position of the actuation rod is too high and not pressing the flush button properly.
- b. The air pipe is not installed in the right place resulting in leakage.
- c. The actuation rod interferes with the flush valve during the flushing process.

Solution:

- a. Re-adjust the fixed position of the bracket.
- b. Re-insert the air tube into the quick-connect assembly.
- c. Re-adjust the position of the actuation module in the tank.

### 2. Does not automatically flush when you wave your hand over the sensor button.

Reason:

- a. Insufficient battery voltage.

Solution:

- a. Replace with new batteries.

### 2. Does not automatically flush when you wave your hand over the wall sensor.

Reason:

- a. Hand is outside of sensing range.
- b. Insufficient battery voltage.
- c. Code matching is not completed.

Solution:

- a. Wave hand within sensing range.
- b. Replace with new batteries.
- c. Re-match the codes by reinstalling both sets of batteries.

### 3. Does not flush, or has a low flush volume when pressing the mechanical flush button.

Reason:

- a. The connecting rod of the flush button is too short resulting in poor flushing performance.

Solution:

- a. Adjust the length of the connecting rod screwed into the buckle.

### 4. There is leakage.

Reason:

- a. The connecting rod is too long and the seal washer doesn't tightly cover the flush outlet.
- b. The actuation rod is positioned too low and the seal washer doesn't tightly cover the flush outlet.
- c. The installation position of the drive rod is too low, causing the water stop pad to be far from the drain.

Solution:

- a. Shorten the length of the connecting rod or adjust the length of the connecting rod screwed into the buckle.
- b. Re-adjust the fixed position of the bracket.
- c. Re-adjust the fixed position of the hinge.



1-434-MADISON  
(623-4766)

1www.swissmadison.com

## ONE YEAR LIMITED WARRANTY

Swiss Madison® products are made with quality materials and excellent craftsmanship to provide our customers with beautiful, durable, long-lasting products. Should there be any defects in materials or craftsmanship under regular use that are discovered within the first year of installation, Swiss Madison® will provide replacement parts at no charge, or at its discretion, replace any product or part of the product that is deemed defective, under normal installation, use, service or maintenance. This warranty applies only to the original purchaser. Proof of purchase will be required in the instance of a claim.

Swiss Madison® recommends all installations of Swiss Madison® products to be conducted by a licensed, professional plumber or contractor. Swiss Madison® will not be held responsible for any damage or product failure due to improper installation, misuse, or failure to utilize a licensed professional for installation. Swiss Madison® is not responsible for any installation or removal costs.

### **This One Year Limited Warranty Will Be Voided If:**

- The installation recommendations were not followed by the installer
- The product has been moved from its initial place of installation
- The product has in any way been modified from its packaged state
- The product has been subjected to improper maintenance, abuse, misuse, excessive use of chemicals, accidents, or other damages, etc.

Swiss Madison® makes no implication that its products comply with any local building or plumbing codes. It is the consumer's responsibility and obligation to determine local code compliance prior to and during installation. This warranty extends only to the original purchaser and first consumer.

Swiss Madison® is not responsible for any special, incidental or consequential damages associated with the installation, replacement, return or use of the original purchaser's product. This includes, but is not limited to: freight costs, labor, travel time, lost profit, home damages and other contingent liabilities and costs (including, without limitation, costs associated with 'professionals' or 'experts', investigations, audits, analyses, attorneys and any other professional/hired services).

The Swiss Madison® warranty is a comprehensive and explicit limit of liability. All items not disclosed within the warranty are not addressable within the responsibility of Swiss Madison®. Certain states have variances regarding implied warranties; in those situations, we remain fully compliant.

**If you have any questions or concerns, please contact us directly at  
1-434-MADISON (623-4766)**

**WARNING:** Contents of your order may contain sharp and possibly other harmful pieces and may cause hazard to children and adults. Swiss Madison® is not responsible in any way for personal damages.