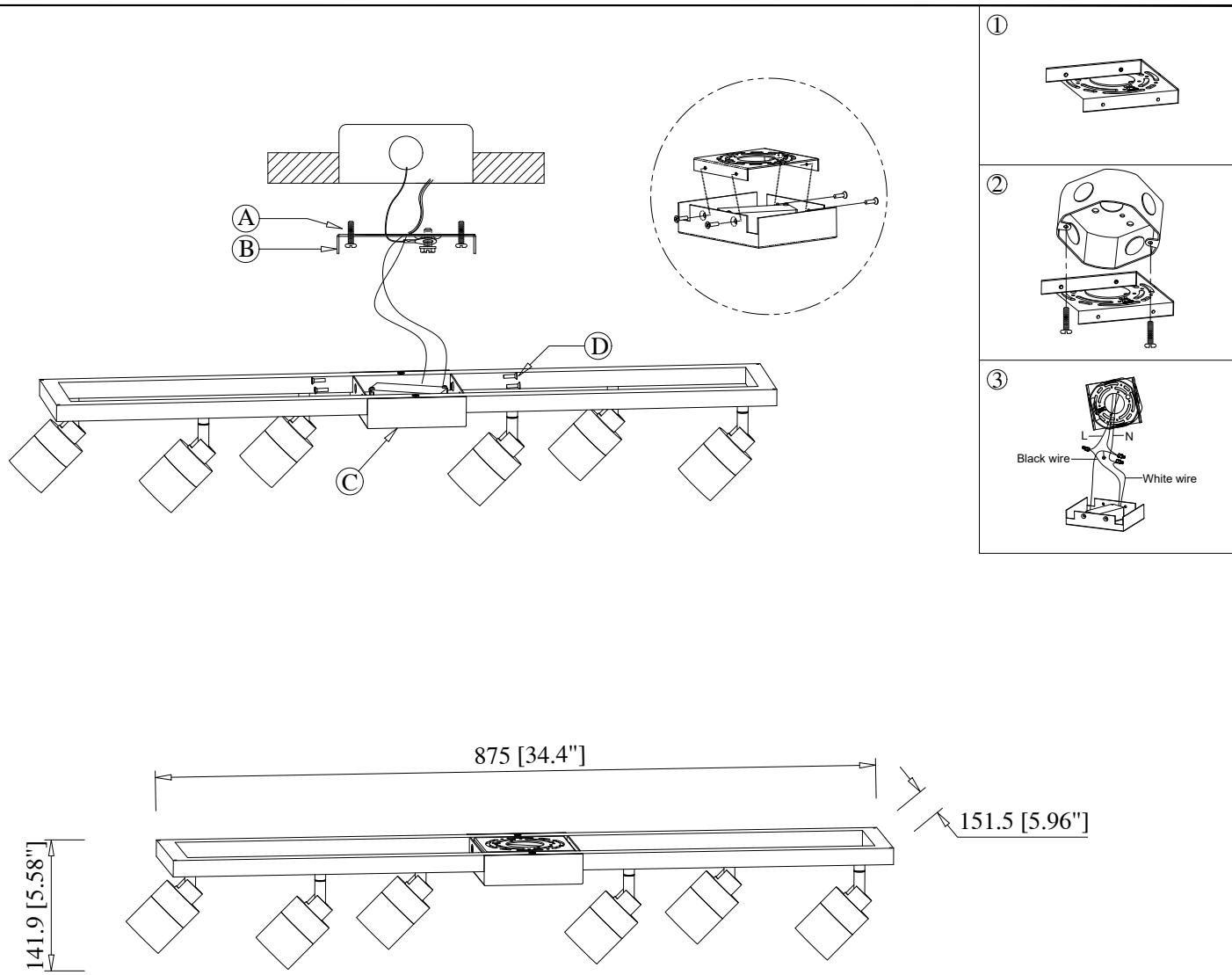

DIAGRAM OF INSTALLATION STRUCTURE

SKU No. :CE1008792 & CE1008793 & CE1008794 Product Size: L34.4"*W5.96"*H5.58"

Light Source: COB



(A) Mounting Screw

(B) Mounting Bracket

(C) Canopy&Lamp Assembly

(D) Flat Screw

Installation instruction

1. Turn off the power.
2. Dismantle mounting bracket subassembly as picture(1), install mounting bracket(B) to J-Box with mounting screws(A).
3. Connect the fixture to a suitable ground in accordance with local electrical codes.
4. Connect the White wire to the neutral power line wire with a wire nut.
5. Connect the Black wire to the hot power line wire with a wire nut.
6. Neatly place all wires and wire nut connections inside the J-box.
7. Install canopy&Lamp assembly(C) to ceiling with flat screw(D).
8. Turn on the power.