

Important safety instructions:

- Please read carefully all instructions before assembly.
- For your safety and ease, assembly by two or more adults is recommended.
- Keep instructions for future use.

Pre-assembly:

- Do not discard any content until assembly is complete to avoid accidentally discarding small parts or hardware.
- Take out all parts and hardware from box.

Parts List

ITEM	DESCRIPTION	QTY
P1	SHELF 1	1
P2	SHELF 2	1
P3	SHELF 3	1
P4	SHELF 4	1
P5	SHELF 5	1
P6	BACK FRAME	1
P7	DRAWERS	1
P8	LEFT LEG FRAME	1
P9	RIGHT LEG FRAME	1
P10	STRECHER	1

Step 1: Assemble the bookcase on a flat, soft surface such as a carpet or cloth to prevent scratching the finish. Attach the back frame (P6) to shelf (P5) using Allen key (H5), Lock washer (H4), Flat washer (H3) and Bolt (H2) as shown below.

- (H2) x 3 BOLT $\frac{1}{4}$ " x $1\frac{3}{8}$ " L
 (H3) x 3 FLAT WASHER $\frac{1}{4}$ "
 (H4) x 3 LOCK WASHER $\frac{1}{4}$ "
 (H5) x 1 ALLEN KEY

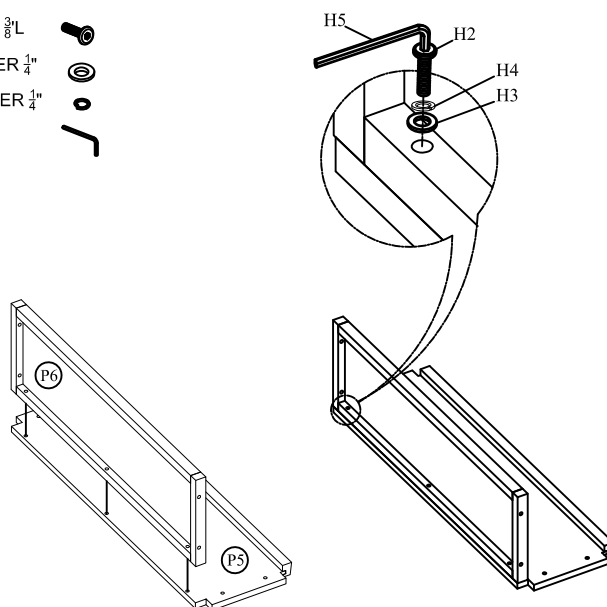

Hardware List

ITEM	DESCRIPTION	QTY
H1	BOLT $\frac{1}{4}$ " x $\frac{5}{8}$ " L	18
H2	BOLT $\frac{1}{4}$ " x $1\frac{3}{8}$ " L	11
H3	FLAT WASHER $\frac{1}{4}$ "	29
H4	LOCK WASHER $\frac{1}{4}$ "	29
H5	ALLEN KEY	1
H6	ANTI-TIP KIT	1 SET

Step 2: Loosely attach shelf (P5) to left leg frame (P8) using Lock washer (H4), Flat washer (H3), Bolt (H2) and Allen key (H5), and loosely attach shelf (P1, P2, P3, P4) & stretcher (P10) to left leg frame (P8) using Lock washer (H3), Flat washer (H3), Bolt (H1) and Allen key (H5), as shown below.

- (H1) x 3 BOLT $\frac{1}{4}$ " x $\frac{5}{8}$ " L
 (H2) x 3 BOLT $\frac{1}{4}$ " x $1\frac{3}{8}$ " L
 (H3) x 3 FLAT WASHER $\frac{1}{4}$ "
 (H4) x 3 LOCK WASHER $\frac{1}{4}$ "
 (H5) x 1 ALLEN KEY

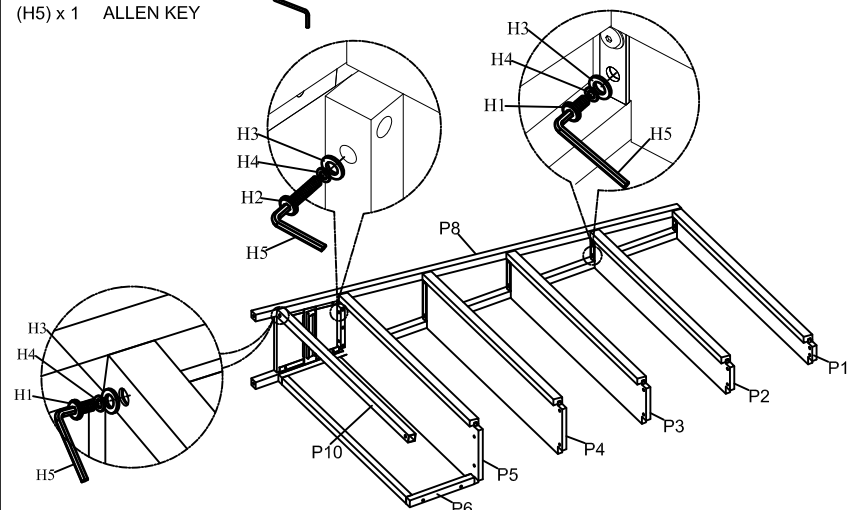

Step 3: Loosely attach right leg frame (P9) to shelf (P1, P2, P3, P4) & stretcher (P10) using Lock washer (H4), Flat washer (H3), Bolt (H1) and Allen key (H5), and loosely attach left leg frame (P9) to shelf (P5) & using Lock washer (H4), Flat washer (H3), Bolt (H2) and Allen key (H5), as shown below.

(H1) x 3 BOLT $\frac{1}{4}$ " x $\frac{5}{8}$ " L
 (H2) x 3 BOLT $\frac{1}{4}$ " x $1\frac{3}{8}$ " L
 (H3) x 3 FLAT WASHER $\frac{1}{4}$ "
 (H4) x 3 LOCK WASHER $\frac{1}{4}$ "
 (H5) x 1 ALLEN KEY

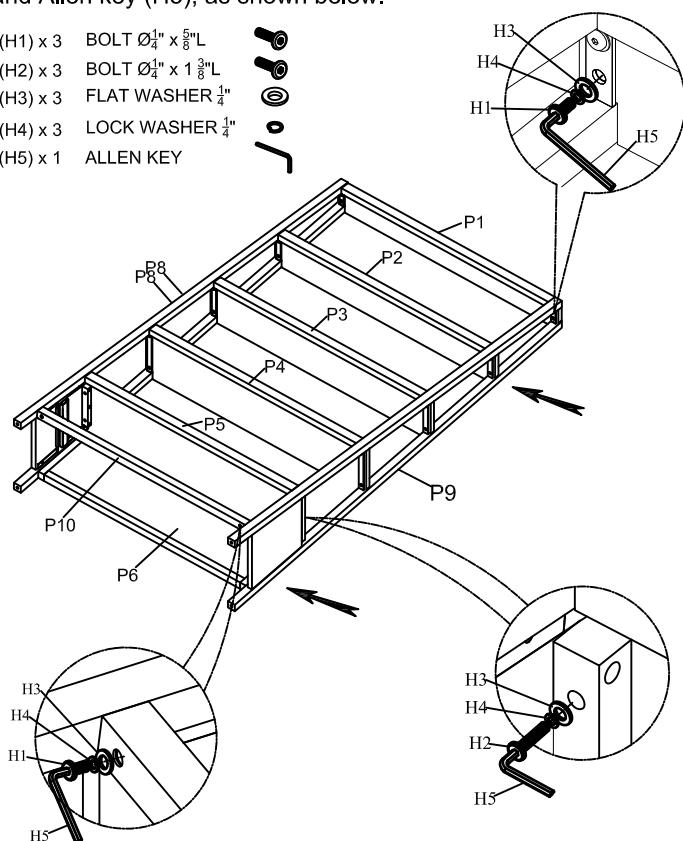

Step 4: With one person for help, turn the assembled bookcase to an upright position. Attach the back frame (P6) to right leg frame (P9) and left leg frame (P8) using Lock washer (H4), Flat washer (H3), Bolt (H2) and Allen key (H5) as shown below.

(H2) x 4 BOLT $\frac{1}{4}$ " x $1\frac{3}{8}$ " L
 (H3) x 4 FLAT WASHER $\frac{1}{4}$ "
 (H4) x 4 LOCK WASHER $\frac{1}{4}$ "
 (H5) x 1 ALLEN KEY

Caution:

Please pull tightly the left/right frame to all shelves & stretcher and make sure the bookcase is level before securely tighten all bolts with Allen key.

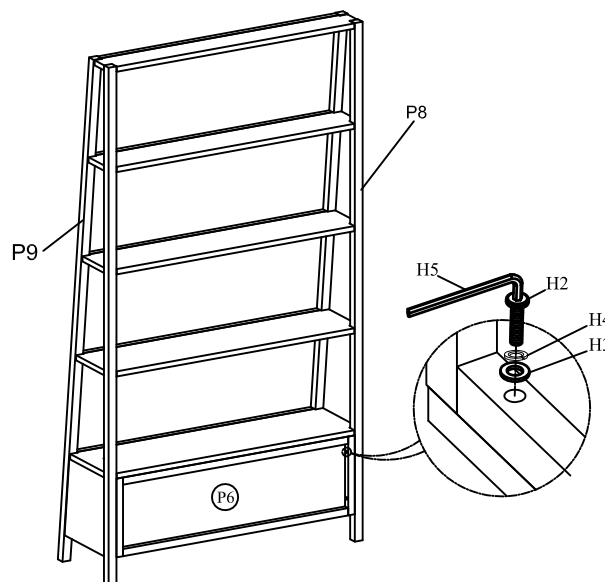

Step 5: Attach the drawer (P7) to the book case.

Note: Please slide ball bearing to front see diagram 1 diagram 2, then hold each drawer evenly and line up the side glide on the drawer side panel with the drawer glide on the drawer box. Then push the drawer into the drawer box.

Diagram 1
Please slide ball bearing to front as picture

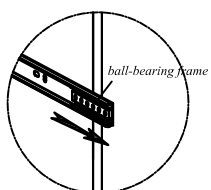

Diagram 2
Attach the drawer and push it in

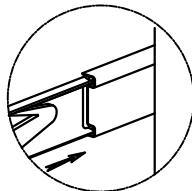
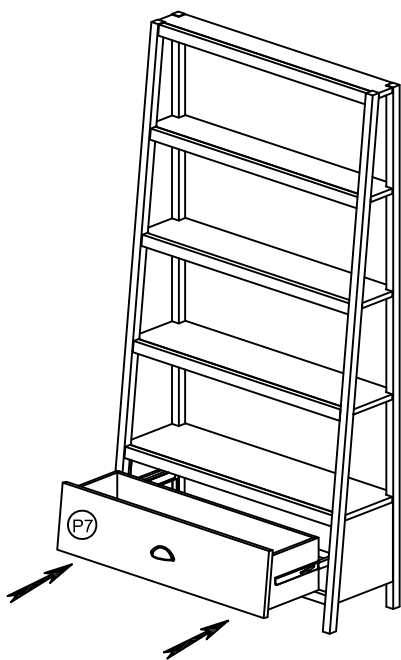
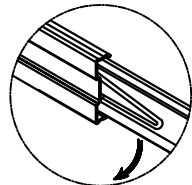

Diagram 3
Push locks on drawer side slide to remove the drawer if necessary.



Step 6:

- 1) To level bookcase: if there is a gap between the floor, please adjust the leveler up or down under each leg.
- 2) Assembly is complete. **Failure to follow these instructions may cause the bolts to misalign during assembly.**
- 3) **Recommend that you attach the products to a wall as a safety precaution.** Please see the other instructions "Furniture Safety Bracket Tip resistant".

(H6) x 1 set ANTI-TIP KIT

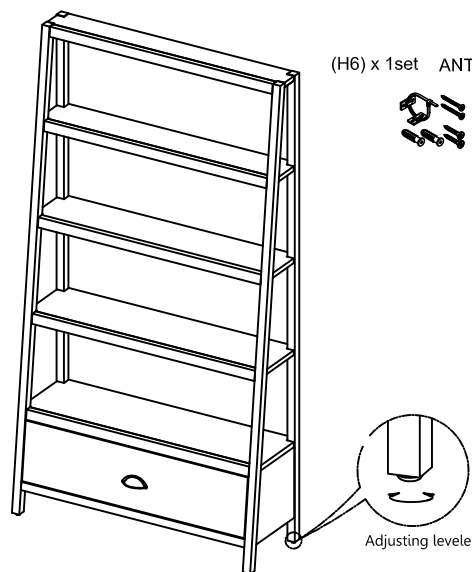

ADDITIONAL NOTE ABOUT SAFETY: BOLTS MAY LOOSEN DURING NORMAL EVERYDAY USE. THEY SHOULD BE PERIODICALLY INSPECTED AND RE-TIGHTENED TO PREVENT DAMAGE OR INJURY. ALWAYS CHECK TO ENSURE THAT ALL HARDWARE IS KEPT TIGHTENED.

Thank you for your purchase