

Read this instruction carefully. See hardware and furniture part list for guidance. Be sure all parts are complete, before you assemble. Place all wooden furniture parts on a clean and flat soft surface to prevent from being scratched. Follow the figure to start assembling.

CAUTION : 1. Do not FULLY - TIGHTEN the nuts or nut bolts until they are ready for assembly.
2. Do not OVER - TIGHTEN the nuts or bolts to avoid causing damages to the thread.
3. Keep all hardware parts out of reach of children.

NOTE : THE LIST AND QUANTITY SHOWN ARE FOR 1 UNIT ASSEMBLY.
Tools needed : Screwdriver & Rubber Mallet (not provided).

PART LIST		
ITEM	DESCRIPTION	QTY
A	HEADBOARD	1 PC
B	FOOTBOARD	1 PC
C	BED LEG (6618)	4 PCS
D	SIDE RAIL	2 PCS
E	HEADBOARD WING	2 PCS
F	SIDE RAIL SUPPORT WOOD	2 PCS
G	CENTER RAIL	1 PC
H	CENTER SUPPORT LEG	3 PCS
I	BED SLAT	1 SET

**** STICKY**

① **BED LEG (M13)**

② **BED LEG (6618)**

HARDWARE LIST		
ITEM	DESCRIPTION	QTY
1	JCBC BOLT M6 x 20mm	8 PCS
2	JCBC BOLT M6 x 40mm	14 PCS
3	M6 FLAT WASHER	14 PCS
4	M6 SPRING WASHER	8 PCS
5	WOOD DOWEL M8 x 30mm	4 PCS
6	WOOD SCREW M4 x 25mm	16 PCS
7	WOOD SCREW M4 x 20mm	2 PCS
8	WOOD SCREW M4 x 32mm	9 PCS
9	M4 ALLEN KEY (BALL SHAPE)	1 PC
10	M5 ALLEN KEY (BALL SHAPE)	1 PC

****NOTE :** Wood Screw M4 x 25mm extra 8PCS .

STEP 1 **NOTE : According the sticky (ii) assembly leg.**

STEP1.1

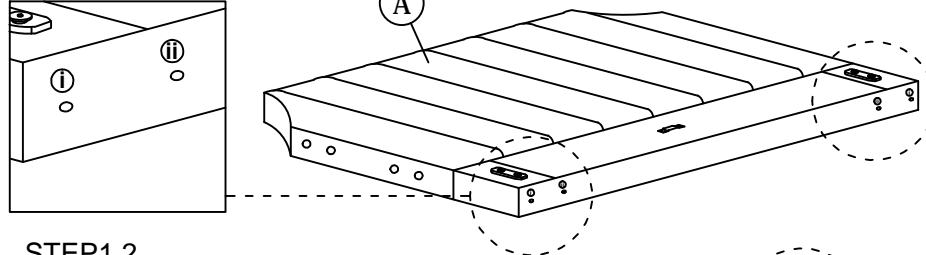

STEP1.2

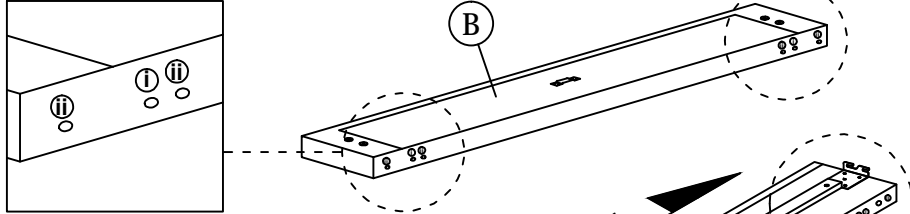

STEP1.3

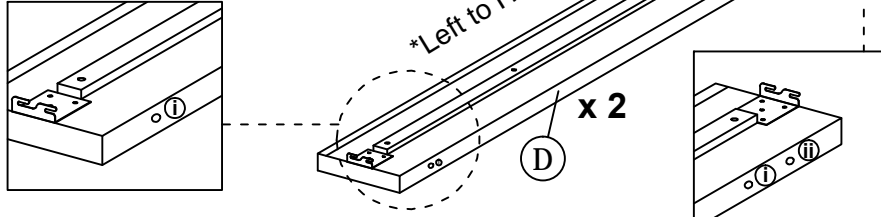

STEP 2

Take out HEADBOARD WING (E) from the HEADBOARD (A).

STEP2.1

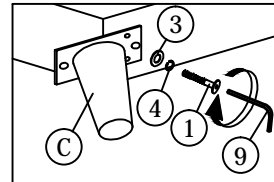

Do not fully tighten yet.

STEP2.2

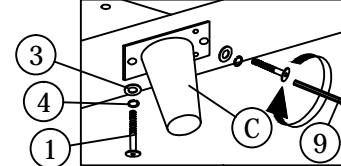

STEP2.3

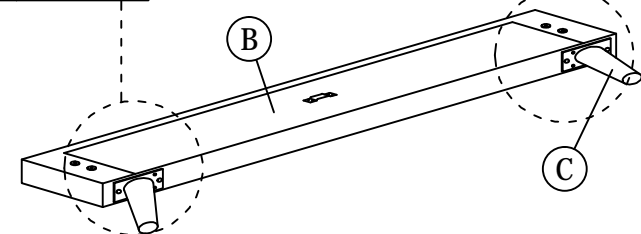
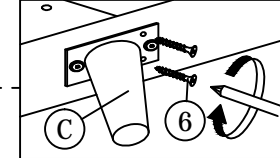

ASSEMBLY INSTRUCTIONS

2 of 4

STEP 3

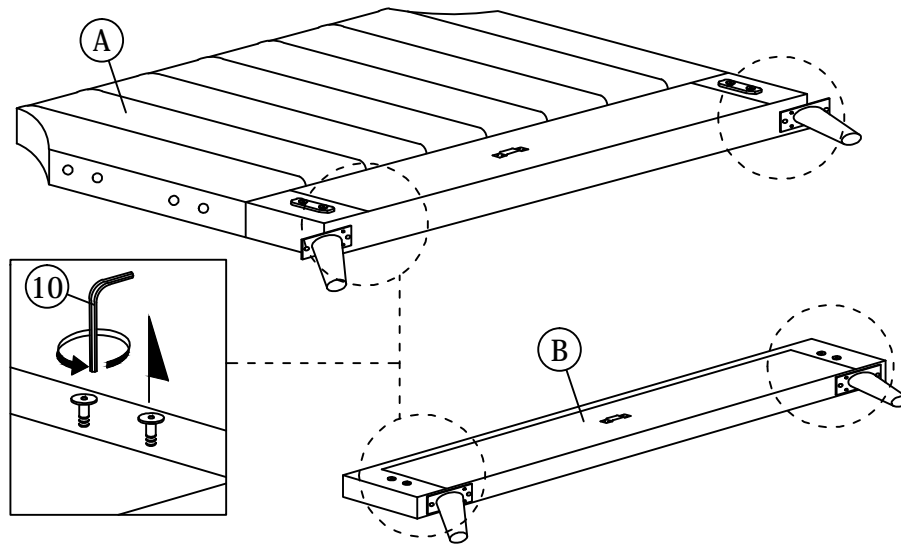

STEP 4

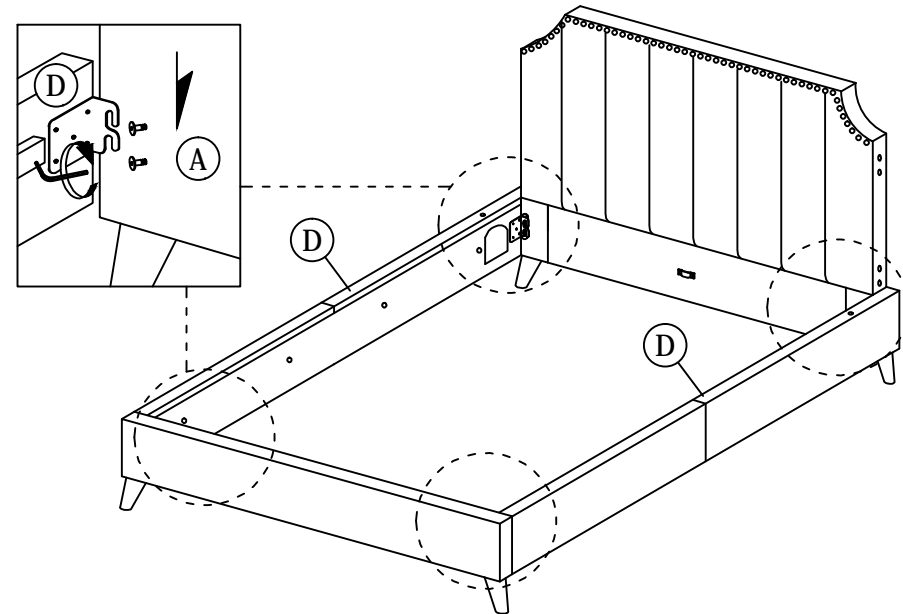

STEP 5

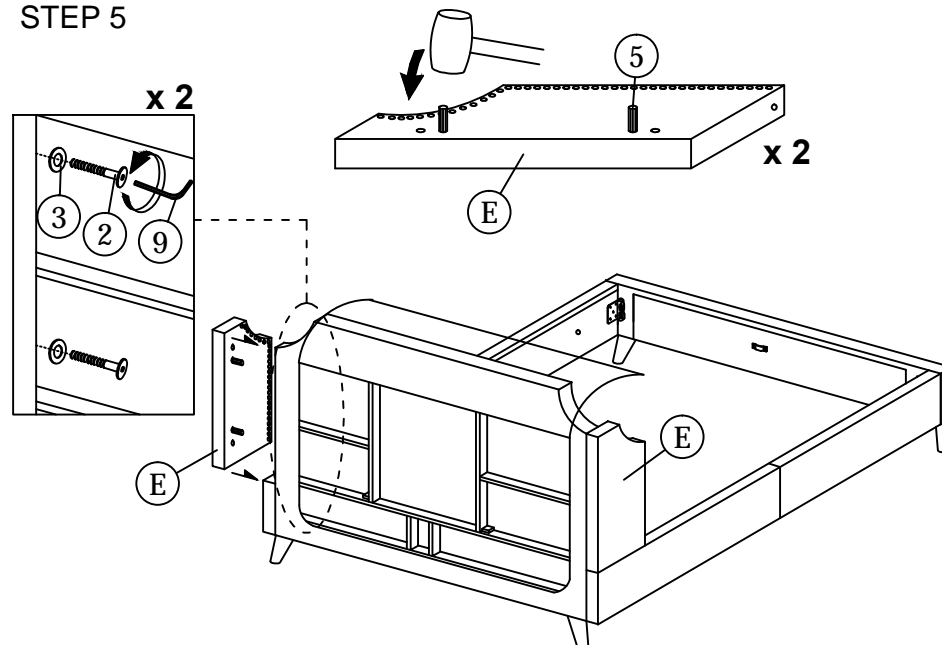

STEP 6

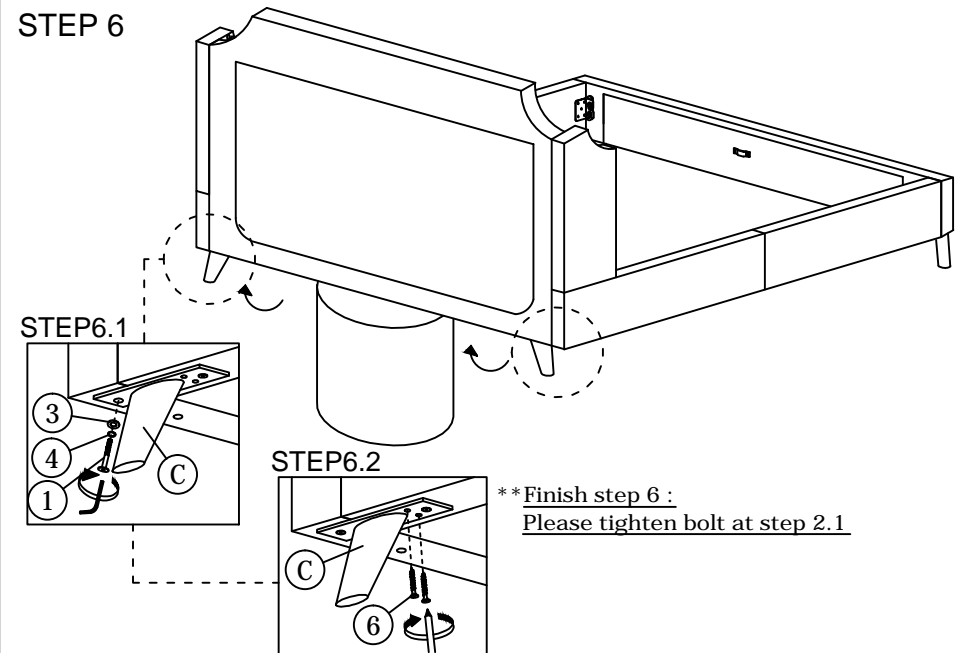

ASSEMBLY INSTRUCTIONS

3 of 4

STEP 7

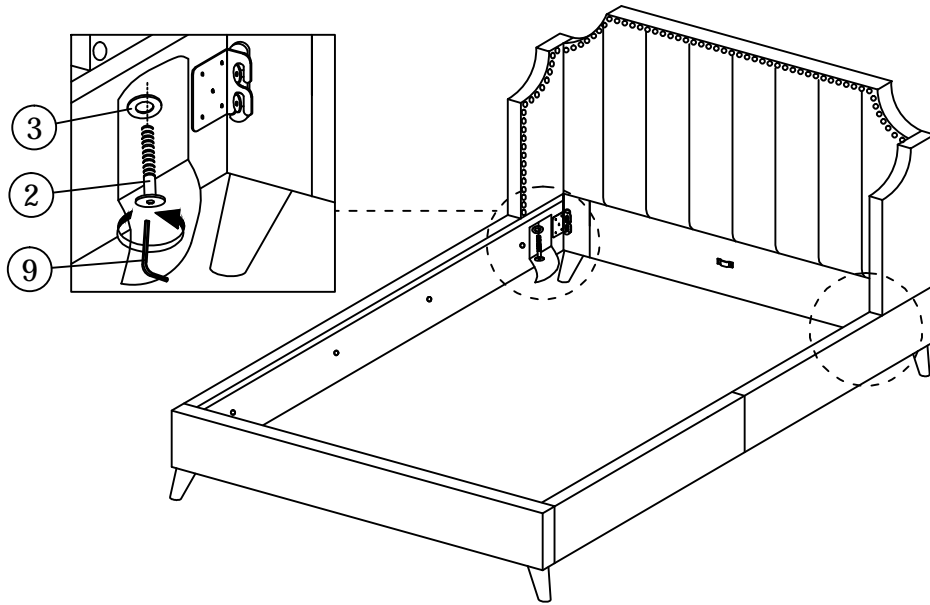

STEP 8

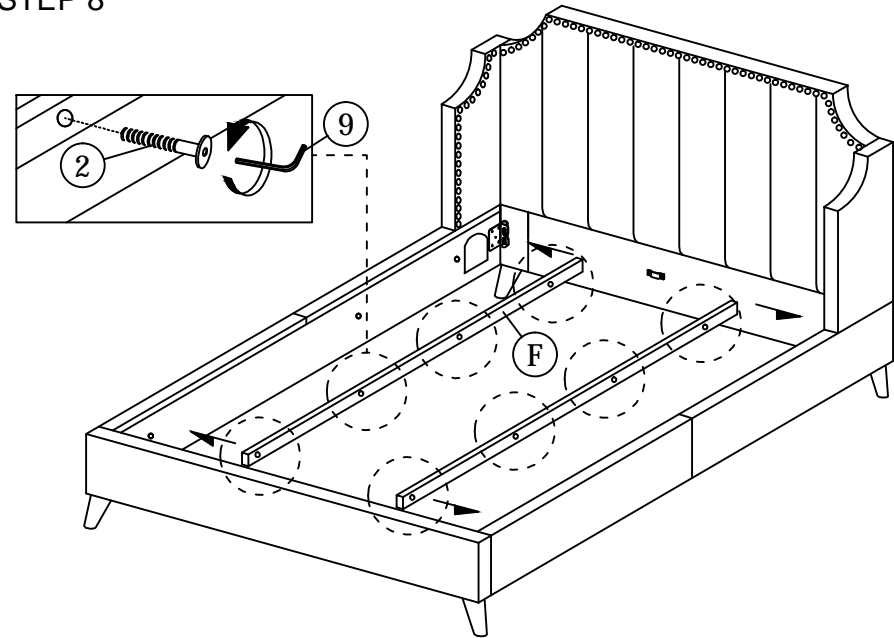

STEP 9

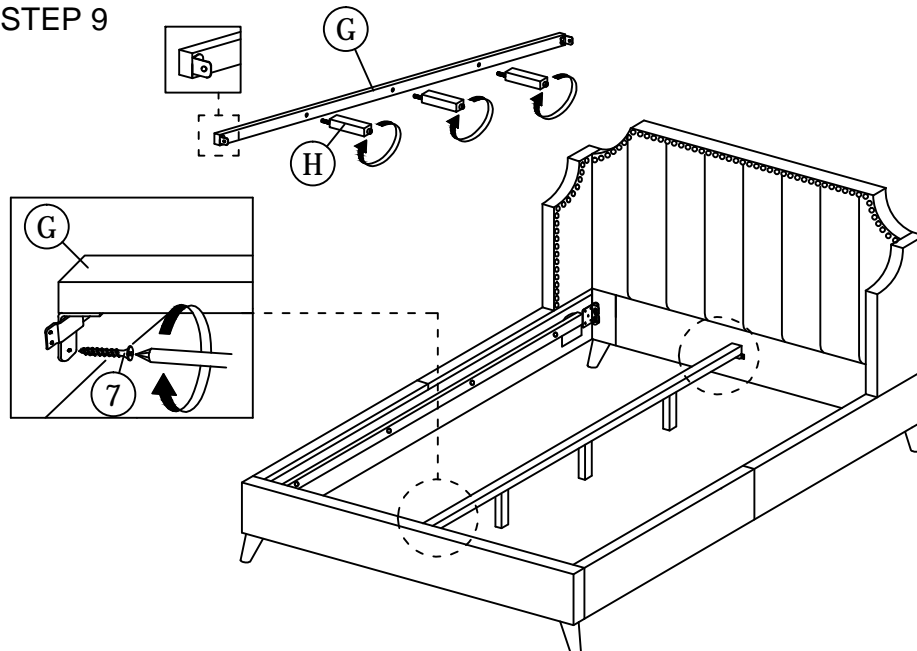

STEP 10

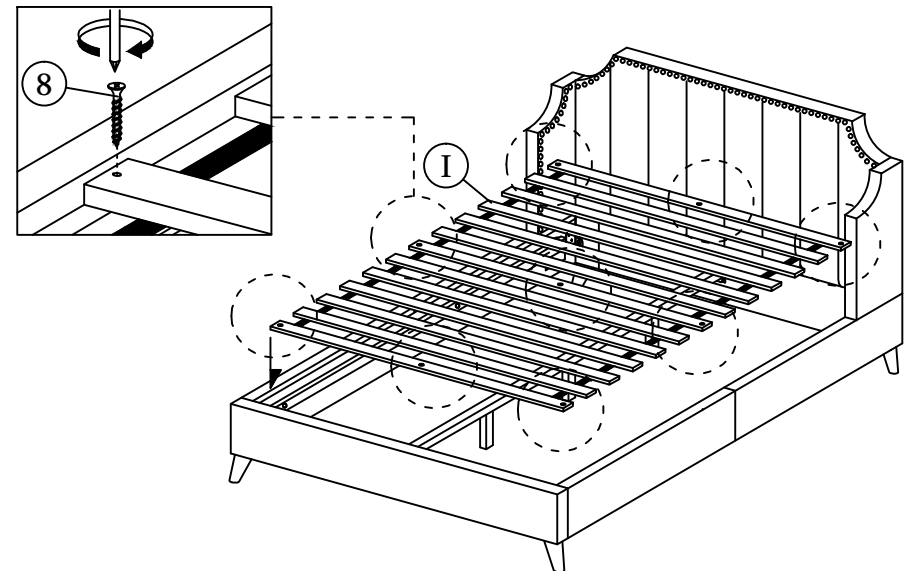

ASSEMBLY INSTRUCTIONS

4 of 4

QUEEN SIZE BED

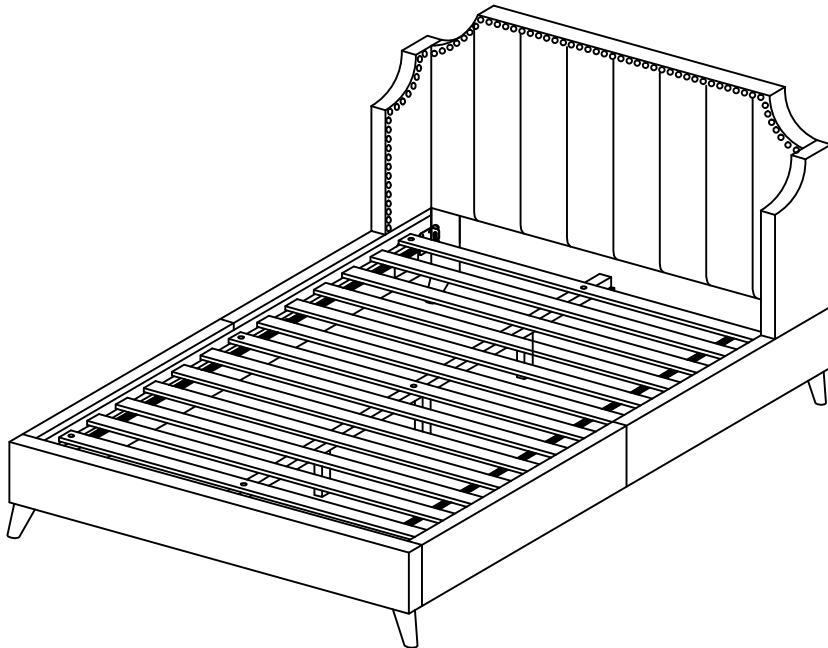

KING SIZE BED

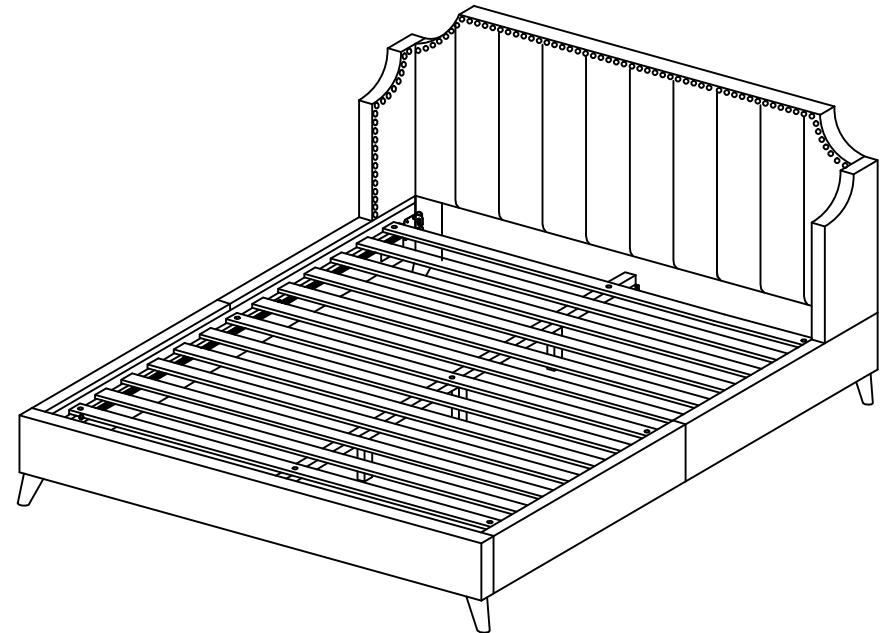

* When moving the bed position, the center support legs
must be adjusted or straightened to avoid any broken problems.