



Steward®

Hybrid High Efficiency Urinal (HEU)

K-5244-ER

Features

- Revolutionary funnel design virtually eliminates splashback.
- KOHLER-engineered water flushing spreader successfully rinses the inverted back wall, sides, and front of the urinal basin for a more sanitary customer experience.
- Ultra low consumption. Operates at 0.125 gpf (0.47 lpf).
- 1/2" (12.7 mm) flexible rear supply hose.
- Includes removable strainer, 2" outlet spud, universal mounting bracket, and hangers.

Material

- Vitreous china.

Installation

- Large footprint covers old urinal wall print.

Water Conservation & Rebates

- Offers 80% water savings compared to standard 1.0-gpf urinals.
- This product can help a building earn Water Efficiency points in the LEED Green Building Rating System™. See specification sheet for water use data.

Recommended Products/Accessories

K-23726 Drain treatment

Included Components

Additional Components:

2" outlet spud
5/8" male adapter
Braided stainless steel hose, G1/2
Hanger(s) (Qty 2)
Removable strainer
Universal mounting bracket



ADA

Codes/Standards

ASME A112.19.2/CSA B45.1
DOE - Energy Policy Act 1992
EPA WaterSense®
California Energy Commission (CEC)
ADA
ICC/ANSI A117.1



KOHLER® One-Year Limited Warranty

See website for detailed warranty information.

Available Colors/Finishes

Color tiles intended for reference only.

| Color | Code | Description |
|-------|------|-------------|
|-------|------|-------------|

| | | |
|--|---|--------------|
|  | 0 | White |
|  | 7 | Black Black™ |

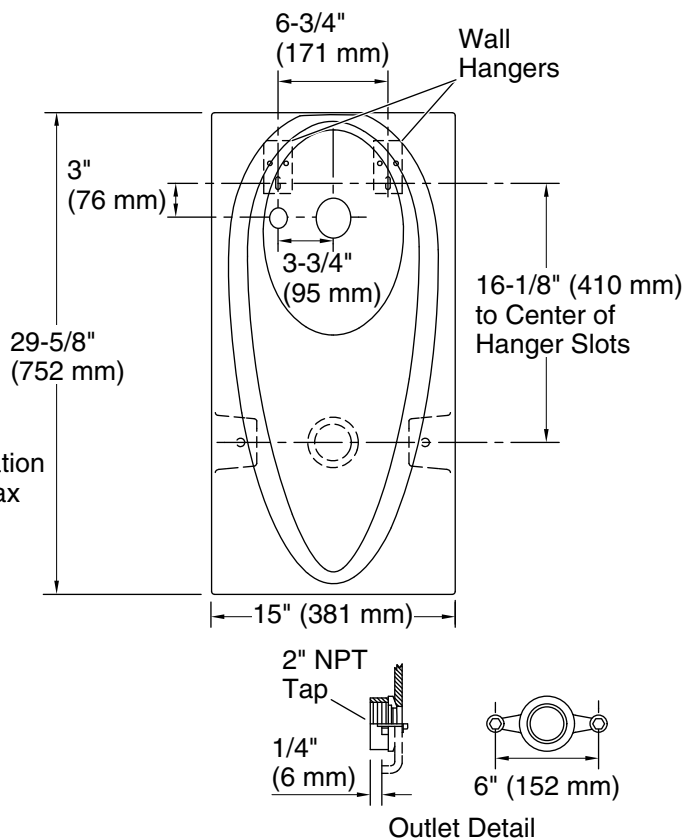
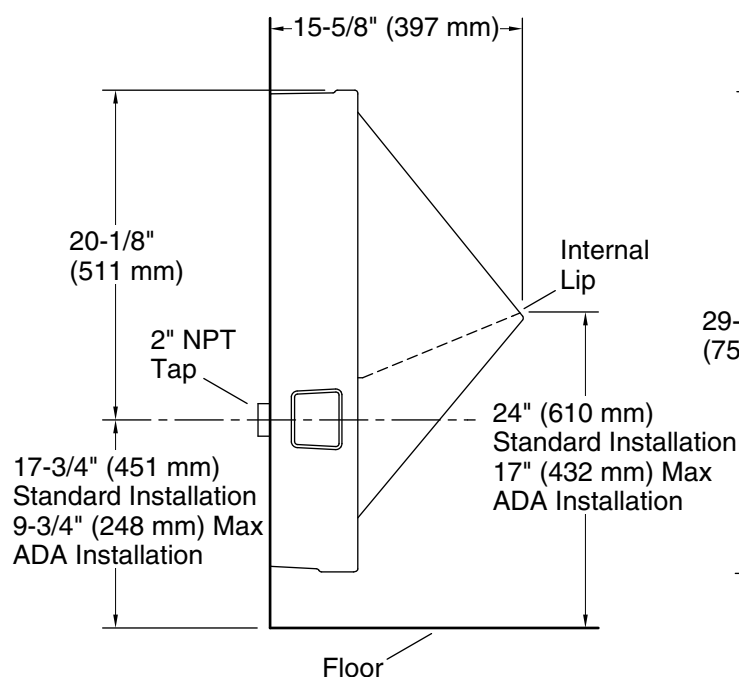

Technical Information

All product dimensions are nominal.

Spud size: 3/4", Inlet, Rear

Spud size: 2", Outlet, Rear

Min. Water per Flush: 0.125 gal (0.5 L)

Designed for the above water use when installed with a water-saving flushometer.

Notes

Install this product according to the installation guide.

Recommended ADA outlet spud height will account for normal product variation.

For ADA compliance, measurement must be 17" (432 mm) or less from the floor to the top of the lip.

ADA compliant when installed to the specific requirements of these regulations.