

Limited Warranty Information

Thank you for choosing an Alpine product! We aim to please with our wide range of products including Fountains, Birdbaths, Statuary, Pond Supplies & More. All of our products are constructed from the highest quality materials. In the event that we have not achieved our usual standard of excellence, we will repair or replace, at our discretion, within the warranty period. A valid proof of purchase, with the purchase date clearly indicated, must be provided. Photos of defective merchandise will also be required to help distinguish the actual cause of the defect. Please read below for a detailed description of warranty coverage.

- **Water Damage**

Alpine products are not manufactured to withstand extreme temperatures. Improper storage that allows water to freeze within a product may cause damage and is considered negligence and will, therefore not be covered under this warranty. The use of "hard water" and/or caustic cleaners can affect the paint or other finishes. Failure to keep the unit clean, and use of such additives/cleaners, will also void the warranty. Please note: for fountains, it is normal for some splashing to occur and protecting the immediate surfaces is not the responsibility of Alpine Corporation

- **Paint & Color (Retention and/or Loss)**

The use of water will cause natural erosion to the color. This area can be touched up using standard paint. The paint is designed to protect the entire finish against breakdown of color. As with any product, all finishes with time will gradually fade and discolor. The warranty will only cover against severe or complete fading within the first year from date of purchase with the above exclusion.

- **Procedure/Service**

Should a warranty/claim be needed, you should contact the retailer from whom you purchased the product. If that is not an option, you can contact Alpine Corporation at www.alpine4u.com. When contacting Alpine Corporation, you must be prepared to show proof of purchase, provide photographs and any other information needed to validate your claim. This may be necessary to distinguish between a partial or complete replacement of a defective product. The warranty does not cover any items with multiple parts; the warranty will ONLY cover the individual component of the unit/item that may be defective. Replacement parts can be made available to a consumer through the original selling party, or an approved parts retailer. If this is not an option, contact our customer service department. Item is covered under one year limited warranty from the date of purchase. When requesting replacement parts due to a warranty claim after 30 days of purchase, credit card information will be requested for shipping charges.

- **Not Covered Under Warranty**

The limited warranty will NOT cover cases of damages due to

1. Damages caused in Transit
2. Inadequate care and/or neglect
3. Environmental and/or natural elements
4. Immersion in water, unless specified
5. Improper Installation/Storage and/or Maintenance

This warranty is void if the product has been damaged by accident, misuse, negligence, improper installation and/or modifications have occurred. This includes any and/or all defects arising out of freezing water damage, hard water damage, failure to keep the unit clean and free of harmful additives such as bleach, chlorine, etc.... which affects the paint and/or parts. This warranty also does not cover any additional charges or installation, removal, disposal and/or shipping costs or consequential damage associated with any warranty claim



MAZ260 24" Birdhouse into Watering Can Floor Fountain



Assembling & Using Your Product

Unpack all components carefully. Please check to ensure all parts have been removed from the packaging. Some splashing may occur.

Assembly Instructions

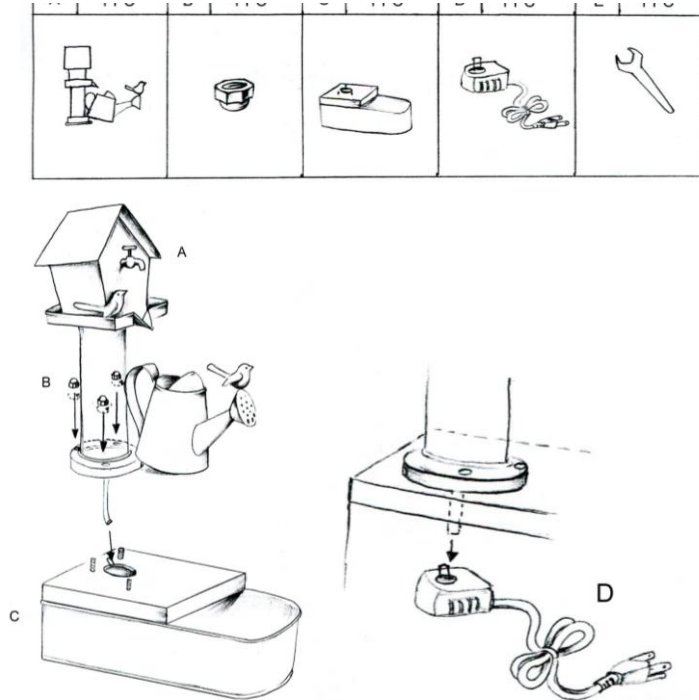

Assembling:

- Place the fountain base (C) on a leveled surface.
- Connect the vinyl tubing from the top of the fountain (A) to the water pump (D) **as shown in diagram above**. Make sure to feed the pump cord out the back of the fountain. Adjust the flow control to the lowest setting to avoid splashing until the fountain is completely assembled.
- Assemble the fountain topper (A) to the bottom (C) using the nuts and screws (B) and (E) **as shown in diagram above** **MAKE SURE THE PUMP IS CONNECTED TO VINYL TUBE BEFORE ASSEMBLING**
- Gently pour water into the fountain, being careful not to overflow and cause splashing. Make sure the water completely submerges the pump and the water flows smoothly during operation.
- Plug into your local power supply. Make sure that there is no water around the transformer and always keep the power source in a dry place.
 - NOTE: We recommend that you use distilled water to prevent scale build-up. The first time you operate the pump it can take up to 5 minutes for the air to be completely expelled and water begins to flow properly. Recommended flow control should be set to 300L per hour.

Troubleshooting & Caution

If you have any questions and/or problems, please contact the retail store you purchased this fountain.

- **If your pump fails to run**
 - Check the circuit breaker or try a different outlet to make sure the pump is receiving electrical power
 - Check the pump discharge and tubing for any kinks and/or obstructions
 - Any buildup obstructing the water flow can be flushed with a garden hose
 - Check the rotor by removing the front cover & plate to access the impeller area. Turn the rotor and make sure that the rotor is not jammed or broken
- **If your pump “spews”**
 - Check the water level to make sure the pump is completely submerged and there is enough water in the basin to operate your fountain. Not having enough water will cause your pump to spew
- **If your pump is making abnormal loud noises**
 - Disconnect the pump from the electrical power supply and remove the front cover & plate
 - Carefully grip the impeller and gently pull the impeller/rotor assembly out of the pump housing
 - Rinse the impeller/rotor assembly and clean the cavity with clean water. If breakage or damage is found, contact your local retailer for part
- **Fountain Care**
 - We recommend to use Alpine’s all natural cleansing formula to eliminate foam, lime scale and calcium buildup, fight mineral deposits, leave water crystal clear, help prevent staining, remove organic contaminants and treat discolored water. This formula will help prevent pump damage due to hard water build up.
 - i. For small sized fountains holding water up to 7liters of water, we recommend Alpine Item # PPL100
 - ii. For larger sized fountains holding water over 7liters of water, we recommend Alpine Item # PPL102
 - iii. For more information please visit www.alpine4u.com



- **Caution**
 - **Always unplug the pump from the electrical outlet before cleaning & handling**
 - **Uses with clean water only, do not place the fountain and/or parts in any other liquid**
 - **Periodically change water & clean the pump to keep free from micro-organisms**
 - **Disconnect and store the unit in a dry place if not in use for an extended period of time**
 - **Do not operate with water above 90°F or 30°C**
 - **Do not lift, carry or pull the pump by the power cord**
 - **Do not exceed the maximum voltage & wattage on transformer**
 - **NEVER LET THE PUMP RUN DRY**