

Assembly Instructions

Foundation Corner Desk with Storage Cabinet

Components

Storage Cabinet:

- 1** Top (1) **2** Left Side Panel (1) **3** Right Side Panel (1) **4** Back Panel (1) **5** Support Leg (1) **6** Bottom (1) **7** Fixed Shelf (1) **8** Door Panel (1)

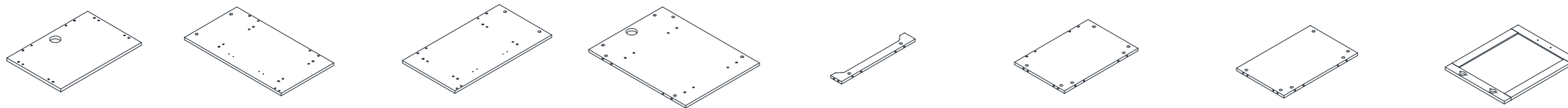

Desk:

- 9** Top (1) **10** Back Panel-A (1) **11** Back Panel-B (1) **12** Leg Panel-A (1) **13** Leg Panel-B (1) **14** Leg Panel-C (1) **15** Leg Panel-D (1) **16** Leg Panel-E (1) **17** Leg Panel-F (1)

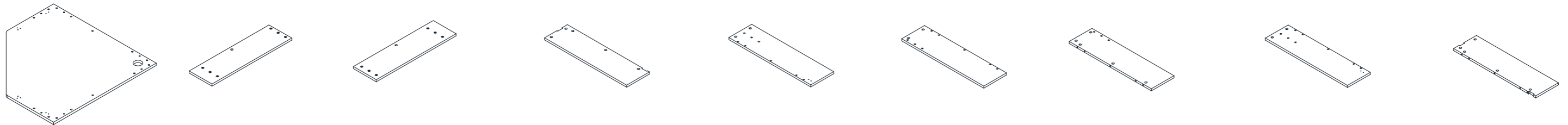

Hardware/Tools

- A** Cam Bolt (47) **B** Cam Lock (47) **C** Wood Dowel (40) **D** L-Bracket (3) **E** Screw M4*14 (15) **F** Door Hinge (2) **G** Screw M4*16 (12)
- H** Handle (1) **I** Screw M4*22 (2) **J** Screw M6*25 (12) **K** Grommet (3) **L** Adhesive Cover (59)



! Tools Required
for Assembly

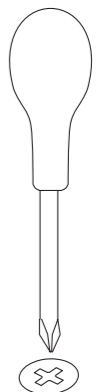

Phillips Screwdriver

1

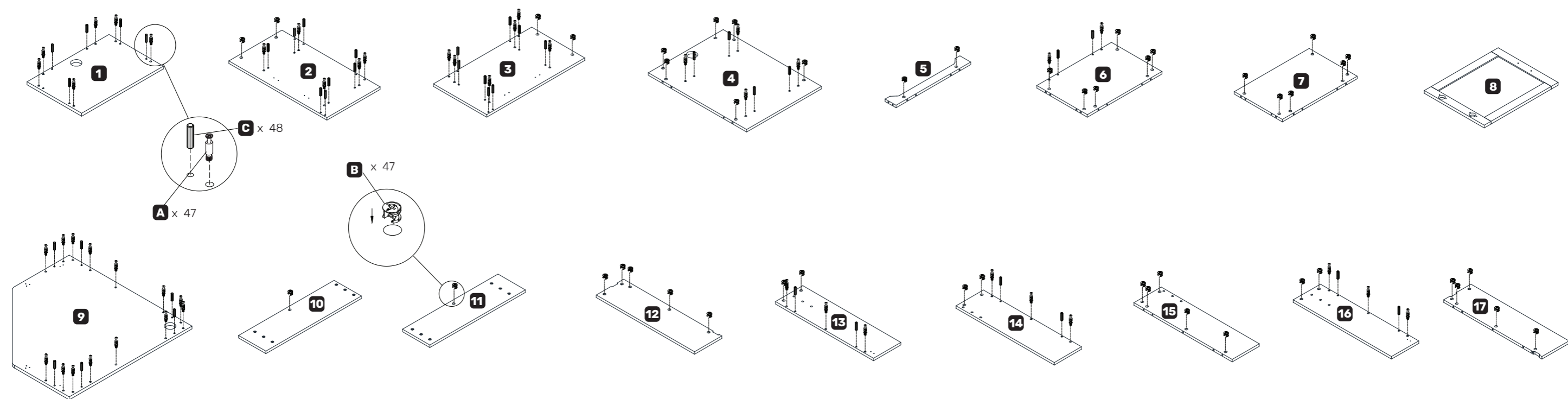

2

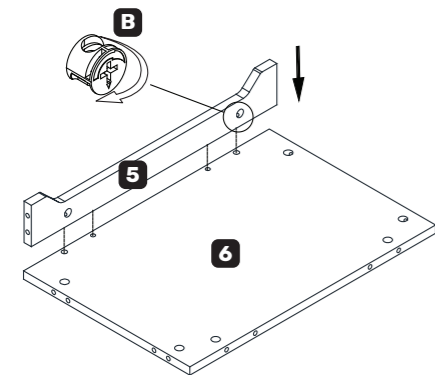

3

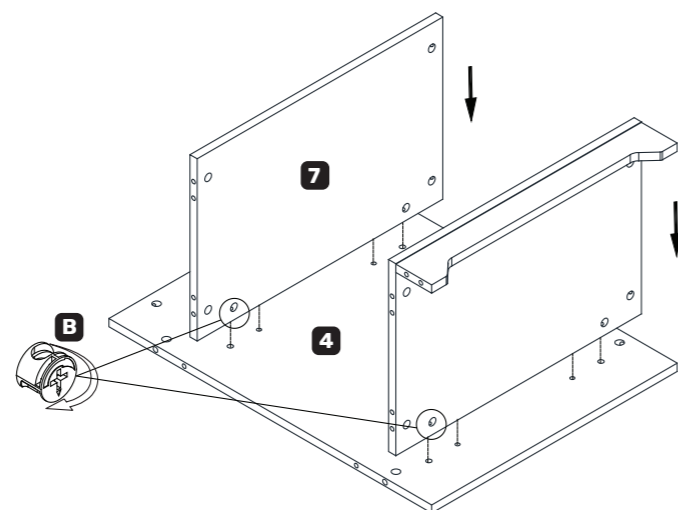

4

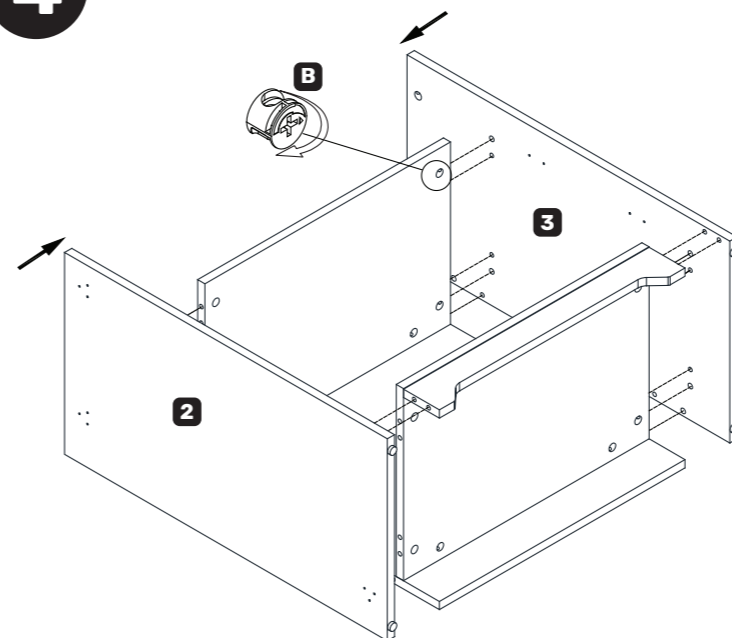

5

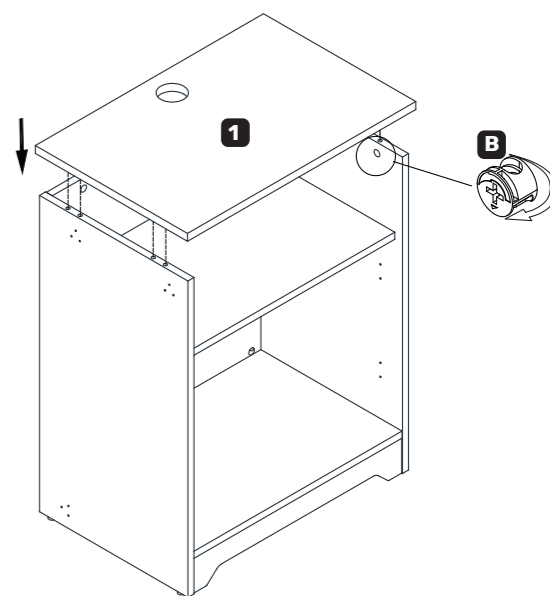

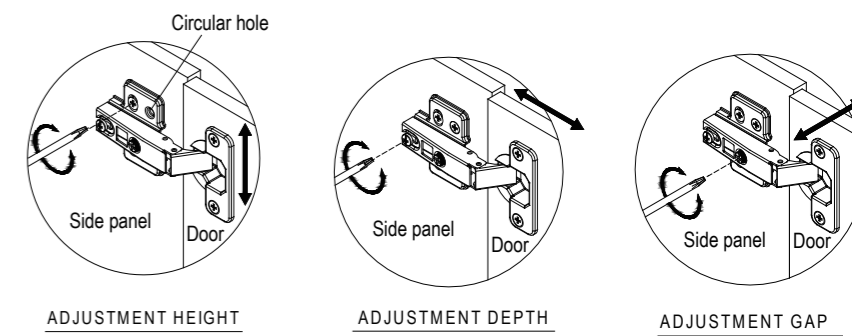
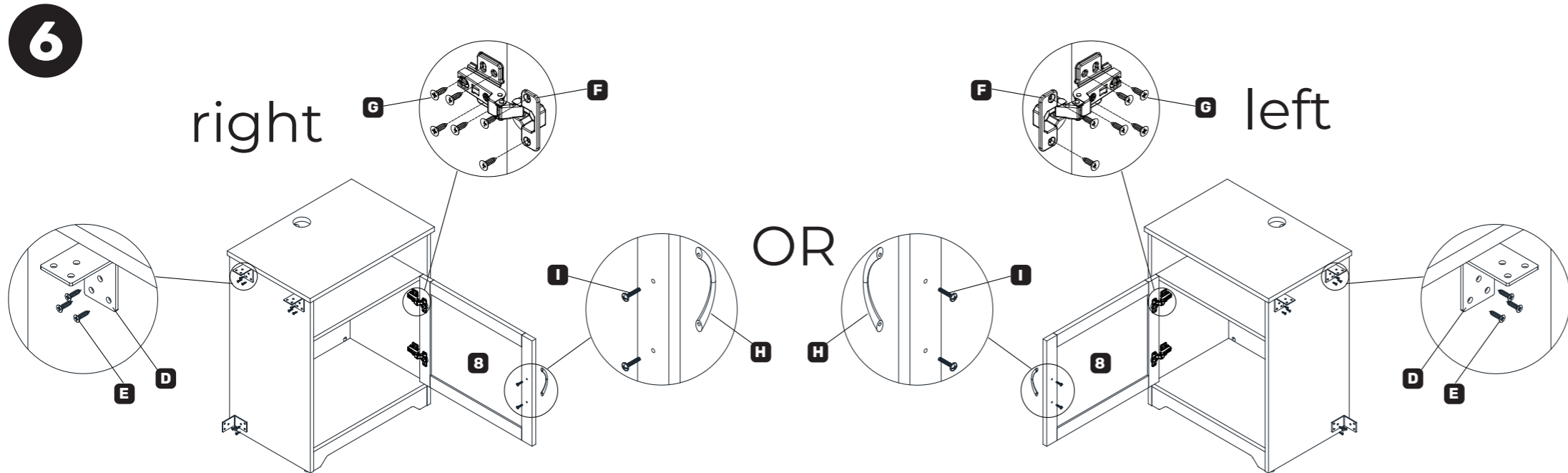

Once height adjustment is complete, insert screw **G** into the circular hole to attach the hinge.

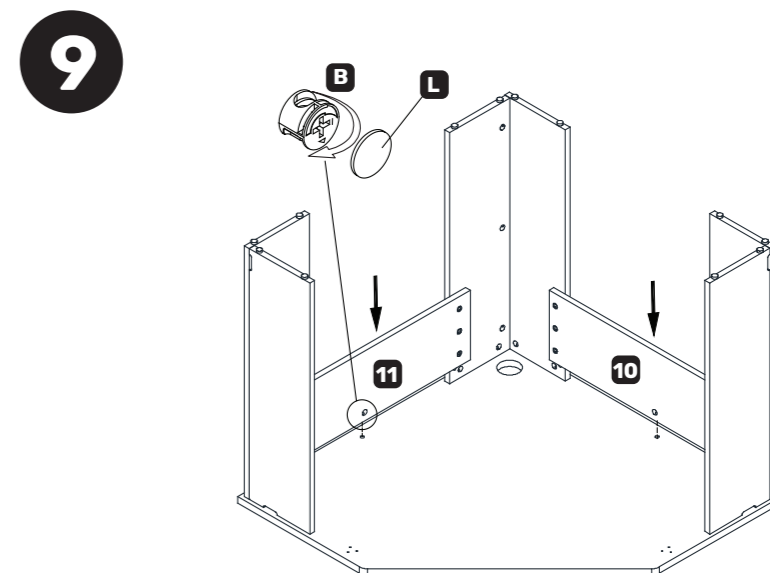
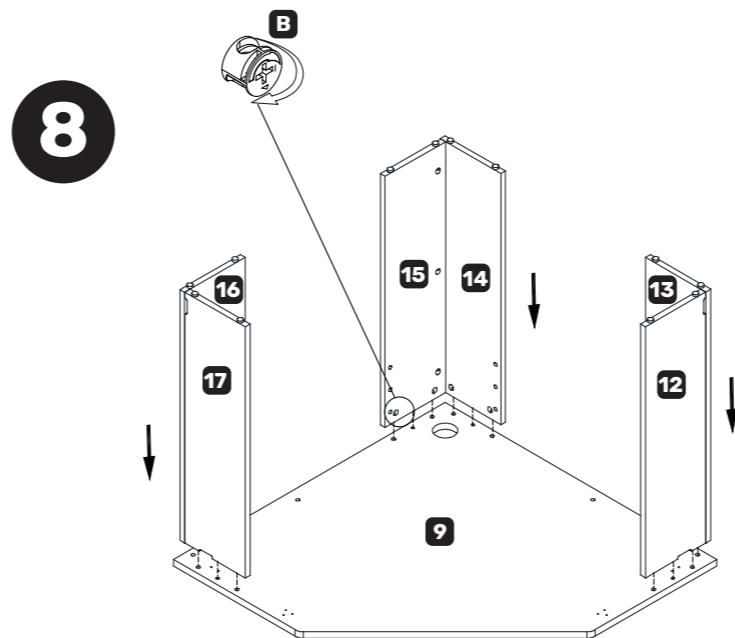
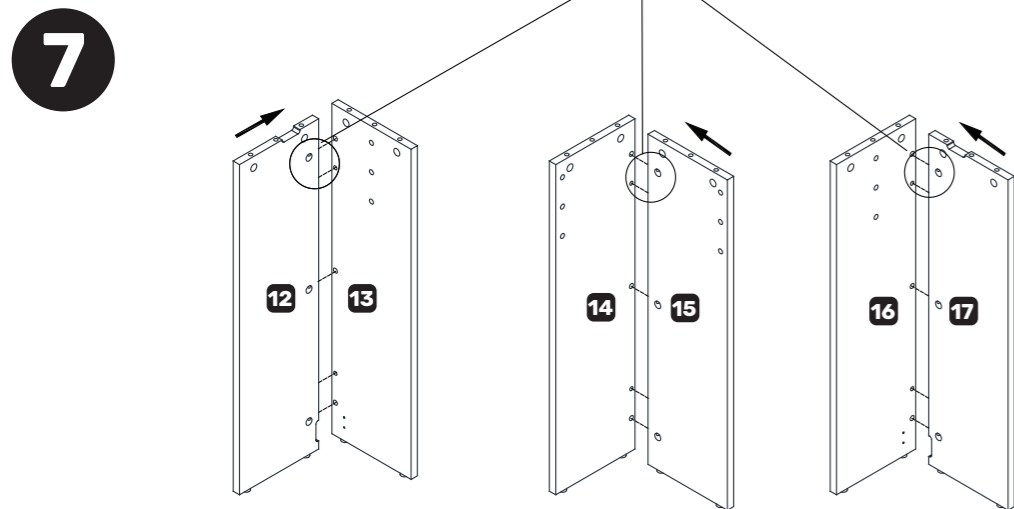

10

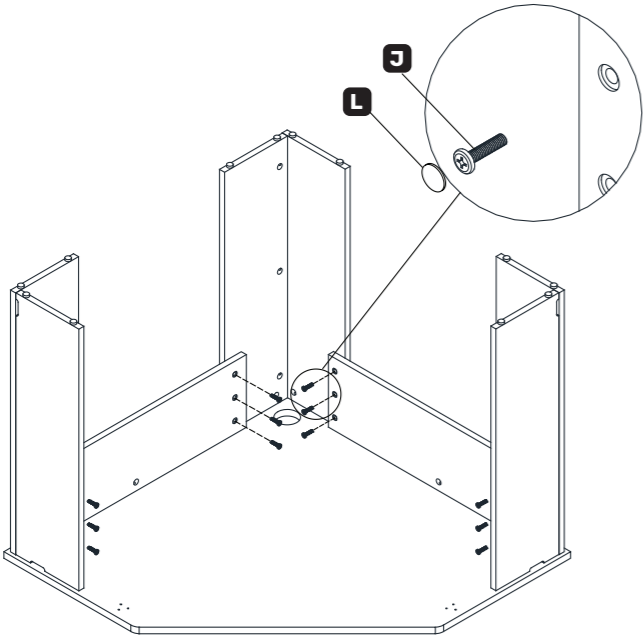

11

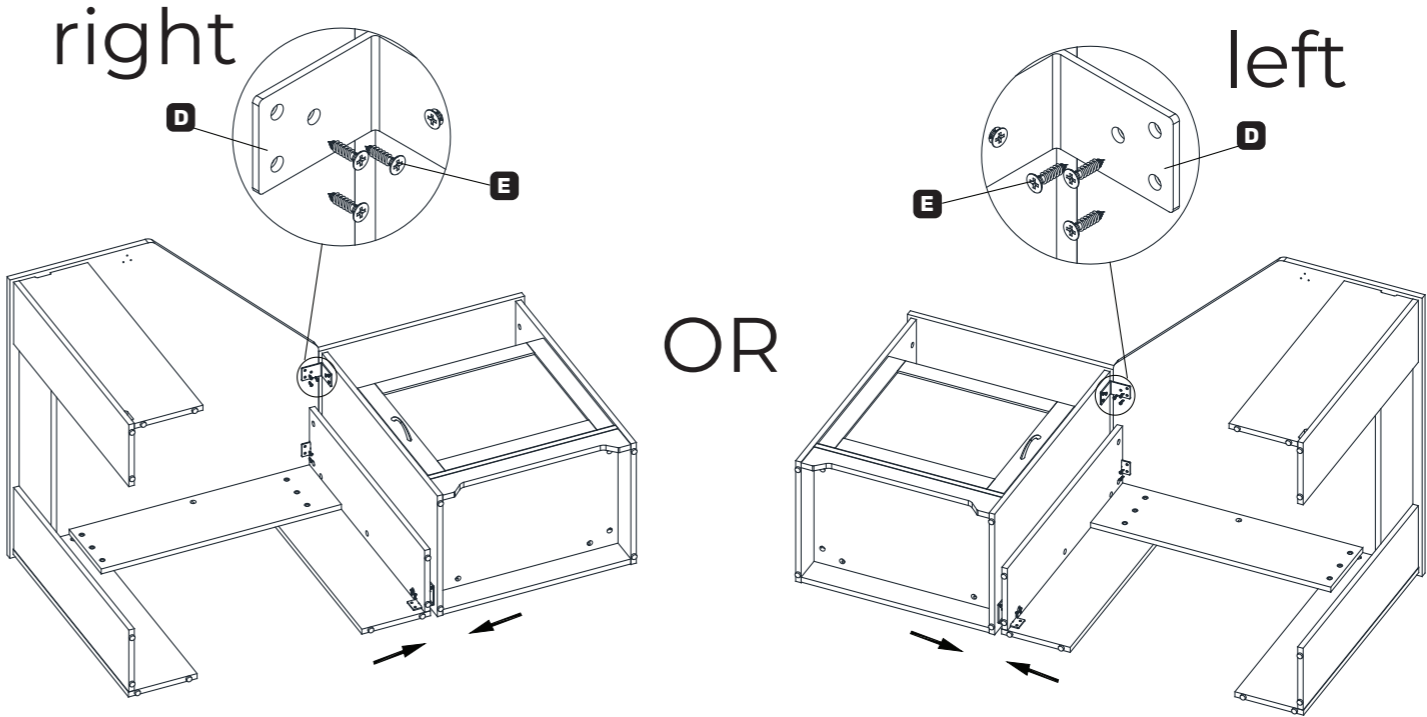

12

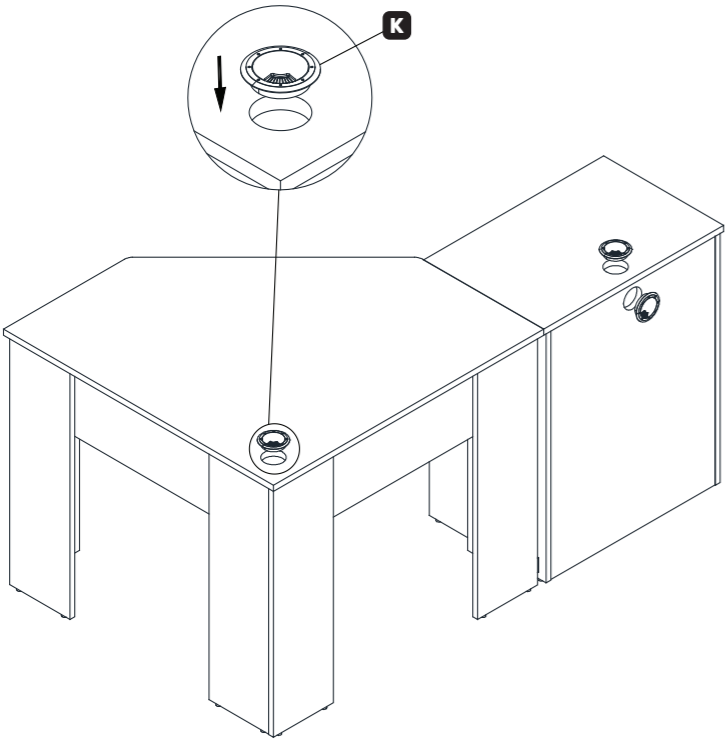

13

