

FRASER HILL FARM[®]

Thank you for your Purchase!

With proper use and care, this product will provide you with years of enjoyment. If you have any questions please contact us directly.

✉ Holiday@FraserHillFarm.com | Anytime

☎ 1 (855) 591-7451 | 9am-9pm EST (Mon-Fri) 9am-5pm EST (Sat-Sun)

Please follow the instructions on how to assemble your item.

If you should have any problems with your product, DO NOT return it to the place of purchase.

Please do not return this item to the retailer.

Please call our toll free number 1 (855) 591-7451 or email us at Holiday@FraserHillFarm.com and a customer service representative will assist you.

Enjoy your Holiday!

FFRS063-SOL5-RD- 63.5 H LED Lit MG02 Drummer Boy w/ Moving Hands, Music and Timer

CAUTION: IMPORTANT SAFETY INSTRUCTIONS READ AND FOLLOW ALL SAFETY INSTRUCTIONS

FOR INDOOR OR OUTDOOR USE

- The product and its adapter are intended for indoor and outdoor use. When product is used in outdoor applications, connect the adapter belongs to the product to a Ground Fault Circuit Interrupter (GFCI) outlet available at your hardware store. If you desire a more permanent solution, please contact a qualified electrician for proper installation. This seasonal use product is not intended for permanent year round installation or use.
- Do not mount or place near gas or electric heaters, fireplaces, candles or other similar sources of heat.
- Do not secure the wiring of the product with staples or nails, or place on sharp hooks or nails.
- Unplug the product when leaving the house, when retiring for the night, or if left unattended.
- **CAUTION:** This is an electrical product – not a toy! To avoid risk of fire, burns, personal injury and electric shock, it should not
- be played with or placed where small children can reach it.
- Keep this product well ventilated. Do not cover product with cloth, paper or any material not part of the product when in use.
- Do not use with a voltage converter. Use only with adapter plug provided.
- Do not use this product for other than its intended use.
- Do not hang ornaments or other objects from cord, wire or light string.
- Do not close doors or windows on the products or extension cords as this may damage the wire insulation.
- Never operate this product if the power cord or plug is damaged.
- In case the external flexible cable or cord of the adapter is damaged: **DO NOT USE THAT DAMAGED ADAPTOR, DO NOT OPEN TO REWIRE! THROW ADAPTOR AWAY.**
- Use of product in extreme weather conditions if not recommended.

BEFORE YOU START

* Check the carton and make sure you have all parts as listed below:

- Resin Product - Adapter and Cord - Detachable Drum - Two Hands w/Drum Stick

IMPORTANT - Do not dispose of the foam mold and carton before you complete the assembly. Detachable parts and adapter may be sitting there. Keep the package material for storage purpose.

USE AND CARE INSTRUCTIONS

- Before using or reusing, inspect product carefully. Discard any product that have cut, damaged or frayed wire insulation or cords, or exposed copper wire.
- When not in use, store neatly in a cool, dry location protected from sunlight.

Note: *This animated nutcracker is hand painted and has synchronized motion, LED lights and Musical and the product is constructed with non-replaceable light bulbs.*

ASSEMBLY INSTRUCTIONS

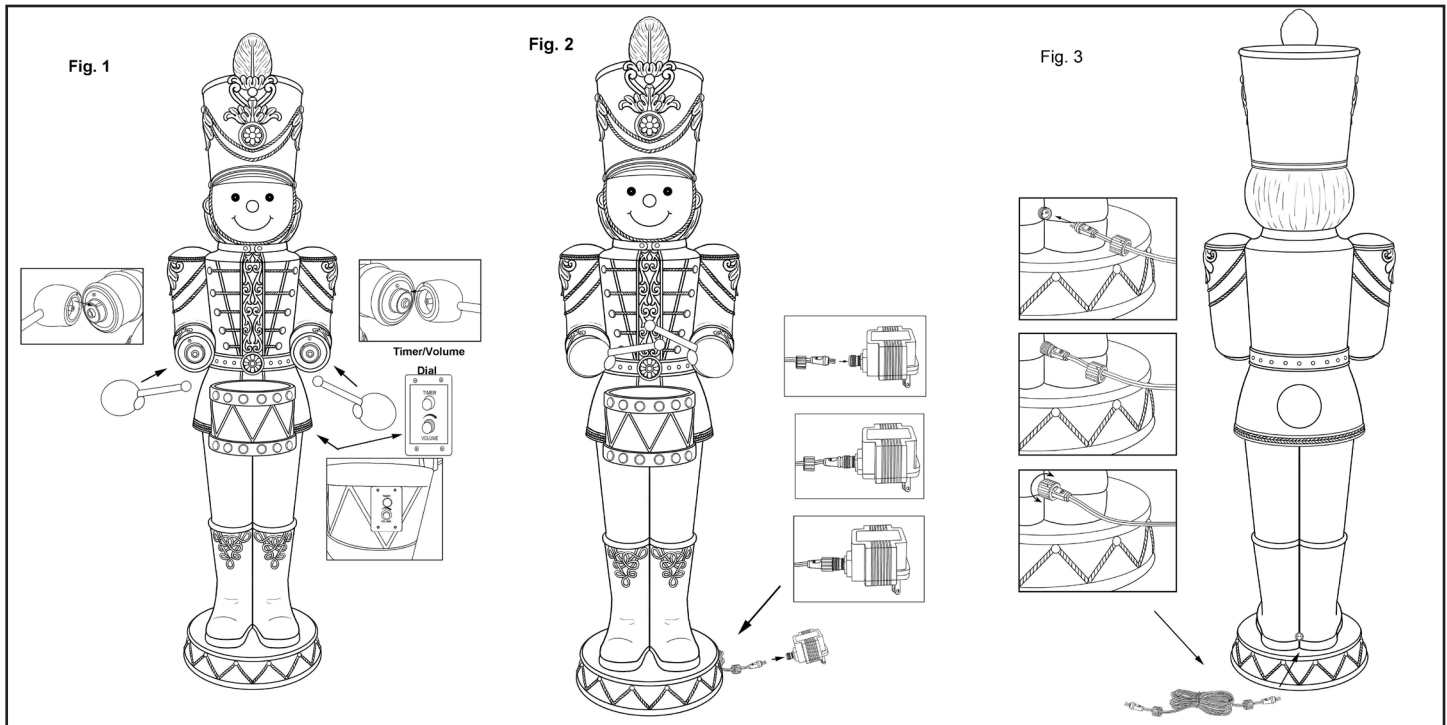

DRUM ASSEMBLY:

STEP 1: Gently lift the unit from the packaging. DO NOT LIFT BY NUTCRACKER ARMS. With **TWO** people, place the nutcracker on a flat surface.

STEP 2: Gently lift the drum unit from packaging. Mount the metal hook on drum unit to the other hook on the waist of Nutcracker. Attach the plug of cord on drum unit to connector on Nutcracker and twist the cap to secure tightly in right position. **See Fig. 1.**

HAND ASSEMBLY:

STEP 1: Lift the drum sticks from packaging and twist on the Nutcracker's hands to secure.

STEP 2: Locate red line on the inside of hands with drumstick. Locate red line on the arm. Place hands on arms by lining up red lines. Hand inner posts will fit into opening on arms. Make sure left hand is placed on left side – right is placed on right side. **See Fig. 1 and below Illustration.**

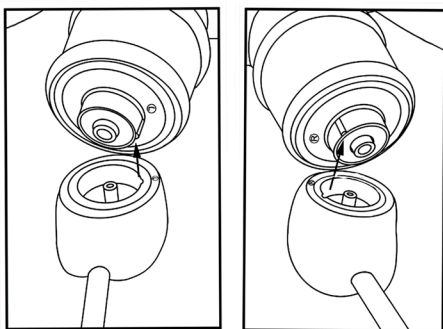

ASSEMBLY INSTRUCTIONS

NUTCRACKER OPERATION:

1. Assembly of cord is required prior to plugging in to a nearby working outlet. Connect the 2 prong ends to adapter. Twist the cap and secure cord to adapter tightly. Now nutcracker is ready to plug in and operate. **(See Below)**

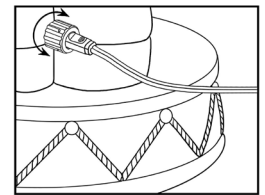
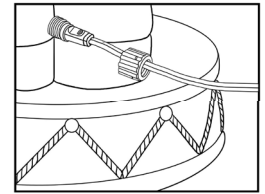
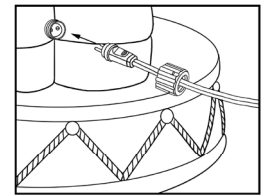
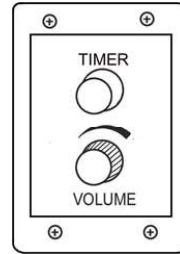
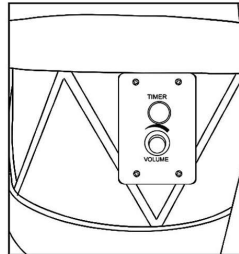
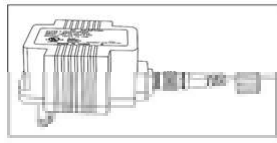
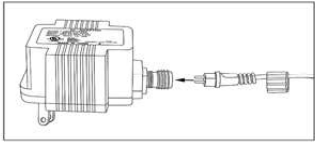

2. Volume & Timer Switch is located on the side of the body. **(See Right Sketch)**

TIMER: A timer is built into the movement mechanism. Turning the "VOLUME" switch to ON position will turn on the lights, activate drumming movement and begin music playing. Lights, hand movement and music including eight holiday songs will work in a loop of 6 hours after pressing "TIMER" button until power is turned off. Please press "TIMER" button again to replay after 6 hours when the "VOLUME" switch still in alert status.

TROUBLESHOOTING

If the product LED lights/movement/musical does not work:

1. Make sure the transformer is connected to a power supply.
 2. Make sure the product is properly connected to the transformer.
- Do not force positions of hands – components must be aligned properly.
 - Do not block movement of hands.

CAUTION:

This is not a toy. Disconnect the plug when the unit is not under the supervision of an adult.

SPECIFICATION OF ADAPTOR:

Adaptor used: Input Voltage: 120V AC 60Hz 0.25A | Output Voltage: 12V AC 1.67A
Efficiency Level: IV 115V

IMPORTANT SAFETY INSTRUCTIONS

When using electrical products, be sure to always follow these basic precautions:

1. Read and follow all instructions and safety instructions before opening product.
2. Do not use an extension cord.
3. Refer to the National Electrical Code, ANS/NFPA 70, for the installation of wiring and clearances from power and lighting conductors.
4. Do not install or use within 10 feet of water source (pool, bathtub, sink, etc.)
5. Warning: Risk of Electric Shock, Mount higher than one foot from the ground surface.

SAVE THESE INSTRUCTIONS- These are important safety and operating instructions for power units.