

CONVENIENCE CONCEPTS

TV/MONITOR RISER



121041CH



121041



121041LO



121041W

ASSEMBLY INSTRUCTIONS

We have designed our furniture with you , the customer in mind . Our clear , easy to follow , step by step instructions will guide you through the project from start to finish . Feel confident that this will be a fun and rewarding project . The final product will be a quality piece of furniture that will go together smoothly and give years of enjoyment .



Please do not return to the store

Broken or missing parts?

Need help with assembly?

If you have any questions just call 1-800-468-6447 or email us at parts@convenience-concepts.com

Hardware List

Part List

A

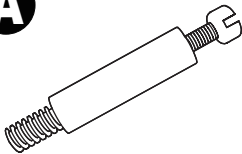

Cam bolt (6pcs)

B

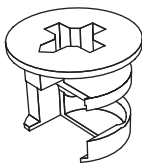

Cam lock (6pcs)

C

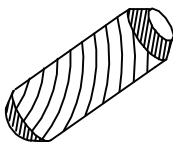

Wood dowel (6pcs)

D

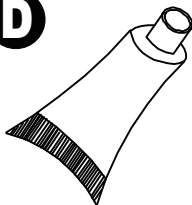

Glue (1pc)

E



Plastic foot (4pcs)

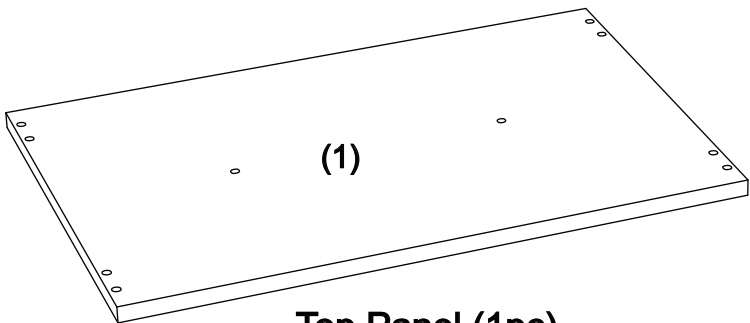

Top Panel (1pc)

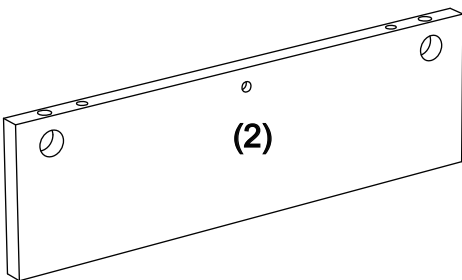

Side Panel (2pcs)

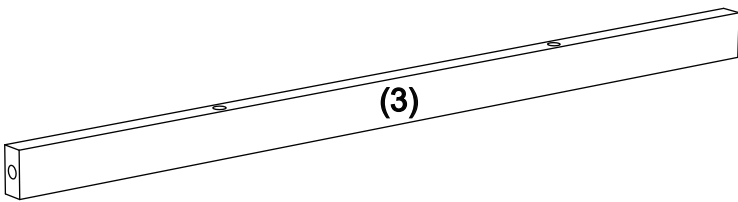

Support Panel (1pc)

Assembling the unit with camlocks and wood dowels.

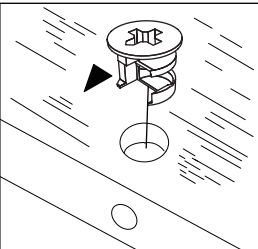

Insert camlock, camlock must face bolt hole

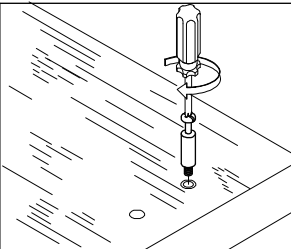

Gently screw cam dowel into the threaded anchor

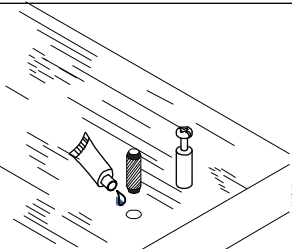

Lightly glue one end of wood dowel and tap into hole.

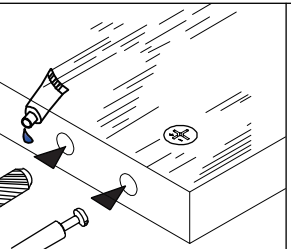

Lightly glue dowel and connect to second panel by inserting dowels into holes

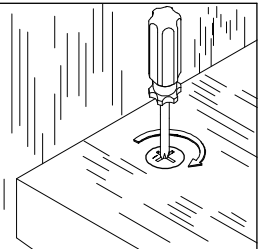

Gently screw the cam clockwise into locked position. Do not overtighten.

Step1

1.Insert Camlock **B** into Side Panels **2** and Support Panel **3**.

2.Screw Cambolts **A** into Side Panels **2**.

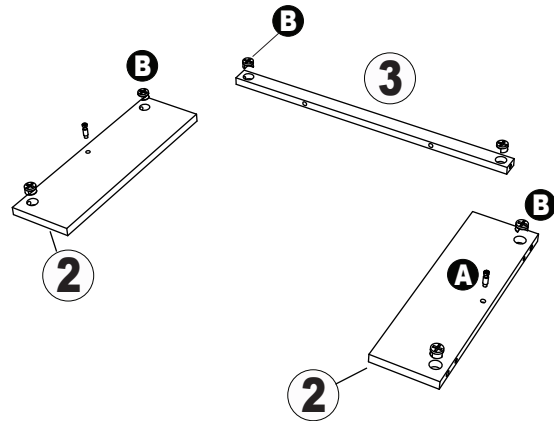

Step2

1.Connect two side panels **2** to support panel **3**.
2.Gently tighten camlocks.

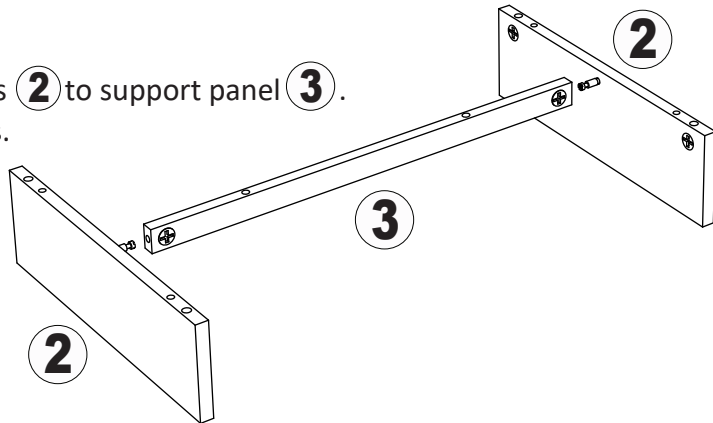

Step3

1.Screw Cambolt **A** and insert wooden dowels into Top Panel **1**.
2.Attach top panel **1** to unit and gently tighten camlocks.

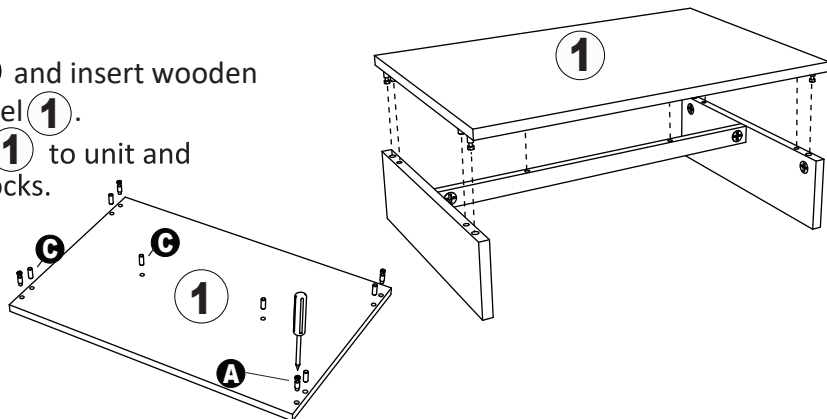

Step4

1.Attach plastic Feet **E** to unit as shown.
2.Turn unit over and enjoy.

