

CH-414

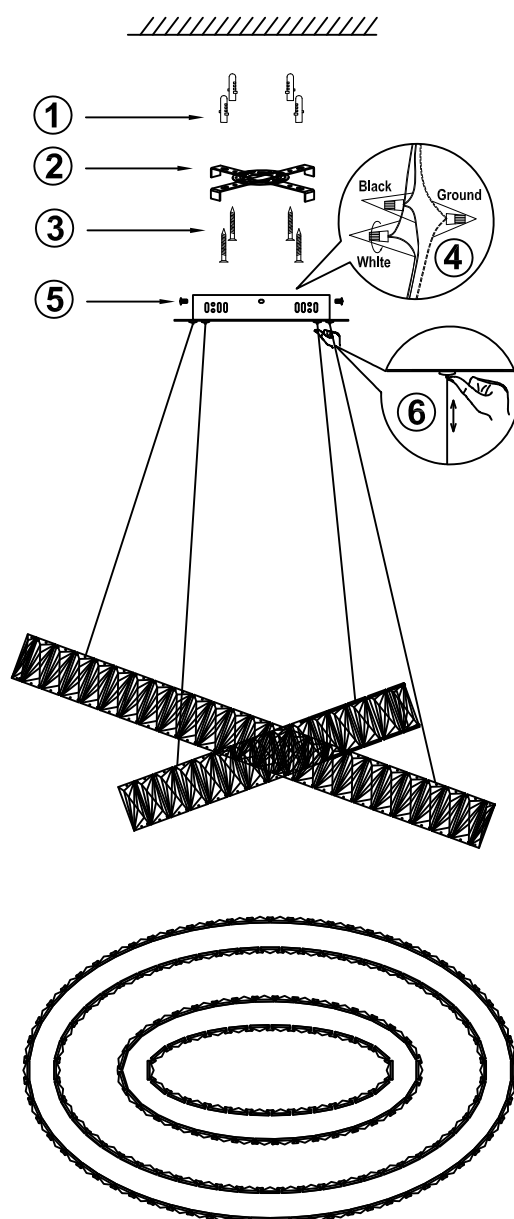

WARNING - ONLY USE A QUALIFIED ELECTRICIAN TO INSTALL THIS LIGHT FITTING

Mounting:

- * For mounting into plaster - use the Rawl plugs (1) provided
- * Screw the cross bar (2) into the ceiling using the screws (3) as shown
- * Connect the junction box (4) to the cross bar
- * Fix the junction box lid into place (5)
- * Manually adjust the wires to the desired length (6)

Maintenance:

- * The light fitting is made from crystal
- * Use a soft cloth to remove dust

