

Thank you for choosing eLEDing!

It is important that you read this set-up instruction before installing
Any questions or issues, please contact us before returning
Our goal is 100% customer satisfaction
Please post your positive feedback on the web-stores
We appreciate your business! Thanks again!

Please watch the installation video before your setup: <https://youtu.be/3Z490H8-j4o>

Initial activation:

- It's highly recommended to charge the light under direct sunlight for 1 day prior to installation. The battery charges even when the light is off.
- Near the white motion sensor lens there is a small button with the words "ON/OFF" beside it. Momentary press the button to activate the lighting system.
- **Just momentary press the button , the light will turn "ON"(Refer Fig 1).**
- If turning "ON" in daylight completely cover the solar panel to block any light.
- Once activated the light will shut off automatically within a few seconds. And then will turn on only in darkness.
- For daytime setup and activation the solar panel surface must be totally covered.



Fig 1

Momentary press to activate



Fig 2

Mounting:

Choose a flat and stable mounting surface with maximum exposure to direct sunlight. It is essential that the solar panel receives at least 4 hours of direct sunlight every day on average in order to ensure dusk to dawn performance.

For Northern hemisphere installations the light should be mounted with a southerly exposure and visa-versa for Southern hemisphere installation. East and West mounting locations with good sun exposure can also be good.

1. Connect the mounting arm to the light body with the provided long screw and bolt (Refer Fig 2)..
2. For wood surfaces mark the screw positions on the mounting surface using the mounting bracket (Refer Fig 3). Then drill the screws into the pre-marked positions to mount the base firmly.
3. Slide the light from side into the mounting base (Refer Fig 4). The light should be mounted horizontally with up to 5 degree upward tilt to project light toward the desired area.



Fig 3

NOTE: For surfaces other than wood such as concrete, brick or stucco, use a masonry bit (with appropriate size & length) to drill clearance holes. Insert the plastic anchors and screws. Secure the mounting bracket and then mount the unit on the mounting base.

Also, a heavy duty tie wrap is included in the box for 'pole mounting' this light.

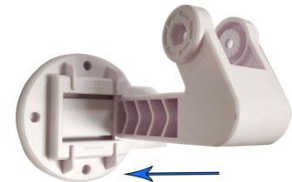

Fig 4

Dusk to Dawn Function:

This solar light senses its surrounding ambient light level and it will turn "ON" in darkness and provide moonlight soft glow lighting all night long. When motion is detected it brightens up to its full brightness within the default sensitivity range (up to 30' when it is mounted 7' above the ground). When motion is no longer sensed the unit will automatically dim down to moonlight soft glow lighting level.

Note:

- Never have shadows or anything covers the solar panel during the day (Refer Fig 5).
- Avoid placing objects in front of the motion detector that may affect detecting performance.
- Avoid installing the unit near air conditioners, central heaters, or high voltage systems.
- Avoid placing the motion detector head towards high movement areas
- Clean the solar panel with a moist soft cloth at least once a year.
- Clean accumulated snow as soon as possible during the snowing season.
- Do not expose the light to fire/intense heat or immerse in water.
- Never look directly into the light or shine it into another person's eyes.
- If the light doesn't activate when it is first turned on, then allow 1-2 days for the panel to re-charge the battery.



Fig 5

Unlimited Applications

