

# ASSEMBLY INSTRUCTIONS

## QUEEN STORAGE BED

### (Box 1)

BOX OF HEADBOARD & FOOTBOARD

No	ITEM	Qty
A	Headboard	1 pc
B	Footboard	1 pc
C	Headboard Leg (L/R)	2 pcs

### (Box 1)

HARDWARE LIST (HEADBOARD)

No	ITEM	Qty
1	JCBC M6 x 30mm	6 pcs
2	SPRING WASHER 1/4" Rbw	6 pcs
3	Flat Washer 1/4"ID x 13mmOD Blk	6 pcs
4	ALLEN KEY m4x65mm Blk	1 pc

### (Box 2)

HARDWARE LIST (SIDE RAIL)

No	ITEM	Qty
5	CSK M4 x 32mm	14 pcs
6	Pan Head Screw M3.5 x 20 blk	25 pcs
7	JCBC M6 x 35mm	2 pcs
8	JCBC M6 x 50mm	6 pcs
9	SPRING WASHER 1/4" Rbw	2 pcs
10	Flat Washer 1/4"ID x 13mmOD Blk	2 pcs
11	ALLEN KEY m4x65mm Blk	1 pc
12	ALLEN KEY m5x65mm Blk	1 pc

### (Box 3)

BOX OF DRAWER

No	ITEM	Qty
L	Drawer	2 pcs

**STEP 1 :** Attach Head Board Leg ( C ) to Head Board ( A ) as shown using JCBC BOLT ( 1 ) with Spring Washer (2),Flat washer (3) and securing with ALLEN KEY ( 4 ).

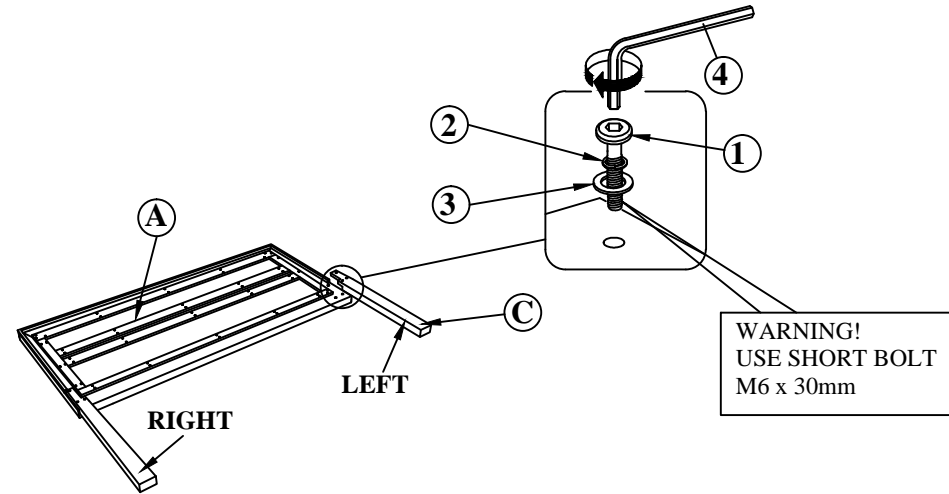

**STEP 2 :** Loosen the JCBB Bolt from Headboard (A) and Footboard (B) using ALLEN KEY (12). Attach the Side Rail (D) to Headboard (A) and Footboard (B) by pushing the bracket down to fit it. Tighten the JCBB Bolt by ALLEN KEY (12).

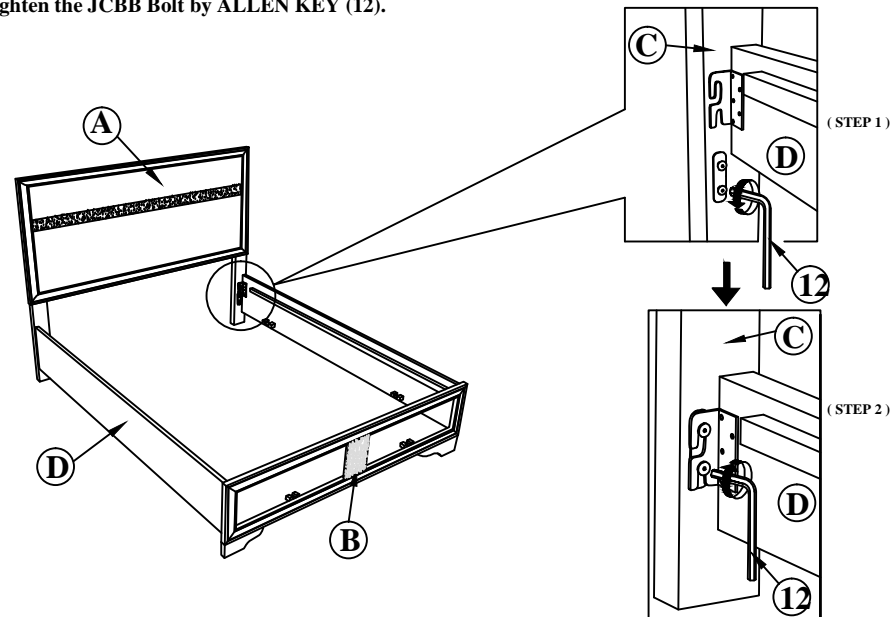

# ASSEMBLY INSTRUCTIONS

**STEP 3 :** Attach the Center Slat Drawer ( E ) to Side Rail ( D ) as shown using CSK Screw ( 5 ) and tighten with Screw Driver.(Not Included)

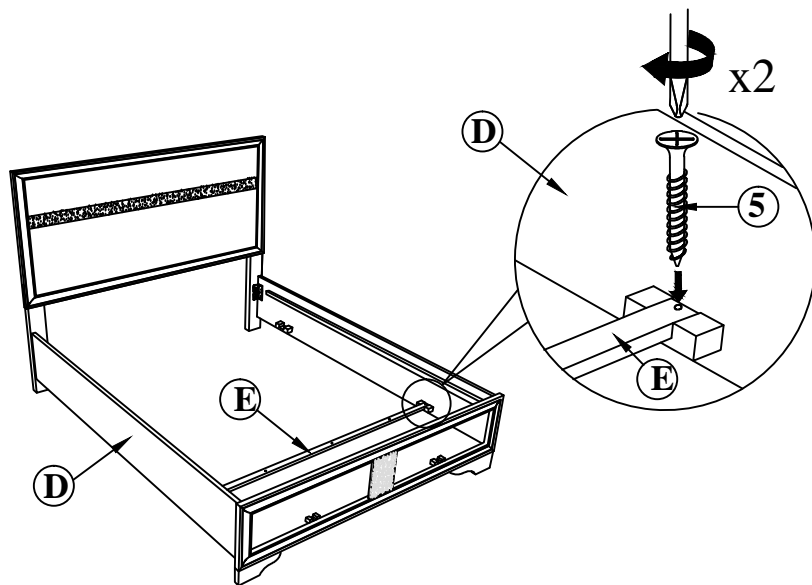

**STEP 4 :** Attach the Support Slat Drawer ( H ) to Center Slat Drawer ( E ) as shown using JCBC Bolt ( 8 ) and tighten with ALLEN KEY ( 11 ).

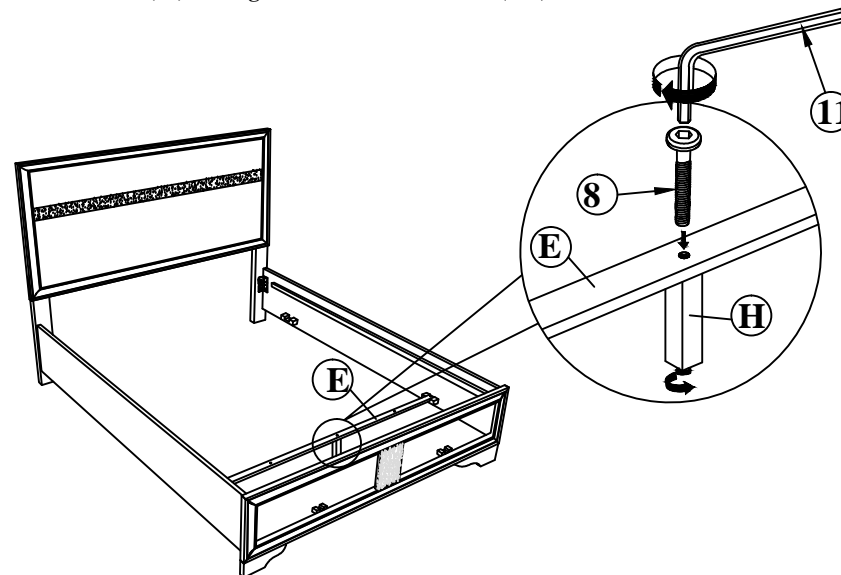

**STEP 5.1 :** Attach the Drawer Support Rail ( J ) as shown using CSK Screw ( 5 ) and tighten with Screw Driver.(Not Included)

**STEP 5.2 :** Using JCBC Bolt ( 7 ) with Spring Washer ( 9 ),Flat Washer ( 10 ) and securing with ALLEN KEY ( 11 ).

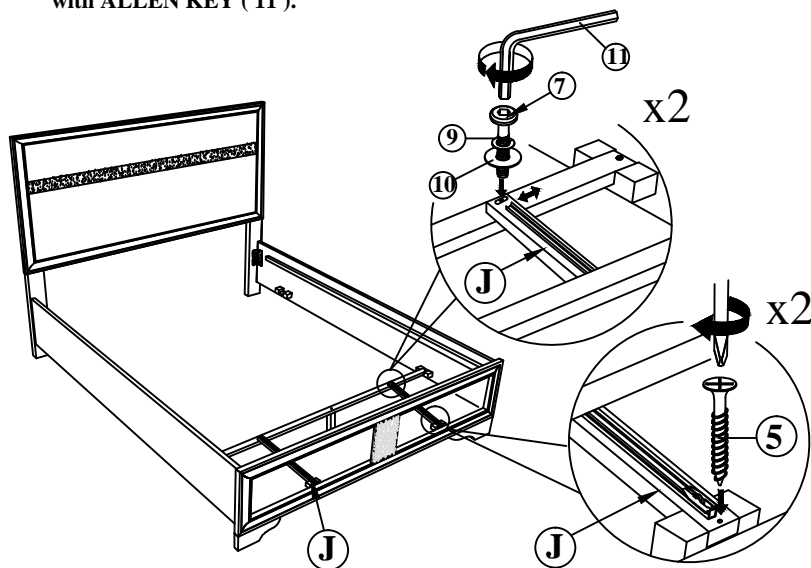

**STEP 6.1 :** Insert the Drawer ( L ) at the Drawer Support Rail ( J ).

**STEP 6.2 :** Remove HANDLE and using a Philips head screw driver as shown

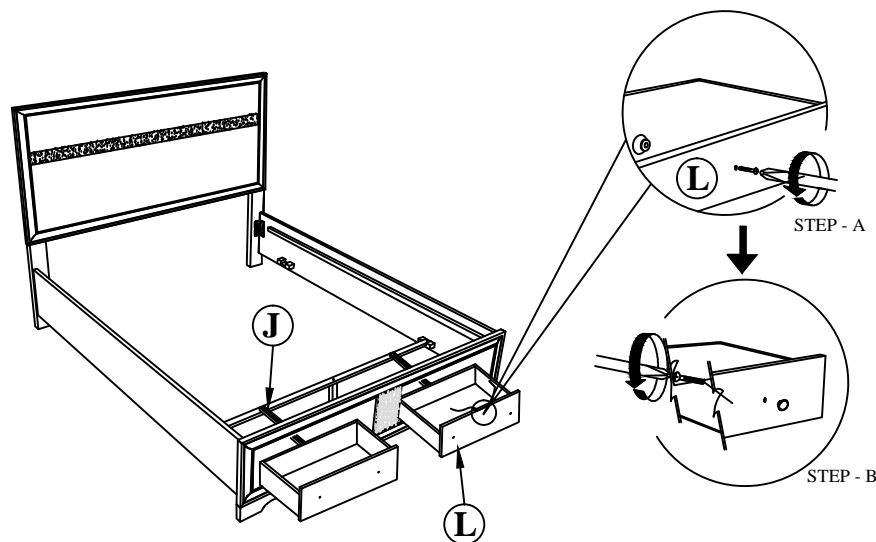

# ASSEMBLY INSTRUCTIONS

**STEP 7 : Fix the Bed Slat Support ( G ) to the Bed Slat ( F ) as shown.**

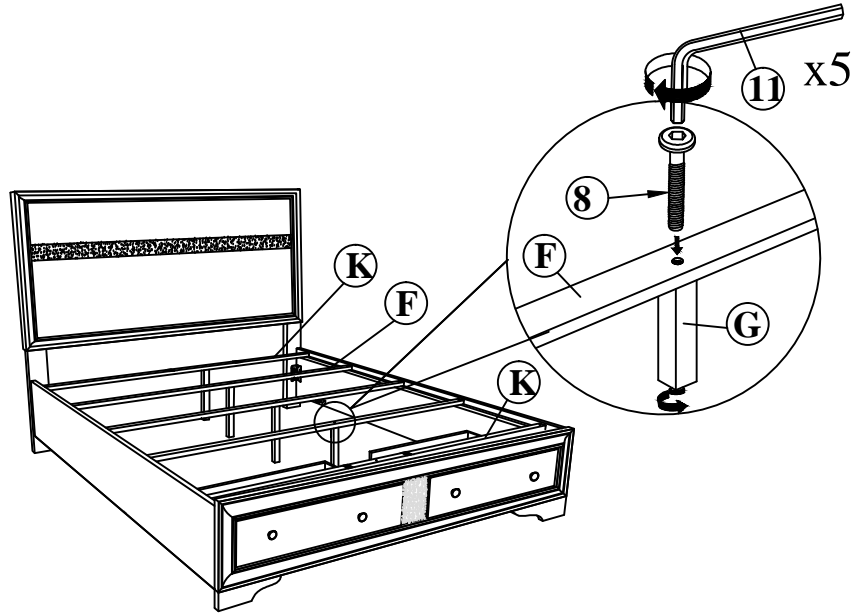

**STEP 8 : Fix the Bed Slat ( F ) by push closely to the Side Rail ( D ) by using SCK Screw ( 5 ) as shown.**

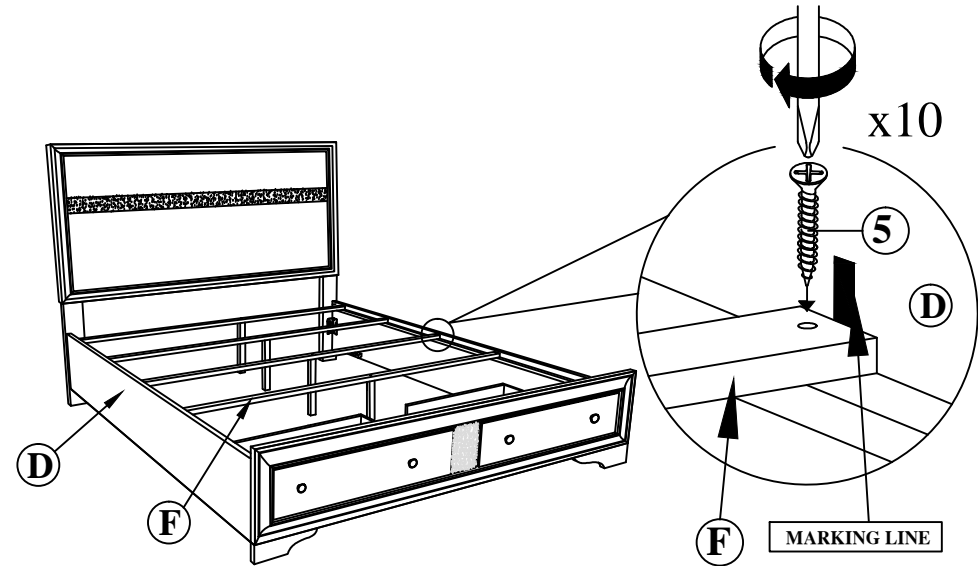

**STEP 9: Attach Concealed Panel ( I ) at the upper Bed Slat ( F ) using Panhead Screw ( 6 ) and tighten with Screw Driver.(not Included)**

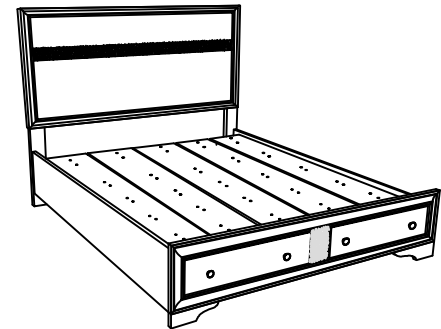
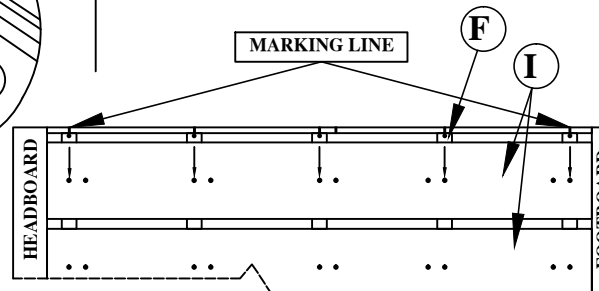
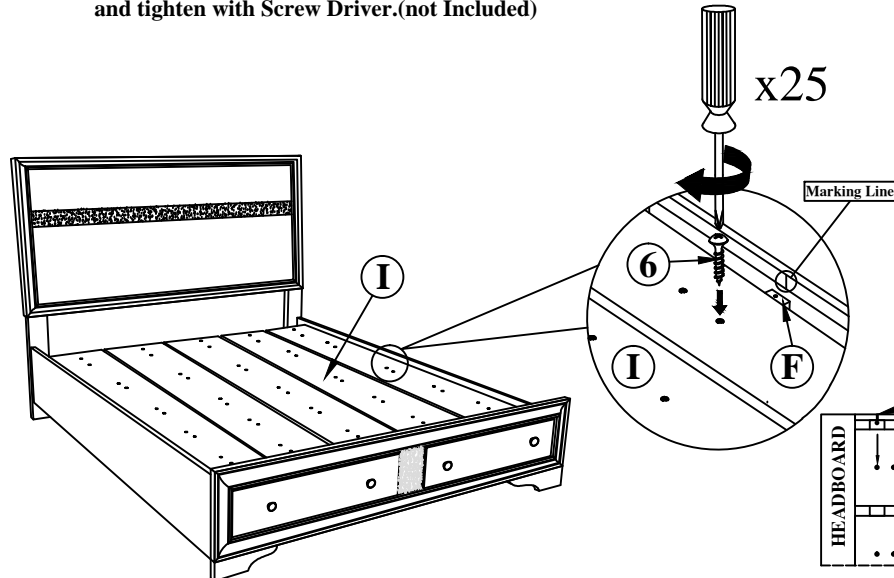

**COMPLETED ASSEMBLY**

TIGHTEN THE PANHEAD SCREW (6)  
BY FOLLOW THE ARROW AS SHOWN

# ASSEMBLY INSTRUCTION

## DRESSER & MIRROR

### (Box 1)

#### BOX OF MIRROR

NO	ITEM	Qty
A	MIRROR	1 PC
B	MIRROR SUPPORT RAIL	2 PCS

### (Box. 2)

#### BOX OF DRESSER

NO	ITEM	Qty
C	DRESSER	1 PC

### (Box. 1)

#### HARDWARE LIST

NO	ITEM	Qty
1	JCBC BOLT M6 x 35MM BLK	4 PCS
2	JCBC BOLT M6 x 40MM BLK	4 PCS
3	SPRING WASHER 1/4" RBW	8 PCS
4	FLAT WASHER 1/4" ID x 19mm OD BLK	8 PCS
5	ALLEN KEY m4 x 65mm BLK	1 PC

### STEP 1

Draw out mirror support (B) from the carton box.

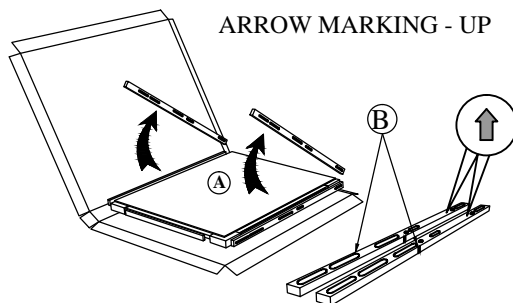

**STEP 2 :** Align & fasten mirror support (B) to the back of mirror (A) using short JCBC bolt(1), spring washer (3) & flat washer (4). DO NOT FULLY TIGHTEN AT THIS STEP.

Note : Make sure arrow marking of the mirror support (B) is aligned up.

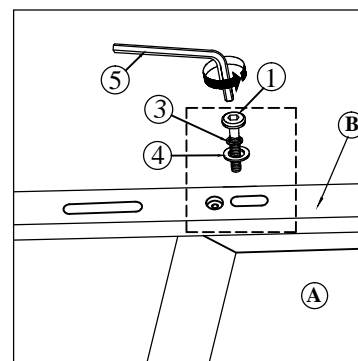

\*\*BACK VIEW

ARROW MARKING - UP

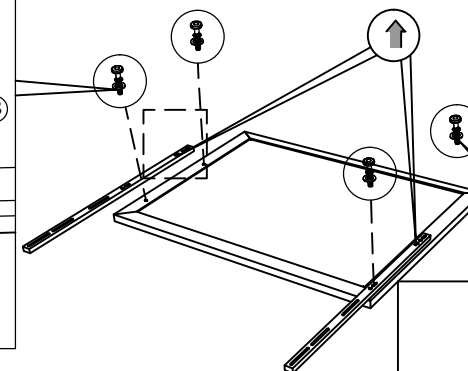

**WARNING !**  
Use Short Bolt  
M6 x 35mm

**STEP 3 :** Place mirror (A) on top of dresser (C). Align & fasten mirror support (B) to the back of dresser (C) using long JCBC bolt (2) , spring washer (3) & flat washer (4) THEN FULLY TIGHTEN ALL THE BOLTS AT STEP 2 & 3 WITH ALLEN KEY ( 5 ).

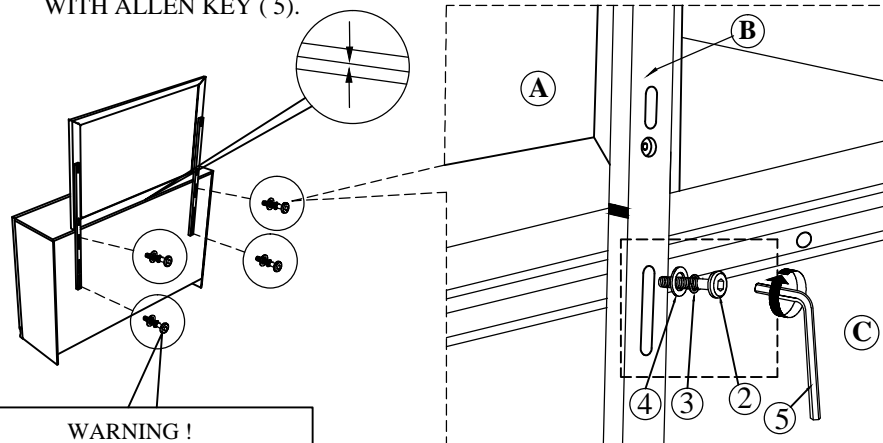

**WARNING !**  
Use Long Bolt  
M6 x 40mm

Note : Make sure arrow marking of the mirror support is aligned with the arrow marking of the center of the dresser as show in drawing.

\*\*HARDWARE SET IS IN 1857-6 FOR ASSEMBLY



COMPLETED ASSEMBLY

NOTE : MUST TIGHTEN SCREWS PERIODCALLY WITH USE SCREW WILL BECOME LOOSE CHECK TIGHTNESS OF ALL SCREW EVERY 6-8 WEEKS.