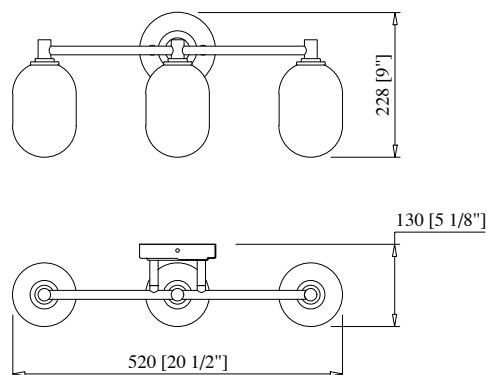
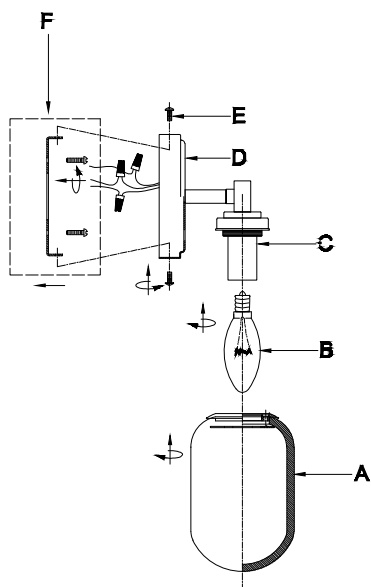

DIAGRAM OF INSTALLATION STRUCTURE

SKU No. :CE1009387

Product Size: L20 1/4"*W9"*D5 1/8"

Light Source: 3 × B10 E12 Bulb



- A: Glass shades
- B: B10 E12 bulbs(Not Included)
- C: Fixture
- D: Backplate
- E: Mounting screws
- F: Mounting hardware

Installation instruction

1. Turn off the power.
2. Fasten mounting hardware(F) to junction box with machine screws.
3. Raise the fixture(C) over to the wall and do the wire connection.
4. Tighten mounting screws (E) to secure fixture(C) to wall.
5. Screw recommended bulbs(B) (E12 B10 bulb type, not included) into socket.
6. Install the glass shades(A) onto the socket.
7. After finish the installation, turn on the power.