

Features

- Includes valve trim with handle, bath spout, showerarm and flange, and showerhead.
- Single handle controls both on/off activation and temperature setting.
- Integrated push button diverter.
- Coordinates with Loure faucets and accessories to complete your bathroom.
- Pressure-balancing diaphragm technology maintains outlet temperature within +/-3 degrees Fahrenheit during water pressure fluctuations
- Showerhead features MasterClean™ sprayface for easy cleaning.
- For use with any KOHLER showerhead (not supplied).
- "Premium material construction with metal handle ensures reliability and durability."
- "Deck or Bath-Mount installation"
- Trim set requires valve to complete installation.
- KOHLER finishes resist corrosion and tarnishing, exceeding industry durability standards over two times
- Premium material construction for durability and reliability
- Rite-Temp® pressure-balancing technology maintains water temperature within +/-3 degrees Fahrenheit
- High-temperature limit stop allows you to preset a comfortable maximum temperature to eliminate scalding
- Optimal water coverage provided by large showerhead diameter
- Valve allows for sweat or thread connection
- Ease of installation with slip-fit connection

Required Products/Accessories

K-11748 Series Rite-Temp® Valves

Optional Products/Accessories

1139260 Deep Rough-In Kit



Codes/Standards



ASME A112.18.1/CSA B125.1

KOHLER® Faucet Lifetime Limited Warranty

See website for detailed warranty information.

Available Colors/Finishes

Color tiles intended for reference only.

Color	Code	Description
	CP	Polished Chrome
	BN	Vibrant® Brushed Nickel

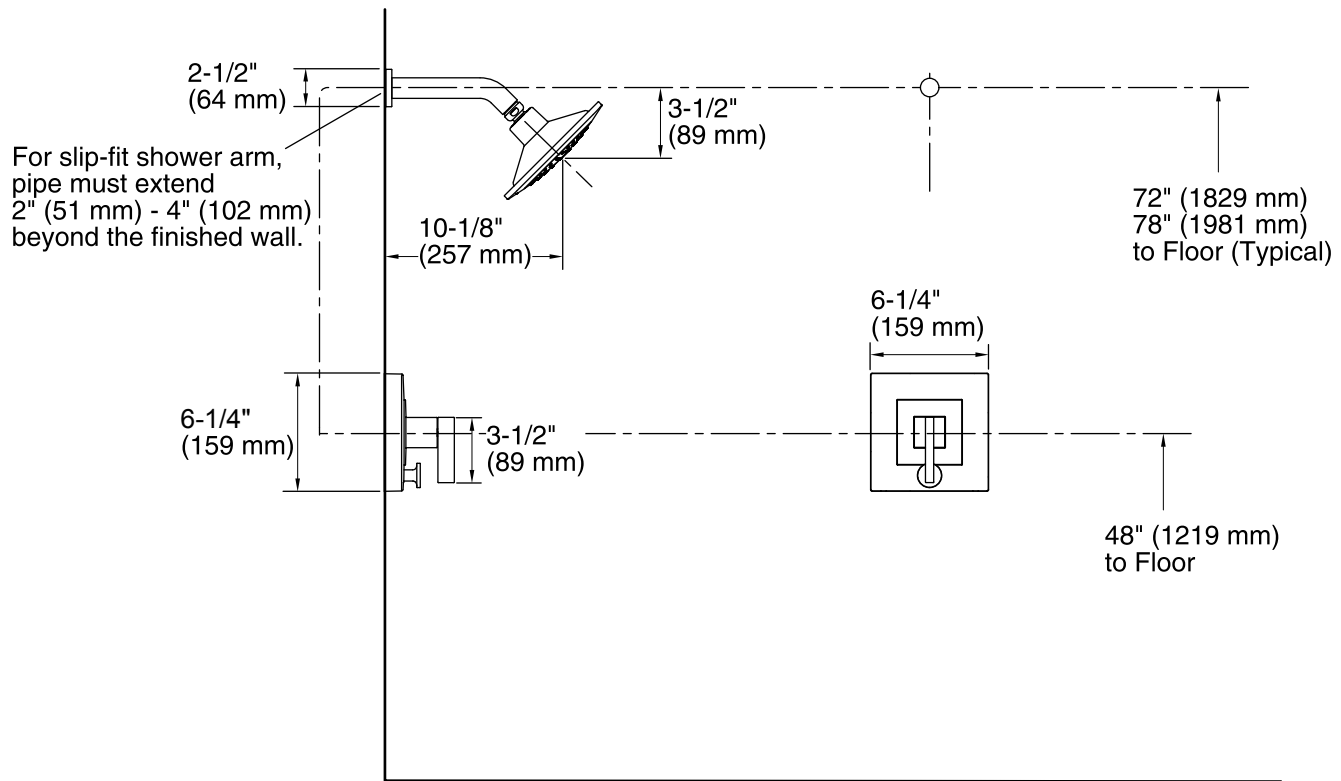

Technical Information

All product dimensions are nominal.

Notes

Install this product according to the installation guide.

Avoid cross-flow conditions. Do not install a shut-off device on either valve outlet.