



KITCHEN FAUCET

MODEL: COS-KF863SS

USER'S MANUAL & INSTALLATION GUIDE

COSMO

Thank You



Thank you for your purchase. We know that you have many brands and products to choose from and we are honored to know that you have decided to take one of our products into your home and hope that you enjoy it.

Our faucets are designed according to the strictest performance standards for the North American market. We follow the most advanced manufacturing philosophy. Each faucet leaves the factory after thorough quality inspection and testing. Our distributors and our service partners are ready to answer any questions you may have regarding how to install, use and care for your faucet.

We hope that this manual will help you learn to use the product in the safest and most effective manner and care for it so that it may give you the highest satisfaction for years to come. If you have any questions or concerns, please contact the dealer from whom you purchased it, or contact our Customer Support at 1-888-784-3108.

The manual also includes directions for the professional installer that will install the product in your home. We recommend using trained personnel for professional installation.

Please keep this manual for future use

PRE-INSTALLATION INSTRUCTIONS

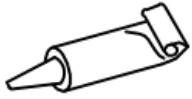

Plumber's putty



Pipe tape



Bucket



Philips Screwdriver



Pliers



Adjustable wrench

Make sure you have all necessary parts by checking the diagram and parts list. If any part is missing or damaged, please contact Cosmo Appliances at **1-888-784-3108**

Pre-drilled hole size requirement: 1-3/8" - 1-1/2"

Max countertop thickness without deck plate: 1-3/8"

Turn off the hot and cold water supply at the angle stops and turn on the old faucet to release any built up pressure. Remove existing faucet. Clean the sink of countertop to remove debris, plumber's putty, and silicone.

Place a bucket under the angle stops. Turn on to clear any debris prior to installing new plumbing. Shut off angle stops.

TABLE OF CONTENTS

PARTS DIAGRAM	04
PARTS INCLUDED	05
FAUCET DIMENSIONS	06
INSTALLATION PROCEDURES	08
OPERATING INSTRUCTIONS	12
TROUBLESHOOTING	14

FAUCET PARTS DIAGRAM

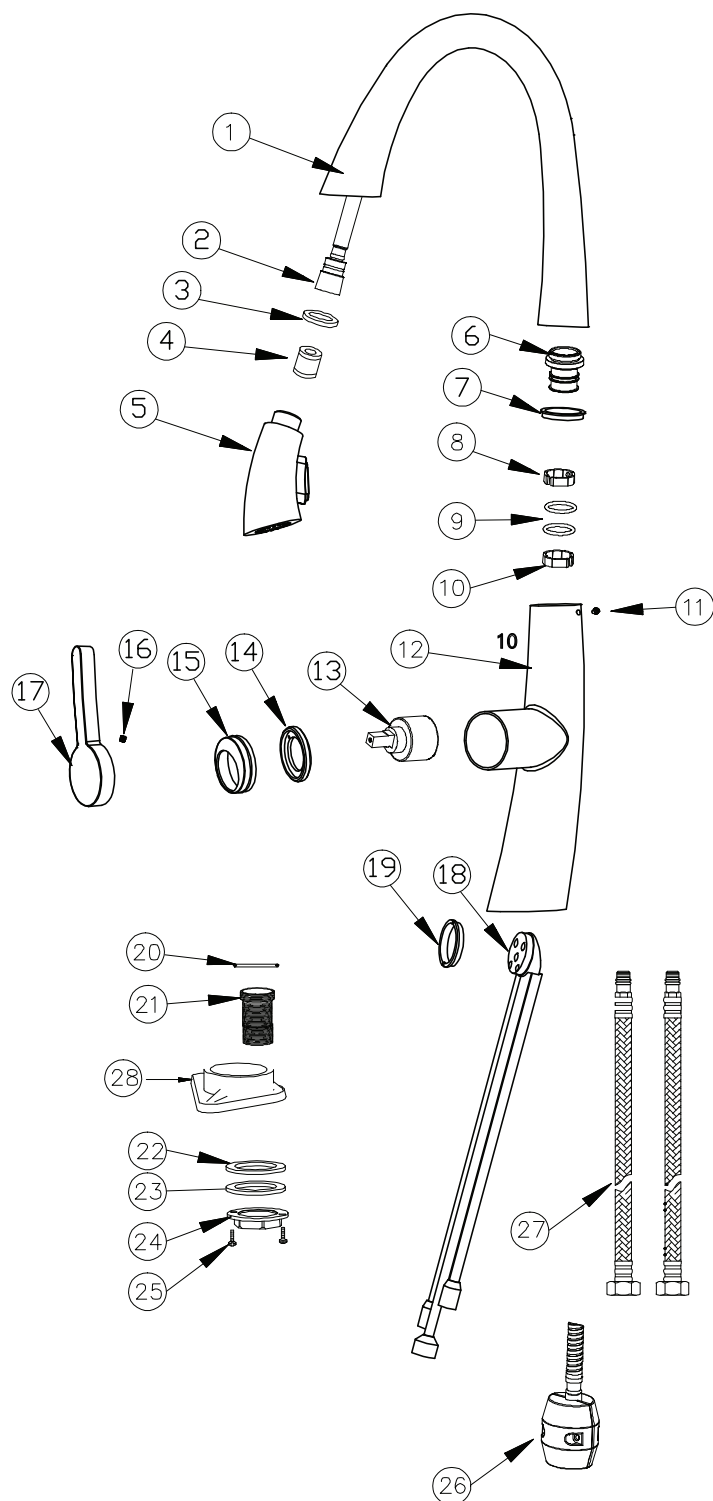

NO.	NAME	QTY
28	Plastic washer	1
27	Water Supply Hose	2
26	Weight Kit	1
25	Screw	1
24	Lock Nut	1
23	Metal Gasket	1
22	Rubber Gasket	1
21	Shank	1
20	O-ring	1
19	Cartridge Seat Nut	1
18	Cartridge Seat	1
17	Handle	1
16	Screw	1
15	Trim Cap	1
14	Cartridge Nut	
13	Cartridge	1
12	Body	1
11	Screw	1
10	Washer	2
9	O-ring	1
8	Washer	1
7	Washer	1
6	Connector	1
5	Spray	1
4	Check Valve	1
3	Gasket	1
2	Spray Hose	1
1	Spout Assembly	1

PARTS INCLUDED:

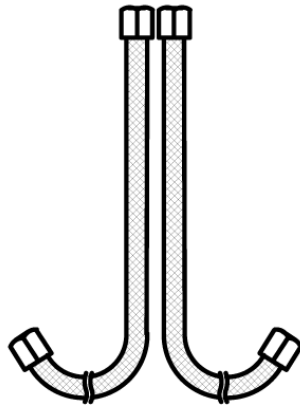

TWO METAL
BRAIDED HOSES



SILICONE RING

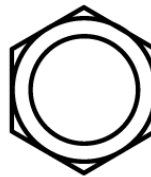

NUT



METAL RING



PLASTIC HOLDER

FAUCET DIMENSIONS

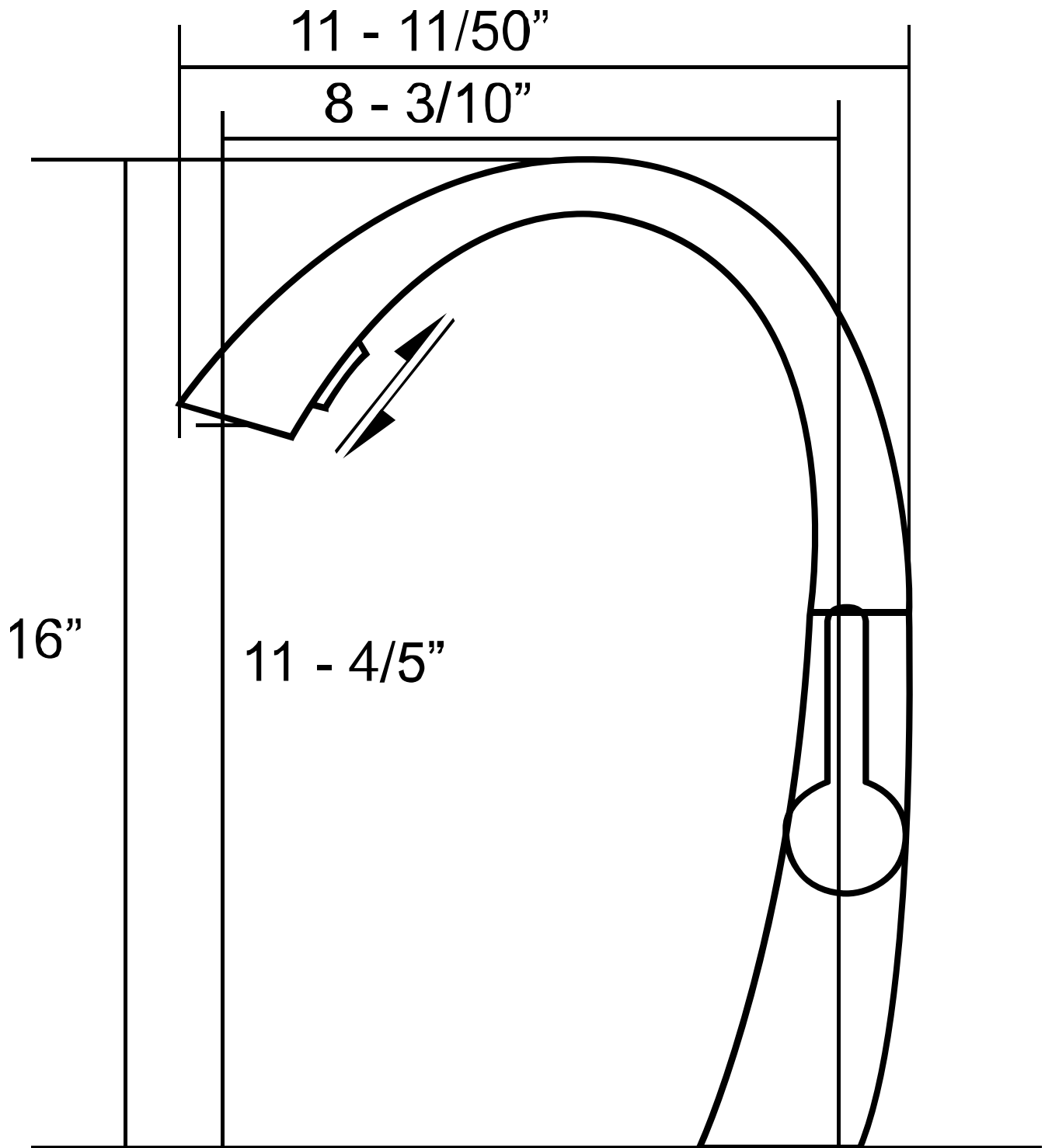

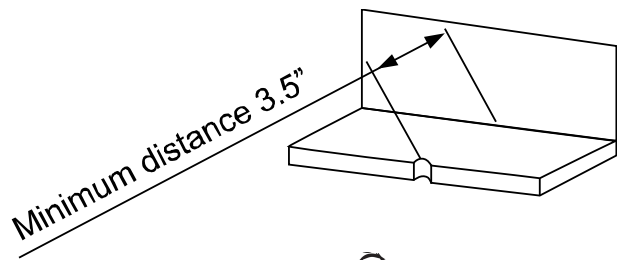

The minimum distance between the faucet hole and the wall should be 3.5". This is to ensure that the faucet lever can move freely allowing for full operation.

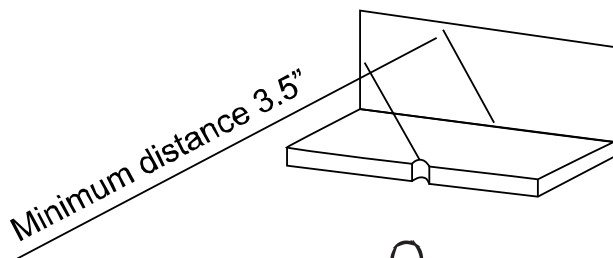
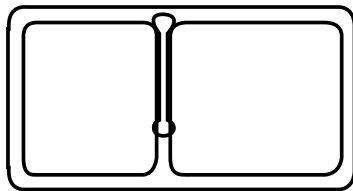
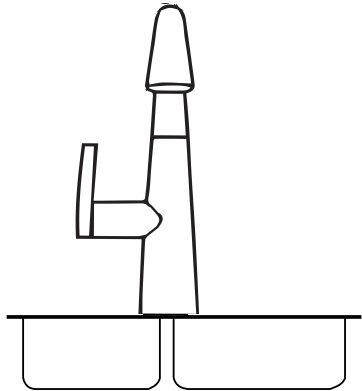

If the distance between the faucet hole and the wall is less than 3.5", you may position the faucet lever 30 degrees to 90 degrees off of the wall to allow for full operation

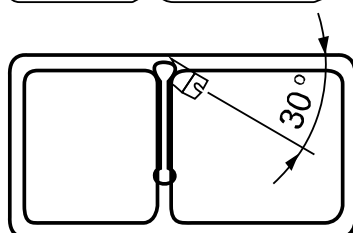
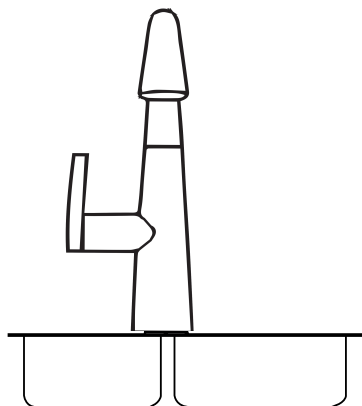

Step 1

INSTALLATION PROCEDURE

Remove the plastic holder, silicone ring, metal ring, and nut from the shank. Insert faucet through the top hole of installation site. Attach Plastic Holder (A), Silicone Ring (B), Metal Ring (C) under the faucet. Use the Nut (D) provided to hold sink and hardware into place. Once tightened, use the Screws (E) located on the nut to firmly secure into place.

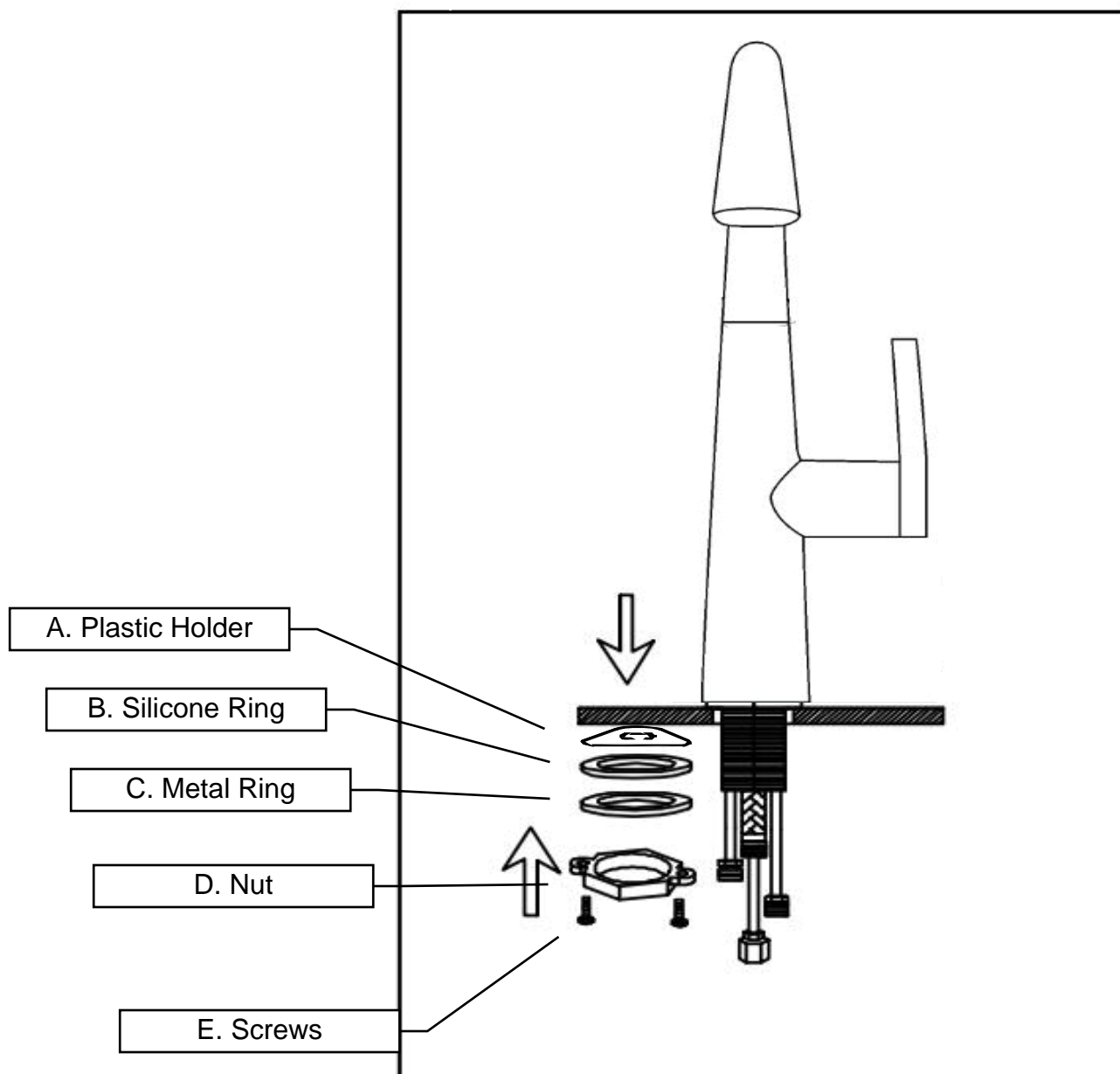

Step 2

Connect spray hose (B) to supply hose (A).

Connect the hot and cold hoses to the hot and cold supply hoses of the faucet. Hoses on the faucet are labeled.

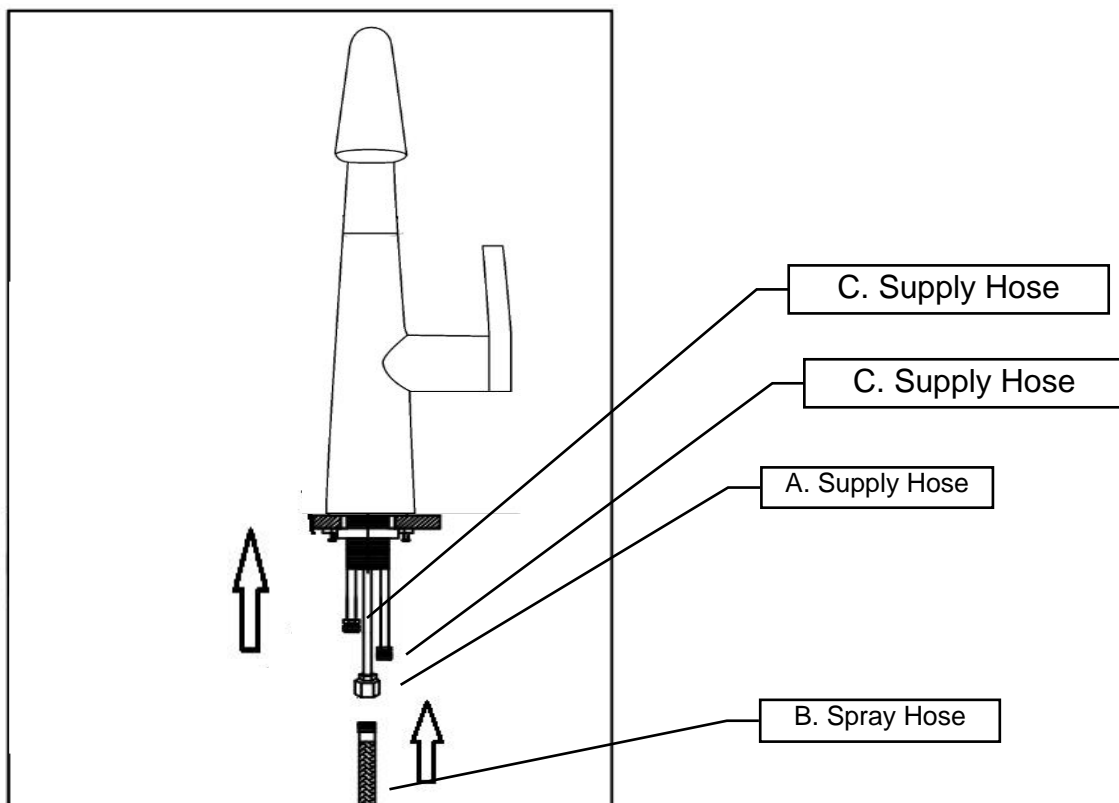

Step 3

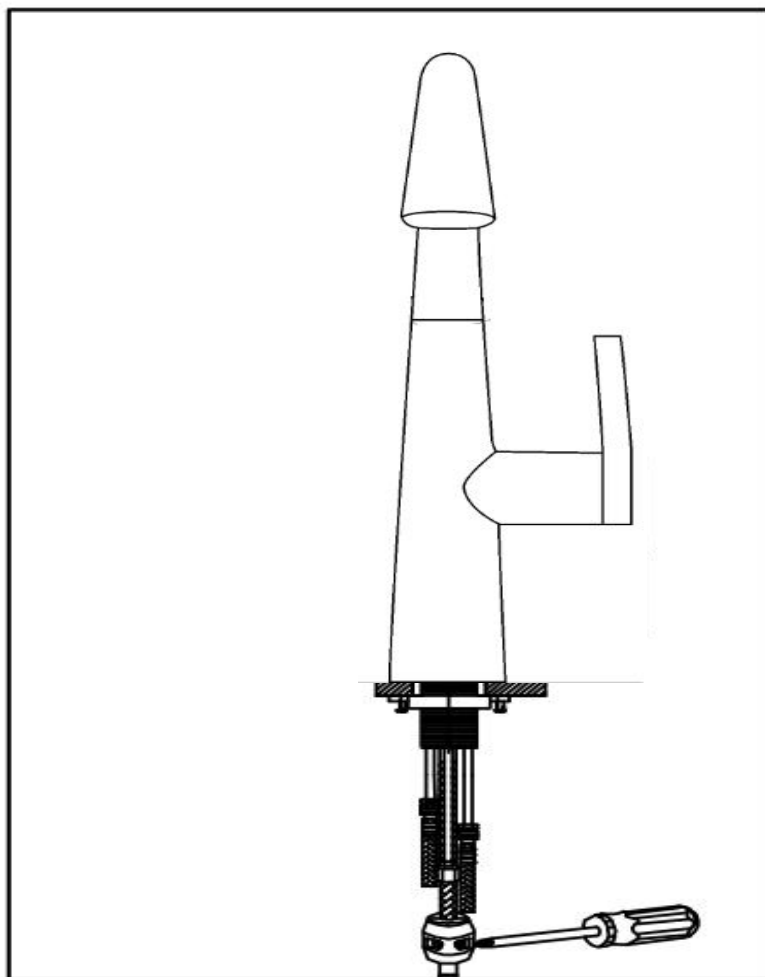

Proper installation of the hose counterweight will ensure that the sprayer retracts smoothly. On the sprayer hose measure 15" down from the body of the faucet and mark this point. Install the hose weight at this marked point. The sprayer should retract smoothly. Reposition the hose weight as necessary. Make sure the hot and cold hoses do not interfere with the spray hose. They can be repositioned slightly if necessary.

Step 4

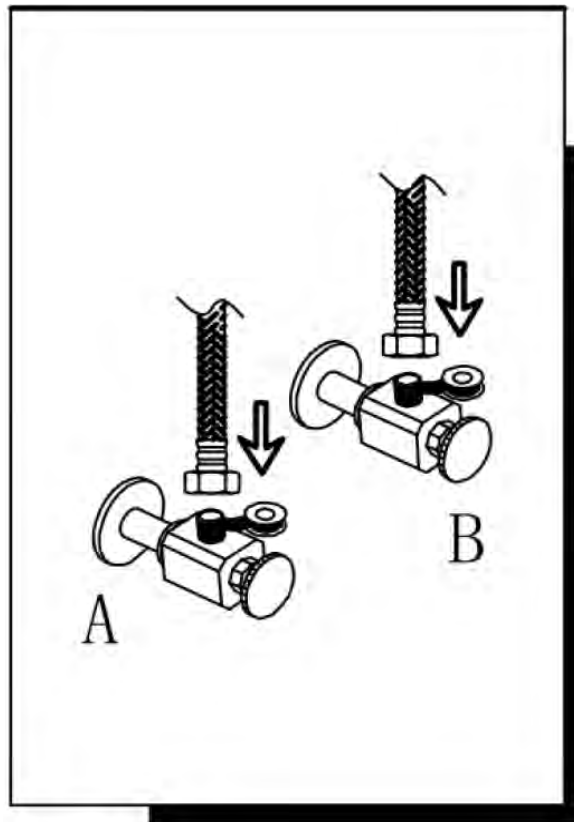

Connect and tighten waterlines to hot and cold water supply (use plumbers tape on the water supply threads). Turn on the water supply and check for leaks **(DO NOT TURN FAUCET ON K7F1)**

If no leaks are found turn the faucet on for 60 seconds to clear any debris from the water lines.

Usage

How to Operate the Handle

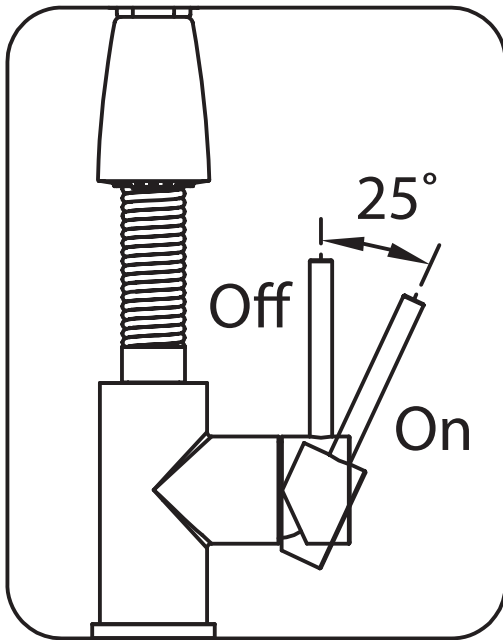

1. Pull the lever to the right to turn on the water. Push to the left to turn offž

2. Pull the lever forward (towards you) to increase cold water flow and push the lever back (away from you) to increase the hot water flow.

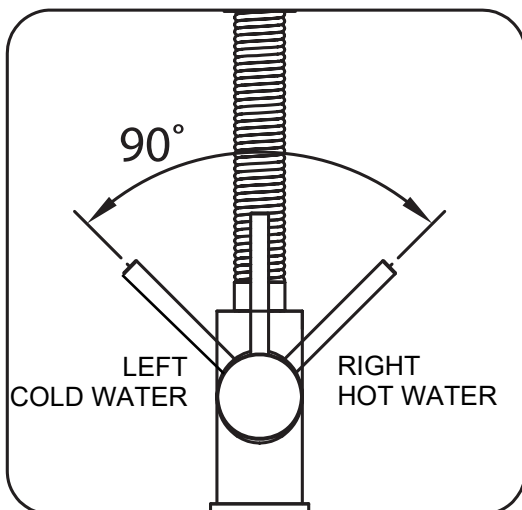

Usage

How to Operate the Sprayer

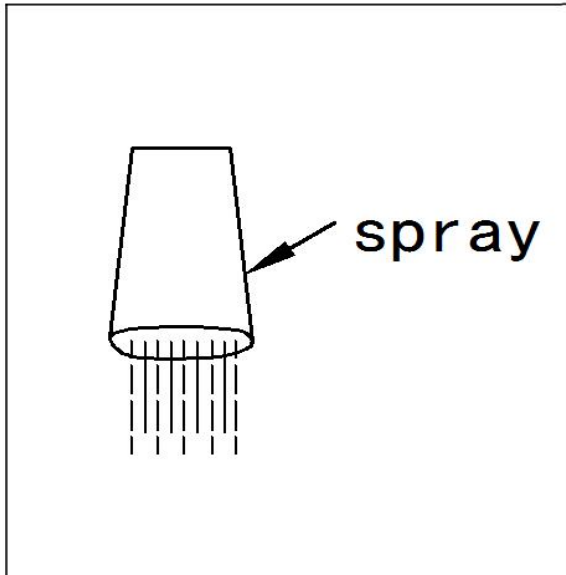

1. Turn on the handle, press the top position on button, for spray function.

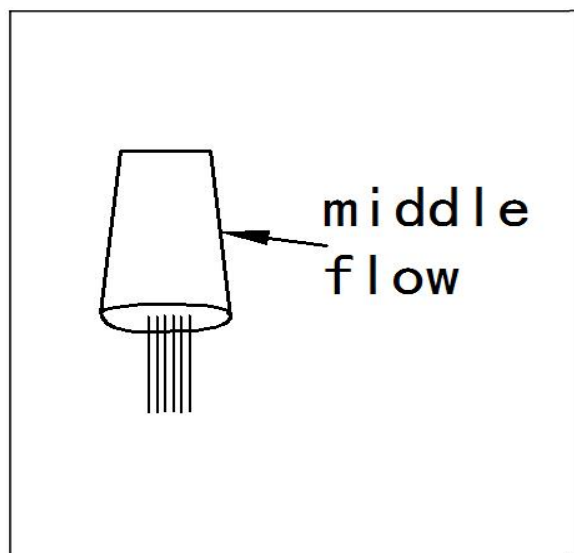

2. Turn on the handle, press the down position on button, the flow will come from the middle

Troubleshooting

If you have followed the instructions carefully and your faucet still does not work properly, take the following corrective steps:

PROBLEM	CAUSE	ACTION
Leakage under the handle.	Locking nut has come loose .	Unscrew the lever on the handle by hand. Loosen set screw with a hex wrench (2.5 mm). Remove the handle and unscrew fd_ USB by hand. Tighten locking nut with an adjustable wrenchž
Water will not shut off completely	Cartridge needs to be replaced.	Unscrew the lever on the handle by hand. Loosen set screw with a hex wrench (2.5 mm). Remove the handle and unscrew fd_ USB by hand. Un-screw the locking nut with an adjustable wrench. Replace ceramic disc cartridge.
Leaking between spray head and the hose	Spray head may be loose or washer is not seated correctly in the hose connection	Tighten the spray head by hand until snug. Make sure the washer is seated correctly

Codes/Standards Applicable:



- Certified to CUPC
- Certified to AB1953
- Certified to NSF/ANSI 61
- **ADA** for lever handle

WARRANTY AND SERVICE



For full warranty details on this product please visit:
<http://www.cosmoappliances.com/warranty>