



Tahoe®
Under-mount Bathroom Sink
K-2890-4U

Features

- 4" (102 mm) centerset faucet holes.
- Overflow drain.
- Single-hole center-mount or 4" centers.

Material

- KOHLER® enameled cast iron.

Installation

- Undermount.
- Drilled oversized to accommodate single-hole centermount or centerset faucet.

Recommended Products/Accessories

K-8998 P-Trap
K-23726 Drain treatment
K-23725 Cast iron cleaner

Included Components

Additional Components:
1193643 Basin clamps



ADA

CSA B651

Codes/Standards

ASME A112.19.1/CSA B45.2
ADA
ICC/ANSI A117.1
CSA B651



**Lifetime Limited Warranty for
KOHLER® Cast Iron Components**

See website for detailed warranty information.

Available Colors/Finishes

Color tiles intended for reference only.

Color Code Description

	0	White
	96	Biscuit

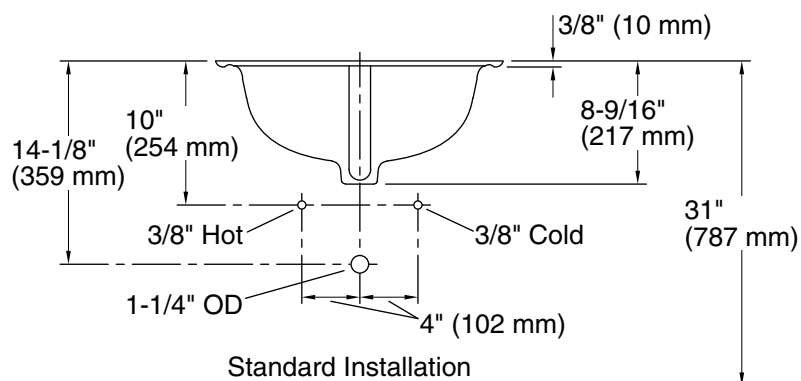
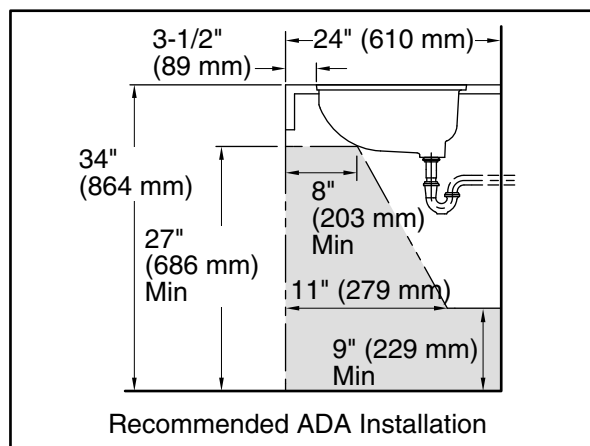
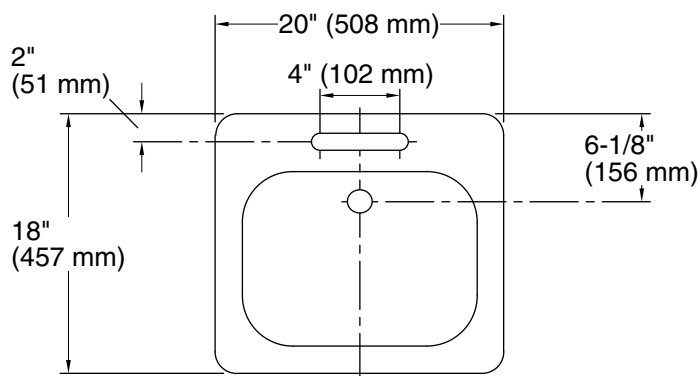

Technical Information

All product dimensions are nominal.

Bowl configuration: Single

Installation: Under-mount

Bowl area (Only): Length: 16" (406 mm)
Width: 12" (305 mm)
Water depth: 5" (127 mm)

Number of deck holes: 3

Faucet hole spacing: 4" (102 mm)

Faucet hole(s): 2-1/8" (54 mm)

Drain hole: 1-11/16" (43 mm)

Template: 114409-7, required, included

Notes

Install this product according to the installation instructions.

ADA, CSA B651 compliant when installed to the specific requirements of these regulations.