



# ZIPPITY

*Easy Does It!*

## OCEANSIDE OUTDOOR VINYL SHOWER KIT (3' X 3' ENCLOSURE)

## ASSEMBLY INSTRUCTIONS ZP19024

**5 HRS**

*Approximate assembly and installation time*

Want to see a video on how to  
assemble this product?  
**Scan the QR code**

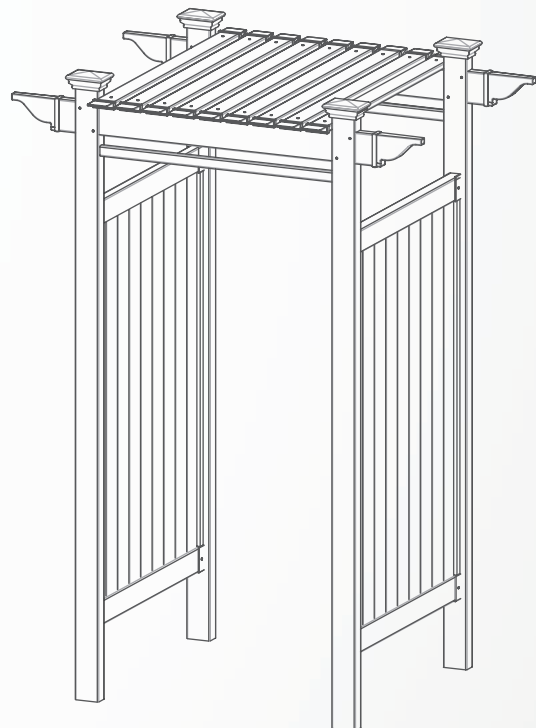

## GENERAL INFORMATION



### IMPORTANT

- + Check the inside of the larger pieces in your box for other materials packed inside.
- + When assembling components, place on a non-abrasive surface (i.e. shipping box) to avoid scratching.
- + We recommend an area approximately 5'x 8' for unobstructed assembling.
- + You should not need to use excessive force when assembling components.

## MISSING OR DAMAGED PARTS?

### VISIT OUR WEBSITE FIRST, SO WE CAN HELP YOU RIGHT AWAY!

Although great care has been taken to ensure proper packaging and handling of this product, occasionally problems occur. If you discover any missing, damaged, or defective parts, please visit our website to order replacement parts. If you experience any further trouble with your product, please contact our customer service department.

 [parts.nychbrands.com](https://parts.nychbrands.com)

 [support@zippity-outdoor.com](mailto:support@zippity-outdoor.com)

 **704-892-5222 / 877-234-6196**

*Customer service agents are available to take calls weekdays from 9am-5pm EST. If you call outside of business hours, please leave a voicemail.*

To help you quickly and accurately, please have reference item number **ZP19024** and the specific part name which can be found on page 4. It is helpful if you can provide the batch lot which is a stamped number inside the box.

## NEED ASSEMBLY HELP?

If you are having problems with the assembly or installation of this product, we are happy to assist you with the process, **so please give us a call at 704-892-5222 / 877-234-6196.**

## NEED TO RETURN?

If for some reason you need to return this product, please allow us to help resolve your issues first. If you still decide to return the product, **you will need to initiate the return from the company you originally purchased from.**

## Detailed Product Dimensions & Specifications

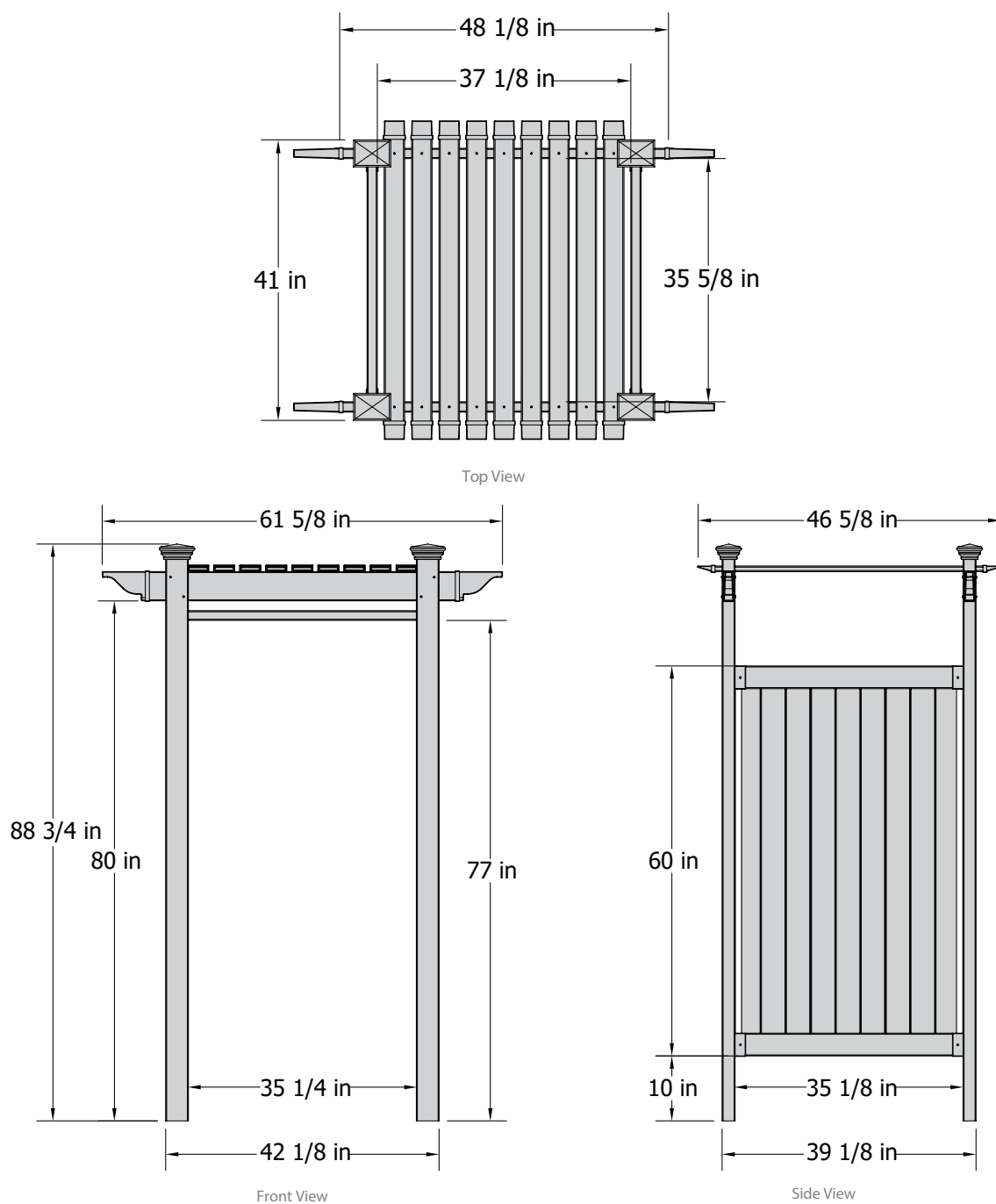

## STEP 1: LAY OUT MATERIALS

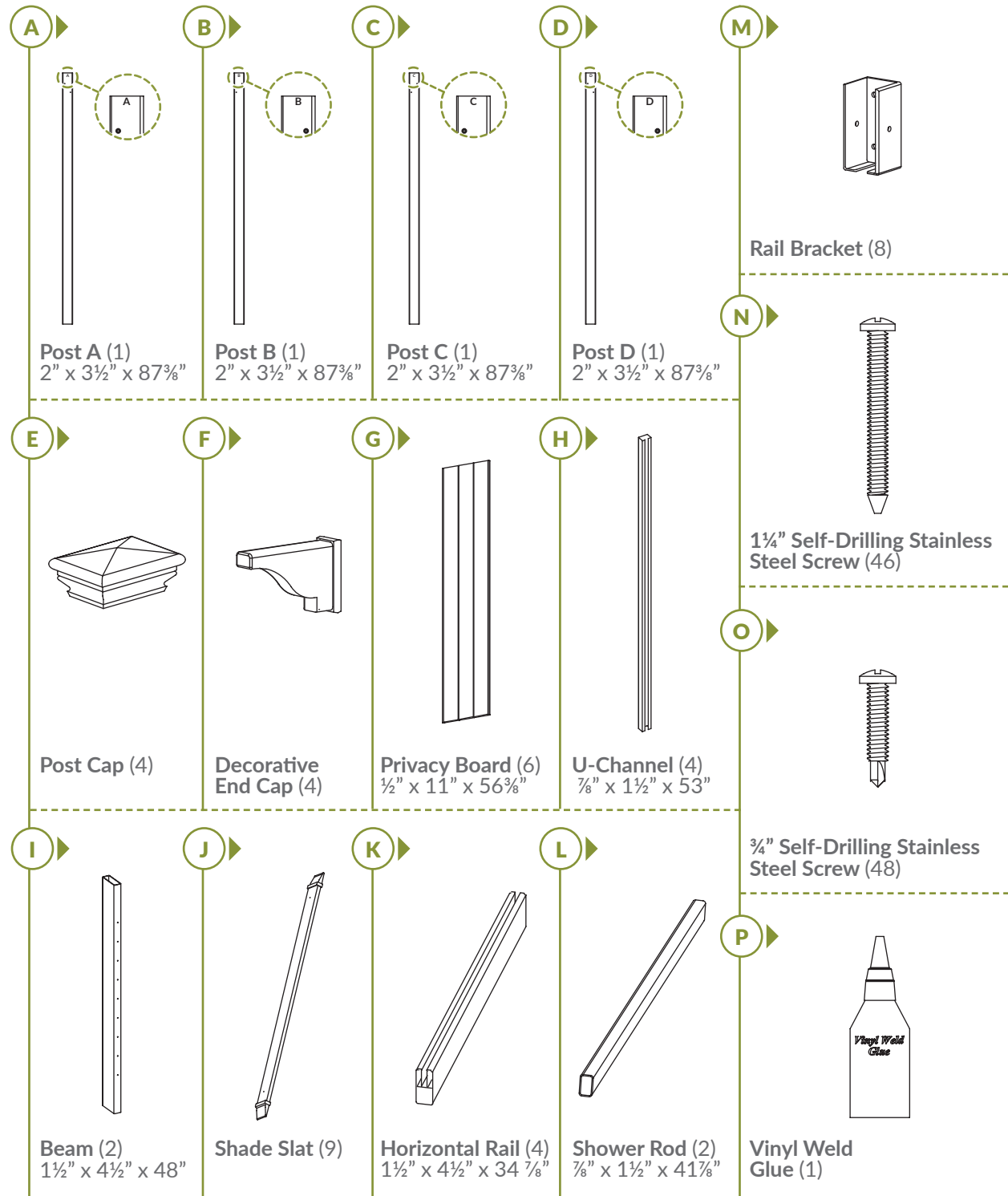

## NOT INCLUDED WITH PURCHASE:

*Sold Separately*

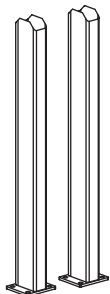

**(ZP19011) Zippity Surface Mount 2-pack (2)**

*For wood or concrete surface mounting*

*Sold Separately*

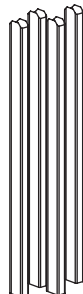

**(ZP19012) Zippity Post Extension (1)**

*For in-ground mounting*

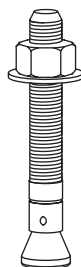

**1/4" x 3" Concrete Wedge Anchor (16)**

*Only needed if installed on concrete*

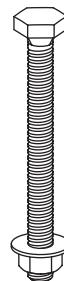

**1/4" x 4" Hex Head Bolt w/ Nut and Washer (16)**

*Only needed if installed on wood*

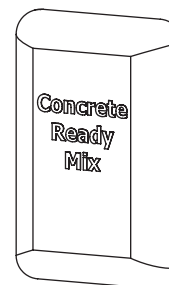

**80 lb Concrete Mix (2)**

*Only needed if installed in ground*

## STEP 2: INSTALLING MOUNTING ACCESSORIES

### STEP 2.1A ▶

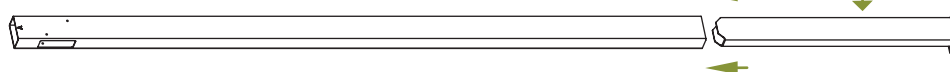

► **Concrete or wood surface mounting:** Insert (4) Surface Mounts (**ZP19011**) into the bottom of all 4 posts as illustrated. The surface mounts will be secured in the next step.

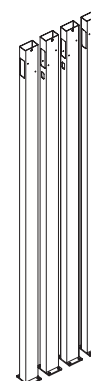

### STEP 2.1B ▶

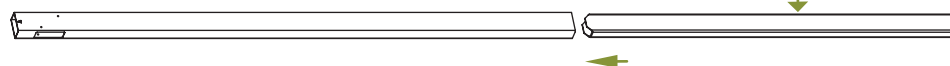

► **In-ground installation:** Insert (4) Post Extensions (**ZP19012**) into the bottom of all 4 posts as illustrated. The post extension should extend 28" below the bottom of the post when secured.



## STEP 3: INSTALL BRACKETS

### STEP 3.1 ▶

- Lay out Post A (**A**) on a flat surface, and align the Rail Brackets (**M**) with the pre-drilled holes on post A. Secure the brackets to post A with (8) 3/4" Self-Drilling Stainless Steel Screws (**O**).

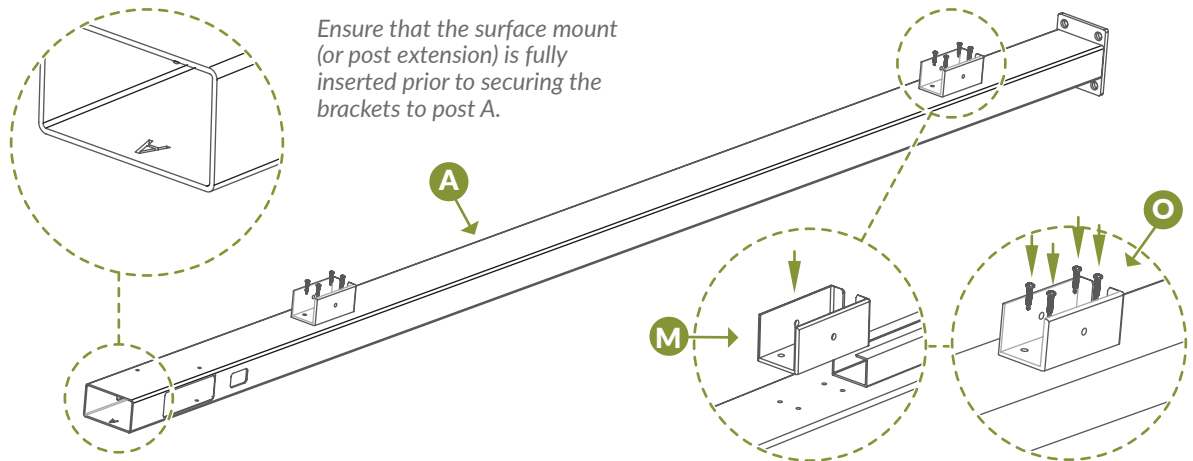

### STEP 3.2 ▶

- Repeat step 3.1 for Posts B (**B**), C (**C**), and D (**D**).

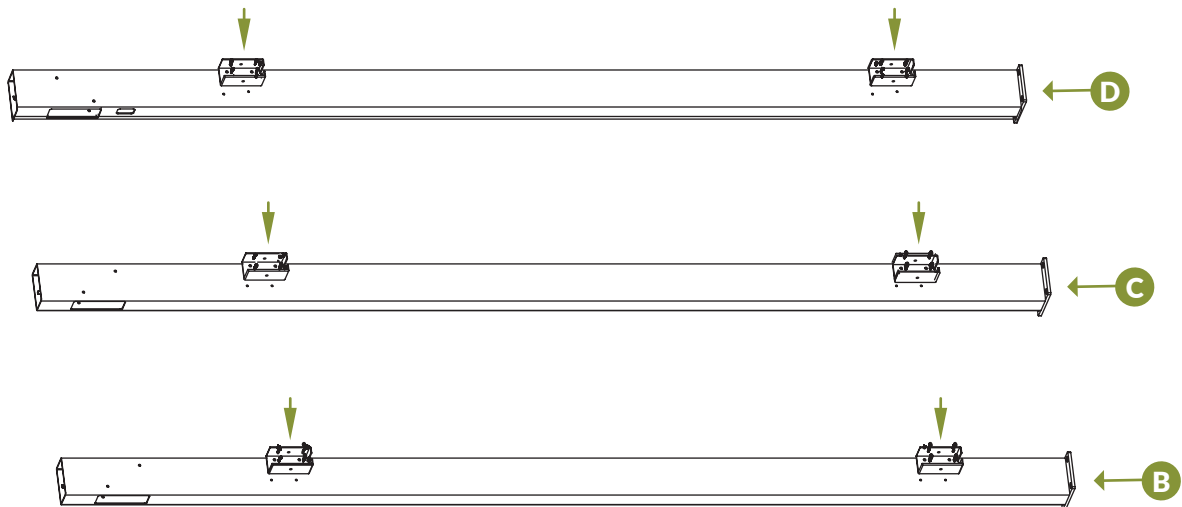

## STEP 4: INSTALL U-CHANNELS

### STEP 4.1 ▶

1. Position (1) U-Channel (**H**) between the two rail brackets. Ensure the open groove of the U-channel is centered with the brackets.
2. Drive (3) 1 ¼" Self-Drilling Stainless Steel Screws (**N**) through the pre-drilled holes in the U-channel.

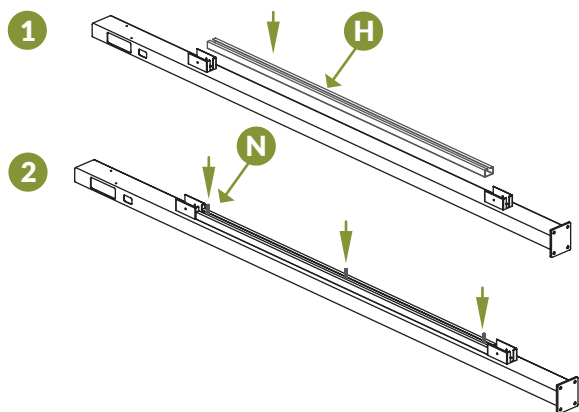

### STEP 4.2 ▶

- ▶ Repeat step 4.1 for the rest of the posts.

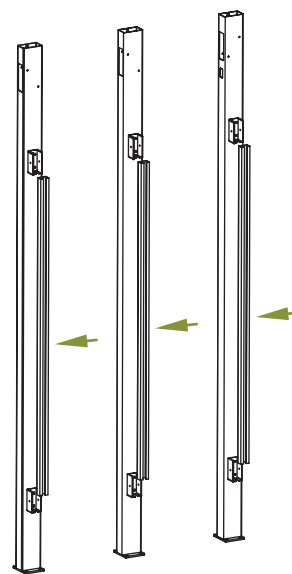

## STEP 5: ASSEMBLE SIDE PANELS

### STEP 5.1 ▶

1. Position post A and post B as illustrated, and insert a Horizontal Rail (**K**) into the rail brackets. Ensure the groove in the rail faces up.
2. Secure the horizontal rail into the rail brackets with (4) ¾" self-drilling stainless steel screws.

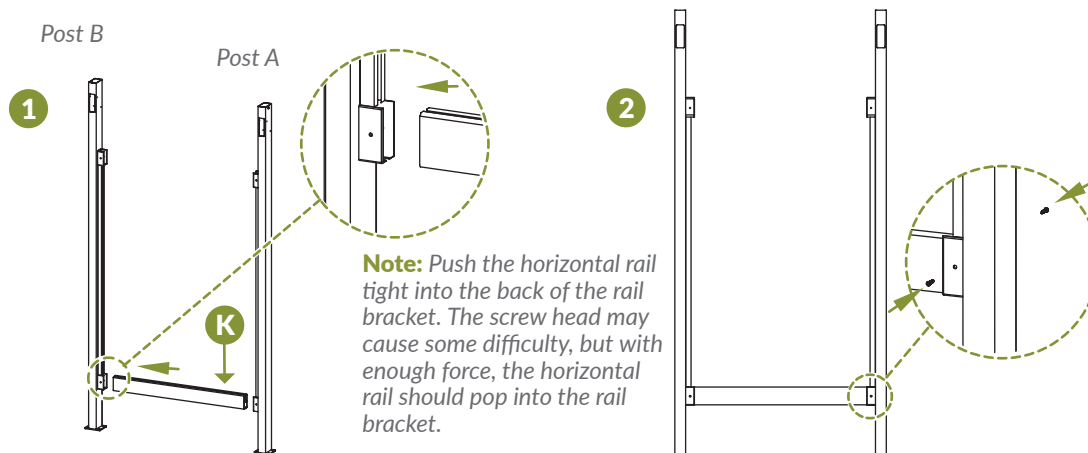

## STEP 5.2 ▶

▶ Insert the first Privacy Board (G) into the horizontal rail then insert the privacy board into the U-channel. Angle the privacy board as illustrated. This will make it easier to get the privacy board into the U-channel. Insert the last privacy board in the same fashion.

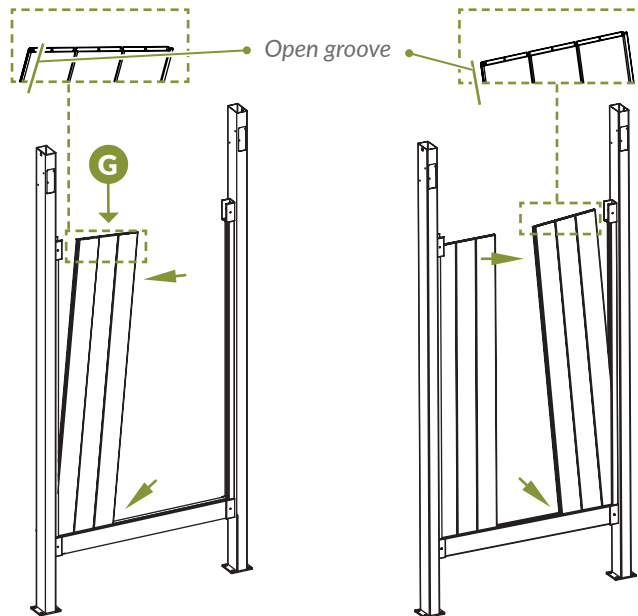

## STEP 5.3 ▶

▶ Slide the middle privacy board in vertically as illustrated.

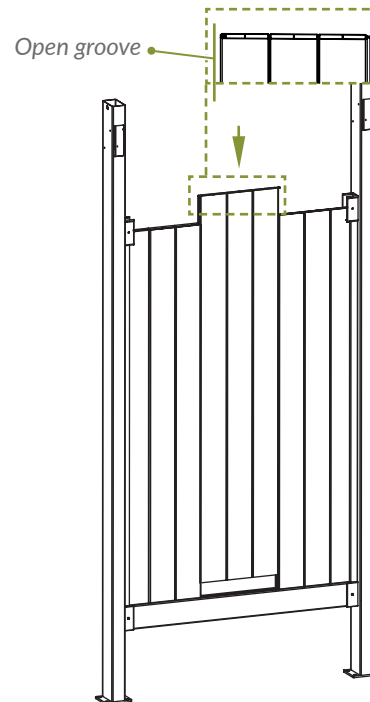

## STEP 5.4 ▶

1. Slide another horizontal rail down over the privacy boards.
2. Secure the horizontal rail to the rail brackets with (4)  $\frac{3}{4}$ " self-drilling stainless steel screws.
3. Repeat steps 5.1 through 5.4 to assemble the second wall panel.

**Note:** Make sure the horizontal rail is inserted fully over the privacy boards and rests inside the rail brackets.

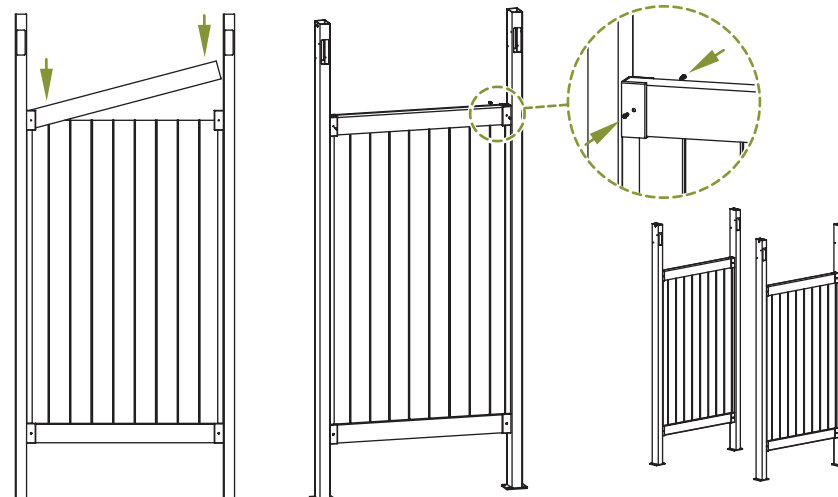



## STEP 6: INSTALL SHOWER RODS AND BEAMS - REQUIRES 2 PEOPLE

### STEP 6.1 ▶

- ▶ Slide (2) Shower Rods (**L**) into the smaller routed holes in the posts until they hit the back wall of the posts.

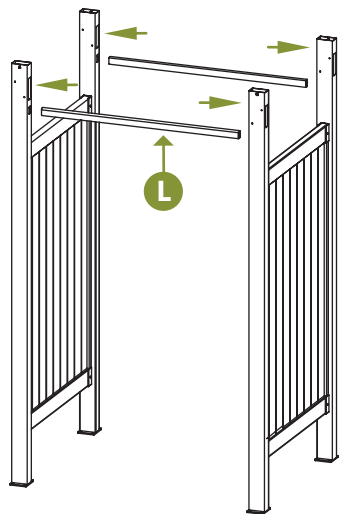

### STEP 6.2 ▶

1. Slide (2) Beams (**I**) into the larger routed holes in the posts until the pre-drilled holes in the beams and posts align.
2. Drive (16) total 1¼" self-drilling stainless steel screws into the pre-drilled holes in the posts to secure the beams.

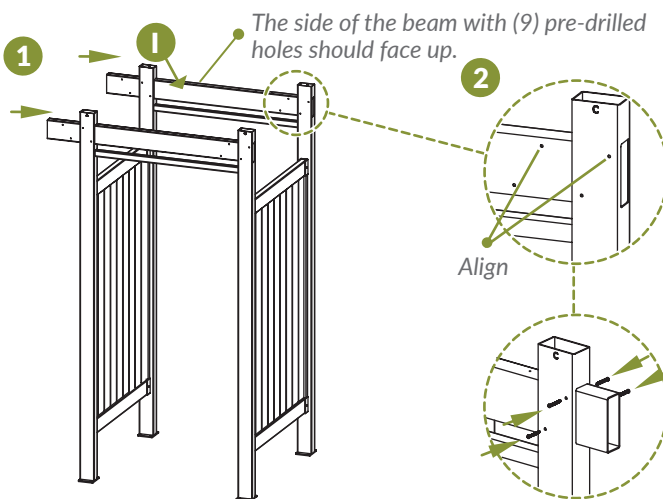

## STEP 7: INSTALL POST CAPS

### STEP 7.1 ▶

- ▶ Pressure fit the Post Caps (**E**) onto each post as shown.

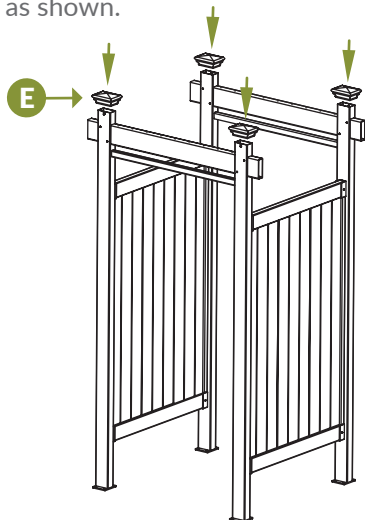

### STEP 7.2 ▶

- ▶ Apply a small amount of Vinyl Weld Glue (**P**) to the inside of each Decorative End Cap (**F**). Attach the decorative end caps to the ends of the beams.

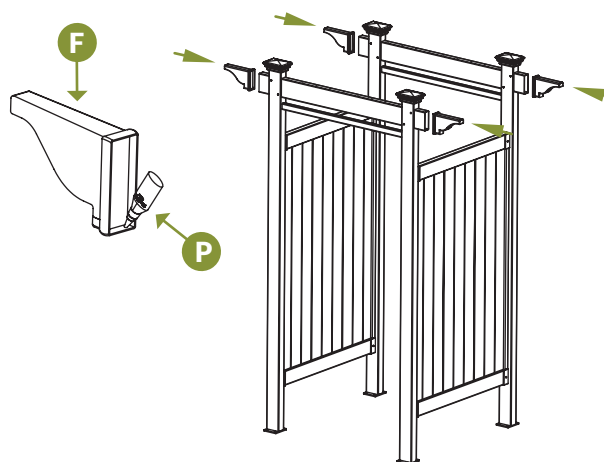

## STEP 8: SQUARE AND SECURE POSTS

### STEP 8.1

► Square the unit in the space where you plan to install your shower. The diagonal distance between your posts must be equal for your unit to be square.

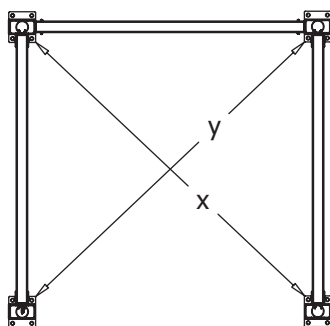

### STEP 8.2A

► **Surface Mount install:** Mark the hole locations for all 4 surface mounts, and use (16)  $\frac{1}{4}$ " x 3" concrete wedge anchors (NOT INCLUDED), or similar sized lag screws (NOT INCLUDED) if mounting on wood, to secure the surface mount.

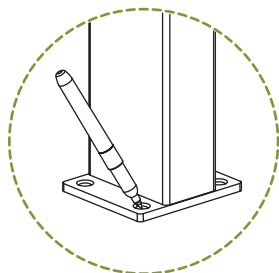

**Note:** If your concrete is not level, insert galvanized steel washers under the lower side of the surface mount until it is level. Then, secure the surface mount with wedge anchors.

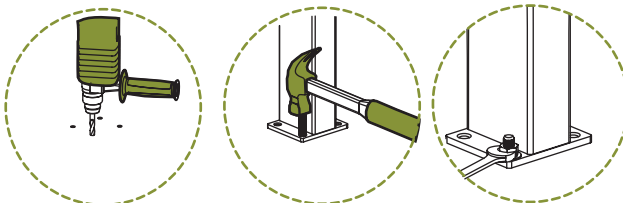

A hammer drill will be needed for this step.

### STEP 8.2B

► **Post Extension install:** Mark the post locations and temporarily set the unit aside. Dig (4) 9" diameter, 36" deep holes at the post locations. Then lower the unit into the ground, and fill the holes with concrete (NOT INCLUDED). Use support blocks to hold the unit while the concrete cures.

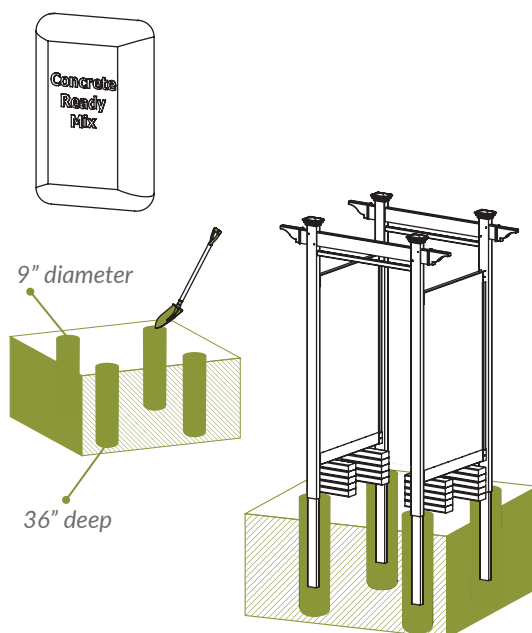

## STEP 9: INSTALL SHADE SLATS

### STEP 9.1 ▶

1. Drive a 1¼" self-drilling stainless steel screw through the pre-drilled holes on each end of a Shade Slat (J) until the screw comes out the bottom of the shade slat.
2. Place each shade slat on the beam, guiding the 1¼" stainless steel screw into the pre-drilled holes on each beam, and drive the screws in.

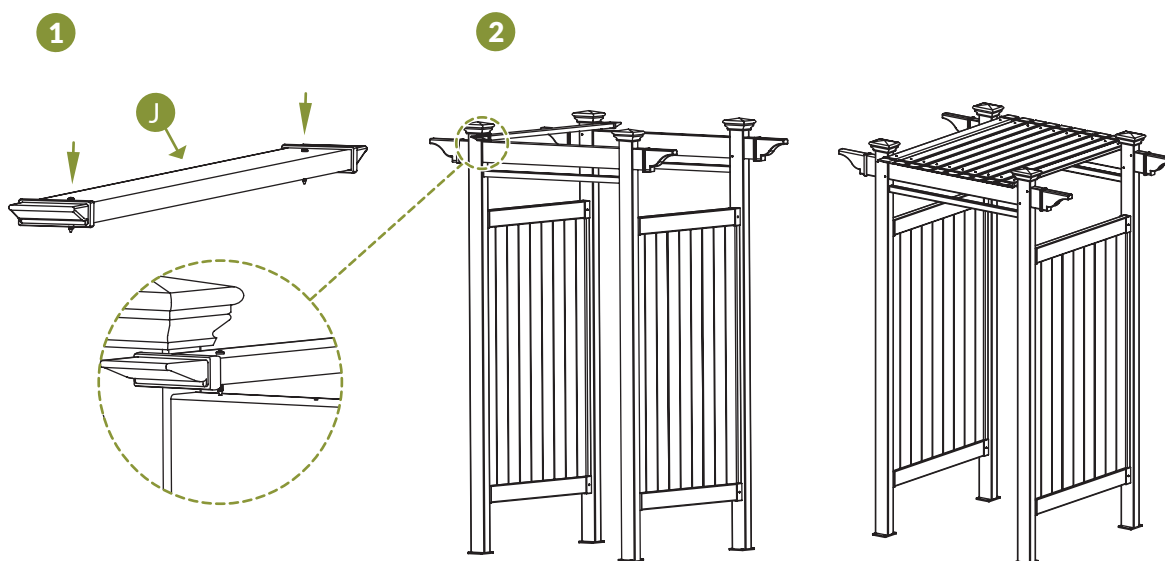

### STEP 9.2 ▶

- ▶ Install your shower curtain (NOT INCLUDED) according to the product instructions.

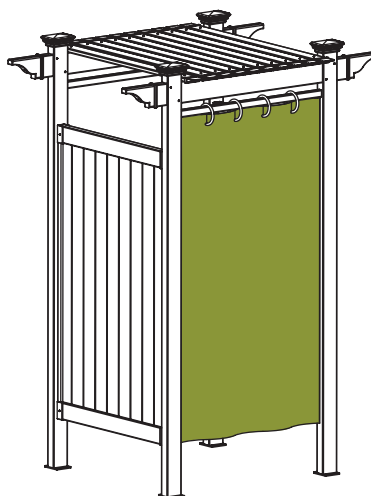



# ZIPPITY

*Easy Does It!*



6935 Reames Rd. Ste. K.  
Charlotte, NC 28216



[support@zippity-outdoor.com](mailto:support@zippity-outdoor.com)

704-892-5222  
877-234-6196



[WWW.ZIPPITY-OUTDOOR.COM](http://WWW.ZIPPITY-OUTDOOR.COM)