

BLISS FMB60S

Sink: BSL60SSINK



| Dimensions: | width | depth | height |
|-------------|-------|-------|---------|
| inches | 59" | 18.5" | 35.125" |
| mm | 1499 | 470 | 892 |

NOTE: DIMENSIONS AND TECHNICAL DETAILS ARE SUBJECT TO CHANGE WITHOUT NOTICE

FRONT ELEVATION

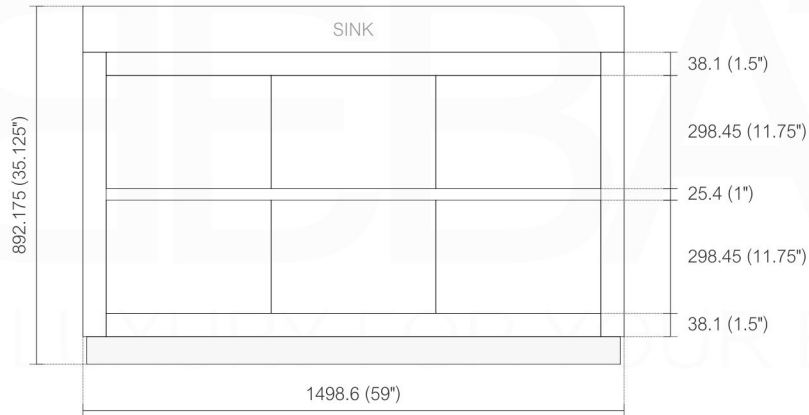

BACK ELEVATION

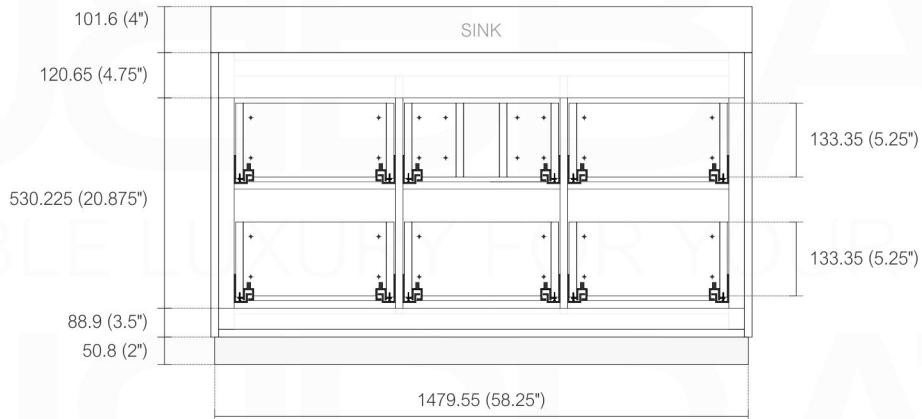

TOP ELEVATION

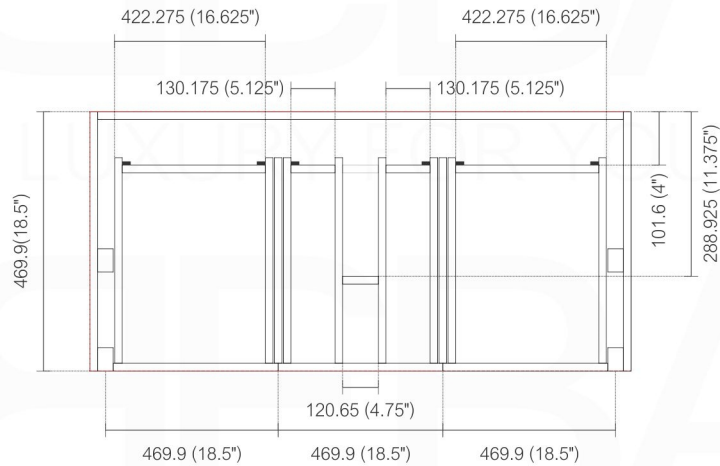

NOTE: DIMENSIONS AND TECHNICAL DETAILS ARE SUBJECT TO CHANGE WITHOUT NOTICE

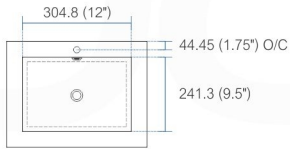

product code
BSL16SINK

Thickness: 9.53 (0.38")

| Dimensions: | width | length | height | depth |
|-------------|-------|--------|--------|-------|
| inches | 16.0" | 16.0" | 4.0" | 3.38" |
| mm | 406.4 | 406.4 | 101.6 | 85.73 |

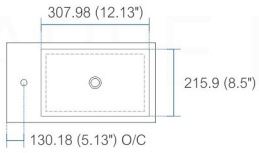

product code
BSL18SINK

Thickness: 9.53 (0.38")

| Dimensions: | width | length | height | depth |
|-------------|-------|--------|--------|-------|
| inches | 18.0" | 10.25" | 4.0" | 3.38" |
| mm | 457.2 | 257.18 | 101.6 | 85.73 |

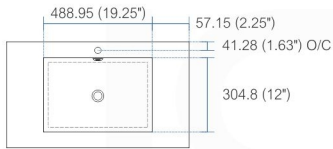

product code
BSL24SINK

Thickness: 9.53 (0.38")

| Dimensions: | width | length | height | depth |
|-------------|--------|--------|--------|-------|
| inches | 23.63" | 18.5" | 4.0" | 4.0" |
| mm | 600.08 | 469.9 | 101.6 | 101.6 |

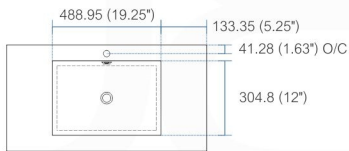

product code
BSL30SINK

Thickness: 9.53 (0.38")

| Dimensions: | width | length | height | depth |
|-------------|-------|--------|--------|-------|
| inches | 29.5" | 18.5" | 4.0" | 4.0" |
| mm | 749.3 | 469.9 | 101.6 | 101.6 |

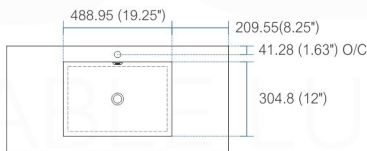

product code
BSL36SINK

Thickness: 9.53 (0.38")

| Dimensions: | width | length | height | depth |
|-------------|--------|--------|--------|-------|
| inches | 35.75" | 18.5" | 4.0" | 4.0" |
| mm | 908.05 | 469.9 | 101.6 | 101.6 |

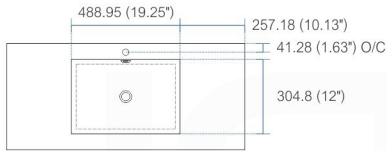

product code
BSL40SINK

Thickness: 9.53 (0.38")

| Dimensions: | width | length | height | depth |
|-------------|--------|--------|--------|-------|
| inches | 39.5" | 18.5" | 4.0" | 4.0" |
| mm | 1003.3 | 469.9 | 101.6 | 101.6 |

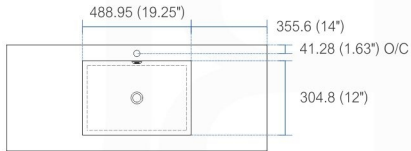

product code
BSL48SINK

Thickness: 9.53 (0.38")

| Dimensions: | width | length | height | depth |
|-------------|---------|--------|--------|-------|
| inches | 47.25" | 18.5" | 4.0" | 4.0" |
| mm | 1200.15 | 469.9 | 101.6 | 101.6 |

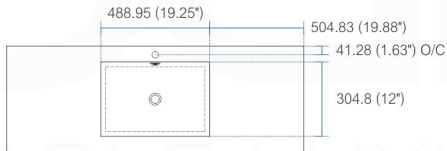

product code
BSL60SSINK

Thickness: 9.53 (0.38")

| Dimensions: | width | length | height | depth |
|-------------|--------|--------|--------|-------|
| inches | 59" | 18.5" | 4.0" | 4.0" |
| mm | 1498.6 | 469.9 | 101.6 | 101.6 |

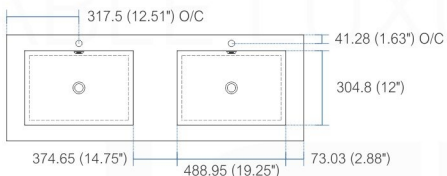

product code
BSL60DSINK

Thickness: 9.53 (0.38")

| Dimensions: | width | length | height | depth |
|-------------|--------|--------|--------|-------|
| inches | 59" | 18.5" | 4.0" | 3.75" |
| mm | 1498.6 | 469.9 | 101.6 | 95.25 |

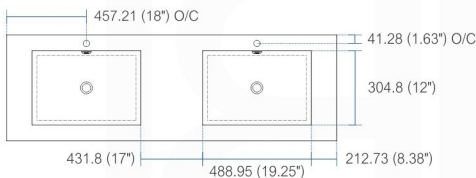

product code
BSL72SINK

Thickness: 9.53 (0.38")

| Dimensions: | width | length | height | depth |
|-------------|---------|--------|--------|-------|
| inches | 71.63" | 18.5" | 4.0" | 4.0" |
| mm | 1819.28 | 469.9 | 101.6 | 101.6 |

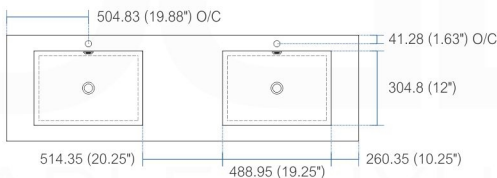

product code
BSL80SINK

Thickness: 9.53 (0.38")

| Dimensions: | width | length | height | depth |
|-------------|--------|--------|--------|-------|
| inches | 79" | 18.5" | 4.0" | 4.0" |
| mm | 2006.6 | 469.9 | 101.6 | 101.6 |

How to Install a Bliss Freestanding Vanity & Remove / Install Drawers INSTALLATION GUIDE

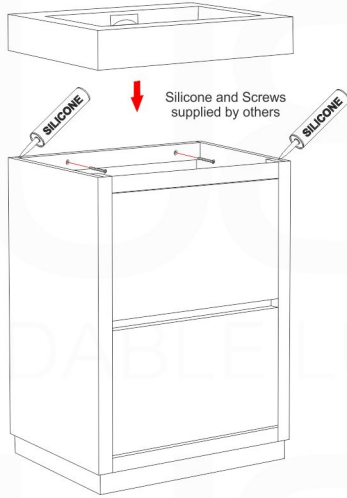

1. Determine your vanity placement and mark the area on the wall where it will be installed.
2. Locate and mark the location of the studs to which you will fasten your vanity. You can find studs by listening for a solid sound as you knock on the wall or by using a stud finder.
3. If your vanity cabinet has a solid back, mark and drill holes to accommodate drain pipes and supply pipes as necessary.
4. Place the vanity in the installation location. Verify that the vanity cabinet is level. If the vanity is not level, use vanity feet (if included) or wooden shims to adjust as necessary.
5. Attach the vanity to the wall by screwing through the mounting rail in the back of the vanity cabinet into the wall studs.
6. Install the integral sink/vanity top by applying a dot of silicone sealant on the corners of the vanity. Position the vanity top onto the vanity and press firmly into place. Wipe away any excess sealant with a damp cloth.

Note: We recommend consulting professional help if you are unfamiliar with installing bathroom vanities and/or plumbing.

REMOVE / INSTALL DRAWERS

REMOVE DRAWERS

(Locate the plastic clips on the bottom of the drawer)

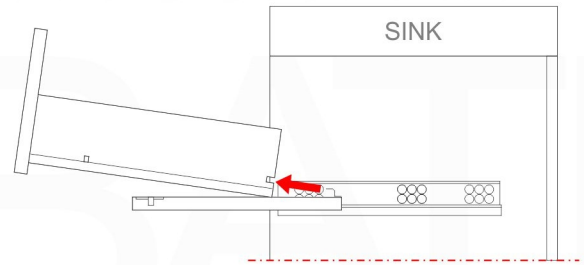
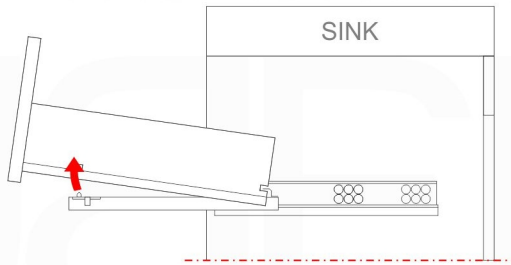
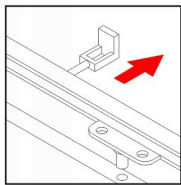

INSTALL DRAWERS

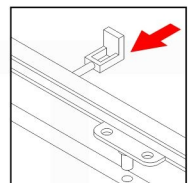
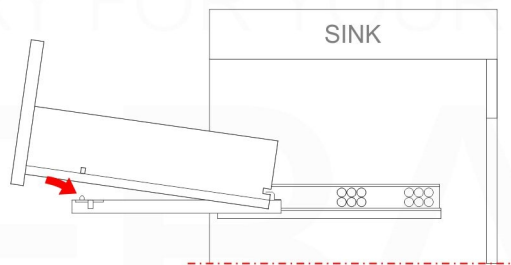
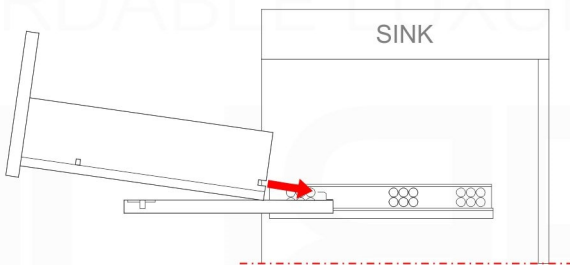

Pop-Up / P-trap Installation Instructions INSTALLATION GUIDE

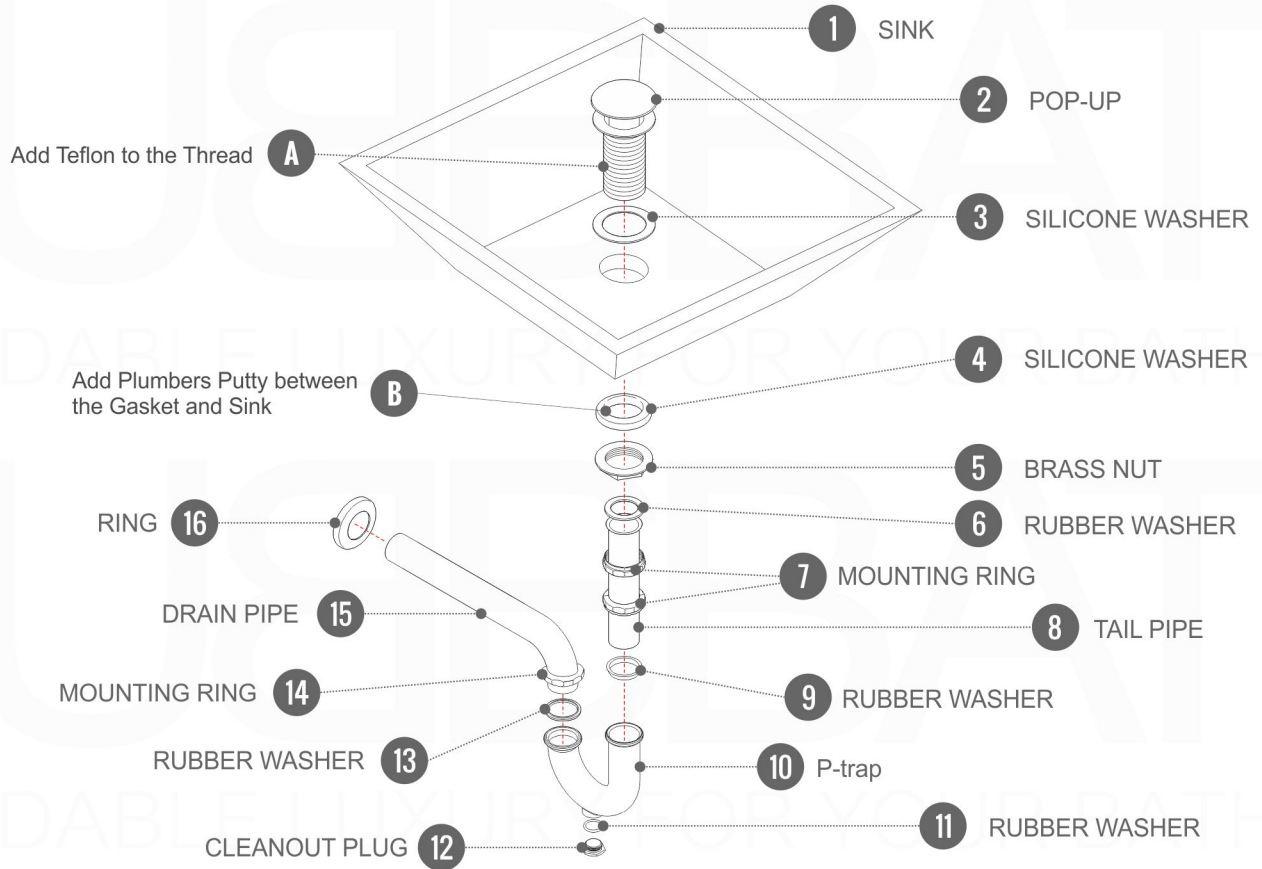

FOR SINKS WITHOUT OVERFLOW
#SKU: P101N / P102N

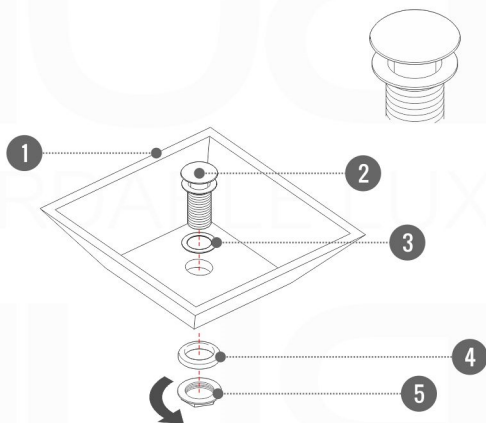

FOR SINKS WITHOUT OVERFLOW
#SKU: P101 / P102

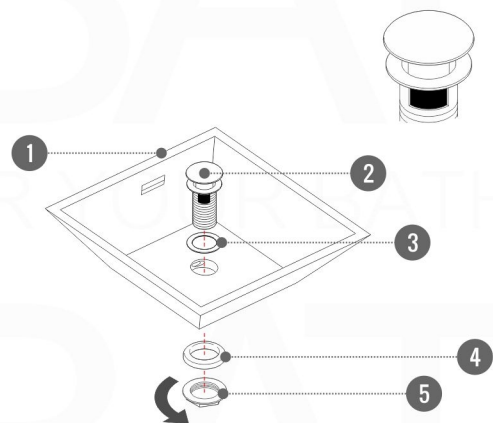

OR