

Maykke™

www.maykke.com

Installation, Care Guide and Warranty



Vanity

YSA1133601	YSA1153601	YSA1156002
YSA1134801	YSA1153602	YSA1157202
YSA1136001	YSA1154801	YSA1157201
YSA1144801	YSA1154802	YSA1163001
YSA1146001	YSA1156001	YSA1163002
YSA1173001	YSA1194801	YSA1197201
YSA1183001	YSA1194812	YSA1213001
YSA1011801	YSA1001801	YSA1031801

NOTICE: Do not change or modify the product in any way. Doing so may compromise the products structural integrity and will void the warranty.

NOTICE: Installation instructions must be followed. Any diversions from the installations instructions may risk property damage and will void the warranty.

NOTICE: When moving your vanity be sure to lift, never slide or pull, doing so may result in damage to the product.

IMPORTANT:

Observe all state and local building codes.

PRE-INSTALLATION

Tools Required



Rubber mallet



Safety goggles



Phillips
screwdriver

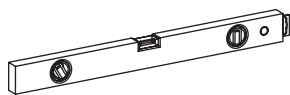

Level

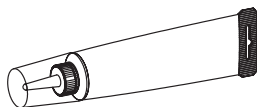

Silicone
Compound

Hardware Included

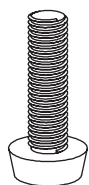

AA



BB

Part	Description	Quantity
AA	Leg levelers (pre-installed on legs)	4
BB	Round pegs for shelf (for vanities with adjustable shelf)	4

Materials Required

Description	Quantity
Wood screws	2
2" x 6" lumber (cut to fit between studs)	1
5/16" Lag Bolts (min. 250lbs) load bearing	2
Washers for Lag Bolts	2

PRE-INSTALLATION (continued)

Package Contents

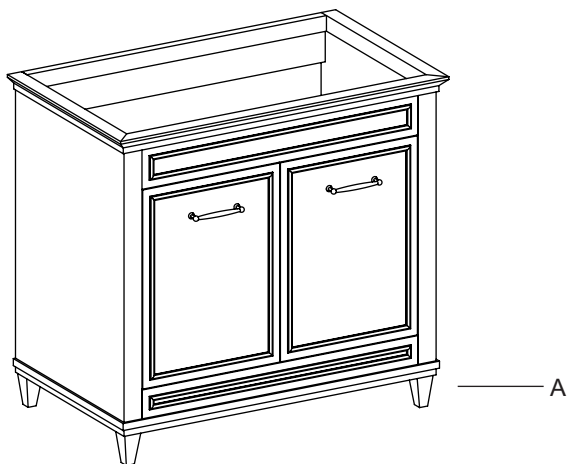

Part	Description	Quantity
A	Cabinet body	1

INSTALLATION

1 Tracing the outline of the vanity (see fig 1)

Determine the ideal location for your new bath furniture.

- ☐ Trace its outline on the wall.
- ☐ Use a stud finder to locate the studs to which you will attach the vanity.
- ☐ With a level, draw lines along the studs from the floor to the top of the vanity. These lines will help you spot where to place the screws in Step 3.

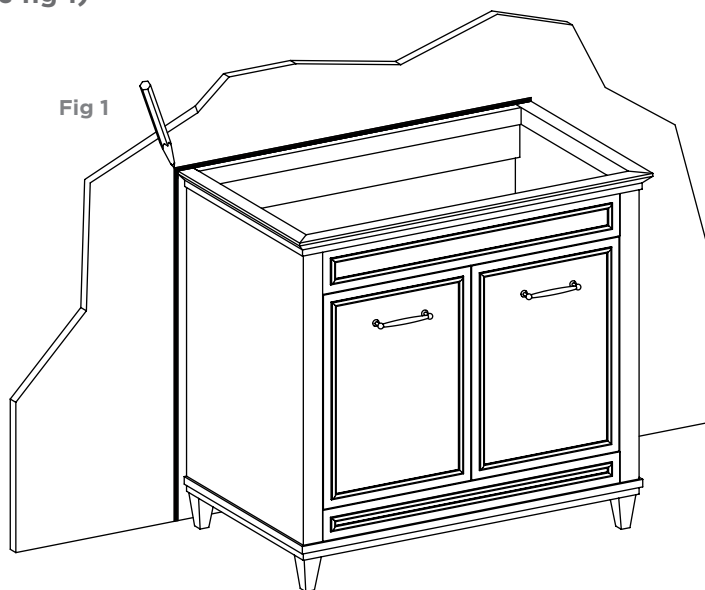

INSTALLATION (continued)

2 Installing support for vanity (see fig 2)

Provide 2x6 backing material behind the finished wall to properly support the vanity.

- To properly secure the vanity, the middle of the required 2x6 backing material must be 31-3/16" from the finished floor.
- Extend the backing material beyond the width of the vanity to the nearest stud. This will ensure proper support for the vanity.
- Front-notch the studs to ensure the 2x6 backing material is flush against the studs.
- Secure the 2x6 backing material to the studs with framing nails.
- Rough-in the water supply and drain lines into the rough-in plumbing areas of the vanity.

Fig 2

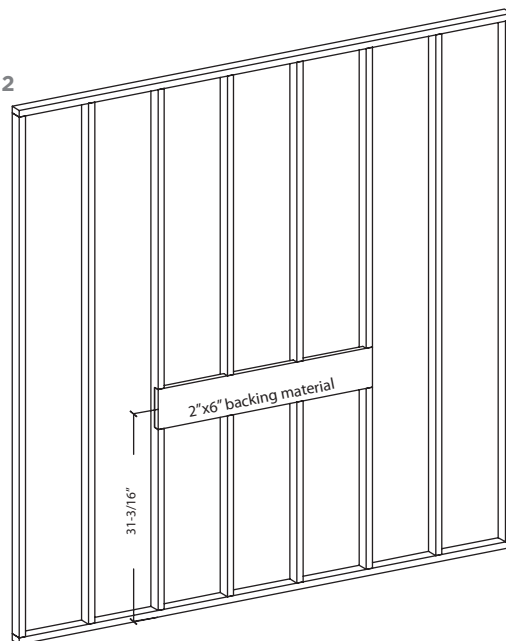

3 Attaching the vanity (see fig 3)

- Verify the vanity is level and the back rail is plumb against the wall. If necessary, turn the leg levelers (AA) to adjust the vanity.
- Using a drill bit, drill two pilot holes through the back rail and the finished wall. Verify the pilot holes are positioned to ensure the lag bolts will engage the 2x6 backing material.
- Secure the vanity to the finished wall with two 5/16" lag bolts and washers (not provided).

Fig 3

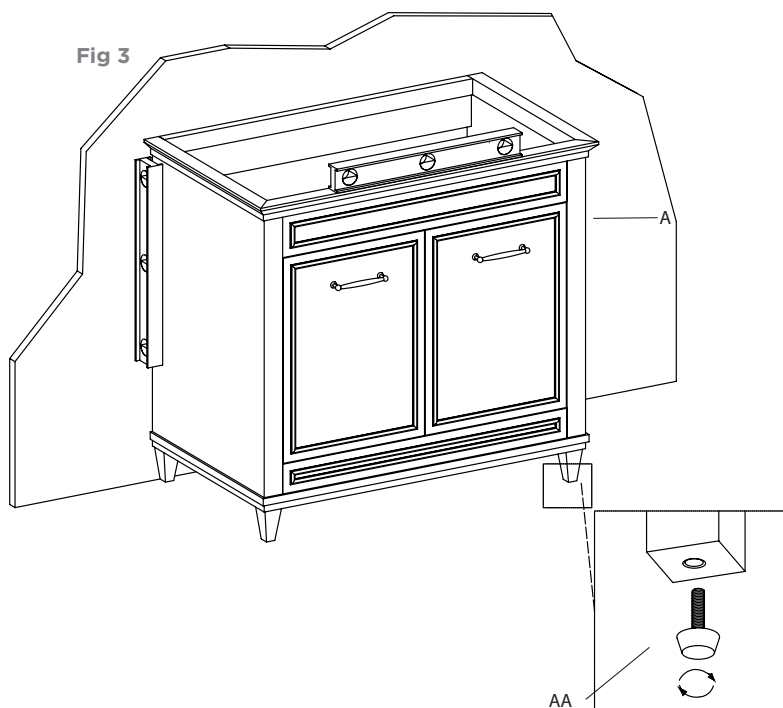

INSTALLATION (continued)

4 Installing the faucet to the vanity top

Follow the manufacturer's instructions to install the faucet and drain assembly to the vanity top.

5 Installing the Sink to the top (If installing Maykke sink)

- Apply a small bead of silicone compound around the sink cut out on the vanity top (C), position the sink (D) on the top (C), pressing firmly together.
- Secure the sink (D) to the top (C) with the screws.

6 Securing the vanity top (If installing Maykke vanity top) (see fig 4)

- Place the vanity top (C) with the sink (D) over the vanity (A).
- Make sure the wall is straight and there are no gaps between the wall and vanity top (C).
- Remove the top (C) and apply a small bead of silicone compound to the top of the vanity before the vanity top is set into position.
- Firmly press the vanity top (C) into position; check the level and evenness across the front of the vanity (A), and make sure the vanity top (C) is flush to the wall.
- Apply silicone compound to the back and bottom of the backsplash (B). Firmly press the backsplash (B) to the vanity top (C) to set into place, then firmly press the backsplash (B) to the wall.

Fig 4

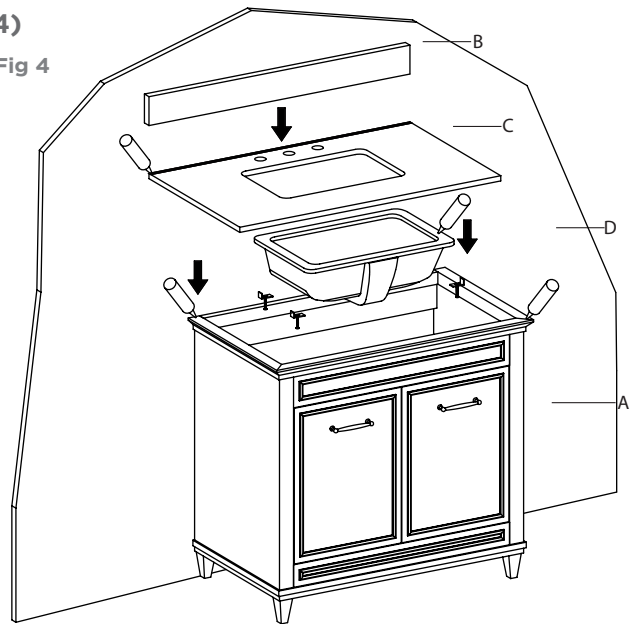

7 Reconnecting the water supply

- **For vanities with shelves only:** Install the 4 round pegs (BB) into the pre-drilled holes inside the vanity and slide the wooden shelf over the round pegs (BB). (see fig 5)
- Reconnect the faucet supply lines to the water supply and reconnect the p-trap.
- Install the drain.
- Turn on the water supply or the home's main water supply and test for leaks.

Fig 5

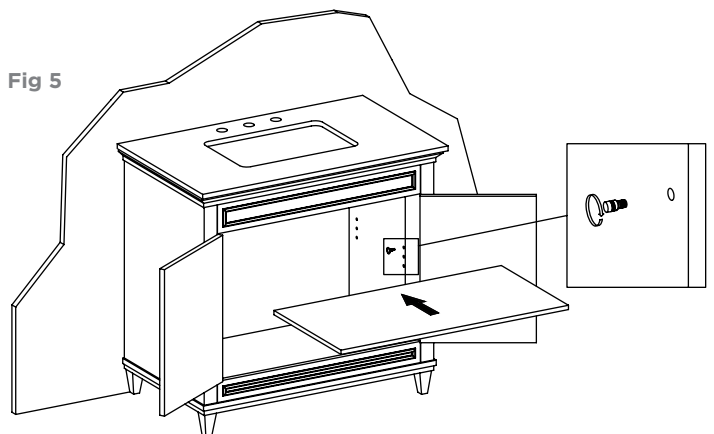

DOOR ADJUSTMENT

LEFT TO RIGHT

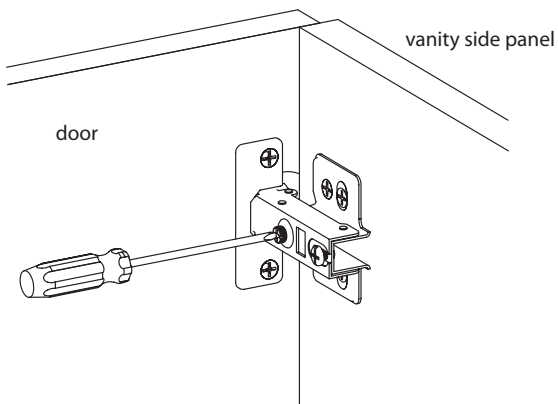

If the gap between the door and vanity side panel needs adjustment, turn the screw closest to the door clockwise or counter clockwise.

Make sure to adjust both the top and bottom hinges to keep the door level.

FRONT TO BACK

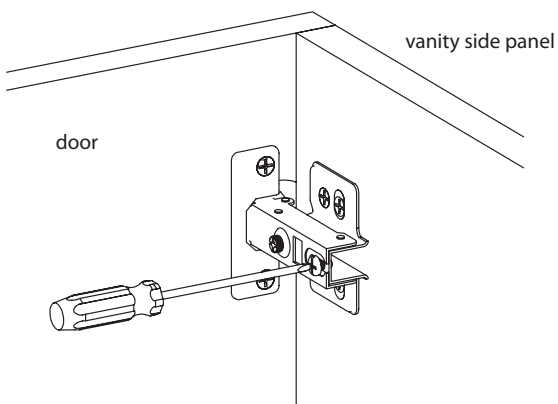

If the door is not aligned perfectly with the vanity frame, turn the screw closest to the vanity side panel clockwise or counter clockwise.

Make sure to adjust both the top and bottom hinges to keep the door level.

UP AND DOWN

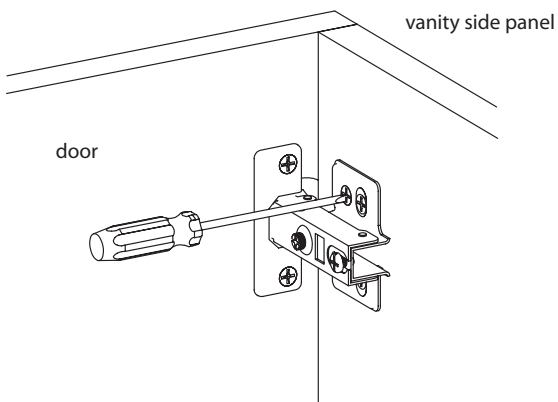

If the gap above or below the door needs adjustment, turn the screw that is mounted to the hinge plate of the vanity side panel.

Loosening the screw allows the door to move up or down.

Both hinges of the door need to be loosened to adjust the door.

Remember to tighten the hinges after the door is in place.

DRAWER ADJUSTMENT

UP AND DOWN

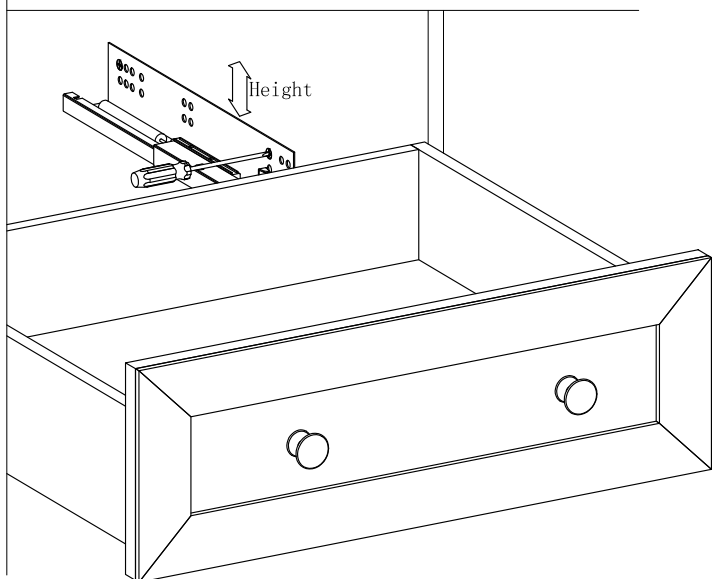

If the gaps above or below the drawer need adjustment, simply turn the screw that is mounted to the glide of the drawer box.

By loosening the screws this gives the drawer box freedom to move up or down.

Remember to tighten the screws after the drawer box is in place.

FRONT TO BACK

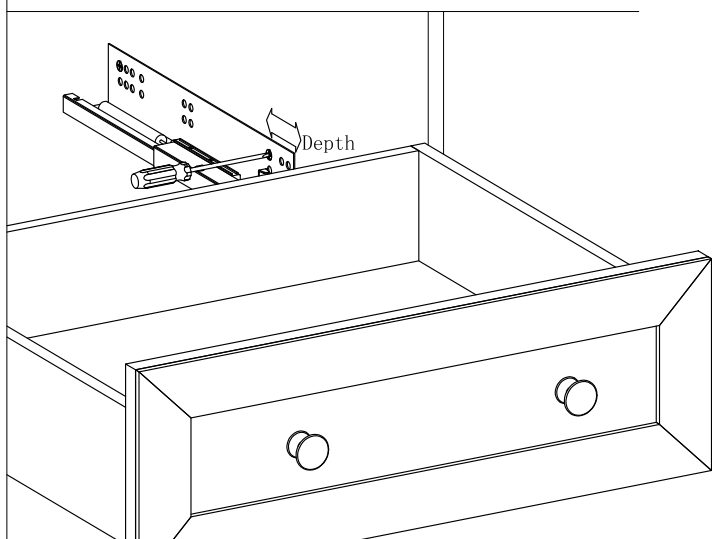

If the drawer is not aligned with the vanity frame, pull the drawer out to its furthest point to reveal the screw closest to you.

By turning the screw clockwise or counter clockwise it will adjust the depth of the drawer.

Adjust the drawer until the face is flush with the vanity frame.

CARE AND CLEANING

Wood

Care: Excess moisture can be damaging to any fine wood finish, be sure to clean up any spills right away.

Over time, exposure to sunlight, smoke and chemicals may cause some finishes to vary from their original color. Cabinets or accessories added at a later date may not match cabinets previously installed. For the same reason, finish samples on displays may not represent the exact color of cabinets received at the time of shipment.

Over exposure to humidity may cause permanent damage to the product. It is very important to dissipate the humidity in the room as soon as possible. If exposed to higher temperatures (excess of 160°) for extended periods of time the heat may be excessive and the doors and drawers should be removed right away.

Cleaning: Dust Cabinets using a soft, lint-free cloth. When needed, clean the vanity with a clean damp cloth, wiping dry with another clean soft cloth. A non-silicone based furniture cleaner can be used periodically when additional cleaning is needed.

Vitreous China

Care: Rinse thoroughly and use a soft cloth to wipe the product dry after each use to prevent hard water stains.

Cleaning: Soft abrasive cleaners may be used when necessary.

Granite or Marble Tops

Care: Natural stone is a porous material; and may stain if not properly cared for. Stone tops should be sealed before using. Follow the instructions on the sealer label.

Cleaning: For best results use a natural stone cleaner and follow the directions on the label.

Quartz Tops

Care: Quartz is an easy material to maintain. It is a non-porous material that is highly resistant to staining, scratching, and heat. Though non-porous, it is not stain, scratch, or heat proof. Spills should be cleaned as soon as possible.

Cleaning: For best results use warm water with a small amount of non-abrasive cleaner that does not contain bleach.

WARRANTY

WHAT IS COVERED

All products in the package carry a One-Year Limited Warranty. This warranty applies only to the original purchaser and to the original installation of the product.

WHAT IS NOT COVERED

Damage caused during moving or during installation is not a defect or warranty issue and will not be considered as such. This warranty does not cover product failure caused by abusive treatment, surface scratches, misuse, neglect or damage due to handling or faulty installations. All wood naturally ages, darkens, changes in color, and mellows over time due to exposure to light. While this color change is imperceptible from day to day, it may be significant over a long period of time, or due to amount of light the wood is exposed to. Imperfections such as small surface splits, small dark holes or darker mineral streaks are natural and are not considered defects.

Contact support@maykke.com or call toll free 1 (877) 659-2858 M-F 7:30am - 4:30pm (PST) with any questions or warranty concerns

