

PARTS LIST / LISTE DES PIÈCES / LISTA DE PIEZAS

ITEM NO. / ARTICLE NO. / ARTICULO NO. : P294128 / 127

DESCRIPTION / DESCRIPCIÓN : MASTER CHEST DECK / PARTIE SUPÉRIEURE DE COMMODE / PARTE SUPERIOR DE CÓMODA
MASTER CHEST BASE / BASE DE COMMODE / BASE DE CÓMODA

WARNING



Children have died from furniture tip-over. To reduce the risk of furniture tip-over :

- ALWAYS install tipover restraint provided.
- NEVER put a TV on this product.
- NEVER allow children to stand, climb or hang on drawers, doors, or shelves.
- NEVER open more than one drawer at a time.
- Place heaviest items in the lowest drawers.



*This is a permanent label.
Do not remove !*



H

x1 Master Chest Deck
x1 Partie supérieure de commode
x1 Parte superior de Cómoda

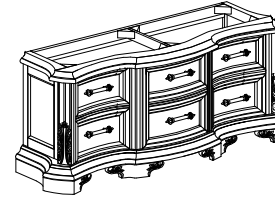

I

x1 Master Chest Base *
x1 Base de Commode
x1 Base de Cómoda



J

x2 Bracket *
x2 Ferrure
x2 Ménsula



A

x4 Allen Bolt Ø1/4" x 25mm *
x4 Vis à tête creuse hexagonale
Ø1/4 " x 25mm
x4 Perno Allen Ø1/4 " x 25mm



B

x2 Allen Bolt Ø1/4" x 70mm *
x2 Vis à tête creuse hexagonale
Ø1/4 " x 70mm
x2 Perno Allen Ø1/4 " x 70mm



C

x6 Lock Washer Ø1/4" *
x6 Rondelle de blocage Ø1/4 "
x6 Arandela de seguridad Ø1/4 "



D

x6 Flat Washer Ø1/4" *
x6 Rondelle de plate Ø1/4 "
x6 Arandela plana Ø1/4 "

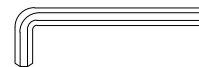

E

x1 Allen Key 4mm *
x1 Clé hexagonale 4mm
x1 Llave allen 4mm



F

x1 Long Allen Key 4mm x 100mm *
x1 Clé hexagonale 4mm x 100mm
x1 Llave allen 4mm x 100mm



G

x2 Anti-tipping Restraint *
x2 Systeme antibasculent
x2 Control para evitar vuelcos

* Replaceable Part



ASSEMBLY INSTRUCTIONS / NOTICE DE MONTAGE / INSTRUCCIONES DE MONTAJE

ITEM NO. / ARTICLE NO. / ARTICULO NO. : P294128 / 127

DESCRIPTION / DESCRIPCIÓN : MASTER CHEST DECK / PARTIE SUPÉRIEURE DE COMMODE / PARTE SUPERIOR DE CÓMODA
MASTER CHEST BASE / BASE DE COMMODE / BASE DE CÓMODA

WARNING



Children have died from furniture tip-over. To reduce the risk of furniture tip-over :

- ALWAYS install tipover restraint provided.
- NEVER put a TV on this product.
- NEVER allow children to stand, climb or hang on drawers, doors, or shelves.
- NEVER open more than one drawer at a time.
- Place heaviest items in the lowest drawers.

This is a permanent label. Do not remove !

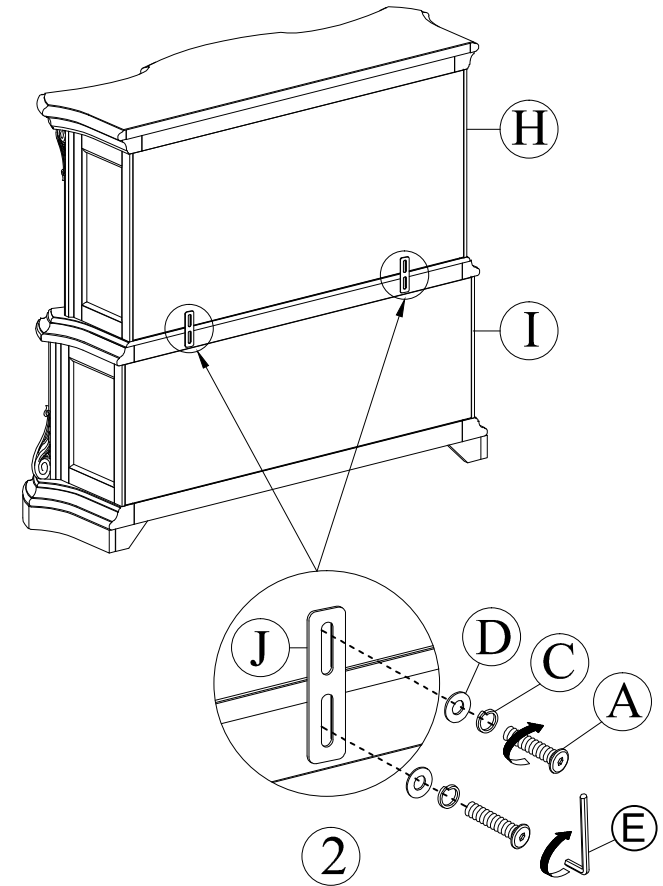
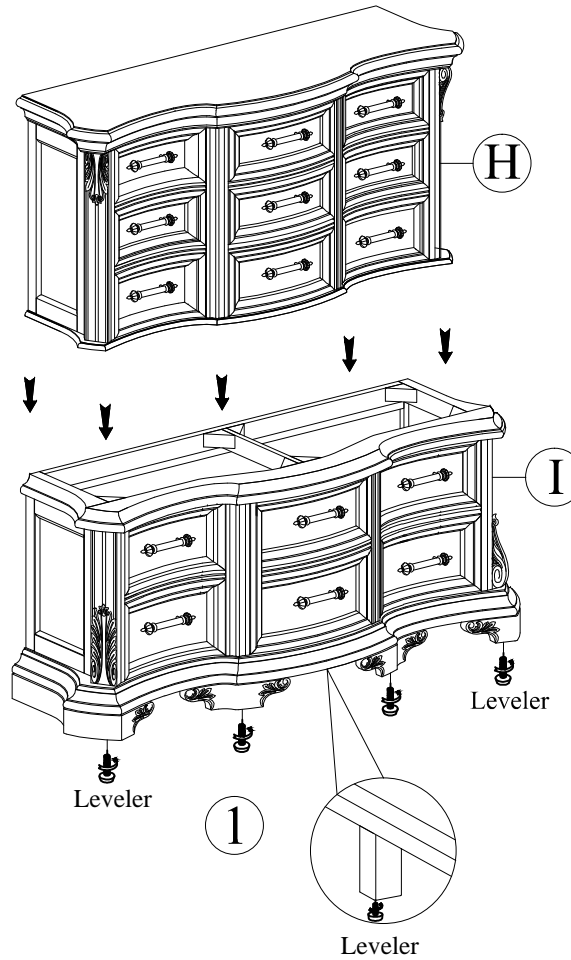

* Replaceable Part

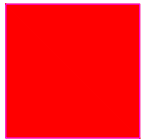

ASSEMBLY INSTRUCTIONS / NOTICE DE MONTAGE / INSTRUCCIONES DE MONTAJE

ITEM NO. / ARTICLE NO. / ARTICULO NO. : P294128 / 127

DESCRIPTION / DESCRIPCIÓN : MASTER CHEST DECK / PARTIE SUPÉRIEURE DE COMMODE / PARTE SUPERIOR DE CÓMODA
MASTER CHEST BASE / BASE DE COMMODE / BASE DE CÓMODA

WARNING



Children have died from furniture tip-over. To reduce the risk of furniture tip-over :

- ALWAYS install tipover restraint provided.
- NEVER put a TV on this product.
- NEVER allow children to stand, climb or hang on drawers, doors, or shelves.
- NEVER open more than one drawer at a time.
- Place heaviest items in the lowest drawers.

*This is a permanent label.
Do not remove !*

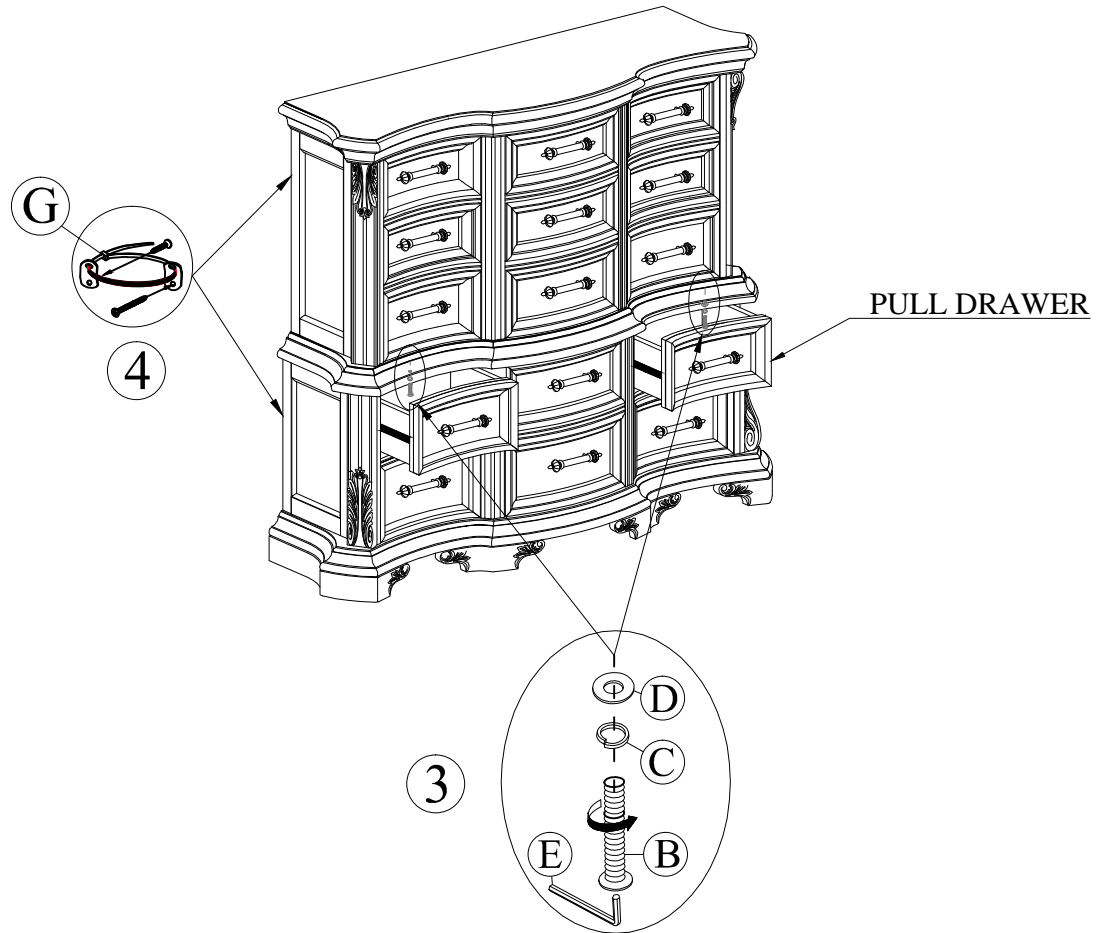

* Replaceable Part



REPLACEABLE PART / PARTIE REMPLACABLE / PARTE REEMPLAZABLE

ITEM NO. / ARTICLE NO. / ARTICULO NO. : P294128 / 127

DESCRIPTION / DESCRIPCIÓN : MASTER CHEST DECK / PARTIE SUPÉRIEURE DE COMMODE / PARTE SUPERIOR DE CÓMODA
MASTER CHEST BASE / BASE DE COMMODE / BASE DE CÓMODA

WARNING



Children have died from furniture tip-over. To reduce the risk of furniture tip-over :

- ALWAYS install tipover restraint provided.
- NEVER put a TV on this product.
- NEVER allow children to stand, climb or hang on drawers, doors, or shelves.
- NEVER open more than one drawer at a time.
- Place heaviest items in the lowest drawers.

*This is a permanent label.
Do not remove !*

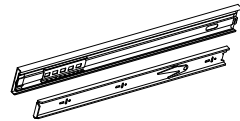

x15 COMGLIDE-12-45
Common Glide 12 inch 45 mm *
Glissière
Carril de deslizamiento

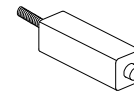

x1 RP294127-CELEG *
Center Leg Support *
Support central
Soporte para la pata central



x1 RC-ANTI-TIP *
Anti-tipping Restraint *
Systeme antibasculement
Control para evitar vuelcos

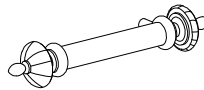

x15 RP294100 PULL
Pull with screw *
Poignée et vis
Tirador y Tornillo



x4 RC-FG-White
White Leveler *
Patin réglable
Nivelador



x2 RC-WH-NAIL *
White Plastic Nail *
Clou en plastique
Clavo de plástico

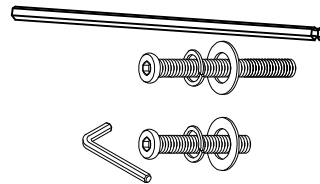

x1 RP294-128-HWKIT *
Hardware Kit *
Kit de matériel
Kit de hardware



x2 RP294-128-BRACKET *
Bracket *
Ferrure
Ménsula

* Replaceable Part