

FreeMotion®

Motion Furniture...Unplugged



Assembly Instructions for Radius Recliner powered by FreeMotion

Parts:

A	Battery Output
B	Motor Connection

1. Underneath chair, connect Battery Output (A) to Motor Connection (B)
 2. Tuck wires inside zipper compartment
 3. Attach back and adhere back flap to frame for a smooth finished look
 4. You may access battery and all connections through zipper located under left arm.
- For trouble shooting, please refer to your FreeMotion battery owner's manual or visit www.freemotionbattery.com.

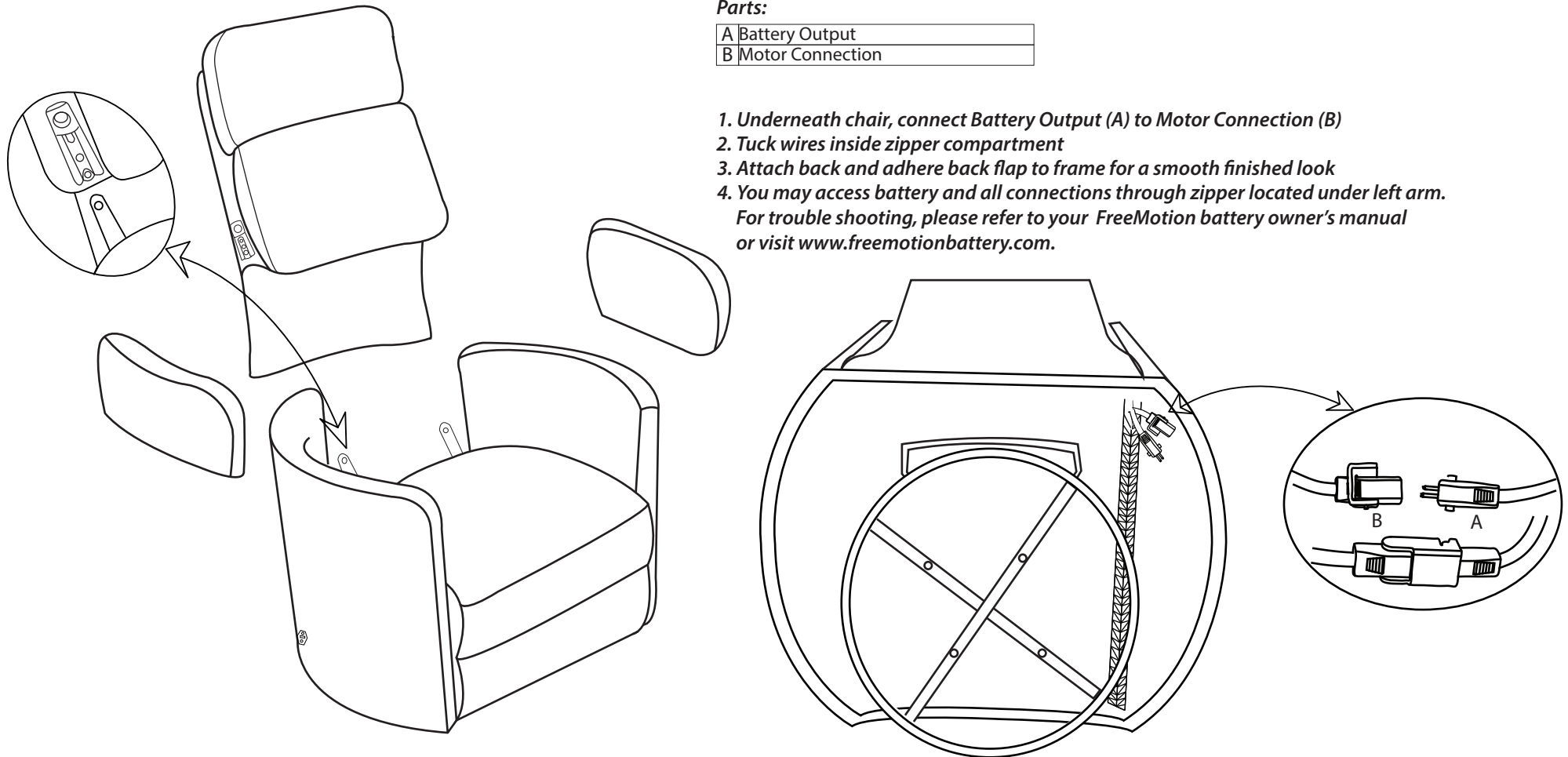

For further information, including installation videos, please visit www.freemotionbattery.com

Parker Living
A Division of Parker House



