

SHOWER SCREEN WITH DOUBLE SLIDING DOOR INSTALLATION INSTRUCTIONS

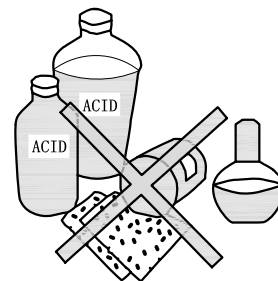
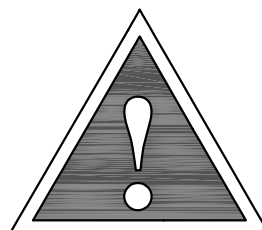
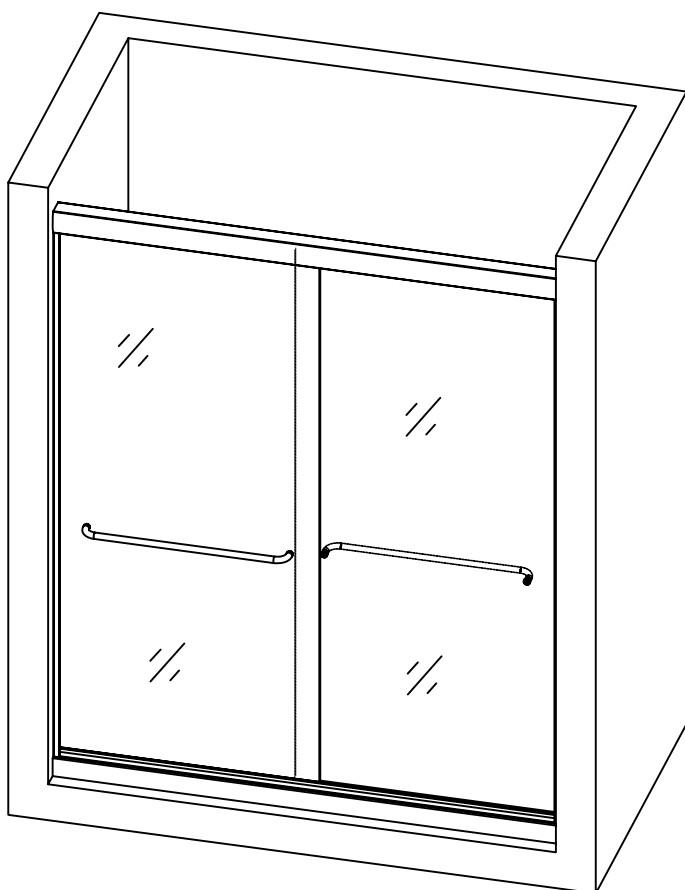

Maintenance tip:

The following substances or articles may cause physical harm and/or damage the shower door.

Do not use them for cleaning:

Acid and alkaline solvents, chemicals such as hydrochloric acid, acetone thinner, solvents, cleansers, or polishers, nylon brooms or sandpaper.

Our product may have changes without prior notice

PREPARATION

1. WE STRONGLY RECOMMEND THAT A LICENSED AND INSURED PROFESSIONAL CONTRACTOR TO INSTALL THIS PRODUCT INCLUDING THE ASSISTANCE OF A SECOND PERSON DURING INSTALLATION.
2. After opening all boxes and packages, read this introduction carefully. Check that all of the needed parts are included in the package by marking all the components on the "Detailed Diagram of Shower Door Components". Examine boxes and packages for shipping damage. If the unit has been damaged, has a finishing defect, or is missing parts, please contact our customer support department to be served immediately. Please note that We will not replace any damaged products or missing parts free of charge after 5 business days or if the product has been installed. Feel free to contact your local distributor if you have any questions.
VERY IMPORTANT: Please double check the glass corner and four edges of the glass door and fixed panel to make sure that all the glass are in perfect condition and without any breakage. Please do not try to install the shower door, if there is breakage to the glass corner.
3. Please note that you should consult your local building codes with questions on installation compliance standards. Building and plumbing codes may vary by location, and We are not responsible for code compliance standards for your project and will not accept any returns.
4. Prior to installation, ensure that the installation surface is leveled and solid and will be able to support the total weight of the unit. Also, make sure the walls are at the right angles. Irregular installation surface level or improper angle of side walls will result in serious problems during installation. Please, note that some adjustments and drilling might be necessary during the installation process.
5. **NOTE!** This door does not have out-of-plumb adjustment. Make sure your walls are at right angles.
6. This door requires a minimum 2 3/4" wide threshold, base or installation space. Please note that Step 6 calls for installation of the door to the wall using anchors. However, the manufacturer strongly recommends installing these heavy doors to the studs or to preinstalled 2" x 4" wood reinforcements behind the wall and attach the Wall brackets to it.

ATTENTION: THIS DOOR IS EXTREMELY HEAVY AND REQUIRES PROFESSIONAL INSTALLATION. INSTRUCTIONS ARE GIVEN FOR THE SHOWER DOOR INSTALLATION. PLEASE, FOLLOW THE SAME INSTRUCTIONS TO INSTALL THE GLASS DOOR. INSTRUCTIONS THAT, IF IGNORED, COULD RESULT IN DEATH OR SERIOUS PERSONAL INJURY CAUSED BY INCORRECT HANDLING OR INSTALLATION OF THE PRODUCT. THESE INSTRUCTIONS MUST BE OBSERVED FOR SAFE INSTALLATION.

TOOLS REQUIRED



Soft Cloth
or Blanket

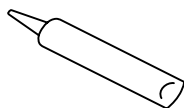

Caulk

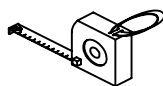

Tape
Measure

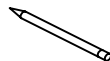

Pencil

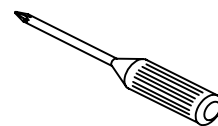

Phillips
Screwdriver



Drill Bit
= Ø8



Safety Glass

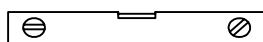

Level

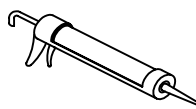

Caulk Gun

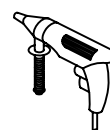

Drill

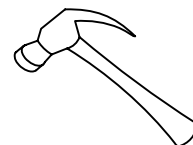

Hammer

OTHER TOOLS MAY BE REQUIRED

Diagram of Enclosure Components

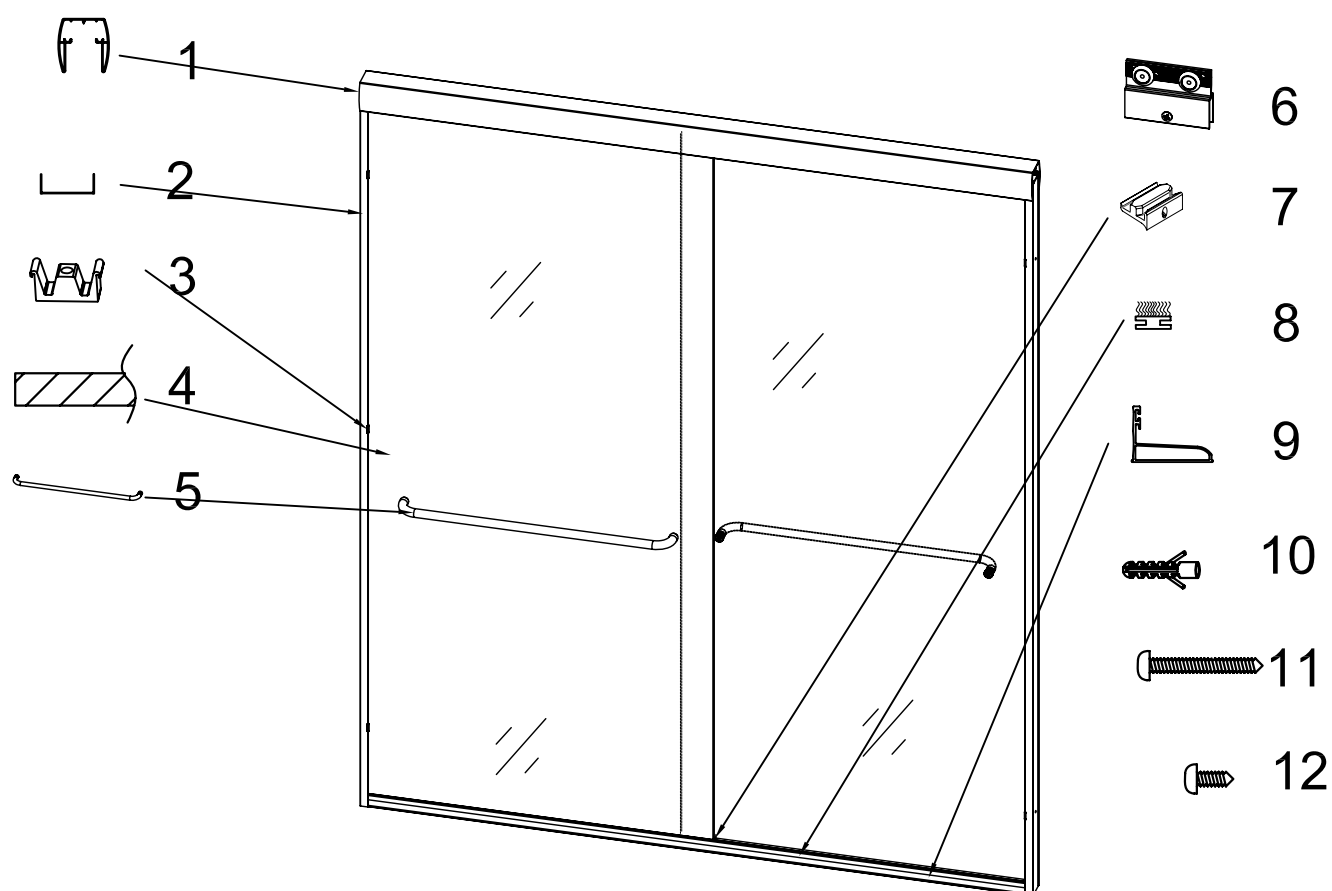

Packing List

1	Upper Guide Rail	1pc
2	Wall Profile	2pcs
3	Glass Stopper	6pcs
4	Glass Door	2pcs
5	Handle	2pcs
6	Wheel	4pcs
7	Guide Block	1pc
8	Top wool	1pc
9	Bottom Guide Rail	1pc
10	Wall Anchor	6pcs
11	Round Head Screw M4x60	6pcs
12	Round Head Screw M3.5X10	1pc

Now you have checked that all components are here, you are now ready to start the installation of your shower enclosure.

WARM TIPS

01:

Open the packaging carefully and inspect all the necessary parts using detailed diagram and component list in your manual as a reference. Before discarding the carton, check for small hardware bags that tend to fall to the bottom of the box. If any parts are damaged or missing, please contact us for replacement.

02:

Retain these installation instructions for future use if in need.

1. Measure the distance between two finished walls. This distance is marked as W .

Please see Fig 1 for details:

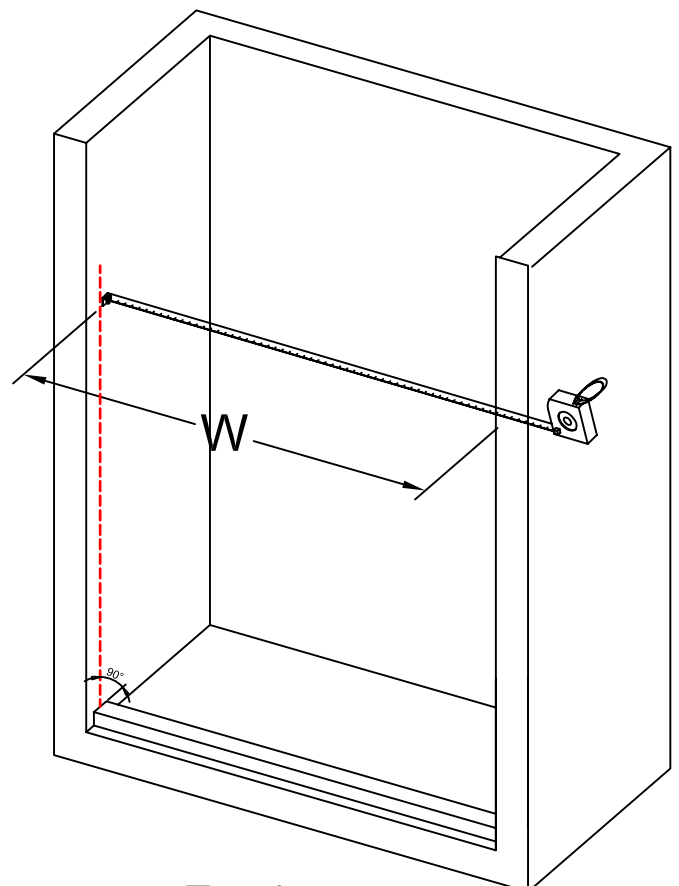
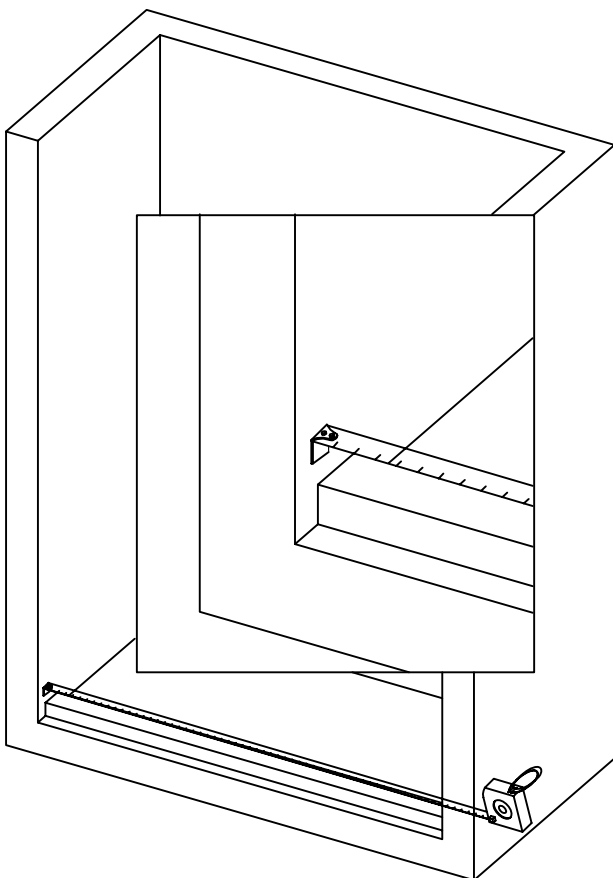
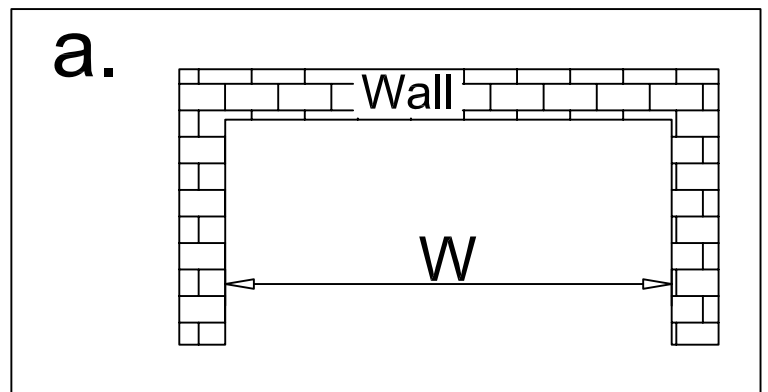

Fig 1

2. Your Upper Guide Rail (1) and Bottom Guide Rail (9) have been precut for your Shower model opening width, eg.60" for shower width.
If W-width of your wall-to-wall opening is equal to the size of your Shower model, it is unnecessary to cut the Upper Guide Rail and Bottom Guide Rail and you can continue to Step 3.

If W-width of your wall-to-wall opening is less than the size of your shower model, you will need to cut the Upper Guide Rail(1)and Bottom Guide Rail(9).

1. Cut the Upper Guide Rail(1) at one side only

2. Cut the bottom Guide Rail(9) **both side**

The length to cut off will be L:

$L = \text{Shower model size} - W$
L=Subtract W from the size of your Shower model.

FOR EXAMPLE

If your wall opening $W=59"$. Your shower model is 60".

$L=60"-59"=1"$,

You have to cut 1" off from the rail.

Please see Fig 2 for details:

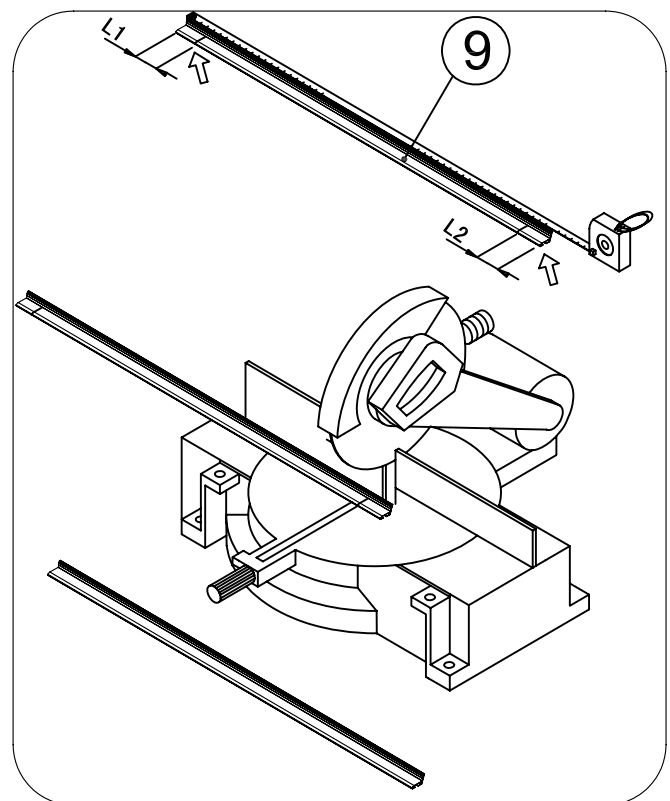
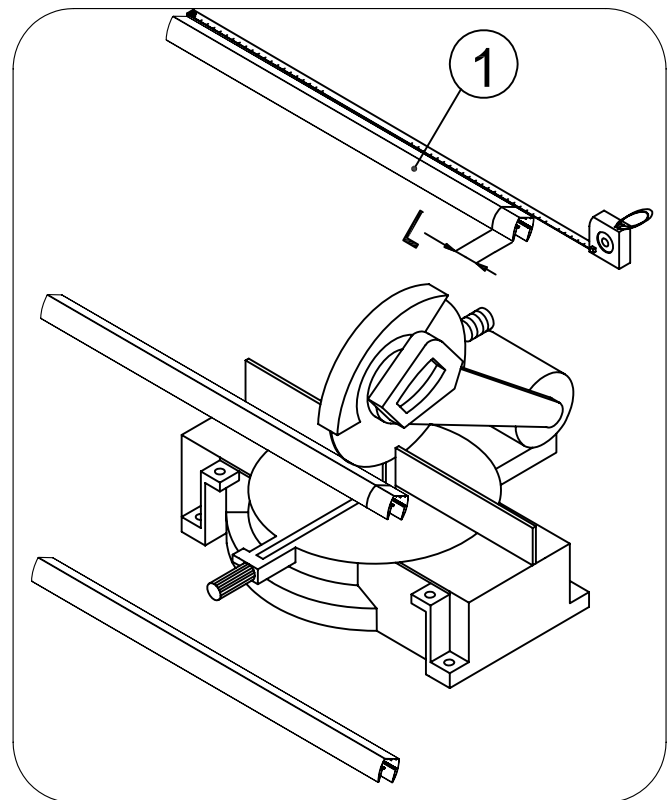

Fig 2

3. Put the tray or threshold at the designated position and level it.

Please see Fig 3 for details:

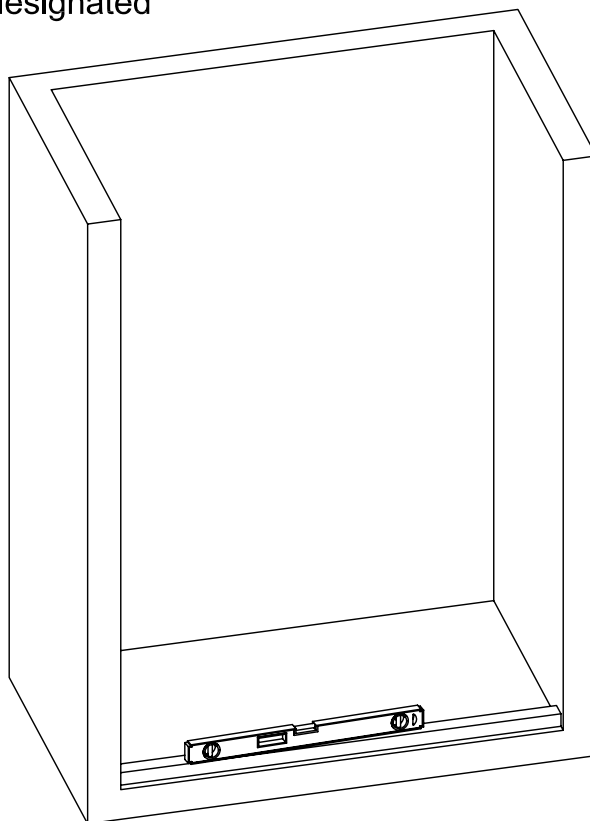
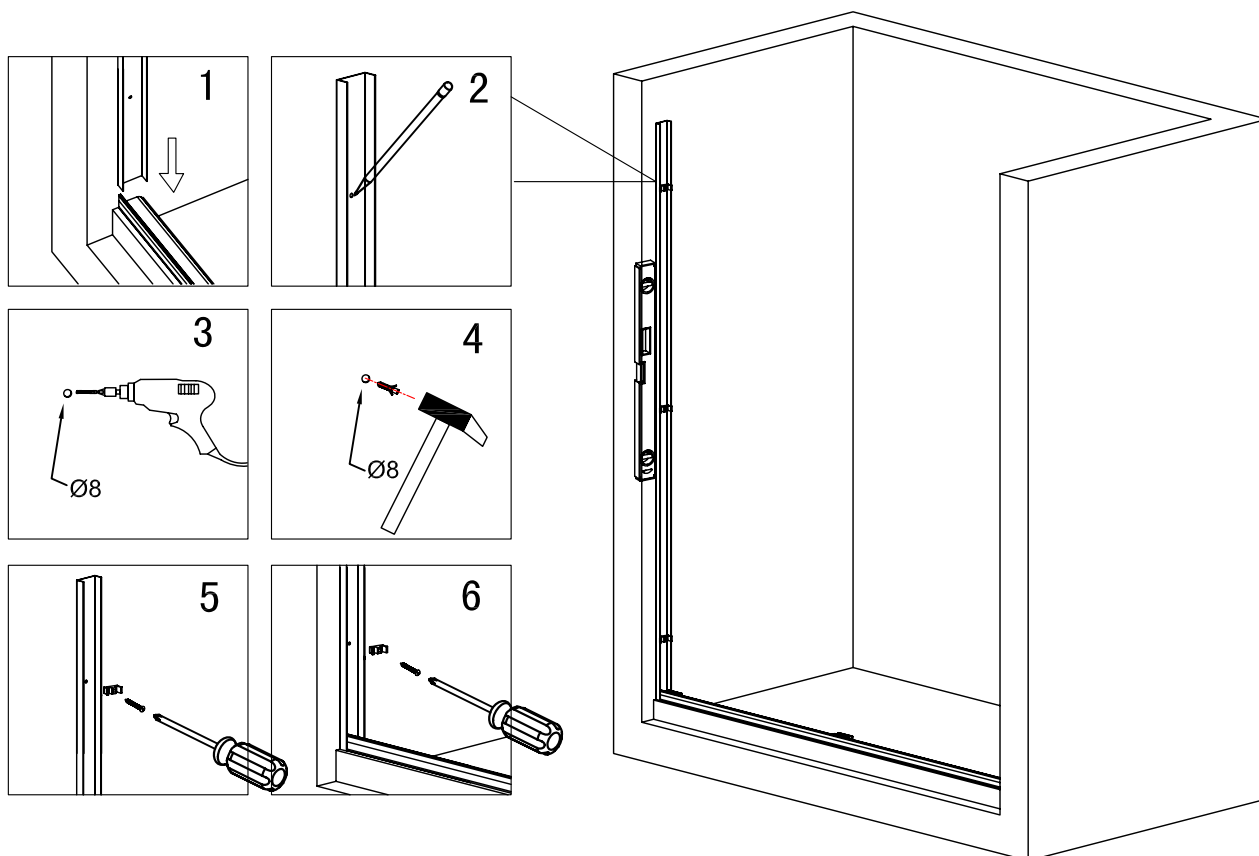

Fig 3



4. Place the **bottom guide rail (9)** onto the shower tray or threshold, put the **wall profile (2)** into the **bottom guide rail (9)**. Now make the marks through the predrilled holes on the aluminum profile for drilling. Now drill the holes with drill bit ($\Phi 8\text{mm}$) and insert the **wall anchor (10)**. Secure the **wall profile (2)** to the wall with **round head screw M4X45 (11)**.

Please see Fig 4 for details:

Fig 4

5. Install another wall profile (2) according to above processes.

Please see Fig 5 for details:

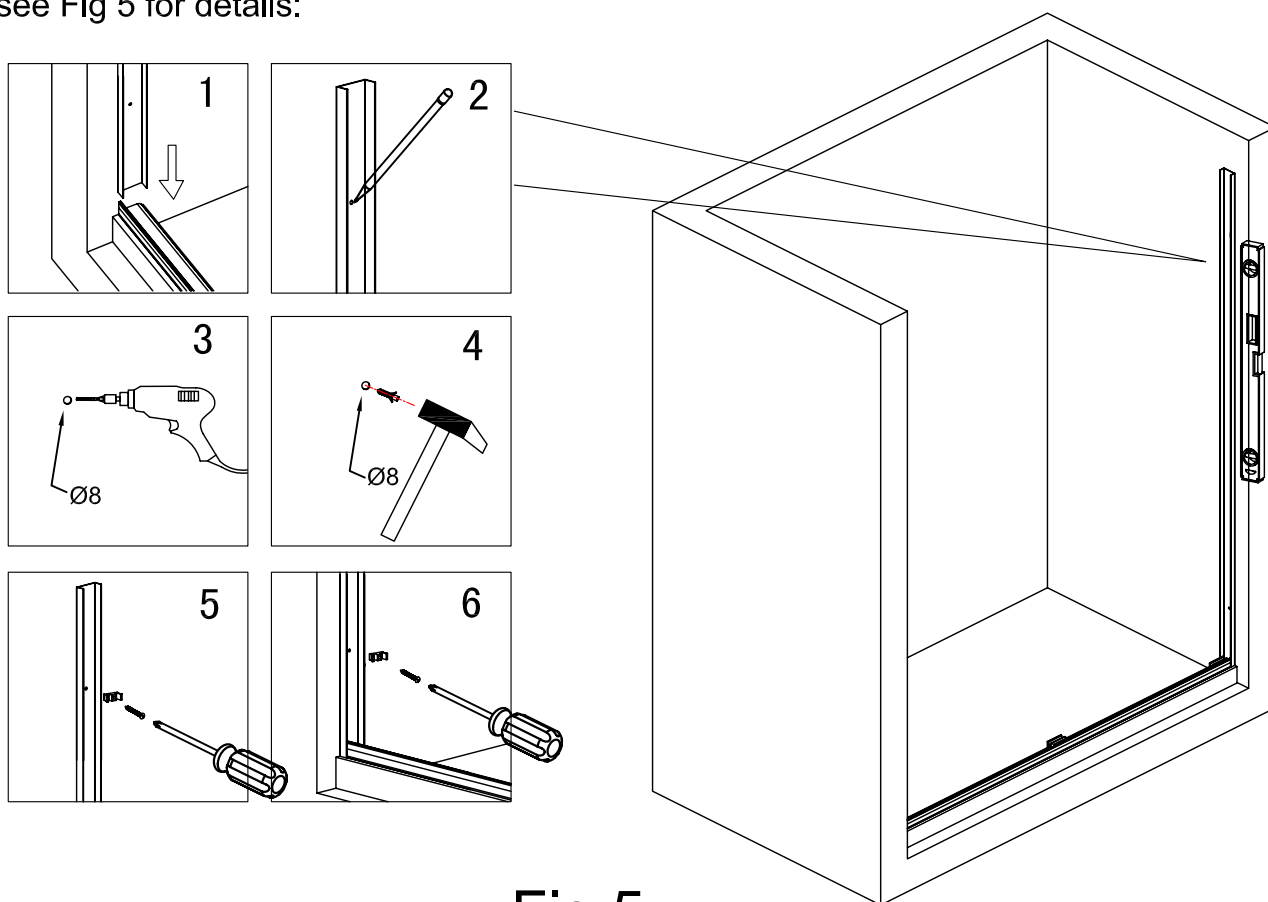
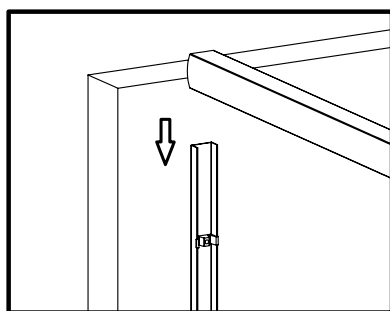

Fig 5



6. Put the upper guide rail (1) into the top part of the wall profiles (2) and make sure that the upper guide rail matches well with the profiles.

Please see Fig 6 for details:

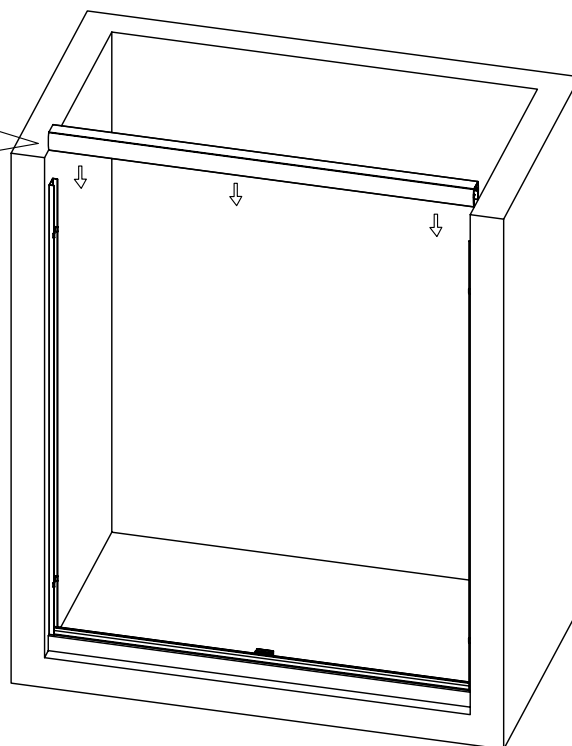

Fig 6

7. Install the wheel (6), handle (5) to the glass door (4).

Please see Fig 7 for details:

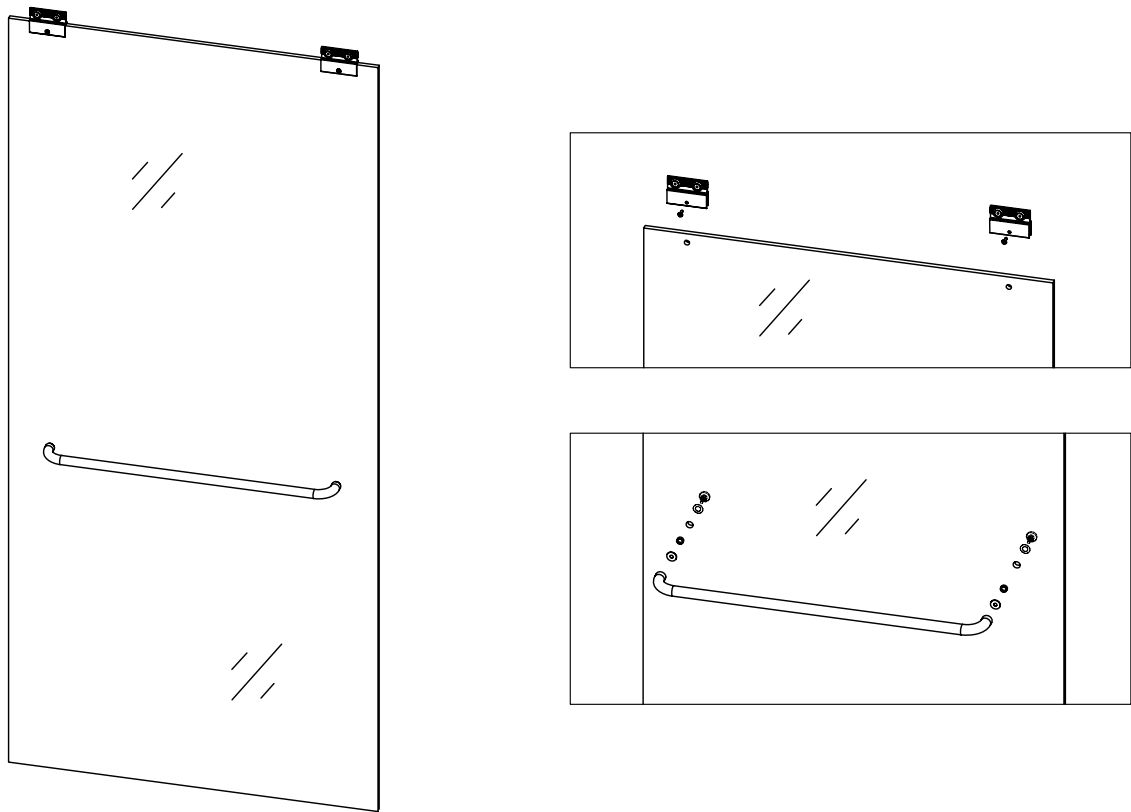
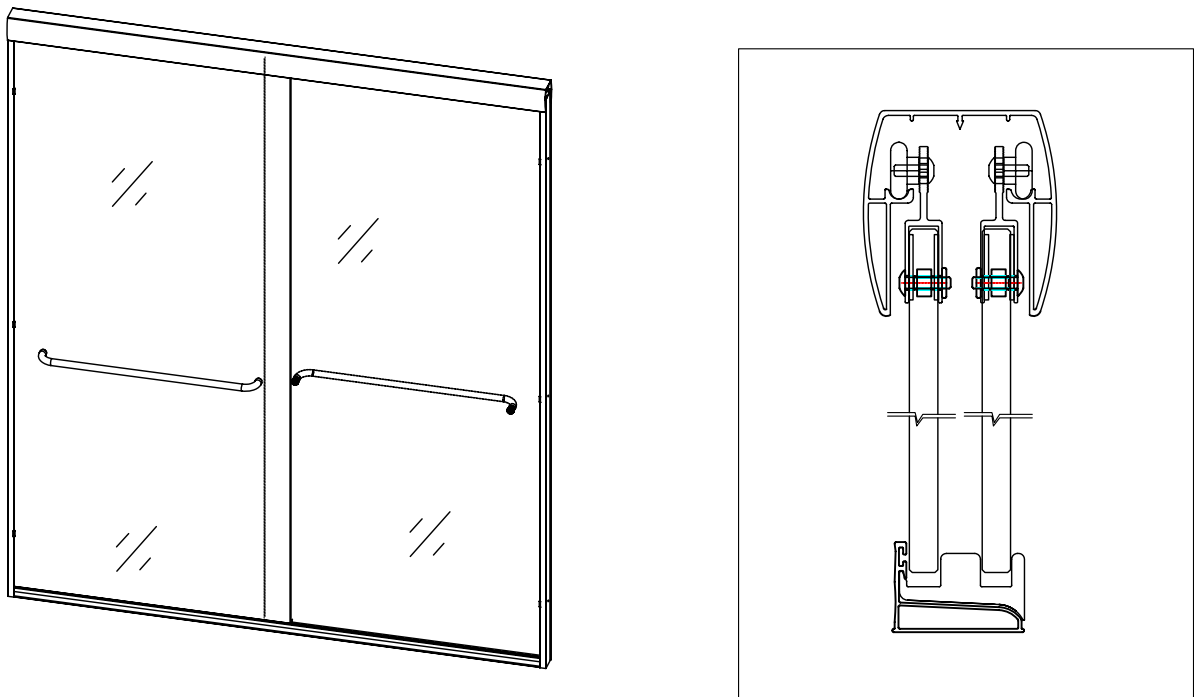

Fig 7



8. Now suspend the wheel with glass door into the track of the upper guide rail (1).
Slide the bottom of the glass door (4) into the guide block (7).

Please see Fig 8 for details:

Fig 8

9.Seal with silicone caulk between wall, glass and tray or ground.

Please see Fig 9 for details:

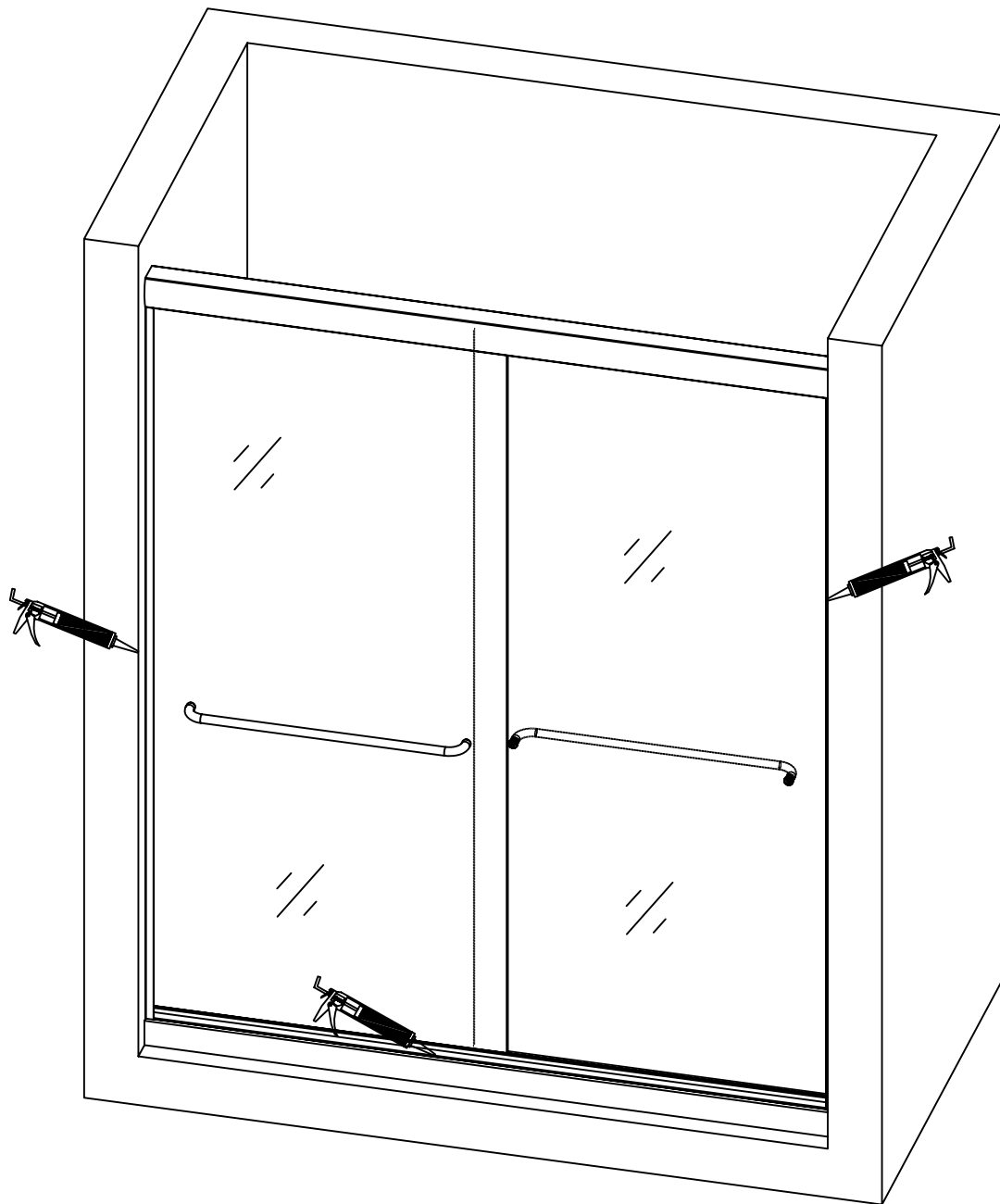

Fig 9

WAIT 24 HOURS BEFORE USING THE SHOWER ENCLOSURE .