

Maximum load claim
Whole shelf set:Holds up to 11.8lbs(5.4 kg)

WALL SHELF SKU: BR14023

with keyholes

TOOLS NEEDED

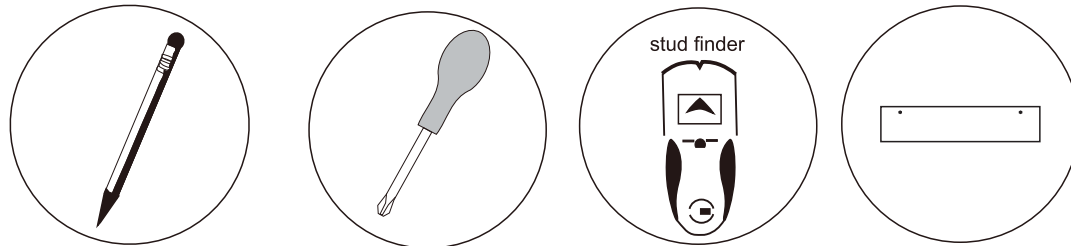

HARDWARE

plastic dry wall anchor
Size:6mmØ×30mm L

philip head screws
Size:4mm dia. × 30mm L

stud mounting screw
Size:4mmØ×50mm L

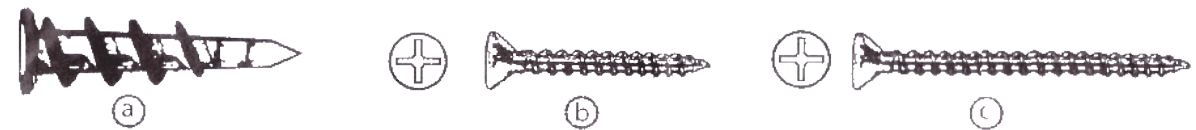

NOTE:

- For drywall mounting, use anchors with screws.
- For stud mounting, use stud mounting screw.
- If walls are concrete or plaster, please consult your local hardware store.

STEP1

Assemble those two parts together

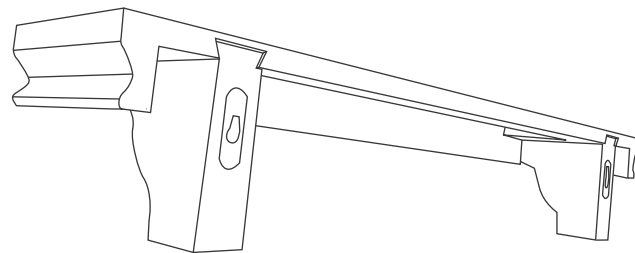

STEP2

Drywall Mounting(2a)Determine placement of shelf on wall. Using the enclosed paper template, stick it on the wall at the desired position to determine the location of the screws. Drill a 2mm (3/32") hole through the paper into the wall for each screw needed. Remove paper template from the wall.

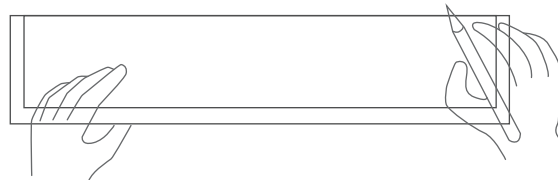

STEP3

Dry wall mounting:(3a)Place Philips screw driver into anchor (a). Press the anchor into wall, then turn clockwise until anchor is flush with the wall.

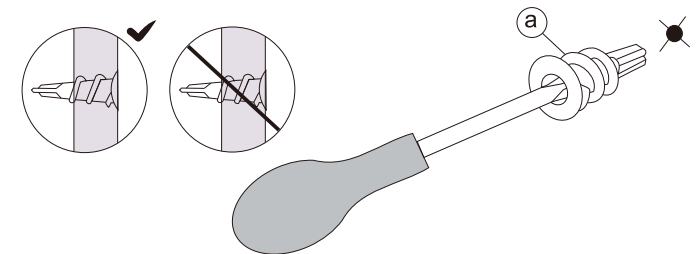

Stud Mounting(2b)Using a stud finder, locate and carefully mark the location of studs on the wall where you want to hang your shelf.
Note: It is best to mount the shelf to at least one stud.

Stud Mounting:(3b) Skip to step 4

STEP 4

Dry wall mounting:(4a) Insert screws (b) into anchors.

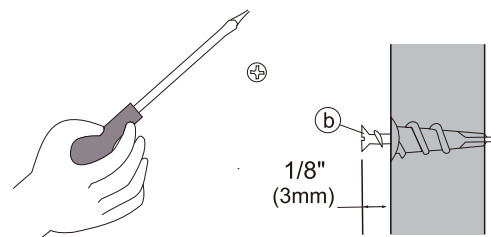

STEP 5

Hang shelf.

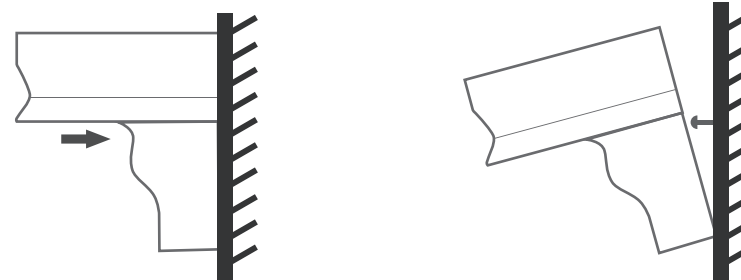

NOTE: Tighten screw and re-hang

Stud Mounting:(4b)Using Philips