

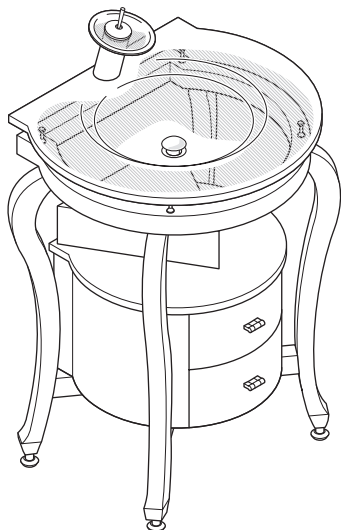

FVN3330
SIMPATICO
INSTALLATION GUIDE

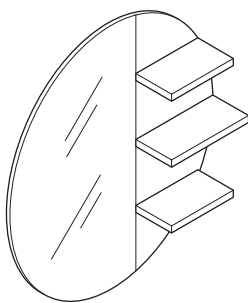

FRESCA®



Vanity Front

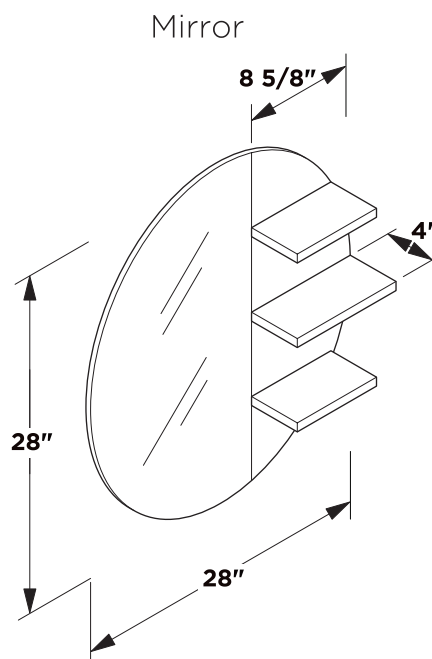

Vanity Back

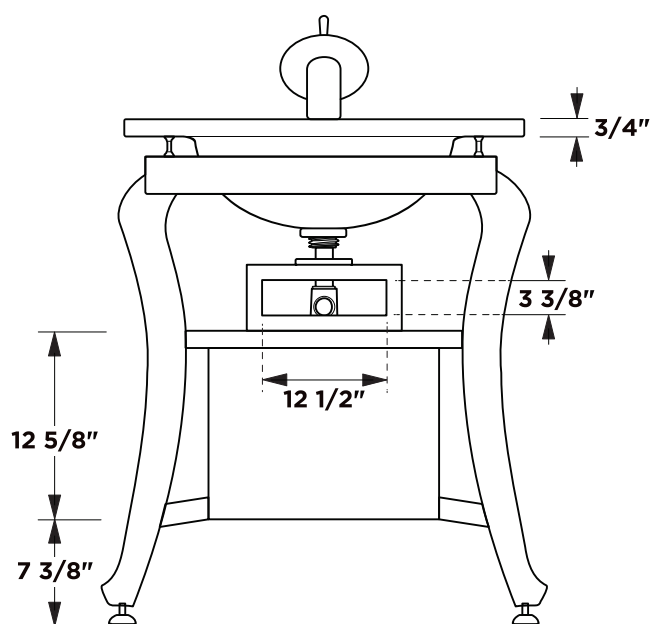
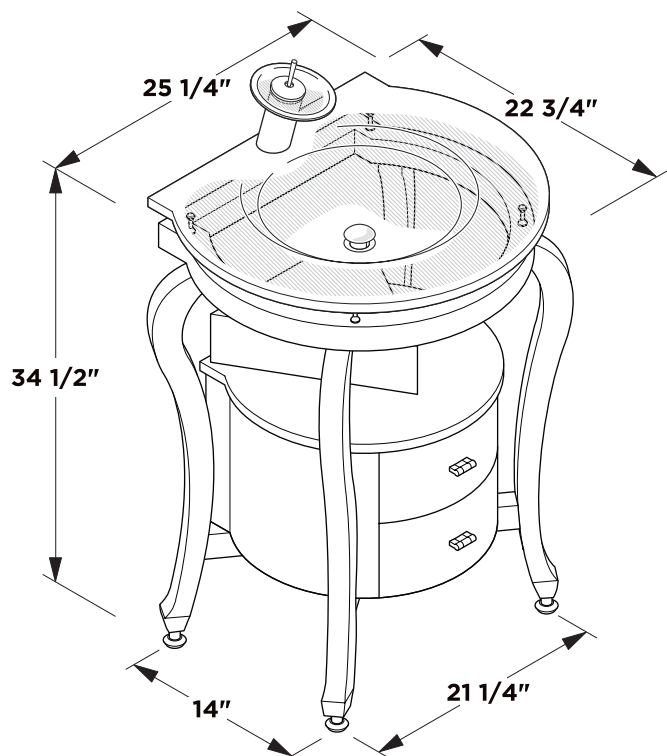

Note: All dimensions and specifications are approximate and subject to change without notice.



SIMPATICO INSTALLATION GUIDE

PAGE 1

TOOLS FOR ASSEMBLY

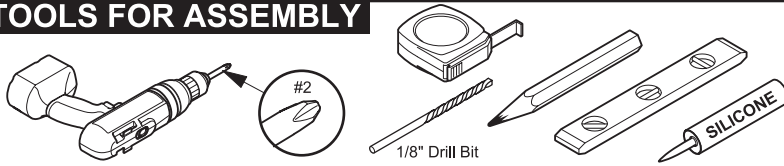

PARTS

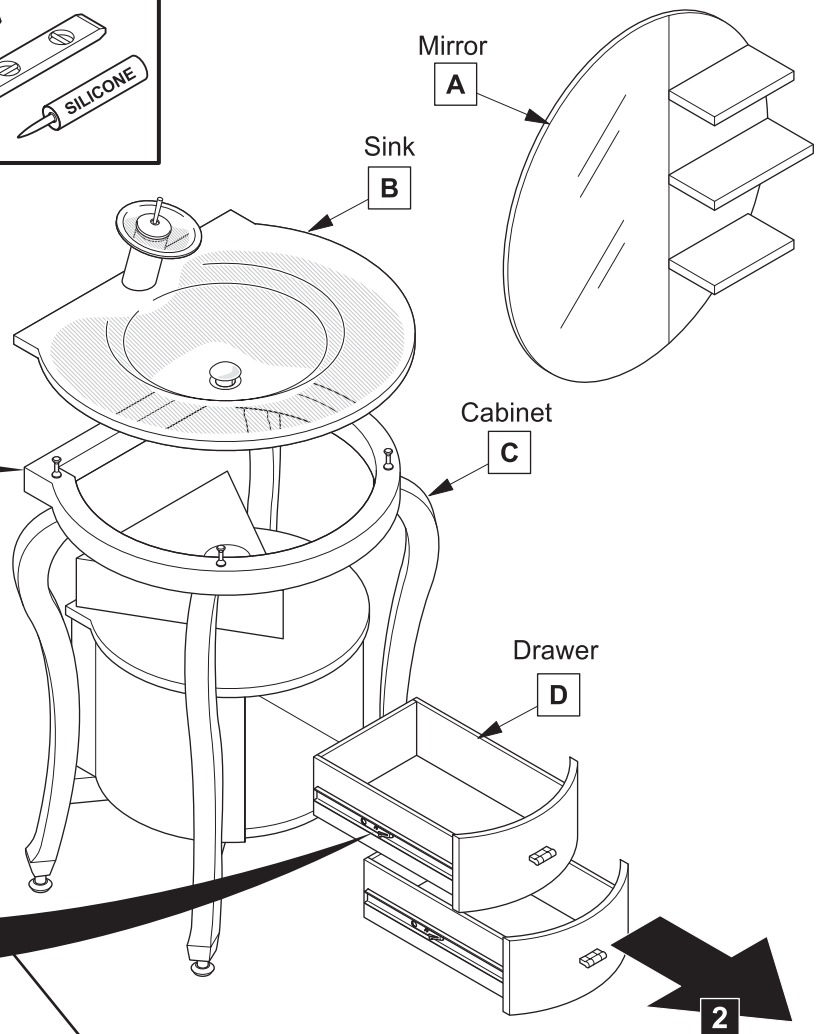
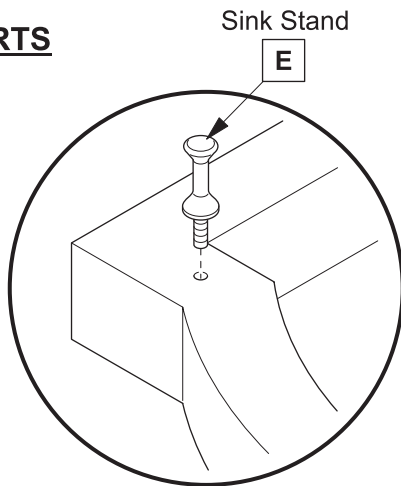

1

Remove drawer (D)

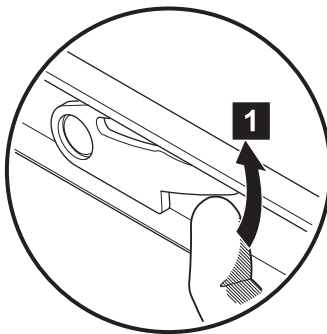

2

Position cabinet (C)

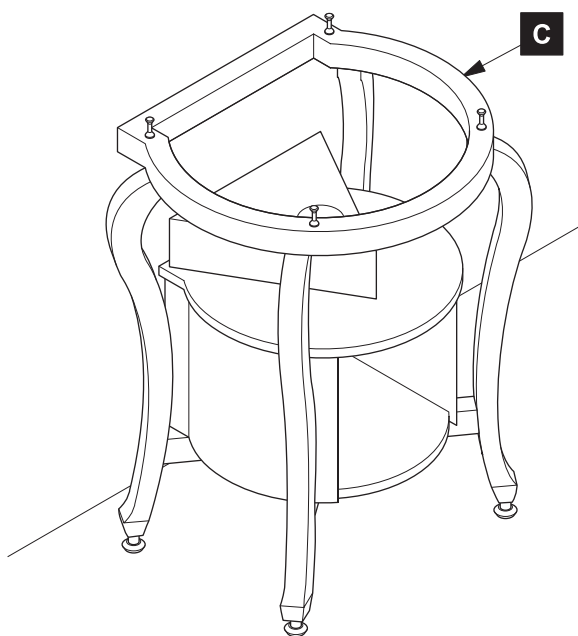

3

Apply silicone and install sink (B)

4

Install Mirror (A)

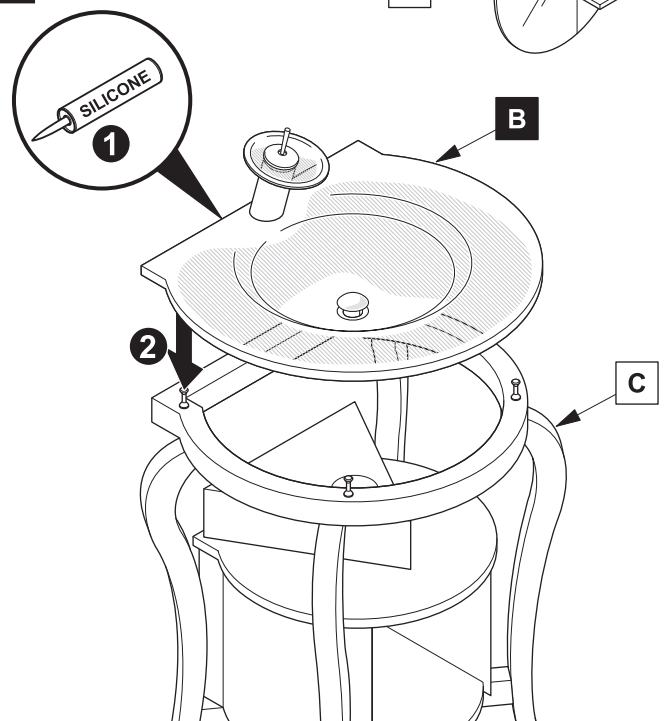

SIMPATICO INSTALLATION GUIDE

PAGE 2

P-TRAP AND POP-UP INSTALLATION INSTRUCTIONS

Your item may appear slightly different from the illustration

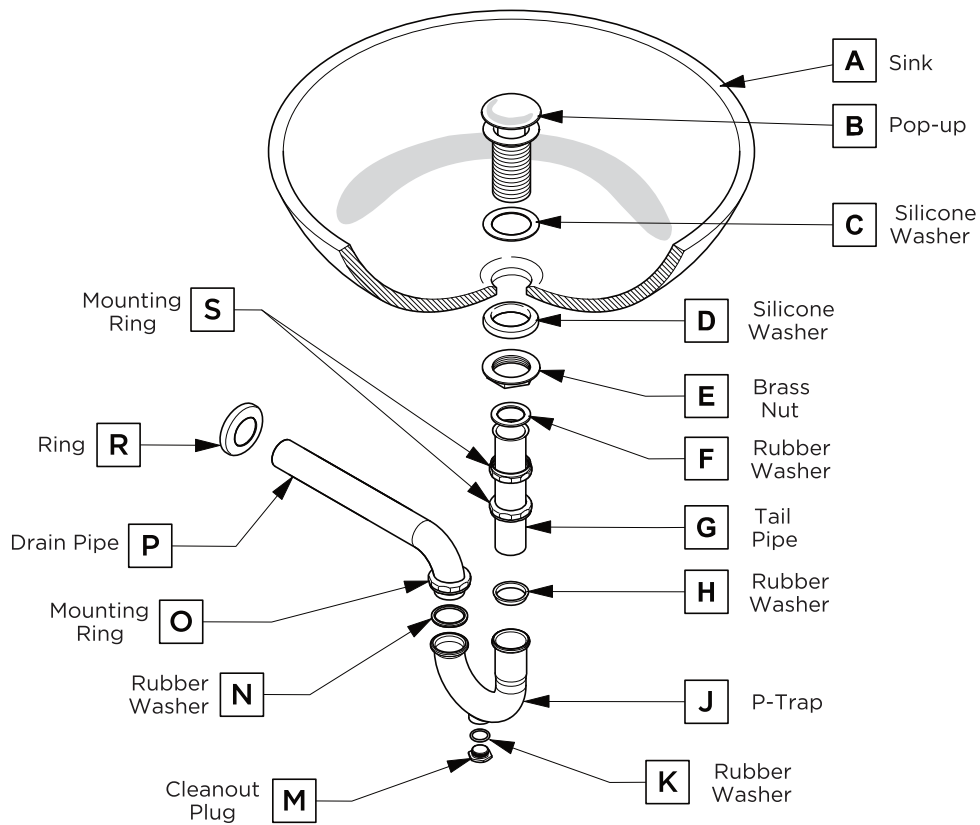

POP-UP INSTALLATION

FOR SINKS WITHOUT OVERFLOW

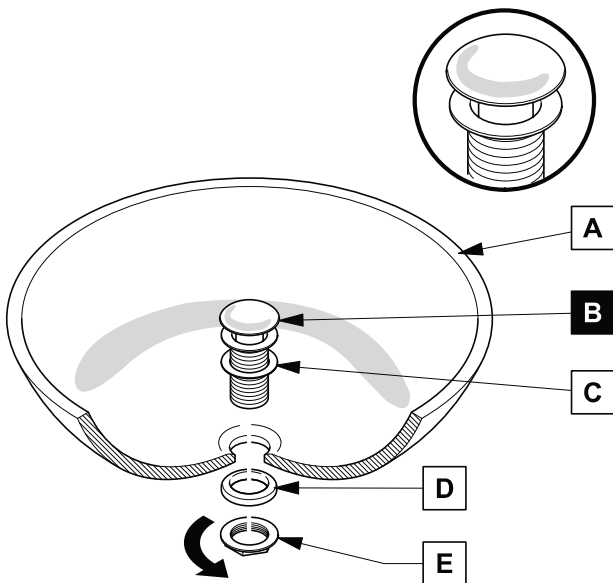

OR

FOR SINKS WITH OVERFLOW

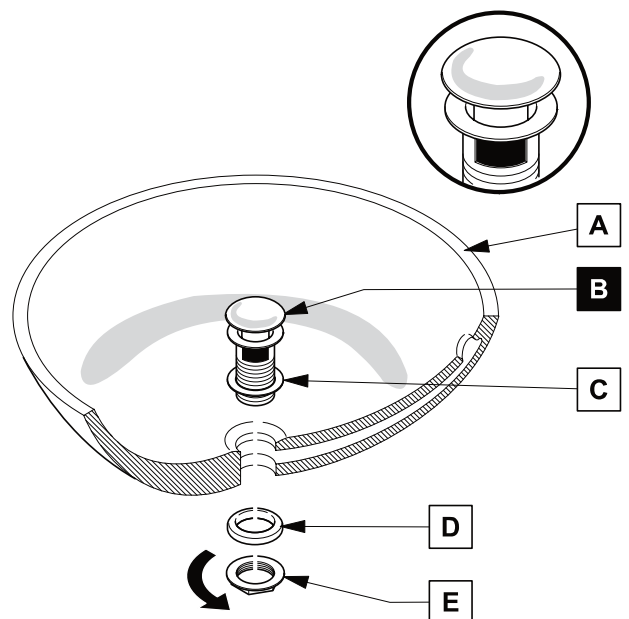

P-TRAP INSTALLATION

1

Install tail pipe (G)

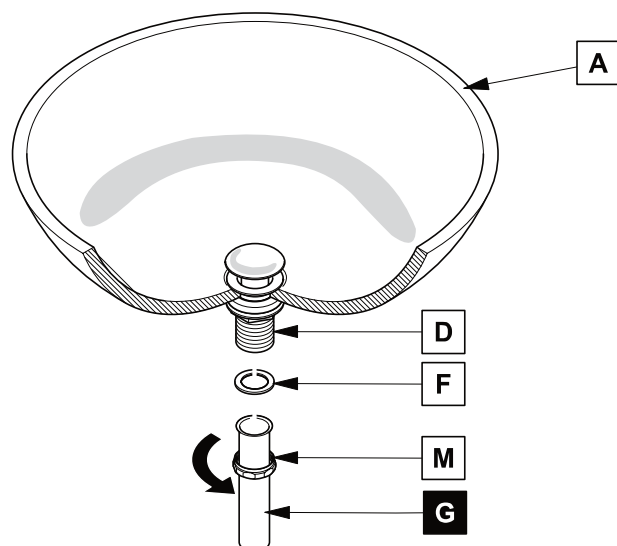

2

Install p-trap (J)

