

INSTALLATION INSTRUCTIONS

ST1200CH/ST1200MB

Single-lever kitchen mixer

stufurhome

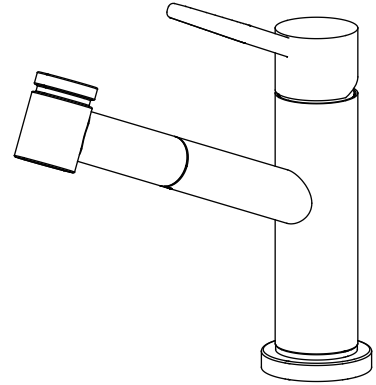

Important

- We recommend that this product is installed by a qualified professional contractor.
- Please check this product immediately to ensure that it has not been damaged and is complete. Before installation, please make sure this product is the correct model and you have all the parts required for installation and using.
- Please flush the water system to ensure that no metal swarf, solder, and other impurities can enter the taps.
- Turn off water supply before commencing work, this should be done at the isolating valves of inlet feeds if fitted or main stopcock.
- Please read these instructions carefully and keep it for future reference.

Maintainance

We do NOT recommend you use any household cleaners to clean the product. Because these cleaners change substance or formula too frequently. The product should be always cleaned only with soapy water and rinsed with clean water and dried with a soft cloth.

Dimensions

Unit: inches

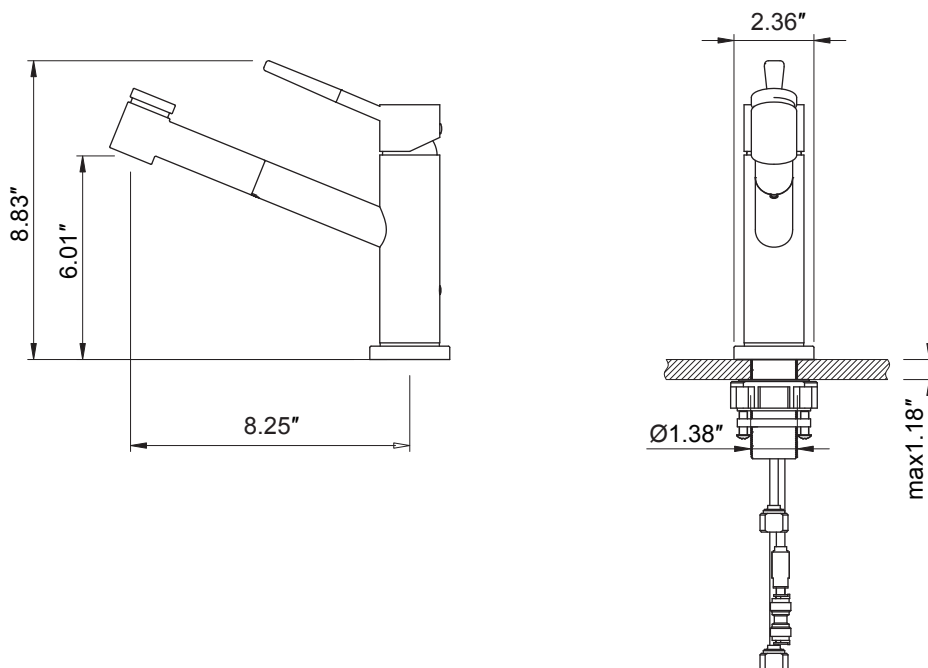

Installation

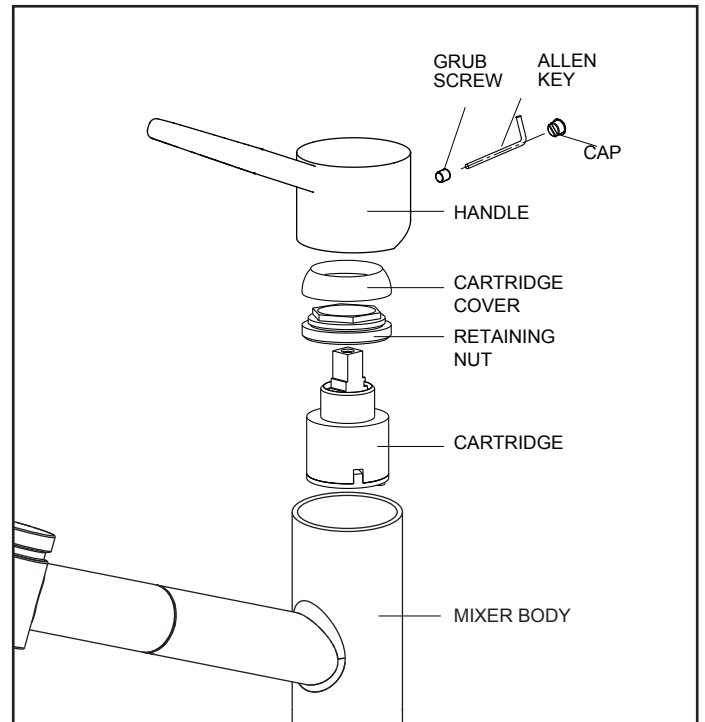
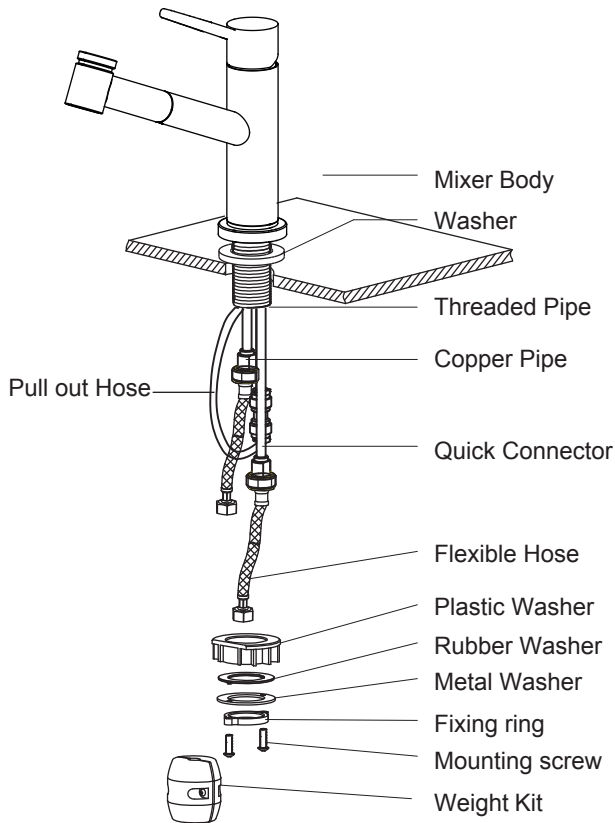

To remove the cartridge.

⚠ First shut off the water supply to the tap.

- 1: Pull out the cap from the handle.
- 2: Loosen the grub screw in handle, but do not remove it.
- 3: Take off the handle, unscrew the cartridge cover.
- 4: Using a correct size spanner unscrew the retaining nut.
- 5: Pull the cartridge and wash it with clean running water.
- 6: Dry and lightly grease the seals (only use silicone grease)
- 7: Replace them in turn.

- 1: Fit the washer into the groove at the underside of the mixer body.
- 2: Screw the flexible hoses into the mixer body, and fully hand tighten.
- 3: Pass the tail of flexible hoses through the hole on the basin from above, and place the mixer in position on the basin, make any necessary alterations to the pipe work.
- 4: Tighten the rubber washer, the metal washer & the fixing ring with the mounting screw from the under-side of the counter.
- 5: Check that the mixer body is correctly positioned; fully tighten the fixing ring and the mounting screw.
- 6: Place the weight kit to pull out hose and adjust the height to ensure that the weight kit can hang freely, then fix the weight kit. After that insert the end of the pull out hose to the quick connector.

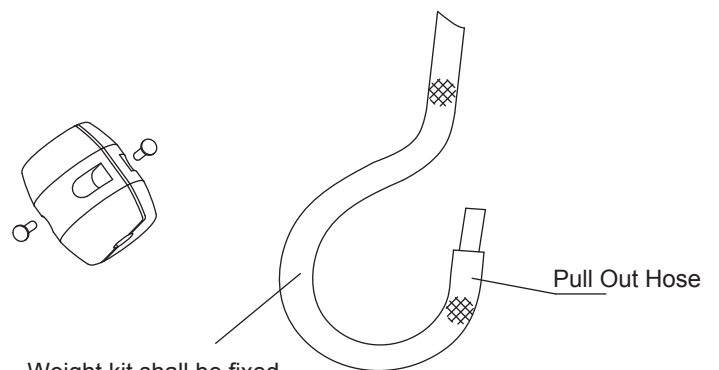

Weight kit shall be fixed here in the pull out hose where 400 mm from the counter.