

Instructions for electrician  
STEPS 2 - 18

WARNING:

2

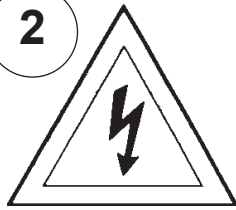

Electrical Danger

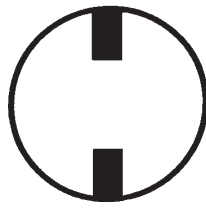

Turn Power Off

All electrical components must be installed by a licensed electrician in accordance with the National Electric Code and the appropriate local electrical codes.

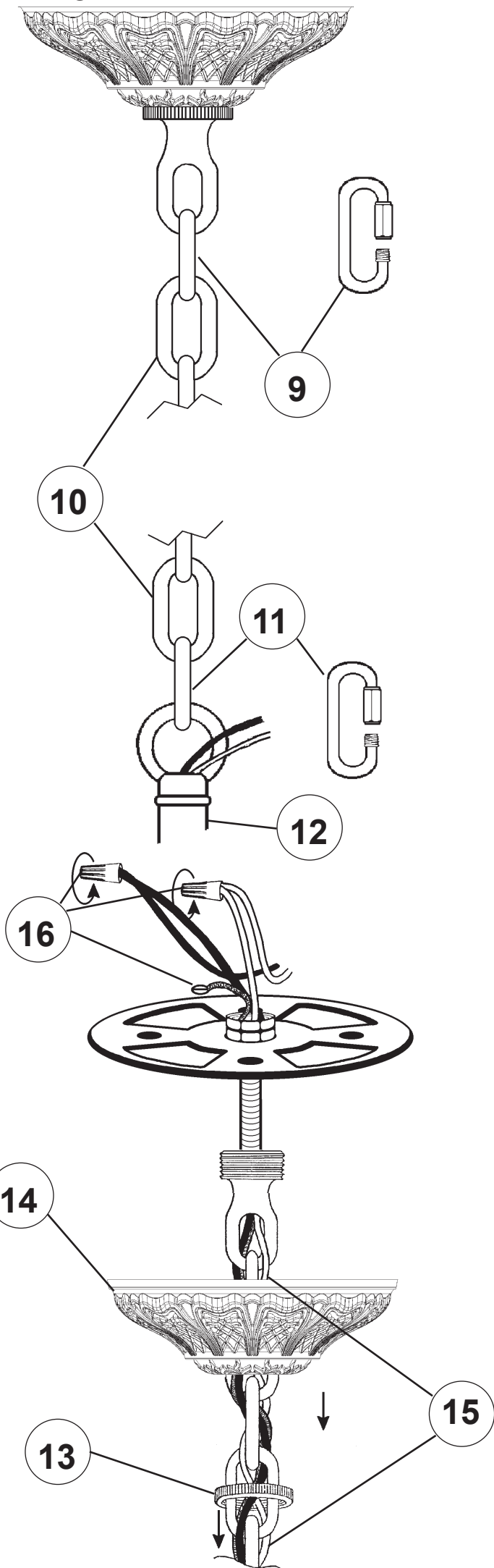
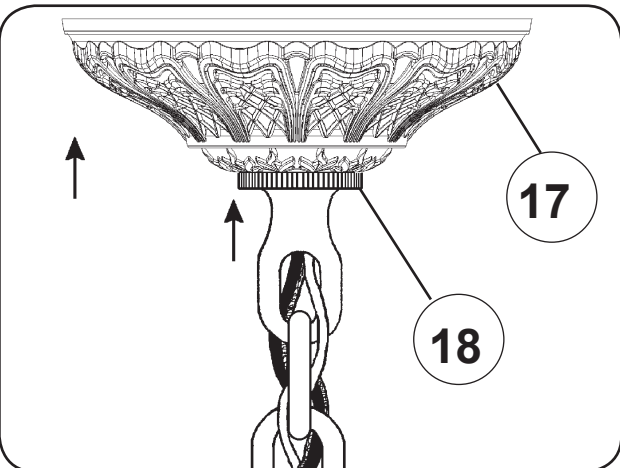
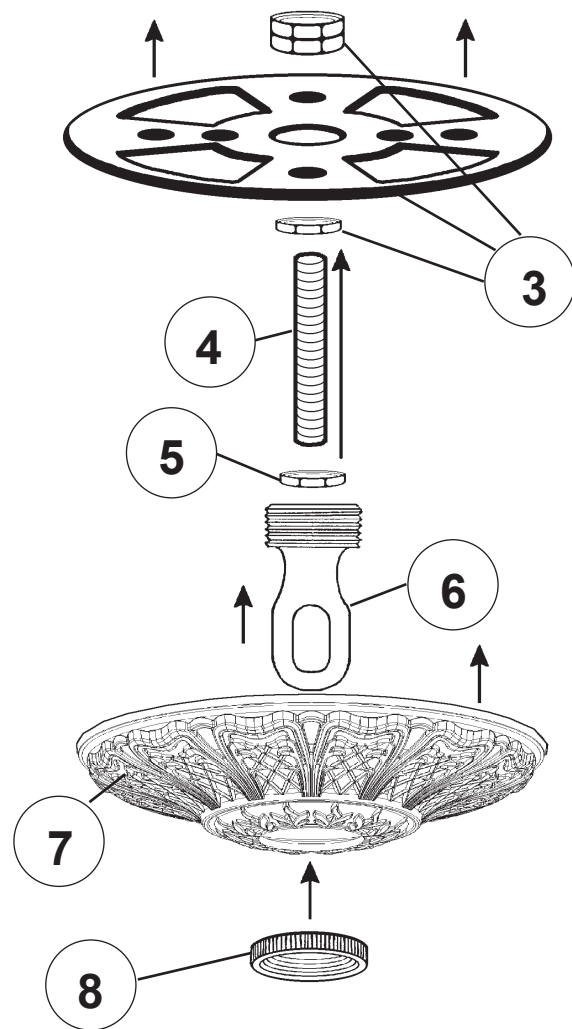

CHANDELIER 6967- \_\_\_\_ A TRIM DIAGRAM  
(Finish Option)



THIS DESIGN IS THE PROPRIETARY  
TRADE DRESS/TRADEMARK OF  
SWAROVSKI LIGHTING, LTD.

14 + 14 + 7 Lights  
Diameter: 55"  
Body Length: 62"  
Hanging Weight: 180 lbs.

**SCHONBEK®**

See diagram on back page  
Follow steps in exact order  
Save this trim diagram for future reference

1

IMPORTANT

Person who opens carton should record the  
following information for future service.

CODE # \_\_\_\_\_ Four-digit number on outside of carton.  
PACKER # \_\_\_\_\_ See crystal package label.  
ORDER # \_\_\_\_\_ See crystal package label.



Instructions for crystal trimming  
STEPS 19 - 47

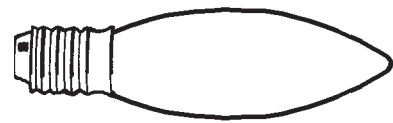

You will need 35 - B10  
25 Watts Recommended  
60 Watts Max

20

Install bulbs and be sure  
to test fixture **BEFORE**  
trimming.

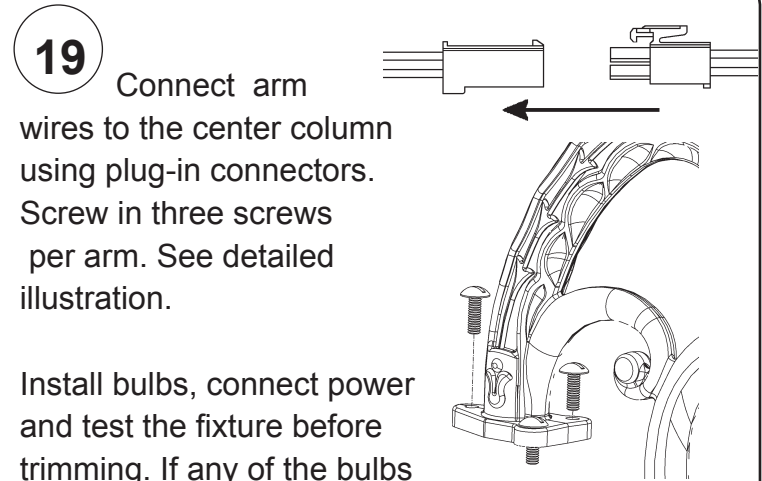

Install bulbs, connect power  
and test the fixture before  
trimming. If any of the bulbs  
do NOT light - DISCONNECT POWER.  
Double check the wire connections.

DIAGRAM 1

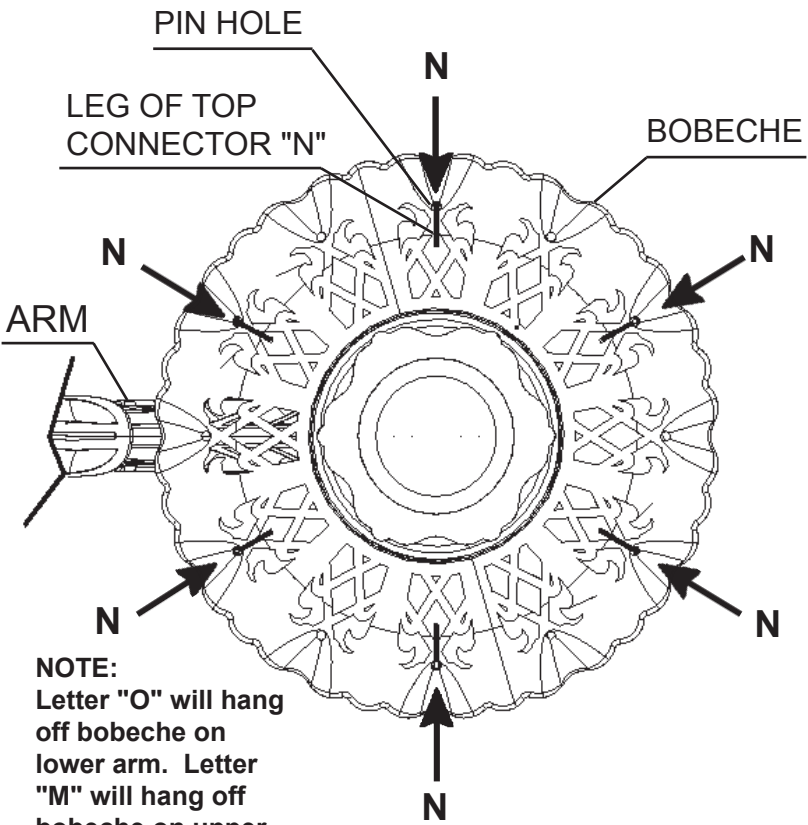

**NOTE:**  
Letter "O" will hang  
off bobeche on  
lower arm. Letter  
"M" will hang off  
bobeche on upper  
arm.  
When trimming arm bobeche with letter "N", insert  
leg of top connector into pin hole from under bobeche.  
Hang in every other pin hole starting on either side of  
the arm (refer to Diagram 1)

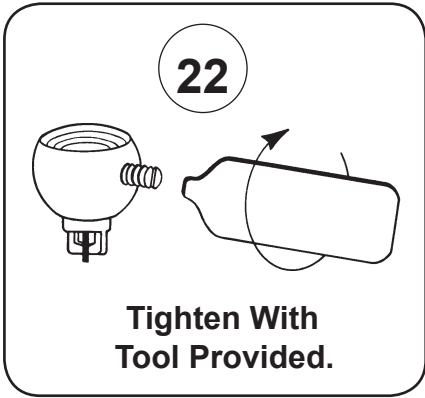

22

Tighten With  
Tool Provided.

**Note:**  
When trimming bobeche  
with letter "M", insert leg  
of top connector into every  
other pin hole from under  
bobeche. (Similar to  
Diagram 1; start with any  
pin hole.)

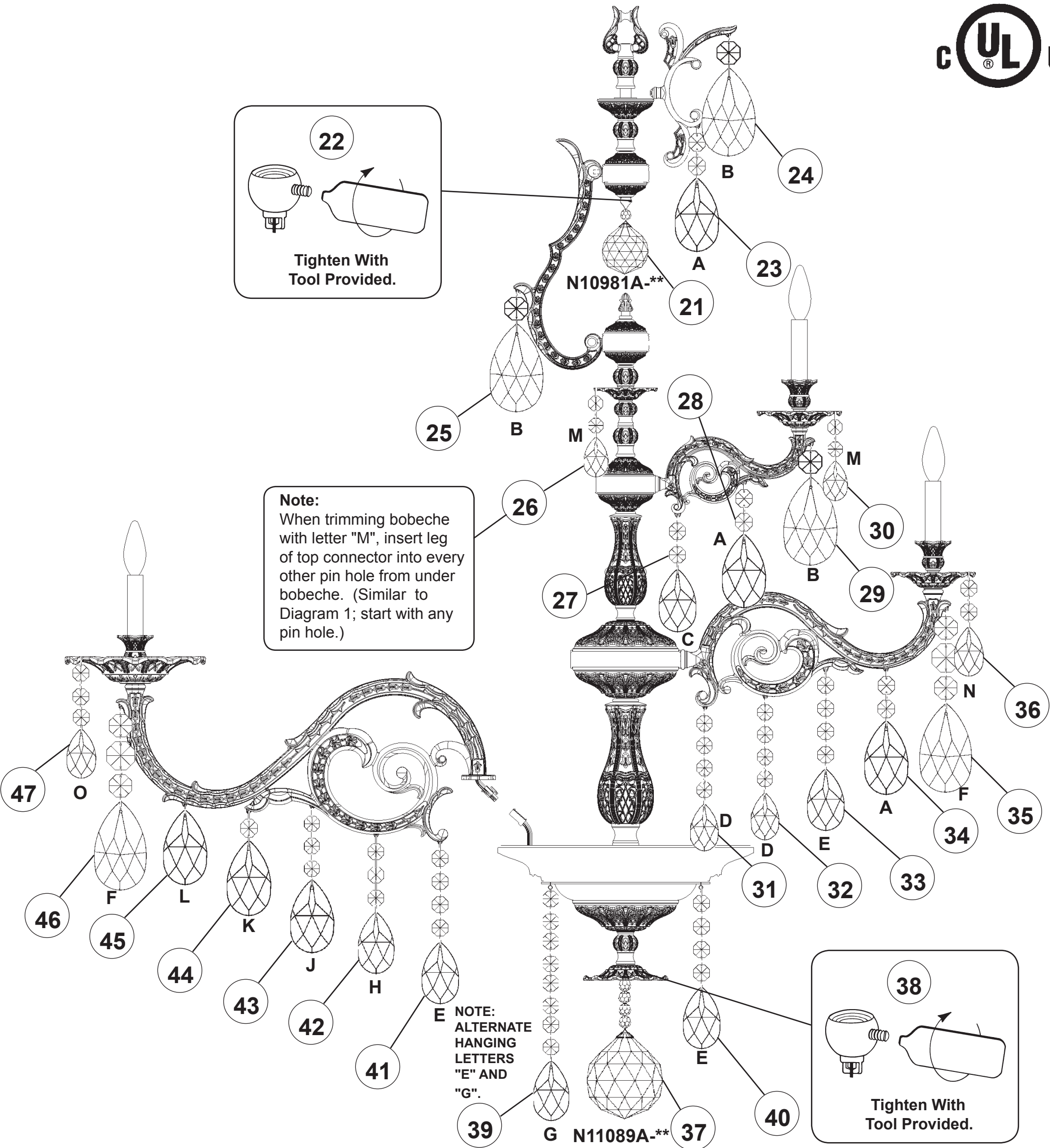

**NOTE:**  
ALTERNATE  
HANGING  
LETTERS  
"E" AND  
"G".

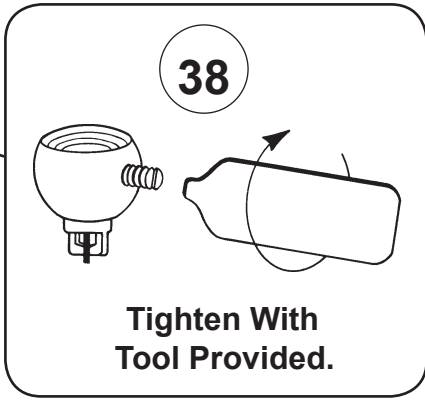

38

Tighten With  
Tool Provided.